

FULL 16TH FLOOR

31,734 SF

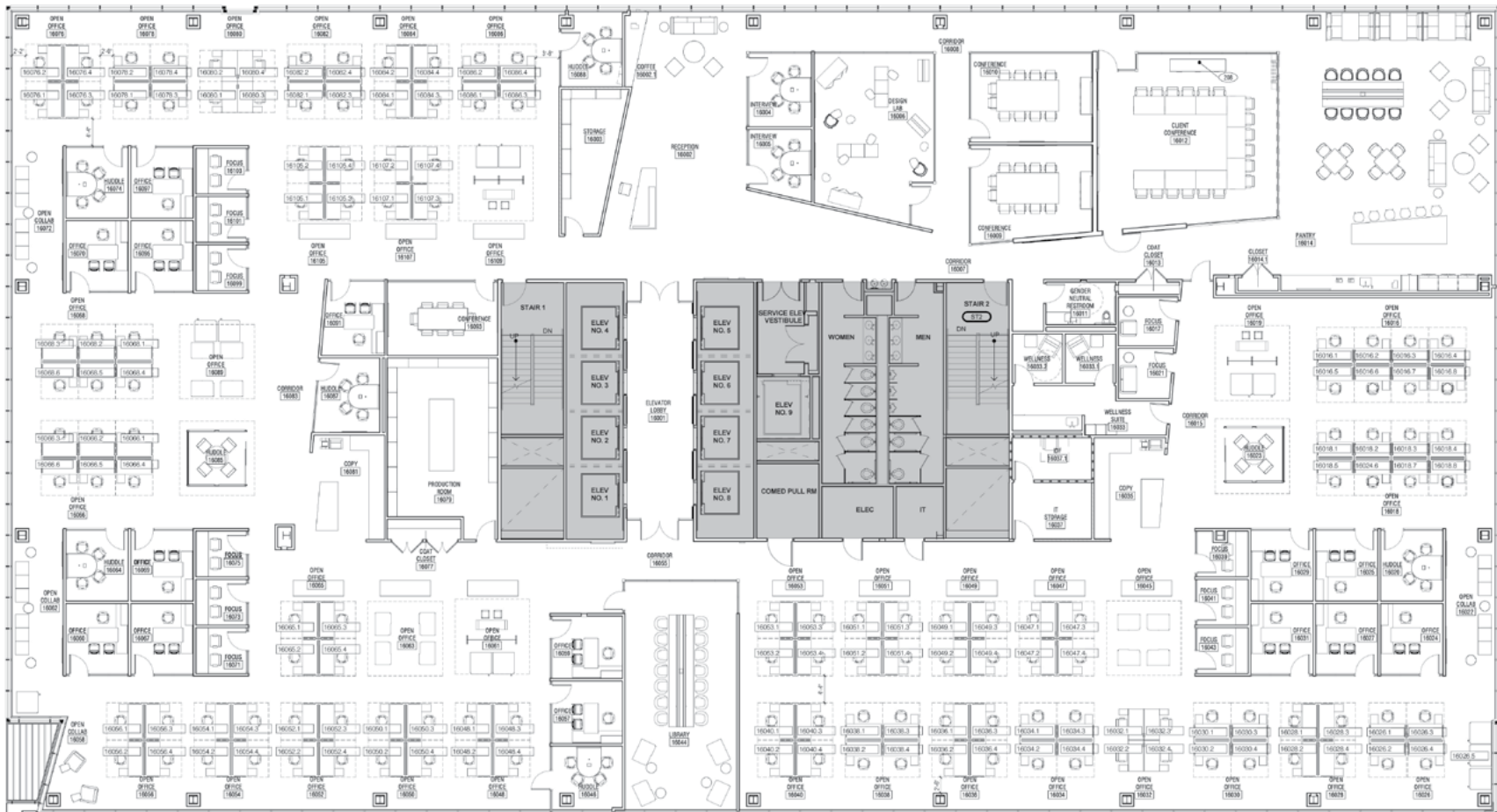



SUITE 1600

31,734 SF

- Single-tenant floor with elevator ID
- Plug & play for immediate occupancy
- Panoramic city views with great light
- Abundance of meeting space to support Tenant's collaboration needs

SPACE DETAILS

- Formal reception with elevator ID
- 132 workstations with sit / stand desks
- 14 offices
- Training room with adjacency to large kitchen & break area
- 8 huddle rooms
- 3 8-person boardrooms
- 9 phone rooms
- 2 large, informal meeting spaces
- Mother's / wellness rooms
- Breakout seating throughout premise for open collaboration

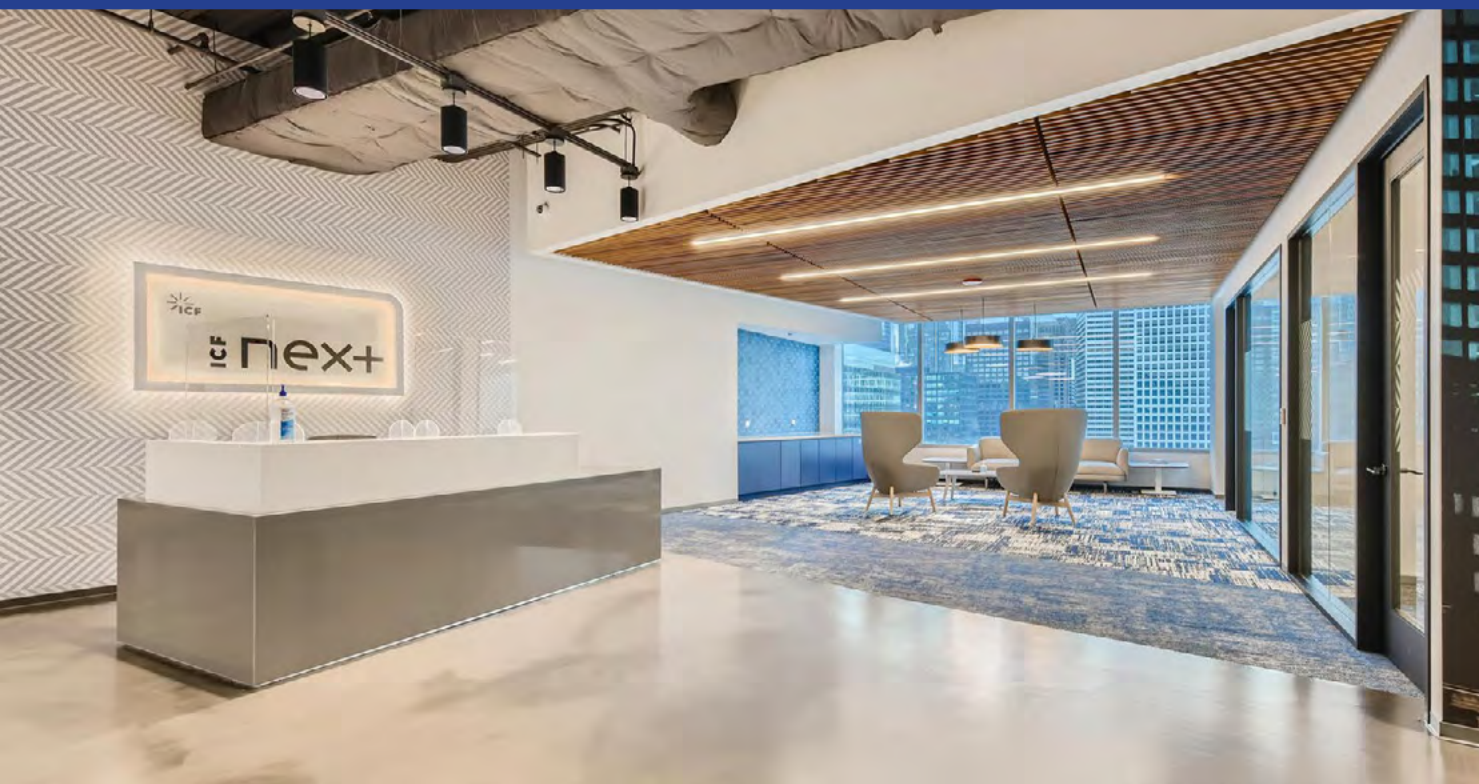

CONTACT

ERIC MYERS

eric.myers@transwestern.com

JOHN NELSON

john.nelson@transwestern.com

KATIE STEELE

katie.steele@transwestern.com

