

Palisade Temescal Commerce Center

Entitlements Approved, Drawings Completed,
Permits NOW READY TO ISSUE

201,844 Square Feet Class-A Industrial Building

22728 Temescal Canyon Road
Corona, CA



Another Quality Development by



Nicholas Chang, CCIM SIOR

Senior Vice President
+1 909 418 2014
nicholas.chang@cbre.com
Lic. 01344844

Richard Lee, SIOR

Senior Vice President
+1 909 418 2010
richard.lee@cbre.com
Lic. 01757870

Justin Kuehn

First Vice President
+1 909 418 2013
justin.kuehn@cbre.com
Lic. 01969182

Sione Fua

Vice President
+1 909 418 2007
sione.fua@cbre.com
Lic. 02006432

Edward Michino

Vice President
+1 310 365 9712
emichino@naicapital.com
Lic. 01742275

CBRE

Site Plan

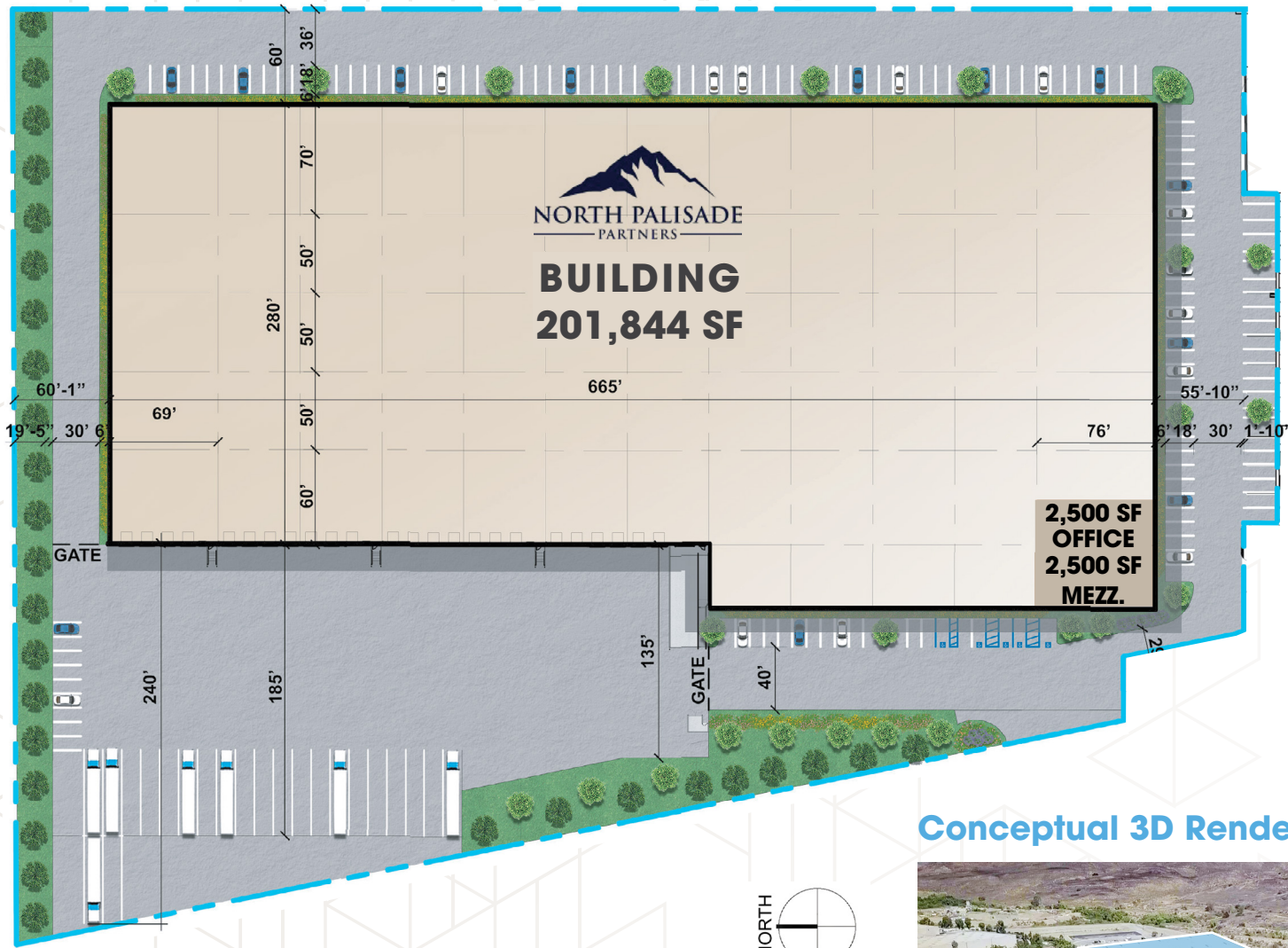

By The Numbers

-  9.26 **NET ACRES**

-  201,844 SF **TOTAL BUILDING SIZE**

-  36' **WH CLEAR HEIGHT**

-  240' DEEP **SECURED TRUCK COURT**

-  24 | 130 **TRAILER | AUTO PARKING**

-  5,000 SF EXPANDABLE TO 8,000 SF **2-STORY OFFICE**

-  ESFR | K-25 **SPRINKLER SYSTEMS**

-  24 **DOCK HIGH DOORS**

-  2000 **AMPS POWER**

-  8 Inch **SLAB THICKNESS**

-  .50 **COVERAGE RATIO**

Conceptual 3D Rendering



Location Map

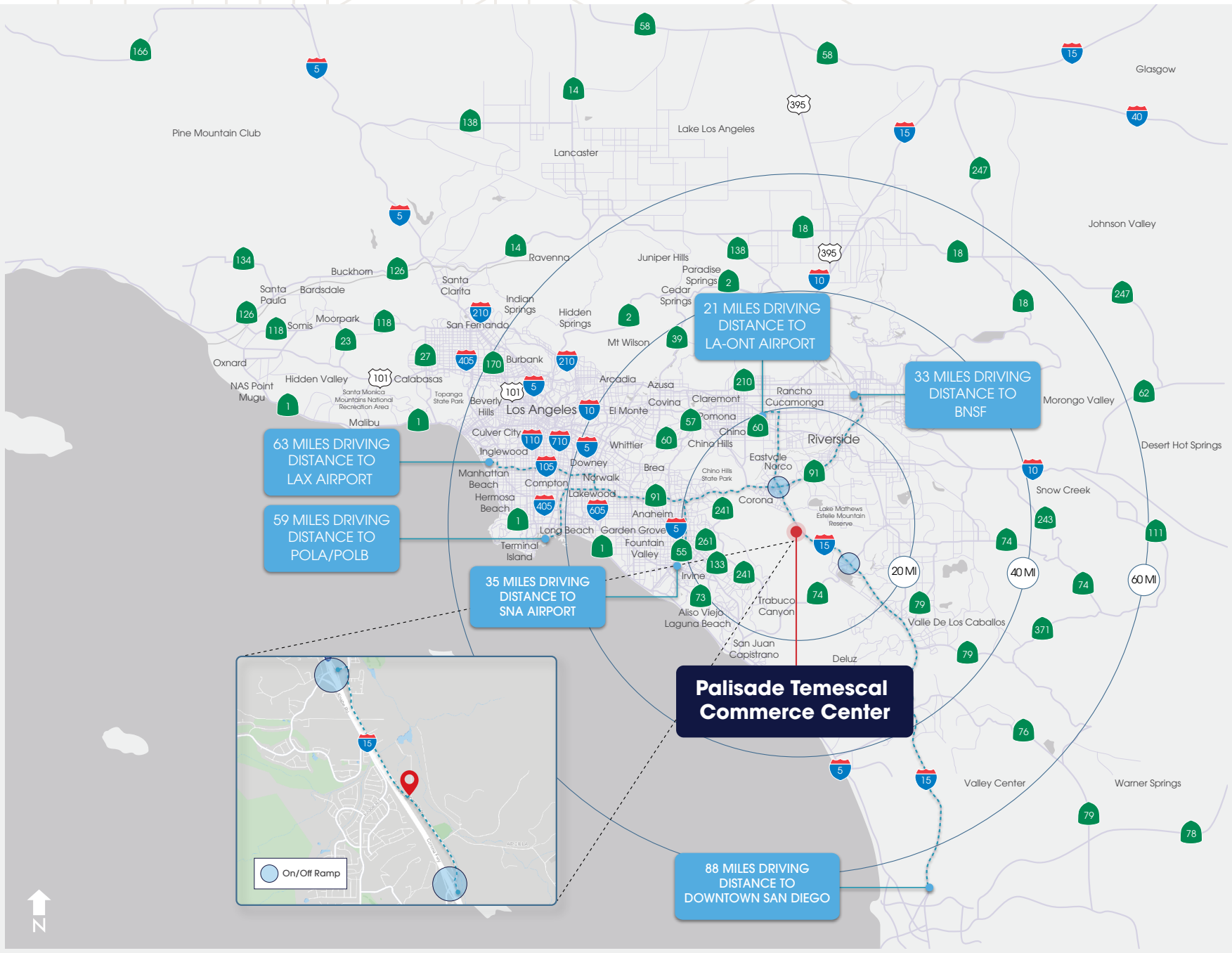

Palisade Temescal Commerce Center

Entitlements Approved, Drawings Completed,
Permits NOW READY TO ISSUE



201,844 Square Feet Class-A Industrial Building

22728 Temescal Canyon Road
Corona, CA

Exclusively Offered by:

Nicholas Chang, CCIM SIOR

Senior Vice President
+1 909 418 2014
nicholas.chang@cbre.com
Lic. 01344844

Richard Lee, SIOR

Senior Vice President
+1 909 418 2010
richard.lee@cbre.com
Lic. 01757870

Justin Kuehn

First Vice President
+1 909 418 2013
justin.kuehn@cbre.com
Lic. 01969182

Sione Fua

Vice President
+1 909 418 2007
sione.fua@cbre.com
Lic. 02006432

Edward Michino

Vice President
+1 310 365 9712
emichino@naicapital.com
Lic. 01742275

CBRE

Another Quality
Development by



© 2025 CBRE, Inc. All rights reserved. This information has been obtained from sources believed reliable but has not been verified for accuracy or completeness. You should conduct a careful, independent investigation of the property and verify all information. Any reliance on this information is solely at your own risk. CBRE and the CBRE logo are service marks of CBRE, Inc. All other marks displayed on this document are the property of their respective owners, and the use of such logos does not imply any affiliation with or endorsement of CBRE. Photos herein are the property of their respective owners. Use of these images without the express written consent of the owner is prohibited. CPM 22728 Temescal Canyon Rd_INT BRO_Chang_v08_GH 03/21/25