

This sketch is provided, without charge, for your information. It is not intended to show all matters related to the property including, but not limited to, area, dimensions, easements, encroachments, or location of boundaries. It is not a part of, nor does it modify, the commitment or policy to which it is attached. The Company assumes NO LIABILITY for any matter related to this sketch. Reference should be made to an accurate survey for further information.

LAND DIVISION
OF
KELLOGG LAND COMPANY'S
PLAT OF
CLALLAM

Vol. 3 P. 56

Scale 1 inch = 100 Feet

Thomas B. White - Engineer
George W. White - Surveyor

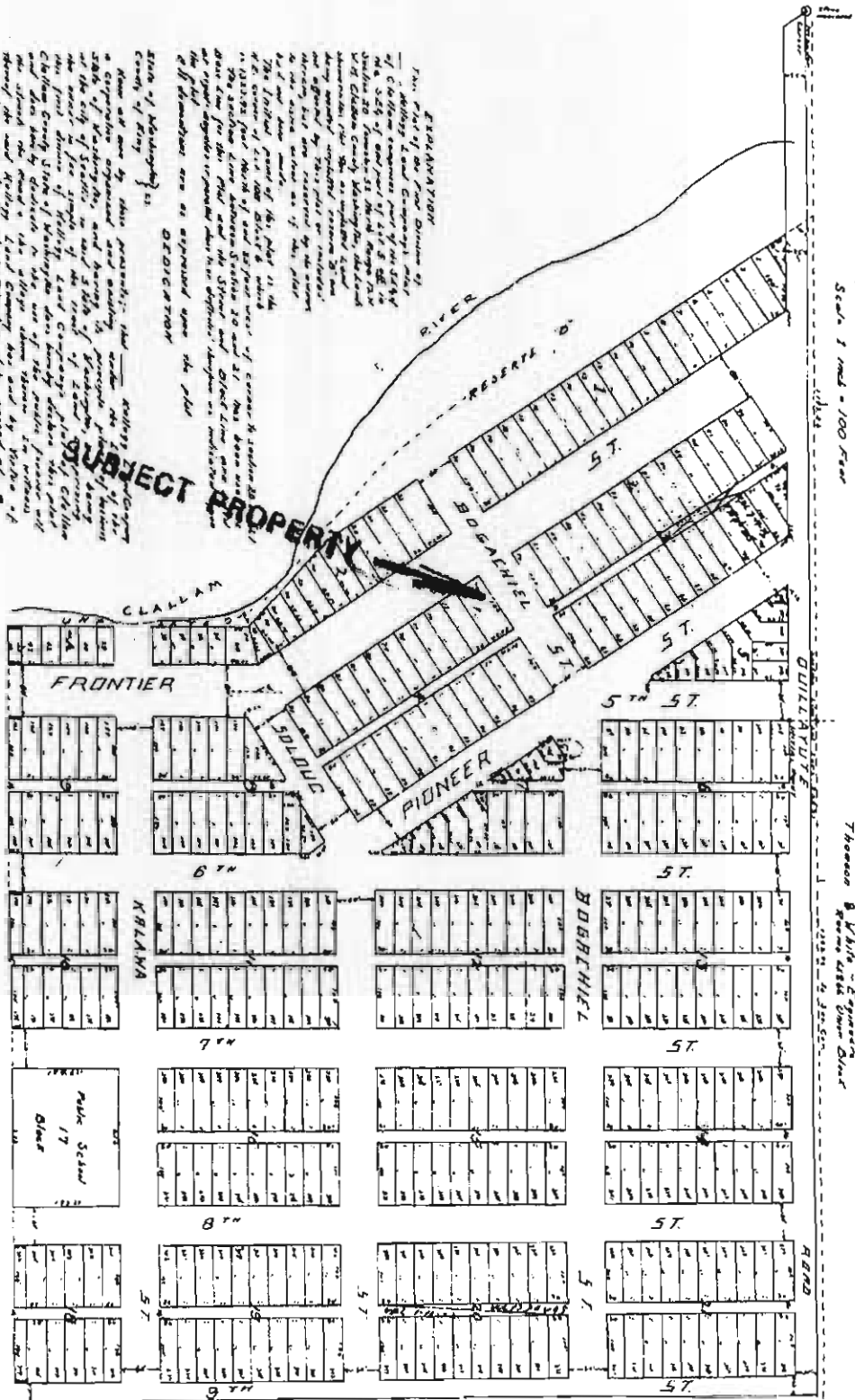

EXPLANATION
The Plat of the First Division of Kellogg Land Company, made by the State of Washington, and approved by the Board of Commissioners of the State of Washington, on the 14th day of October, A.D. 1891, is hereby confirmed and approved by the Board of Commissioners of the State of Washington, on the 14th day of October, A.D. 1891.

STATE OF WASHINGTON
County of King } ss
I, George W. White, Engineer, do hereby certify that the above plat of the Kellogg Land Company, made by the State of Washington, and approved by the Board of Commissioners of the State of Washington, on the 14th day of October, A.D. 1891, is hereby confirmed and approved by the Board of Commissioners of the State of Washington, on the 14th day of October, A.D. 1891.

ACKNOWLEDGMENT
County of King } ss
I, George W. White, Engineer, do hereby certify that the above plat of the Kellogg Land Company, made by the State of Washington, and approved by the Board of Commissioners of the State of Washington, on the 14th day of October, A.D. 1891, is hereby confirmed and approved by the Board of Commissioners of the State of Washington, on the 14th day of October, A.D. 1891.

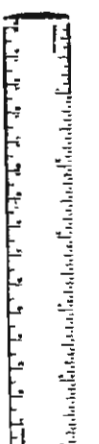

Filed for record by me of David White
David White, Surveyor
Recorded in Vol. 3 of Public Lands
at Clallam, Wash.
this 14th day of October, 1891.

I, George W. White, Engineer, do hereby certify that the above plat of the Kellogg Land Company, made by the State of Washington, and approved by the Board of Commissioners of the State of Washington, on the 14th day of October, A.D. 1891, is hereby confirmed and approved by the Board of Commissioners of the State of Washington, on the 14th day of October, A.D. 1891.

George W. White
Engineer
of Washington
in and for the State
of Washington

This sketch is provided, without charge, for your information. It is not intended to show all matters related to the property including, but not limited to, area, dimensions, easements, encroachments, or location of boundaries. It is not a part of, nor does it modify, the commitment or policy to which it is attached. The Company assumes NO LIABILITY for any matter related to this sketch. Reference should be made to an accurate survey for further information.

LAM

TIDELANDS

BAY

LOT 5

