

FLEXIBLE OFFICE SPACES FOR LEASE

1970 W Fayette Street, Syracuse NY 13204



GEREBLOCK LOUNGE

SITTING AGAINST A SECTION OF THE ERIE CANAL AT WEST FAYETTE STREET, ERIE AND HIAWATHA BOULEVARDS



GEREBLOCK LOUNGE

- GERE BLOCK 27 is a historic renovation of an original Erie Canal Building into a modern mixed-use commercial development.
- Building Tenants include **Cornell University's Brain Education Center**, Eden Fresh Market, Safe Space CNY & Metal Morphosis.
- GERE BLOCK LOUNGE office buildouts include lots of **natural light, exposed brick and high ceilings**.
- Amenities include FIOS wifi, secure CAT6 data connections(offices), conference room, kitchenette, secure controlled access, mail services, printing services, available beer & wine, podcast room(2023), rooftop deck(2023), interior bike storage(2023), **free parking** and **free coffee**.
- Easy access to downtown Syracuse and all major highways.

BOOK YOUR SPACE ONLINE AT:

WWW.GEREBLOCKLOUNGE.COM

Scott Dumas

Licensed Real Estate Broker

315 877 5113

scottdumas107@gmail.com

Monira Alozaima

Licensed Real Estate Salesperson

315 278 6435

malozaima@gmail.com

Papyrus Real Estate Solutions
1970 W. Fayette Street
Syracuse NY 13204

FLEXIBLE OFFICE SPACES FOR LEASE

1970 W Fayette Street, Syracuse NY 13204



PAPYRUS
REAL ESTATE SOLUTIONS



**GEREBLOCK
LOUNGE**

LEVEL 3 – Safe Space CNY & COMMERCIAL SPACES

LEVEL 2 – CORNELL UNIVERSITY / GEREBLOCK LOUNGE

LEVEL 1 – Eden Fresh Network/RETAIL & SERVICE SPACES



GEREBLOCK LOUNGE

2022 PRICING

AVAILABLE

LEASED

MONTHLY RATES FOR AVAILABLE SPACES:

204 - \$790
205 - \$850
206 - \$500
208 - \$650
210 - \$950
211 - \$500
213 - \$500
214 - \$500
215 - \$750
216 - \$650

Nomad open Lounge seating available by the following packages:

- Dedicated – Guaranteed workspace with lockable drawer at desk.
- Flex – First come first served with 1 lockable drawer onsite.
- True Nomad – First-come first-served & no off-hours secure space.

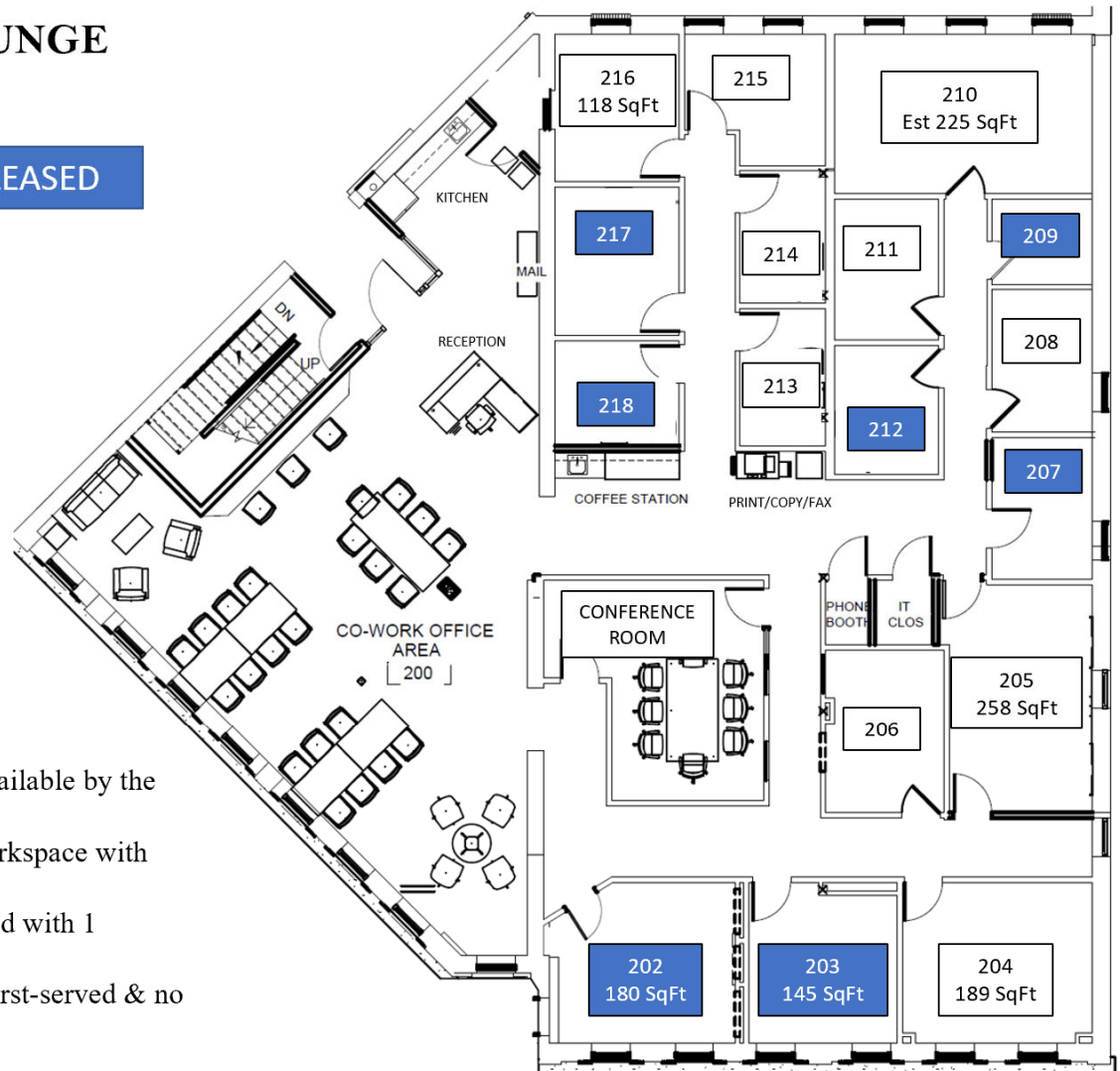

LEARN MORE OR BOOK YOUR SPACE ONLINE AT:
WWW.GEREBLOCKLOUNGE.COM