



7642 McEwen Road

Washington Township, Ohio 45459

LEASE RATE:
\$6.50 PSF MODIFIED GROSS

Property Highlights

- 2,448± SF Warehouse available
- 10' x 12' OH Door
- 14' Clear ceiling height
- Access to loading dock platform
- Park like setting with visibility from I-675
- No city income tax

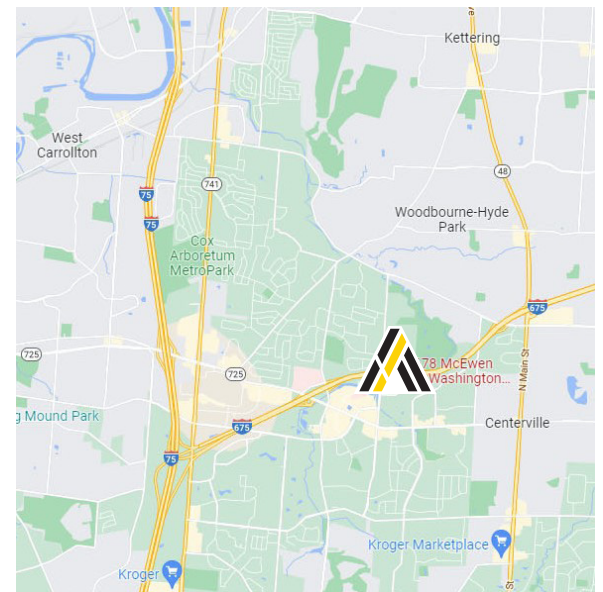

Wade Elliott, SIOR

Vice President

937.469.8270

Wade.Elliott@ApexCommercialGroup.com



Alex Nikolai

Senior Associate

937.222.7884

Alex.Nikolai@ApexCommercialGroup.com

7642 McEwen Road

Washington Township, Ohio 45459



Photos



ApexCommercialGroup.com

7642 McEwen Road

Washington Township, Ohio 45459

Floor Plan

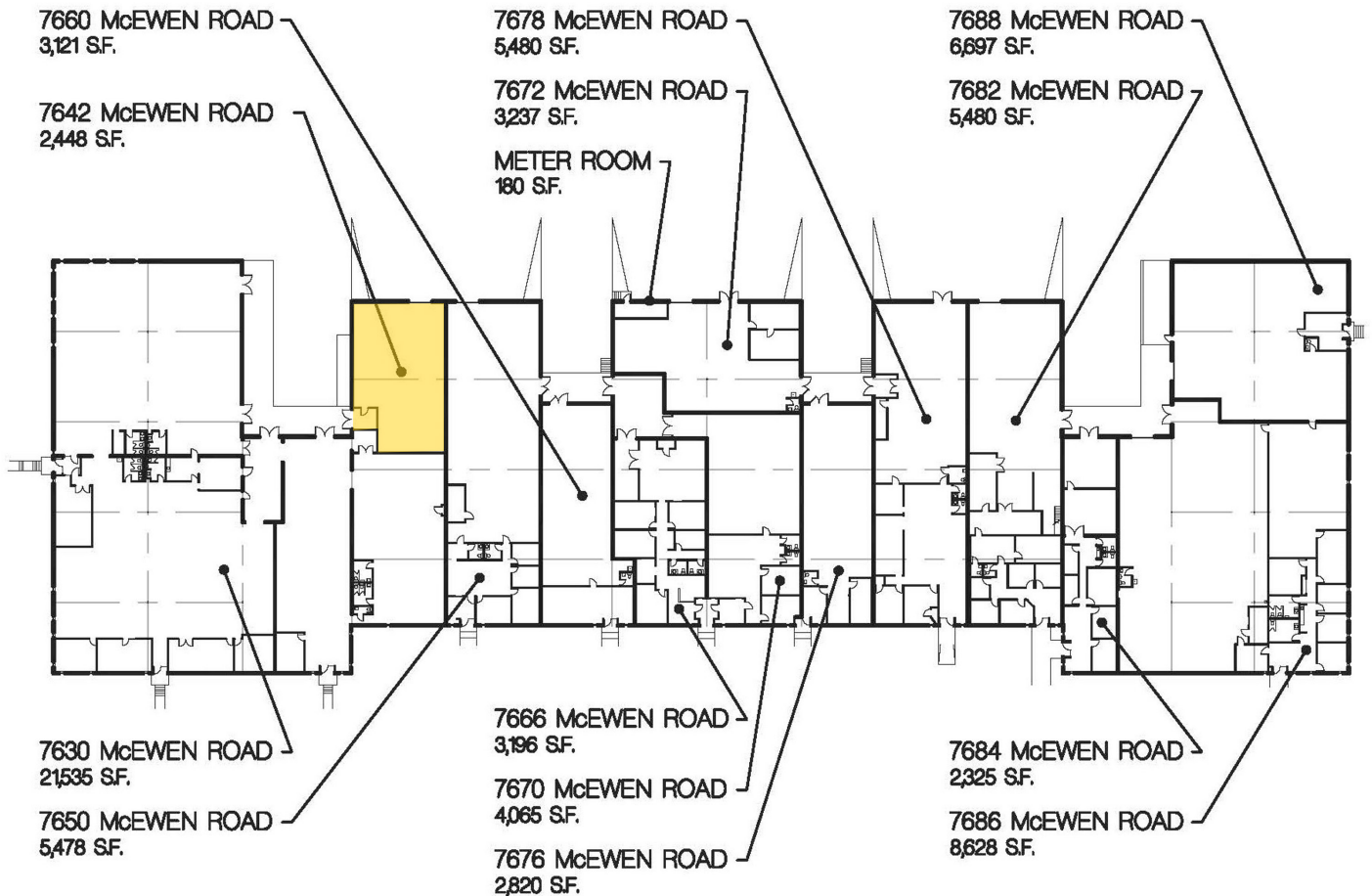
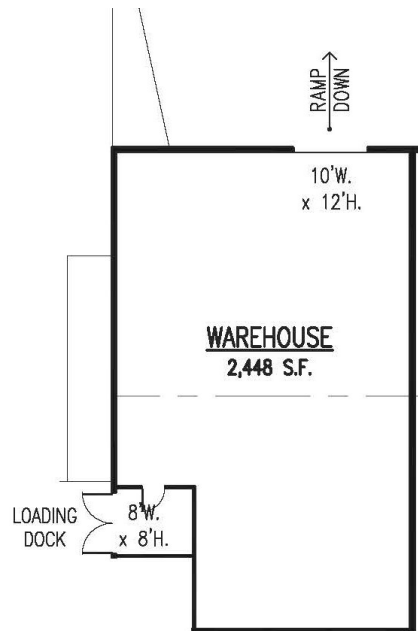

ApexCommercialGroup.com