



2.57 Acres  
Hwy 27  
Frontage

Offering Memorandum  
410 N 14th St, Leesburg, FL 34748

**PRB** | PREFERRED  
REAL ESTATE  
BROKERS

EXCLUSIVELY LISTED BY

## Mark Williams

Senior Associate

2121 S Hiawasse Rd Suite 100 Orlando, FL 32835

Mobile: (407) 406-3187 | Office: (407) 440-4900

Mark.WilliamsRE@outlook.com

License: FL #SL3394984



PREFERRED  
REAL ESTATE  
BROKERS

### NON-ENDORSEMENT & DISCLAIMER NOTICE

**CONFIDENTIALITY & DISCLAIMER** The information contained in the following Marketing Brochure is proprietary and strictly confidential. It is intended to be reviewed only by the party receiving it from Preferred Real Estate Brokers and should not be made available to any other person or entity without the written consent of Preferred Real Estate Brokers. This Marketing Brochure has been prepared to provide summary, unverified information to prospective purchasers or lessees, and to establish only a preliminary level of interest in the subject property. The information contained herein is not a substitute for a thorough due diligence investigation. Preferred Real Estate Brokers has not made any investigation, and makes no warranty or representation, with respect to the income or expenses for the subject property, the future projected financial performance of the property, the size and square footage of the property and improvements, the presence or absence of contaminating substances, PCB's or asbestos, the compliance with State and Federal regulations, the physical condition of the improvements thereon, or the financial condition or business prospects of any tenant, or any tenant's plans or intentions to continue its occupancy of the subject property. The information contained in this Marketing Brochure has been obtained from sources we believe to be reliable; however, Preferred Real Estate Brokers has not verified, and will not verify, any of the information contained herein, nor has Preferred Real Estate Brokers conducted any investigation regarding these matters and makes no warranty or representation whatsoever regarding the accuracy or completeness of the information provided. All potential buyers or lessees must take appropriate measures to verify all of the information set forth herein. Preferred Real Estate Brokers.

**NON-ENDORSEMENT NOTICE** Preferred Real Estate Brokers is not affiliated with, sponsored by, or endorsed by any commercial tenant or lessee identified in this marketing package. The presence of any corporation's logo or name is not intended to indicate or imply affiliation with, or sponsorship or endorsement by, said corporation of Preferred Real Estate Brokers, its affiliates or subsidiaries, or any agent, product, service, or commercial listing of Preferred Real Estate Brokers, and is solely included for the purpose of providing tenant lessee information about this listing to prospective customers.

BOR: Jose Fleming Lic # BK3398881

2.57 Acres

253 ft of Frontage on US Hwy 27



29,500 AADT



410 N 14<sup>th</sup> St  
Leesburg, FL 34748



2.57 Acre  
Development Site

# Investment Highlights

- 2.57 Acre Development Site in Prime Location
- Oversized Retail Parcel with Hwy 27 Frontage
- Access from North and South Bound US Hwy 27
- Four-Way Traffic Light at Hwy 27 and Center St
- South Entrance from Center St for Parking / Trucks
- Few Remaining Development Sites on Hwy 27
- 1,100ft South of Publix Super Market at Palm Plaza
- Major Retailers & Quick Serve Restaurants in Proximity
- 12 Miles from The Villages | Largest 55+ Community
- Leesburg Population has Increased 15.28% Since 2020
- Florida is Income Tax-Free & Business Friendly State



Price  
**\$1,350,000**

Acres  
**2.57**

Price/Acre  
**\$525,292**

Zoning  
**Hwy Comm**

410 N 14<sup>th</sup> St  
**Leesburg, FL**  
**34748**

## Overview

Address	410 N 14 <sup>th</sup> St Leesburg, FL 34748
Price	\$1,350,000
Price / Acre	\$525,292
Lot Size	2.57 Acres
Lot SF	111,949 SF
Zoning	Hwy Commercial
Frontage	US Hwy 27
Access	Hwy 27 and Center St
Type	Retail Development



2.57 Acres



POPEYES



TACO BELL



Publix.



29,500 AADT



Publix-anchored Palm Plaza  
sells for \$17.8 million

True Value.

Leesburg, FL Feb. 2024

A 133,419-square ft, 92%-occupied, high-performing Publix-anchored shopping center, sold for \$17.8 million. This prominent retail destination is located at 715 N. 14th St. in Leesburg, Fla., near The Villages, along U.S. Highway 27, which averages a daily traffic count of 29,500 cars.



# The Villages®

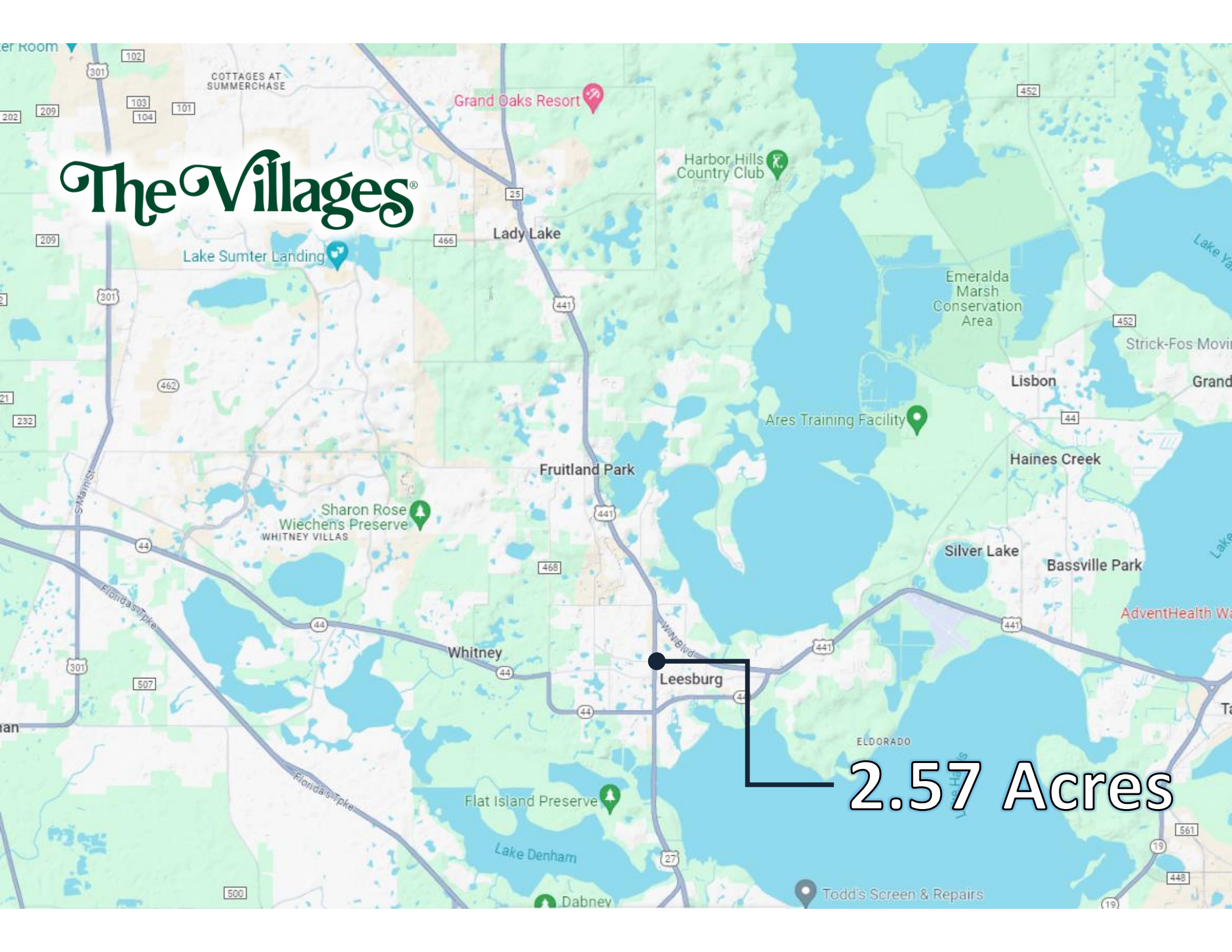

2.57 Acres



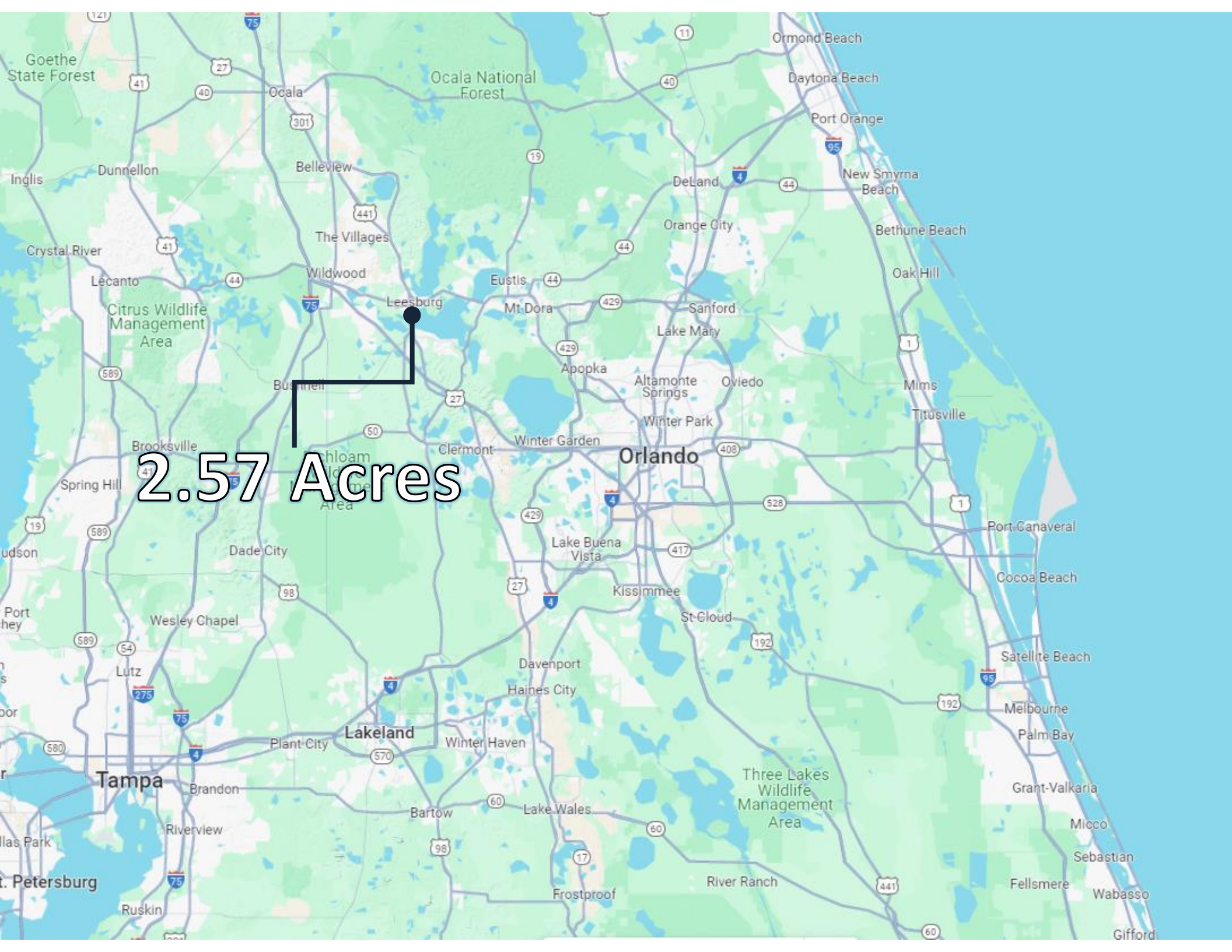

2.57 Acres



## Population

	1 mile	3 mile	5 mile
2010 Population	6,237	22,390	40,318
2023 Population	6,770	28,700	55,575
2028 Population Projection	7,233	31,228	60,670
Annual Growth 2010-2023	0.7%	2.2%	2.9%
Annual Growth 2023-2028	1.4%	1.8%	1.8%
Median Age	39	45	50.6
Bachelor's Degree or Higher	12%	16%	21%
U.S. Armed Forces	11	56	63

## Income

	1 mile	3 mile	5 mile
Avg Household Income	\$56,828	\$56,359	\$65,410
Median Household Income	\$36,660	\$42,706	\$48,616
< \$25,000	747	3,281	5,348
\$25,000 - 50,000	830	3,700	7,095
\$50,000 - 75,000	465	2,780	4,894
\$75,000 - 100,000	270	937	2,447
\$100,000 - 125,000	102	601	1,470
\$125,000 - 150,000	41	305	933
\$150,000 - 200,000	95	462	1,347
\$200,000+	79	231	673

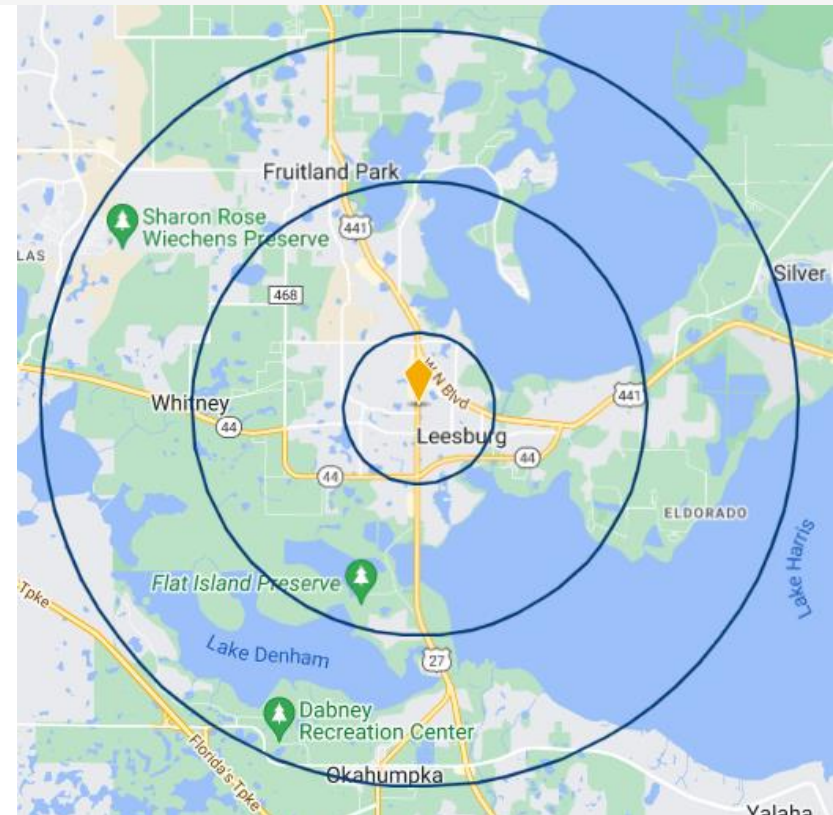

EXCLUSIVELY LISTED BY

## Mark Williams

Senior Associate

2121 S Hiawasse Rd Suite 100 Orlando, FL 32835

Mobile: (407) 406-3187 | Office: (407) 440-4900

Mark.WilliamsRE@outlook.com

License: FL #SL3394984



### NON-ENDORSEMENT & DISCLAIMER NOTICE

**CONFIDENTIALITY & DISCLAIMER** The information contained in the following Marketing Brochure is proprietary and strictly confidential. It is intended to be reviewed only by the party receiving it from Preferred Real Estate Brokers and should not be made available to any other person or entity without the written consent of Preferred Real Estate Brokers. This Marketing Brochure has been prepared to provide summary, unverified information to prospective purchasers or lessees, and to establish only a preliminary level of interest in the subject property. The information contained herein is not a substitute for a thorough due diligence investigation. Preferred Real Estate Brokers has not made any investigation, and makes no warranty or representation, with respect to the income or expenses for the subject property, the future projected financial performance of the property, the size and square footage of the property and improvements, the presence or absence of contaminating substances, PCB's or asbestos, the compliance with State and Federal regulations, the physical condition of the improvements thereon, or the financial condition or business prospects of any tenant, or any tenant's plans or intentions to continue its occupancy of the subject property. The information contained in this Marketing Brochure has been obtained from sources we believe to be reliable; however, Preferred Real Estate Brokers has not verified, and will not verify, any of the information contained herein, nor has Preferred Real Estate Brokers conducted any investigation regarding these matters and makes no warranty or representation whatsoever regarding the accuracy or completeness of the information provided. All potential buyers or lessees must take appropriate measures to verify all of the information set forth herein. Preferred Real Estate Brokers.

**NON-ENDORSEMENT NOTICE** Preferred Real Estate Brokers is not affiliated with, sponsored by, or endorsed by any commercial tenant or lessee identified in this marketing package. The presence of any corporation's logo or name is not intended to indicate or imply affiliation with, or sponsorship or endorsement by, said corporation of Preferred Real Estate Brokers, its affiliates or subsidiaries, or any agent, product, service, or commercial listing of Preferred Real Estate Brokers, and is solely included for the purpose of providing tenant lessee information about this listing to prospective customers.

BOR: Jose Fleming Lic # BK3398881