

± 5,160 SF Industrial Warehouse **FOR LEASE**

14288 Central Ave., Suite A
Chino, CA



Property Features

- ±5,160 SF Industrial Warehouse
- ±1,500 SF Office Area
- 16' - 18' Warehouse Clearance
- 1 Ground Level Door
- 8 Reserved Parking Stalls
- 400 A, 120/208 V Power (verify)
- Central Avenue Frontage
- Access to 60 & 71 Freeways



Voit

REAL ESTATE SERVICES

3280 E. Guasti Road Suite 100, Ontario, CA 91761

John Viscounty

Senior Vice President | Partner

(909) 545-8002 | jviscounty@voitco.com

License # 02028915

Cory Smith

Associate

(909) 545-8014 | csmith@voitco.com

License # 02195878

www.VoitCo.com

± 5,160 SF Industrial Warehouse

FOR LEASE

14288 Central Ave., Suite A
Chino, CA

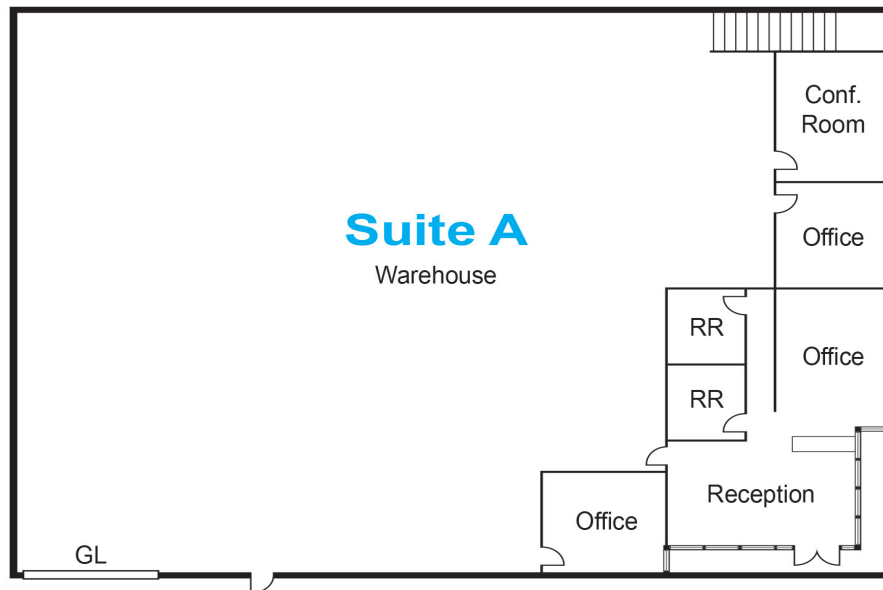
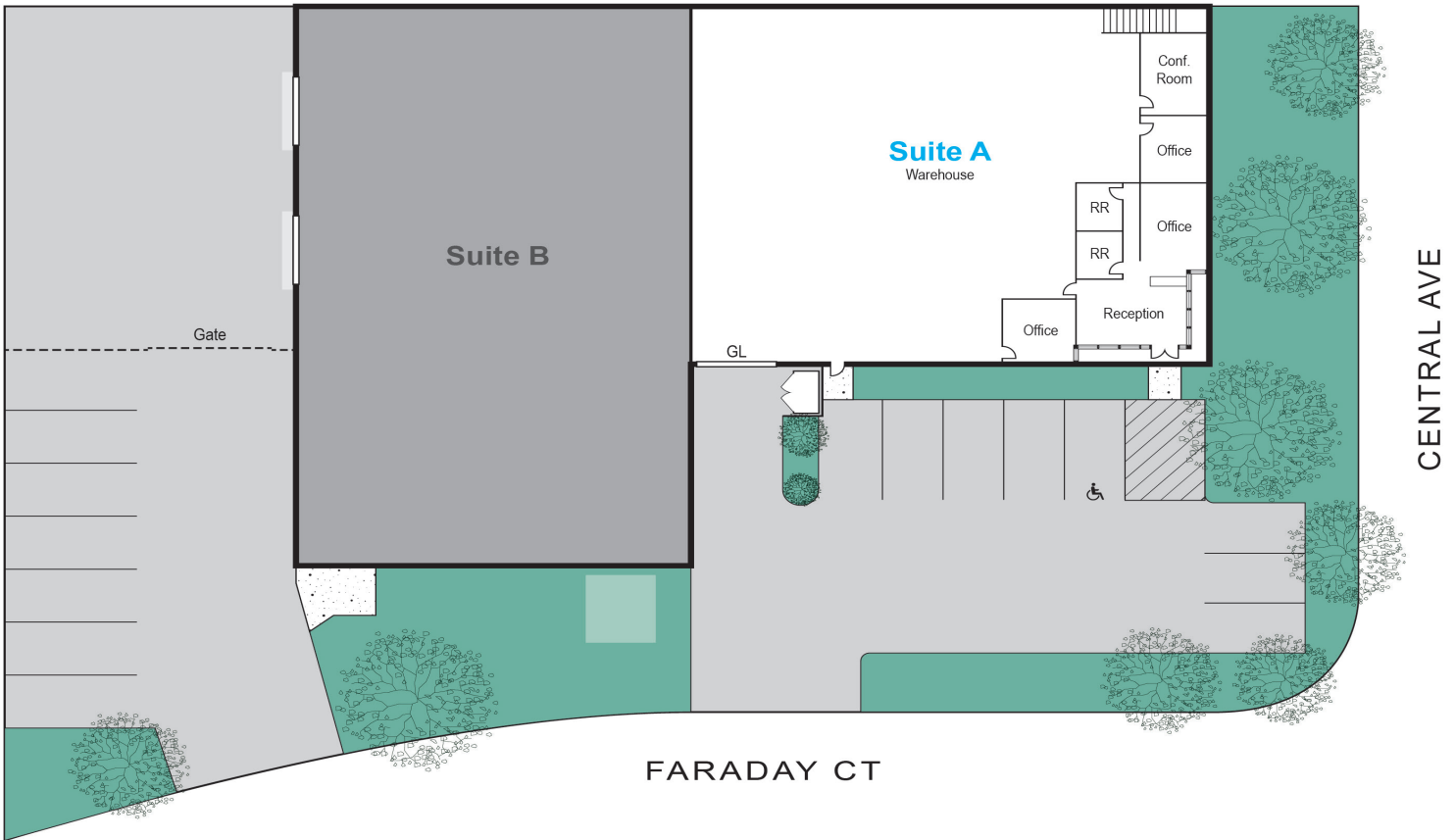

Voit

REAL ESTATE SERVICES

3280 E. Guasti Road Suite 100, Ontario, CA 91761

John Viscounty

Senior Vice President | Partner

(909) 545-8002 | jviscounty@voitco.com

License # 02028915

Cory Smith

Associate

(909) 545-8014 | csmith@voitco.com

License # 02195878

www.VoitCo.com

± 5,160 SF Industrial Warehouse

FOR LEASE

14288 Central Ave., Suite A
Chino, CA

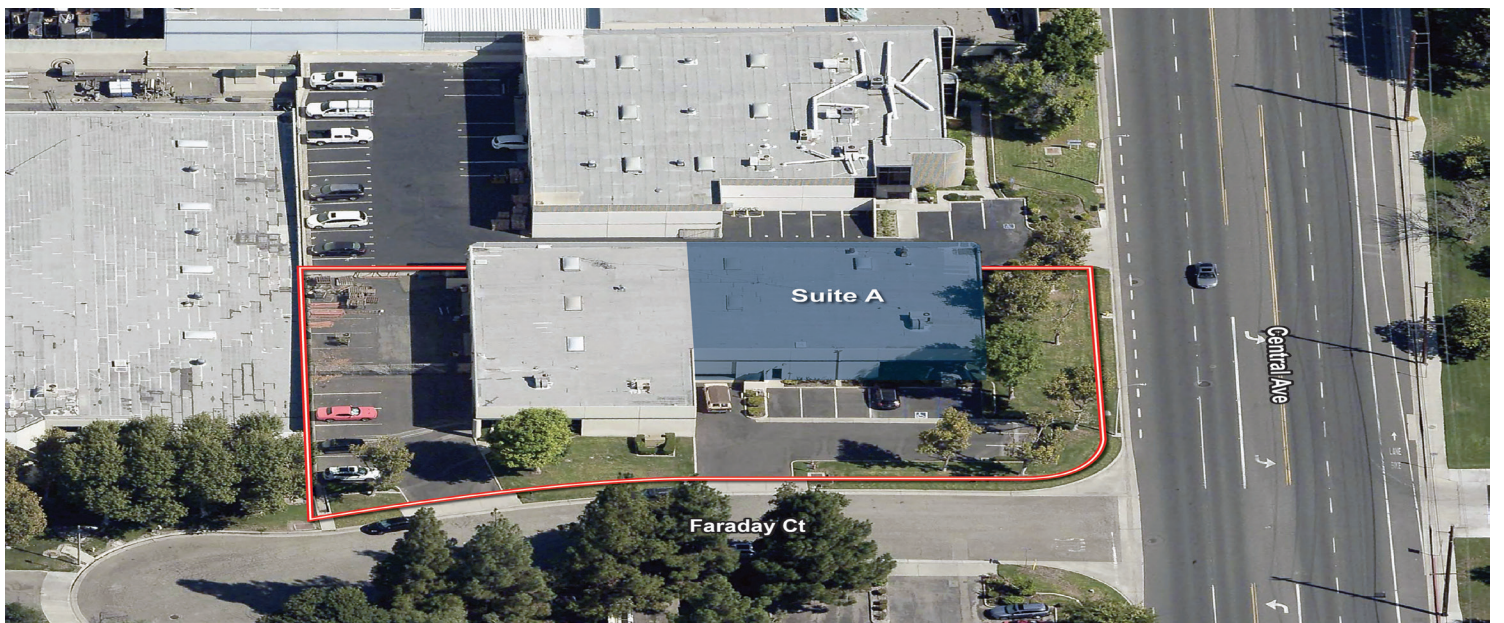

Voit

REAL ESTATE SERVICES

3280 E. Guasti Road Suite 100, Ontario, CA 91761

John Viscounty

Senior Vice President | Partner

(909) 545-8002 | jviscounty@voitco.com

License # 02028915

Cory Smith

Associate

(909) 545-8014 | csmith@voitco.com

License # 02195878

www.VoitCo.com