

# Suites for Lease

449 Eisenhower Boulevard, Harrisburg, PA 17111



## PROPERTY SUMMARY



## OFFERING SUMMARY

<b>Building SF:</b>	90,000 SF
<b>Lease Rate:</b>	\$15.95 / SF
<b>Lot Size:</b>	8.54 Acres
<b>Parking:</b>	On Site
<b>Zoning:</b>	Manufacturing Limited

## Property Description

Introducing a prime opportunity to lease office space in the heart of Harrisburg’s East Shore, offering a range of options from  $\pm$  4,600 SF up to  $\pm$  21,400 SF. This conveniently located property provides exceptional exposure to major thoroughfares including I-83, I-283, Route 322, Paxton Street, and Eisenhower Boulevard. Adjacent to the TecPort Business Center and situated at the intersection of I-83 & I-283, this space boasts ample on-site parking, excellent visibility, and flexible lease terms. Exceptional signage opportunities available.

# Suites for Lease

449 Eisenhower Boulevard, Harrisburg, PA 17111



## AVAILABILITY

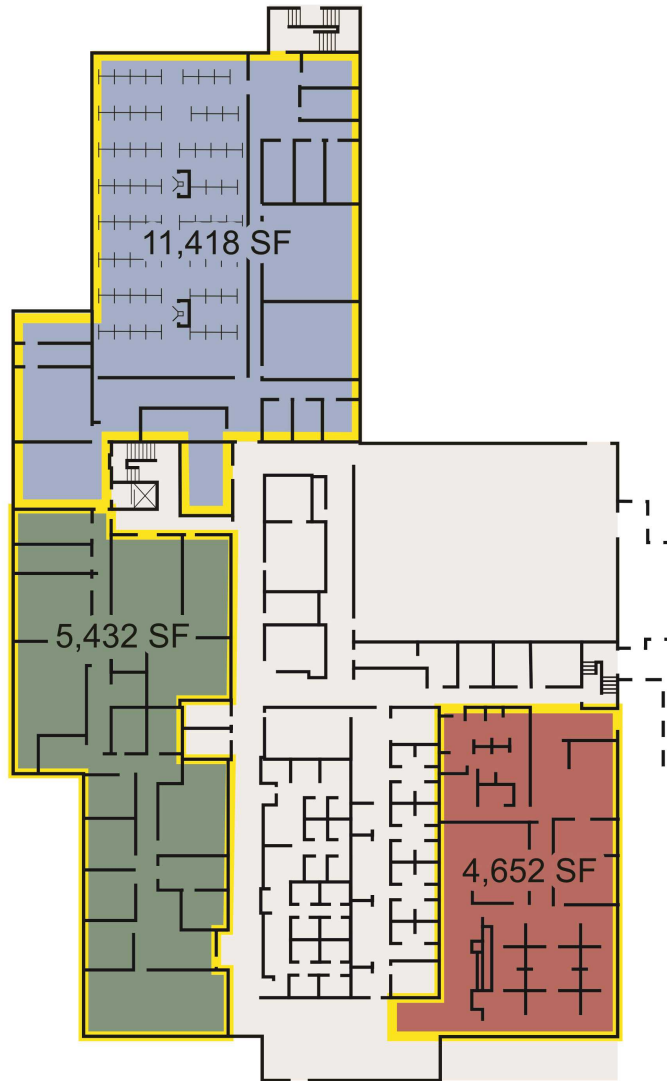

## For Lease

Suite	Size	Rate
# 1	4,652	\$15.95 psf/yr
# 2	5,423	\$15.95 psf/yr
# 3	11,418	\$15.95 psf/yr

## Highlights

- Ample on-site parking
- Excellent visibility
- Flexible terms
- Easy access



THOMAS POSAVEC, SIOR, SIOR  
Sr Vice President  
(717) 731-1990  
tposavec@landmarkcr.com

[www.LandmarkCR.com](http://www.LandmarkCR.com)

TCN  
WORLDWIDE  
REAL ESTATE SERVICES



# Suites for Lease

449 Eisenhower Boulevard, Harrisburg, PA 17111



## ADDITIONAL PHOTOS

### EXCELLENT SIGNAGE & VISIBILITY



### MODERN FINISHES



### EFFICIENT BREAKROOM



### FITNESS CENTER



### CONFERENCE ROOM



### OPEN WORKSPACE



THOMAS POSAVEC, SIOR, SIOR  
Sr Vice President  
(717) 731-1990  
tposavec@landmarkcr.com

[www.LandmarkCR.com](http://www.LandmarkCR.com)





# Suites for Lease

449 Eisenhower Boulevard, Harrisburg, PA 17111



## LOCATION



THOMAS POSAVEC, SIOR, SIOR  
Sr Vice President  
(717) 731-1990  
tposavec@landmarkcr.com

[www.LandmarkCR.com](http://www.LandmarkCR.com)





# Suites for Lease

449 Eisenhower Boulevard, Harrisburg, PA 17111



## DEMOGRAPHICS

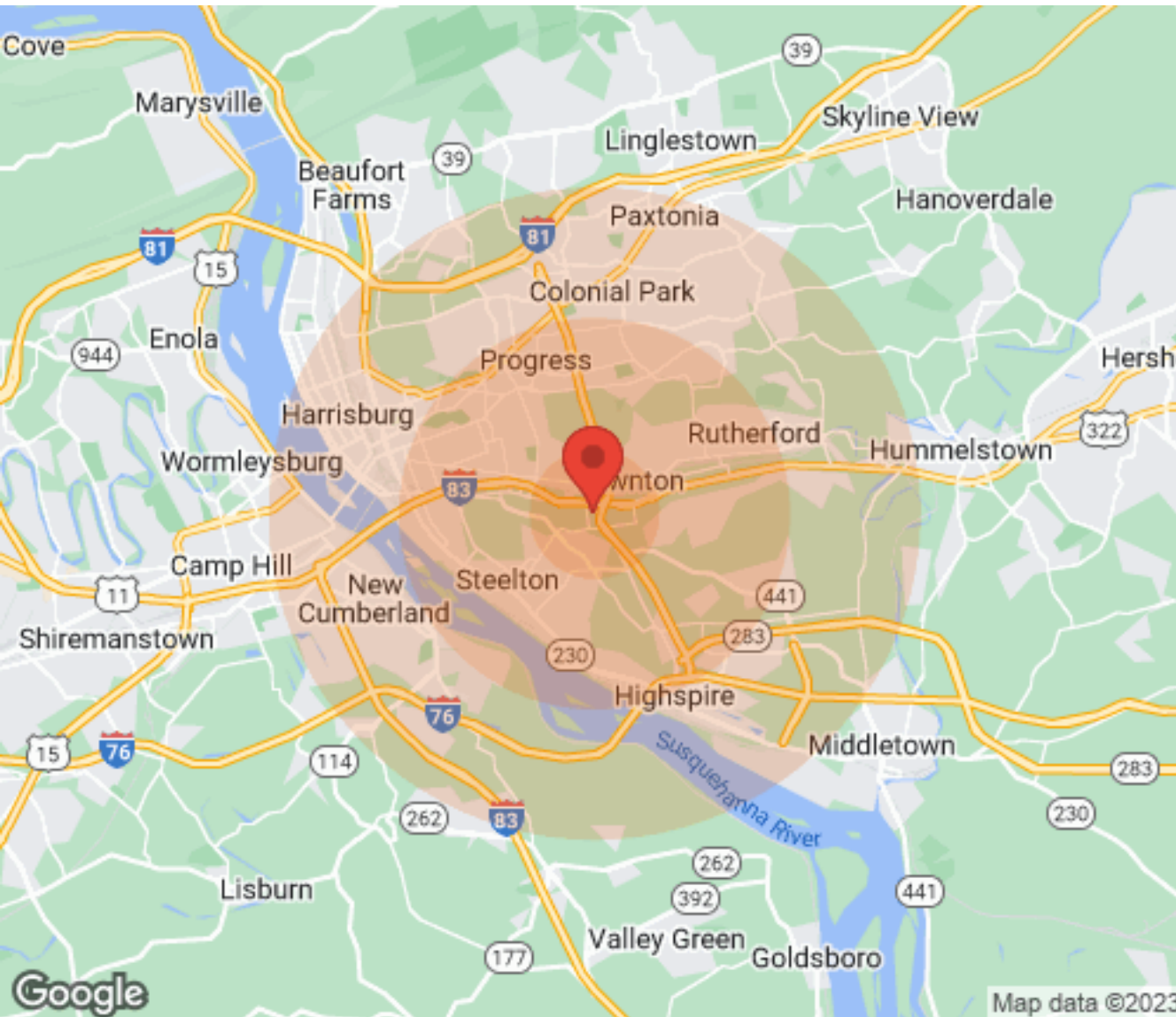

Population	1 Mile	3 Miles	5 Miles
Male	2,072	34,449	76,893
Female	2,488	37,113	82,753
Total Population	4,560	71,562	159,646

Age	1 Mile	3 Miles	5 Miles
Ages 0-14	847	16,202	31,937
Ages 15-24	552	9,788	20,122
Ages 25-54	1,593	27,345	61,767
Ages 55-64	606	8,276	20,343
Ages 65+	962	9,951	25,477

Race	1 Mile	3 Miles	5 Miles
White	3,429	38,278	103,984
Black	769	23,644	40,615
Am In/AK Nat	N/A	51	78
Hawaiian	N/A	31	31
Hispanic	390	11,402	17,032
Multi-Racial	674	15,756	23,826

Income	1 Mile	3 Miles	5 Miles
Median	\$49,462	\$39,950	\$46,180
< \$15,000	242	4,788	9,710
\$15,000-\$24,999	236	3,483	7,309
\$25,000-\$34,999	229	3,550	7,971
\$35,000-\$49,999	414	4,771	10,399
\$50,000-\$74,999	427	4,676	12,316
\$75,000-\$99,999	248	3,799	9,669
\$100,000-\$149,999	149	2,572	7,206
\$150,000-\$199,999	60	689	1,758
> \$200,000	10	201	940

Housing	1 Mile	3 Miles	5 Miles
Total Units	2,341	33,874	78,347
Occupied	2,218	30,814	71,284
Owner Occupied	1,493	17,203	41,619
Renter Occupied	725	13,611	29,665
Vacant	123	3,060	7,063

THOMAS POSAVEC, SIOR, SIOR  
Sr Vice President  
(717) 731-1990  
tposavec@landmarkcr.com

[www.LandmarkCR.com](http://www.LandmarkCR.com)

TCN  
WORLDWIDE  
REAL ESTATE SERVICES

## DISCLAIMER

All materials and information received or derived from Landmark Commercial Realty its directors, officers, agents, advisors, affiliates and/or any third party sources are provided without representation or warranty as to completeness, veracity, or accuracy, condition of the property, compliance or lack of compliance with applicable governmental requirements, developability or suitability, financial performance of the property, projected financial performance of the property for any party's intended use or any and all other matters.

Neither Landmark Commercial Realty its directors, officers, agents, advisors, or affiliates makes any representation or warranty, express or implied, as to accuracy or completeness of the any materials or information provided, derived, or received. Materials and information from any source, whether written or verbal, that may be furnished for review are not a substitute for a party's active conduct of its own due diligence to determine these and other matters of significance to such party. Landmark Commercial Realty will not investigate or verify any such matters or conduct due diligence for a party unless otherwise agreed in writing.

EACH PARTY SHALL CONDUCT ITS OWN INDEPENDENT INVESTIGATION AND DUE DILIGENCE.

Any party contemplating or under contract or in escrow for a transaction is urged to verify all information and to conduct their own inspections and investigations including through appropriate third-party independent professionals selected by such party. All financial data should be verified by the party including by obtaining and reading applicable documents and reports and consulting appropriate independent professionals. Landmark Commercial Realty makes no warranties and/or representations regarding the veracity, completeness, or relevance of any financial data or assumptions. Landmark Commercial Realty does not serve as a financial advisor to any party regarding any proposed transaction.

All data and assumptions regarding financial performance, including that used for financial modeling purposes, may differ from actual data or performance. Any estimates of market rents and/or projected rents that may be provided to a party do not necessarily mean that rents can be established at or increased to that level. Parties must evaluate any applicable contractual and governmental limitations as well as market conditions, vacancy factors and other issues in order to determine rents from or for the property. Legal questions should be discussed by the party with an attorney. Tax questions should be discussed by the party with a certified public accountant or tax attorney. Title questions should be discussed by the party with a title officer or attorney. Questions regarding the condition of the property and whether the property complies with applicable governmental requirements should be discussed by the party with appropriate engineers, architects, contractors, other consultants, and governmental agencies. All properties and services are marketed by Landmark Commercial Realty in compliance with all applicable fair housing and equal opportunity laws.