

21402 84TH AVENUE S.
KENT, WASHINGTON

KENT EAST CORPORATE PARK

BUILDING 1



FOR LEASE
6,366 SF

CBRE

AVAILABLE WITH 30-DAYS NOTICE

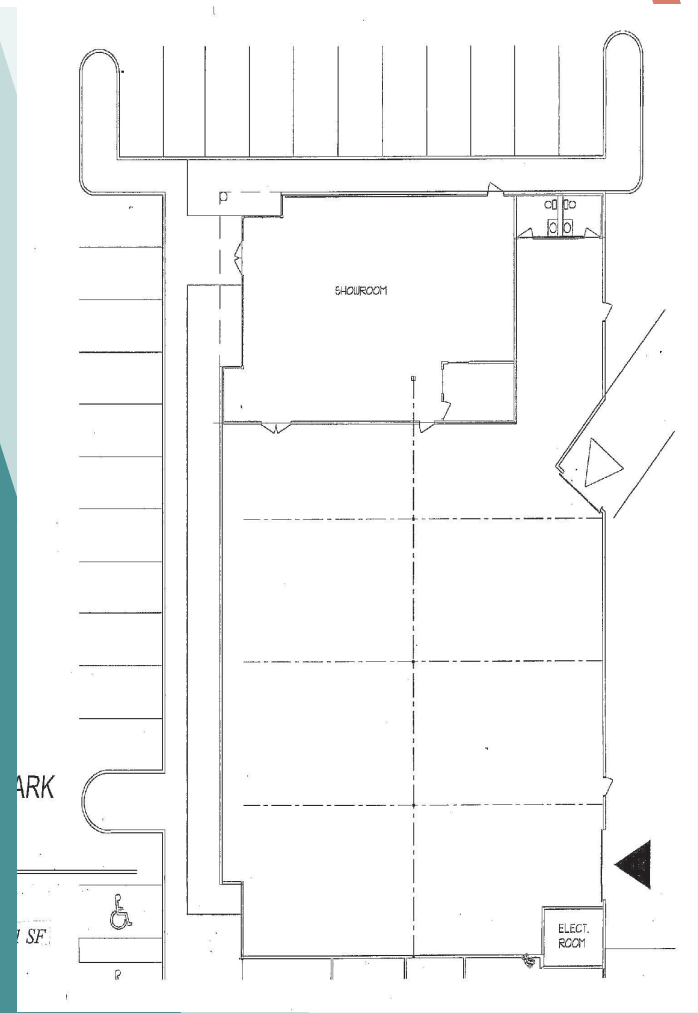

PROPERTY FEATURES



Available with 30-days notice



6,366 SF Shell
2,901 SF Office



1 Dock High Door
1 Grade Level Door



East Valley Highway
exposure



Easy access to
Hwy-167

KENT EAST CORPORATE PARK

BUILDING 1

21402 84TH AVENUE S.
KENT, WASHINGTON

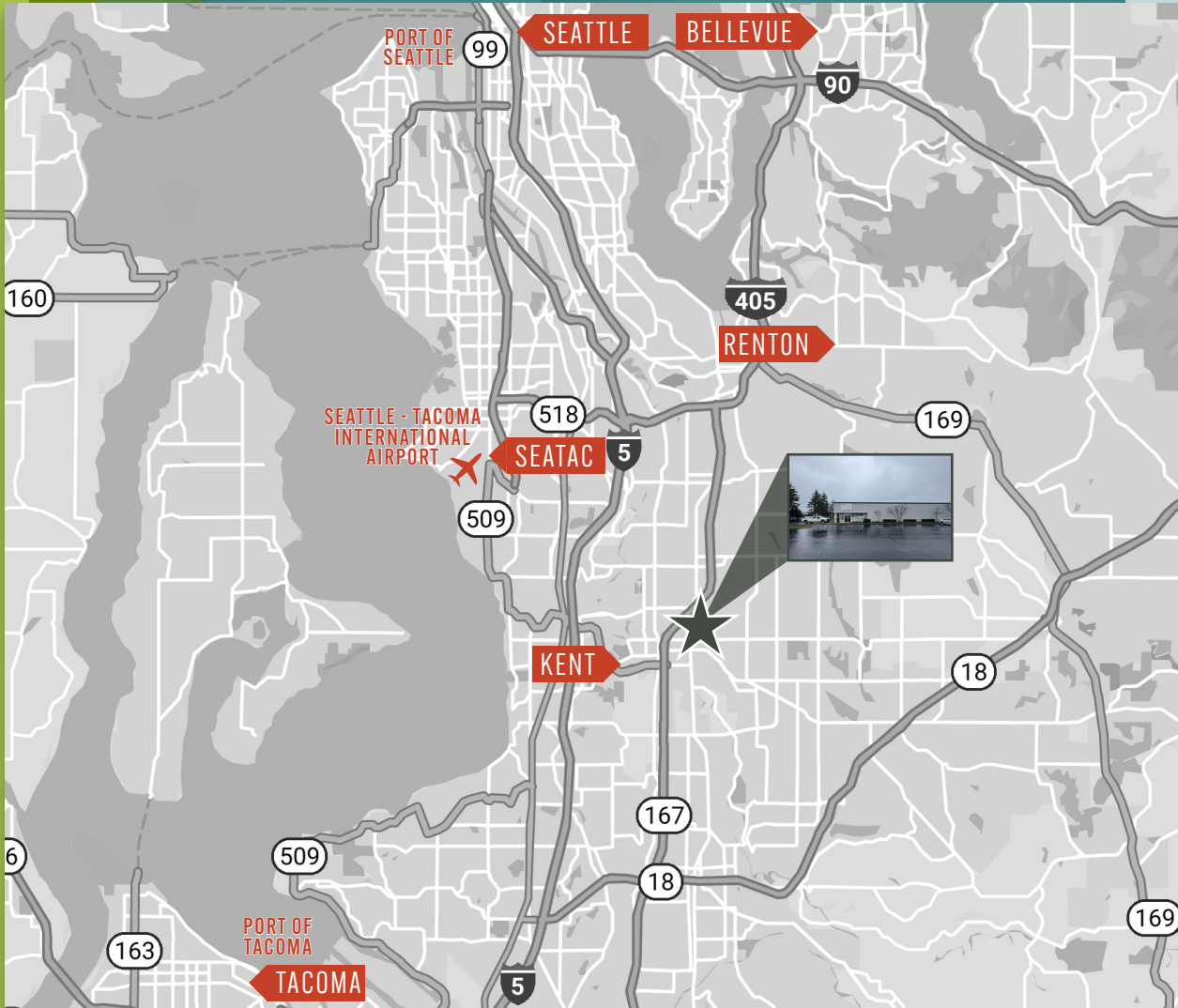

JOHN GILLILAND
SENIOR VICE PRESIDENT
+1 206 442 2745
john.gilliland@cbre.com

ANDREW STARK
EXECUTIVE VICE PRESIDENT
+1 206 442 2746
andrew.stark@cbre.com

ASKING RATES:
Call brokers for Rates

© 2025 CBRE, Inc. All rights reserved. This information has been obtained from sources believed reliable, but has not been verified for accuracy or completeness. You should conduct a careful, independent investigation of the property and verify all information. Any reliance on this information is solely at your own risk. CBRE and the CBRE logo are service marks of CBRE, Inc. All other marks displayed on this document are the property of their respective owners, and the use of such logos does not imply any affiliation with or endorsement of CBRE. Photos herein are the property of their respective owners. Use of these images without the express written consent of the owner is prohibited. 2.19.25MK

CBRE