

ONE OF A KIND SUBLEASE

Castalia at Meadowmont | 301 W. Barbee Chapel Road, Suite 200 | Chapel Hill, NC 27517



Square Footage Available: **8,139 RSF or 16,761 RSF or 24,900 RSF**

Sublease Expiration Date: **July 31, 2026**

Rental Rate: **\$25.00/SF Full Service**

Contact Our Office **919.821.7880**

Braxton Anthony, SIOR

banthony@richcommercialrealty.com

A UNIQUE SUBLEASE SPACE WITH A HOSPITABLE FEEL



RCR

Contact **Braxton Anthony, SIOR**

Call **919.821.7880**

Email **banthony@richcommercialrealty.com**

SPACE FEATURES

* Furniture Negotiable



Contact **Braxton Anthony, SIOR**

Call **919.821.7880**

Email banthony@richcommercialrealty.com

SPACE FEATURES

* Furniture Negotiable



Contact **Braxton Anthony, SIOR**

Call **919.821.7880**

Email **banthony@richcommercialrealty.com**

FLOORPLAN



SECOND FLOOR SPACES

- Option A 8,139 RSF
- Option B 16,761 RSF
- Option C 24,900 RSF (FULL FLOOR)

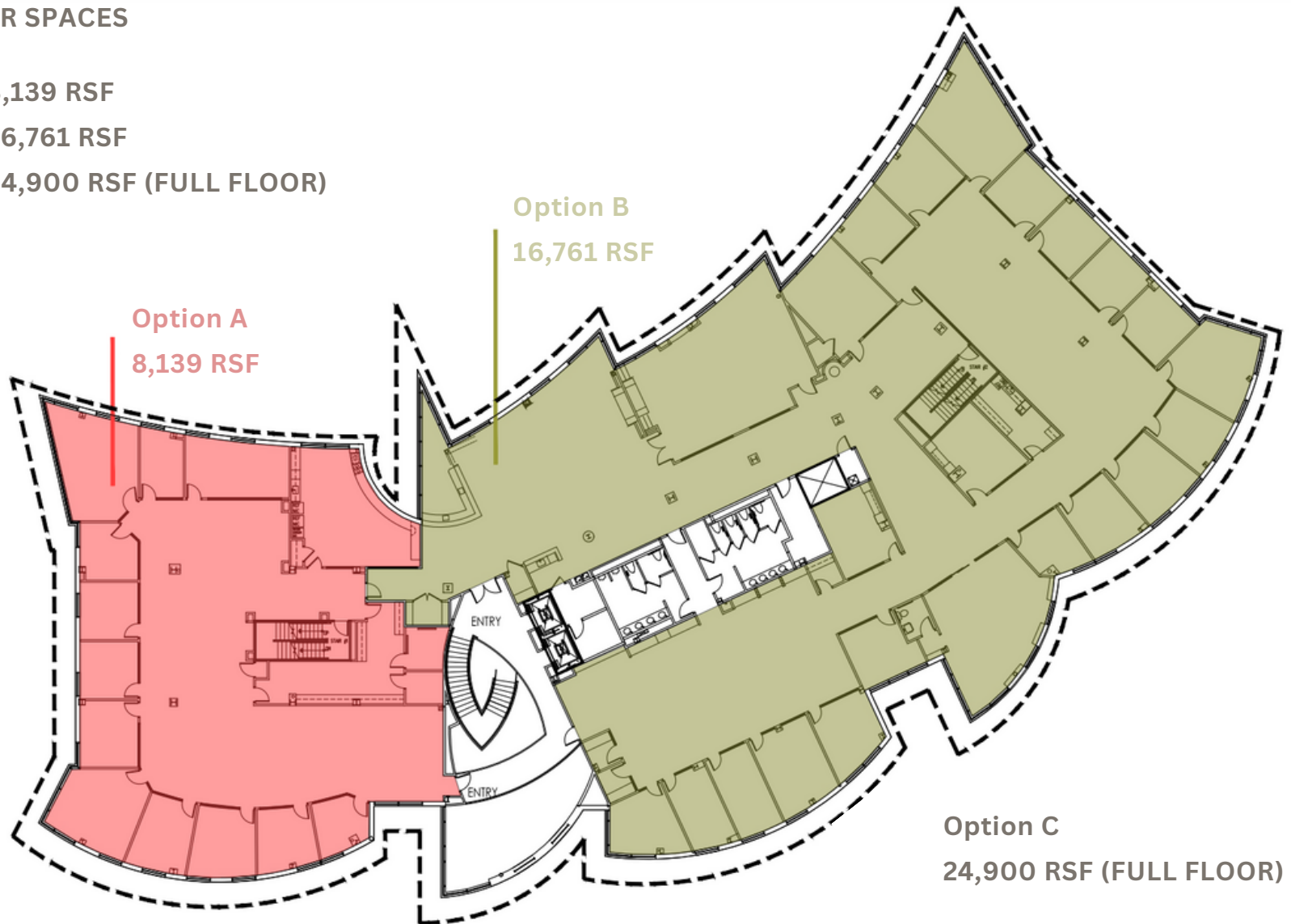

LOCATION OVERVIEW



301 W. Barbee Chapel Road, Suite 200 | Chapel Hill, NC 27517

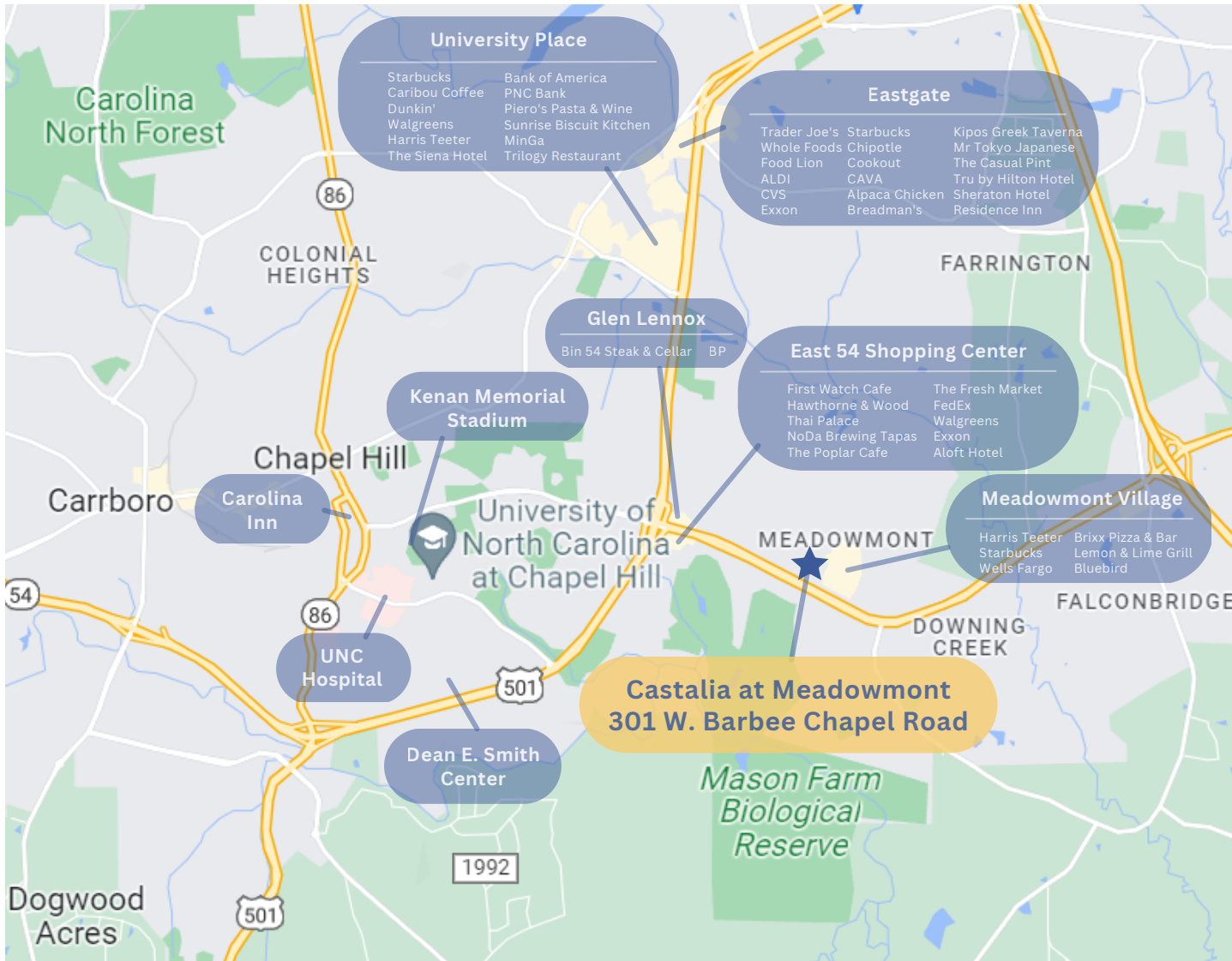

Castalia at Meadowmont

- Class A office complex
- On-site ample parking
- Prime Chapel Hill location
- Close proximity to many restaurants and retail

Contact **Braxton Anthony, SIOR**

Call **919.821.7880**

Email **banthony@richcommercialrealty.com**



BRAXTON ANTHONY, SIOR

Principal
(919) 896-2145 Cell
banthony@richcommercialrealty.com

**FOLLOW RCR
ON SOCIAL MEDIA!**



CALL OUR OFFICE
919.821.7880



VISIT OUR WEBSITE
www.richcommercialrealty.com



OFFICE ADDRESS
Rich Commercial Realty
3840 Ed Drive, Suite 108
Raleigh, NC 27612

DISCLAIMER: While we have made every attempt to ensure that the information contained herein is accurate, Rich Commercial Realty, LLC ("RCR") is not responsible for any errors or omissions, or for the results obtained from the use of this information. All information provided herein is provided with no guarantee of completeness, accuracy, or timeliness, and without warranty of any kind, express or implied, including, but not limited to warranties of performance, merchantability and fitness for a particular purpose. We strongly recommend you and/or your advisory team perform a thorough review of the included property to determine its compatibility with your real estate goals and specifications. In no event will RCR, its partners, agents, or employees be liable to you or anyone else for any decision made or action taken in reliance on the information herein.