

# 511

WOODWARD

Capital One café

CBRE

THE  
ELIA  
GROUP



# 511 WELCOME TO

Come join Capital One Cafe at 511 Woodward - Detroit's premier office building located in the heart of the CBD.

## HIGH-END ENVIRONMENT



**Adjacent to Campus Martius Park and downtown amenities**



**Capital One Cafe on site**



**High Ceilings w/ Floor to Ceilings Windows**



**Rectangular 7,600 RSF Floor Plates**



**Easy Access to Area Freeways**









Explore in 3D

SUITE 300 - 7,600 RSF

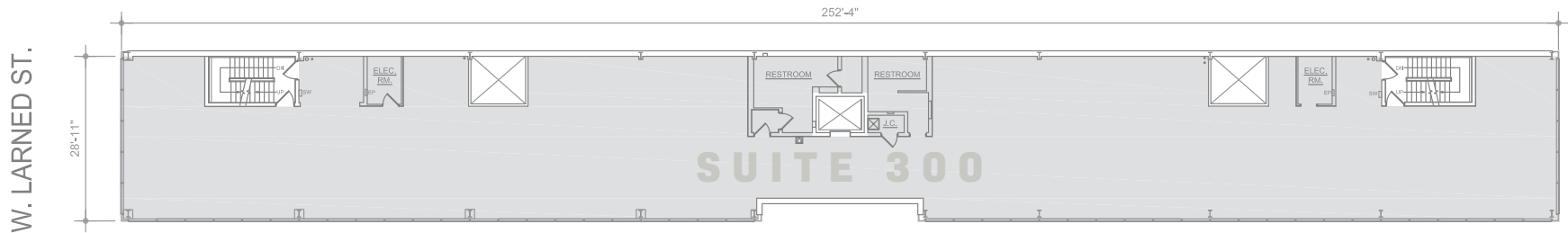

Explore in 3D

SUITE 400 - 7,600 RSF

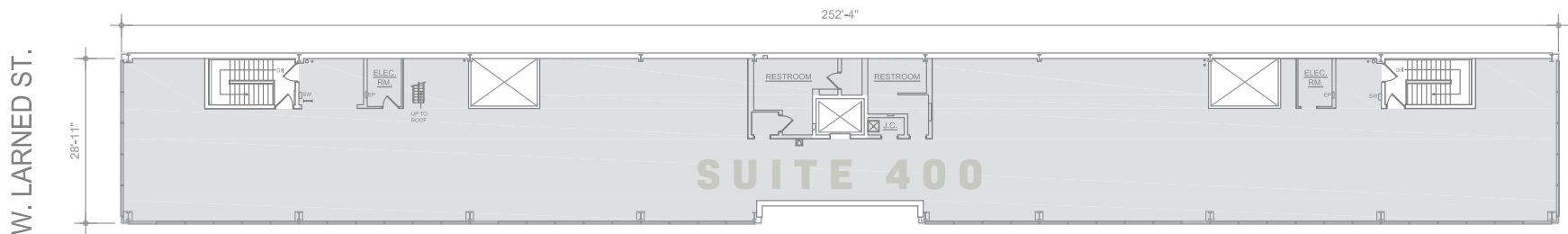





## VIBRANT LOCATION



Closely located to incredible downtown amenities, with a Walk Score of 97/100...a “walker’s paradise”!



Steps from Campus Martius Park



## VIBRANT LOCATION







## For More Information, Contact:

### **Brendan George**

Senior Vice President  
+1 248 351 2039  
brendan.george@cbre.com

### **Jasper Hanifi**

Senior Associate  
+1 248 351 2020  
jasper.hanifi@cbre.com

<https://511woodward.com/>

©2023 CBRE, Inc. All rights reserved. This information has been obtained from sources believed reliable, but has not been verified for accuracy or completeness. You should conduct a careful, independent investigation of the property and verify all information. Any reliance on this information is solely at your own risk. CBRE and the CBRE logo are service marks of CBRE, Inc. All other marks displayed on this document are the property of their respective owners, and the use of such logos does not imply any affiliation with or endorsement of CBRE. Photos herein are the property of their respective owners. Use of these images without the express written consent of the owner is prohibited.

**CBRE**

THE  
**ELIA**  
GROUP