

Available SF 16,794 SF

Industrial For Lease

Building Size 16,794 SF

Immediate Occupancy



Address: 2416 E 16th St, Los Angeles, CA 90021

Cross Streets: E 16th St/E 15th St

Great Modern Building w/Good Secure Fenced Concrete Yard
 South of Arts District, Immediate Access to 5 & 10 Fwy Ramps & Hub
 Big Ground Level Drive In Doors
 Excellent Lighting & Foil Ceiling
 Good For Garment Manufacturing, Well Distributed Power
 Nice Offices with Large Showroom & Kitchen

Lease Rate/Mo: \$17,634
Lease Rate/SF: \$1.05
Lease Type: Gross
Available SF: 16,794 SF
Minimum SF: 16,794 SF
Prop Lot Size: 0.55 Ac / 23,930 SF
Term: 3-5 Years w/Periodic COLA's
Sale Price: NFS
Sale Price/SF: NFS
Taxes:
Yard: Fenced
Zoning: M3-1-RIO

Sprinklered: No
Clear Height: 18'
GL Doors/Dim: 2 / 20'x14' & 12'x14'
DH Doors/Dim: 0
A: 400 V: 240/240 O: 3 W: 4
Construction Type: Masonry
Const Status/Year Blt: Existing / 1980
Whse HVAC: No
Parking Spaces: 22 / **Ratio:** 1.3:1
Rail Service: No
Specific Use: Manufacturing

Office SF / #: 3,516 SF / 10
Restrooms: 3
Office HVAC: Heat & AC
Finished Ofc Mezz: 280 SF
Include In Available: Yes
Unfinished Mezz: 0 SF
Include In Available: No
Possession: Now
Vacant: Yes
To Show: Call broker
Market/Submarket: CBD
APN#: 5168009010

Listing Company: Dorin Realty Company
Agents: [Mark Whitman 213-627-0007](mailto:MarkWhitman@DorinRealty.com)

Listing #: 40842482 **Listing Date:** 08/01/2024 **FTCF:** CB250N000S300

Notes: Occupied. Property formerly had 100,000 gallon/day discharge capacity. Construction type: Block. All details must be verified.

Mark Whitman
 mwhitman@dorinrealty.com
 213-627-0007

2416 E. 16th Street, Los Angeles, CA 90021

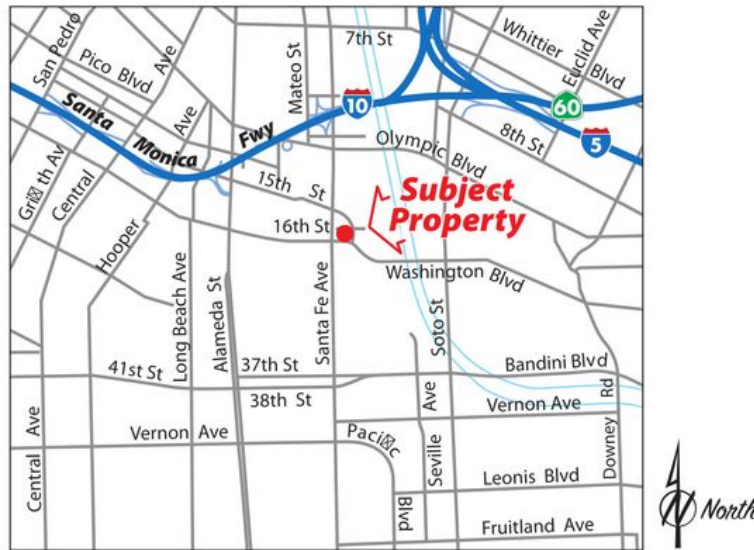
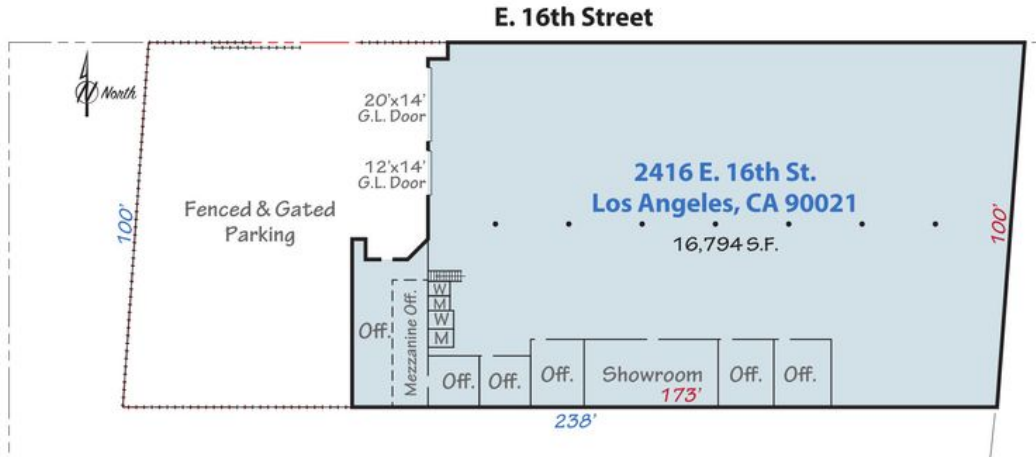



DORIN REALTY
COMPANY, INC.
Lic. No. 00531646

Contact exclusive agent:

Mark Whitman
Lic. No. 00918875
mwhitman@dorinrealty.com
213-627-0007 Ext 124
4555 Pacific Blvd., Vernon, CA 90058-2207

Industrial and Commercial Real Estate Specialists
Since 1959

www.dorinrealty.com

The information contained herein is from sources we believe to be reliable but, we do not guarantee its accuracy. All measurements & dimensions are approximations and are not to scale. Clients are encouraged to verify their accuracy.

Mark Whitman
mwhitman@dorinrealty.com
213-627-0007

AIRCR Powered by **MOODY'S**