



For Lease
Prime Office/Industrial

1803 Tribute Road | Sacramento, CA

±4,995 SF Available
Premium End Cap Space
With rollup door



Exclusively Listed By

Bob Shahlaie
(916) 708-5977
bob@gqnorth.com
DRE# 01441761

Nate Giwoff
(916) 524-6097
nate@gqnorth.com
DRE# 01711995



Call, Text or Email

10018 Fair Oaks Blvd | Fair Oaks, CA 95628

O - 916.678.0880 F - 916.880.5566
www.GQNorth.com info@gqnorth.com

The information provided while not guaranteed has been secured from sources we deem reliable. However, no warranty or representation express or implied is made as to the

Office/Industrial - Spaces Available For Lease



FOR LEASE: ±4,995SF
Asking: \$1.00 PSF NNN

- Zoned C2
- Great visibility
- Monument Signage with Rollup Doors
- Easy Access to Interstate 80

Traffic Count

Tribute Road ±85,000

Annual Household Income

1 Mile Radius: \$68,171

3 Mile Radius: \$62,361

5 Mile Radius: \$60,215

Population

1 Mile Radius: ±14,239

3 Mile Radius: ±134,826

5 Mile Radius: ±369,413

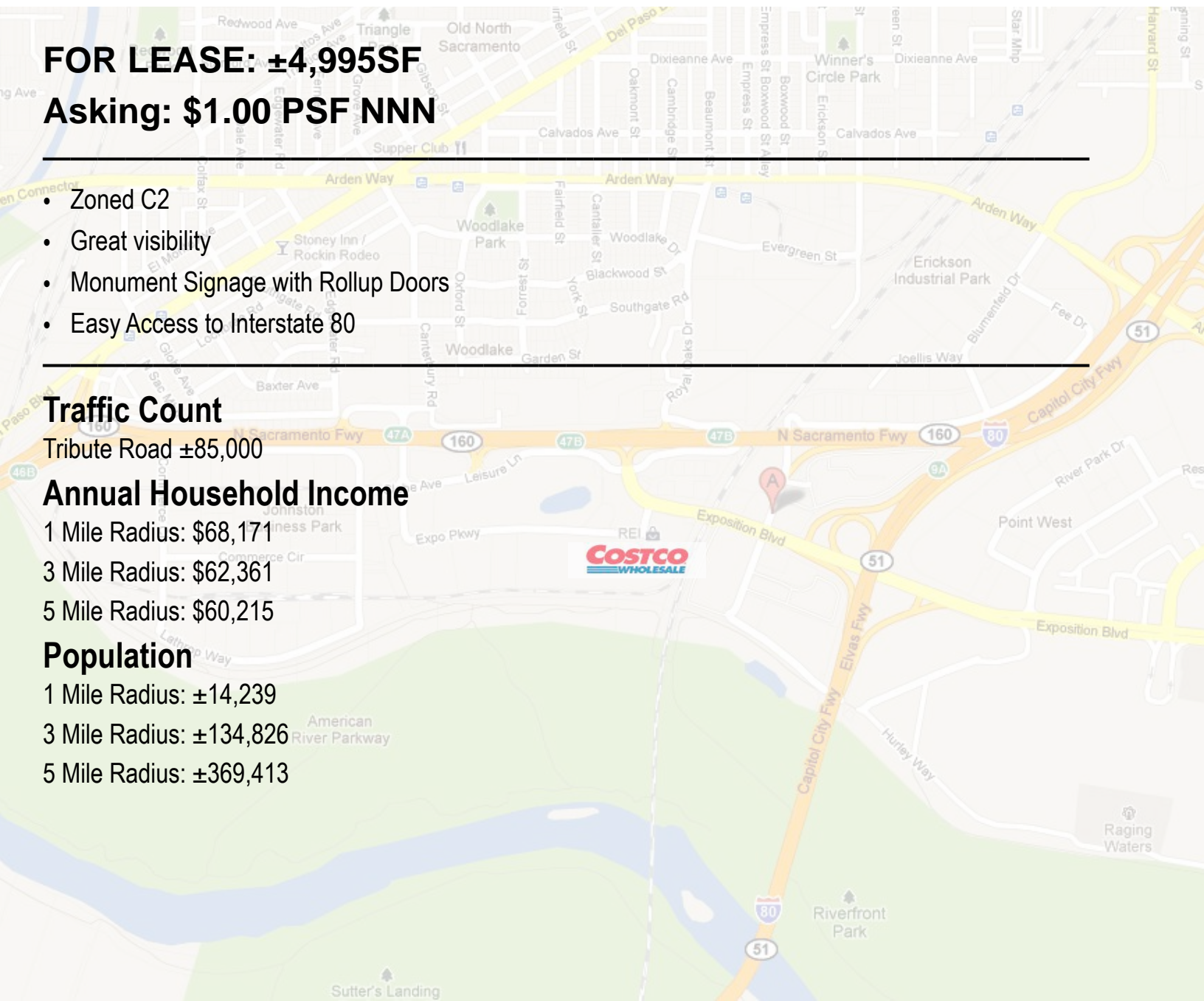

Office/Industrial - Spaces Available For Lease

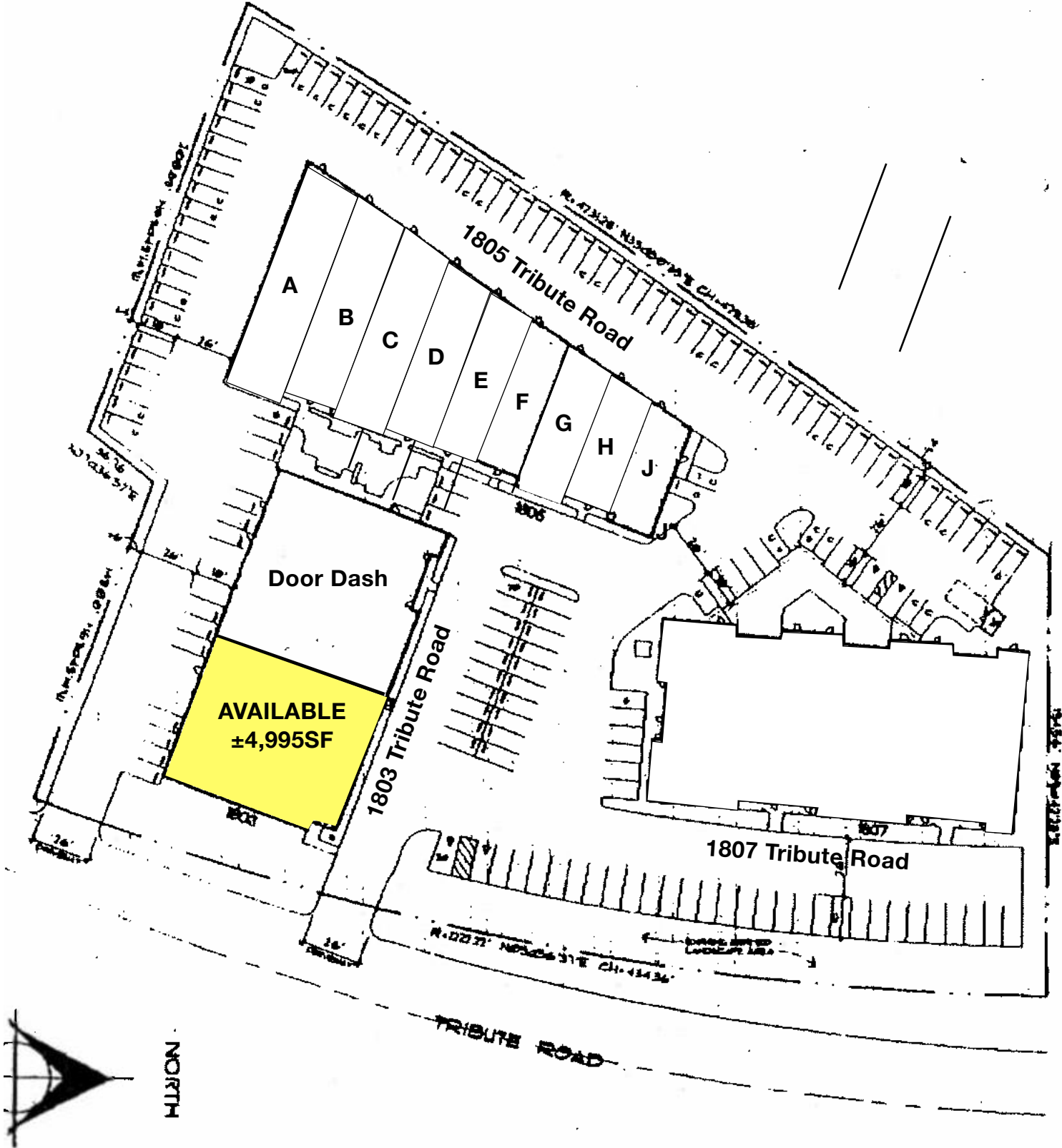

Site Plan Aerial

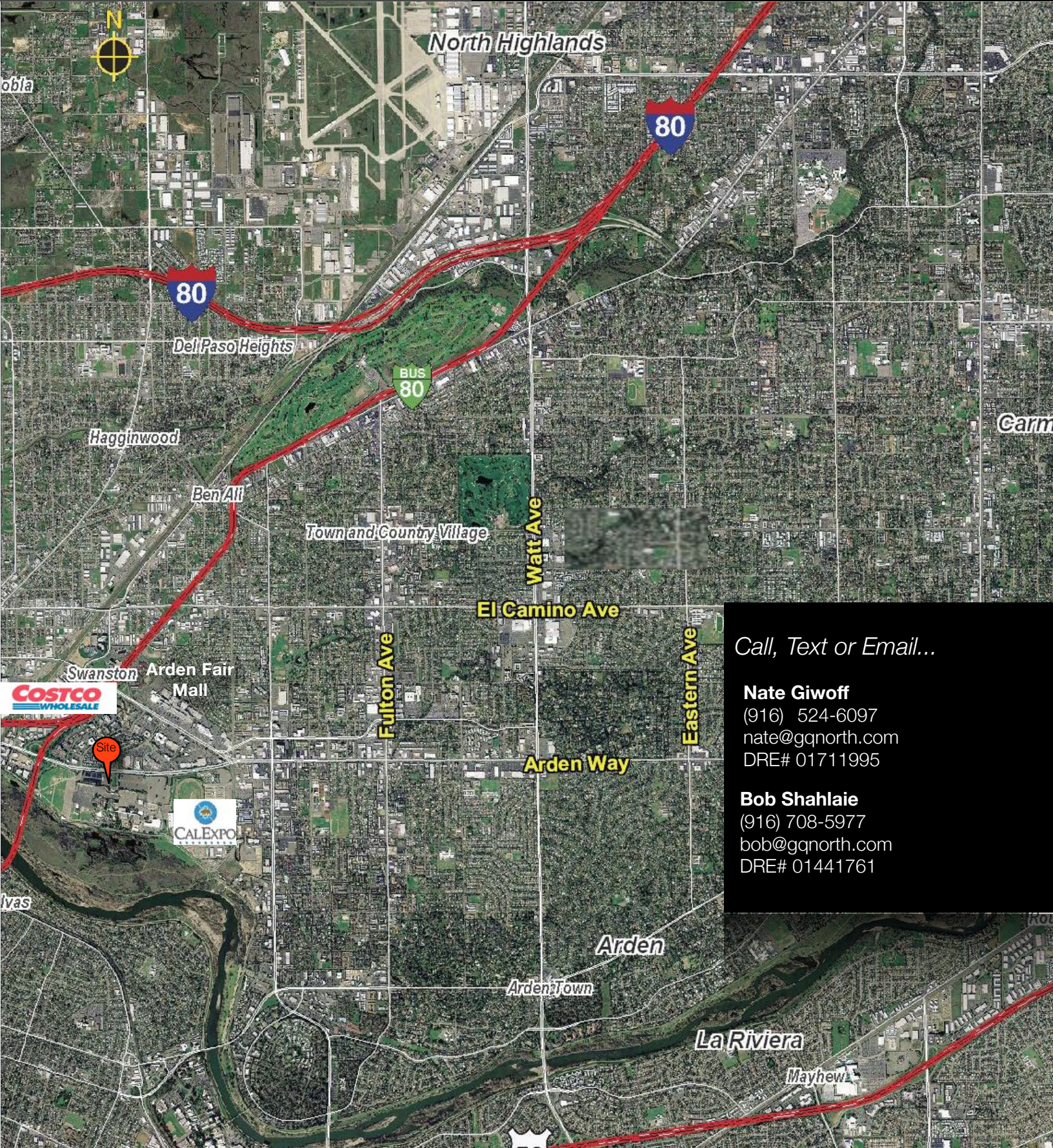

Call, Text or Email...

Nate Giwoff
(916) 524-6097
nate@gqnorth.com
DRE# 01711995

Bob Shahlai
(916) 708-5977
bob@gqnorth.com
DRE# 01441761