

FOR LEASE

Plaza at Bee Cave

3620 Ranch Road 620 S, Bee Cave, Texas 78738



CARR
Development, Inc.



joe@carrdevelopment.com
grant@carrdevelopment.com
5121 Bee Cave Rd., Suite 207
Austin, TX 78746
Phone: (512) 306-1771



PROPERTY INFO

- Join Shipley Donuts, Taco Margarita, and PT Solutions with neighboring businesses including Target, Chick-fil-a and Home Depot.
- Approximately 17,433 square feet of high-end retail and restaurant space.
- Well-positioned for high visibility on Ranch Road 620 at a lighted intersection for easy access.
- Located just down the street from the 1,315,000 square foot Hill Country Galleria in the heart of Bee Cave.

RETAIL SPACE AVAILABLE

- Suite 210: 2,200 square feet
- Suite 140: 1,200 square feet

RATES

- Please call for current lease rates

AREA RETAILERS AND RESTAURANTS



HILL COUNTRY
GALLERIA



PLAZA AT BEE CAVE
SITE PLAN

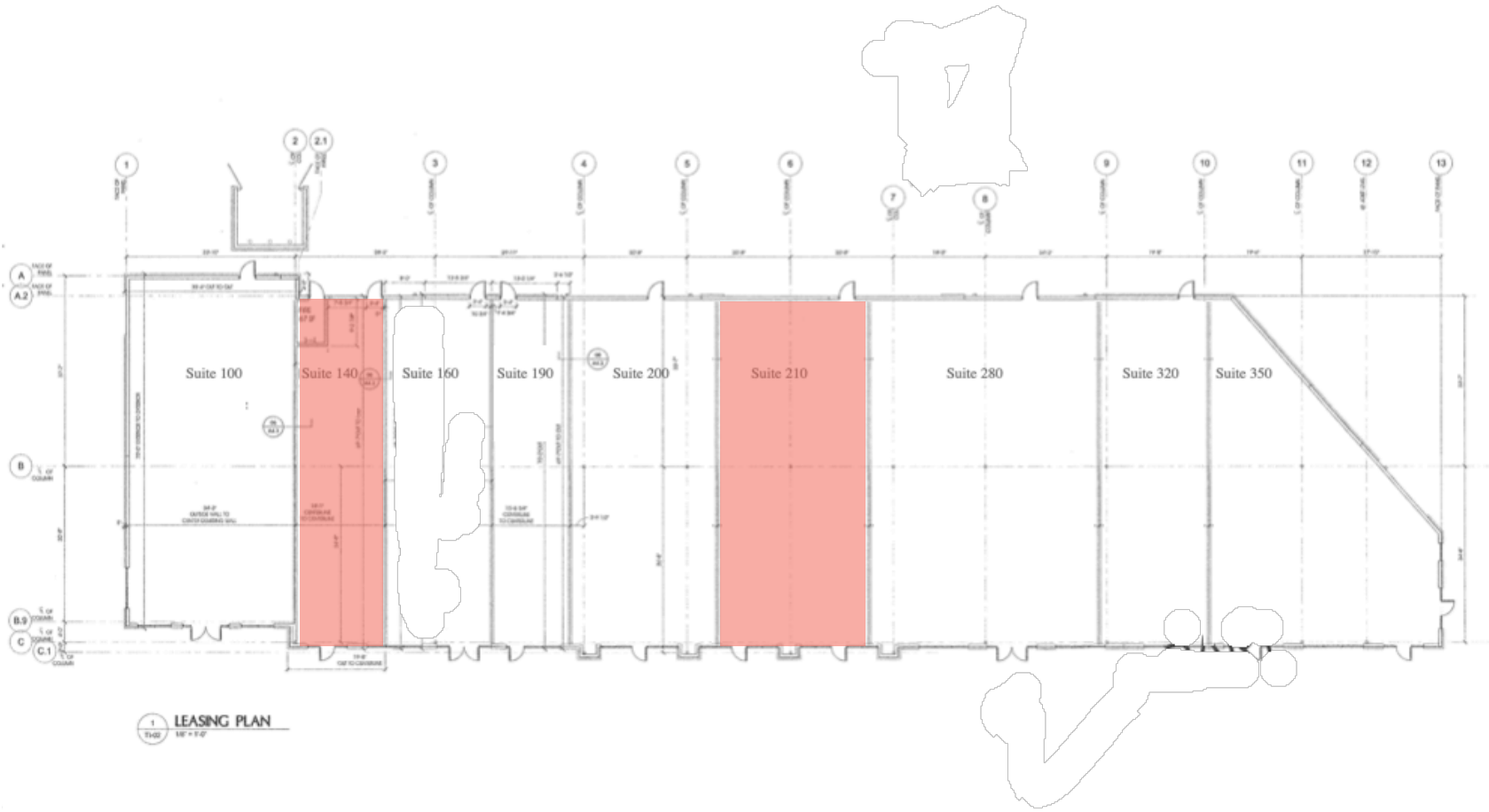

FOR LEASE | PLAZA AT BEE CAVE | 3620 RANCH ROAD 620 S, BEE CAVE, TX 78738



5121 Bee Cave Rd., Ste. 207 Austin, TX 78746

www.carrdevelopment.com

CARR
Development, Inc. 

FOR LEASE | PLAZA AT BEE CAVE | 3620 RANCH ROAD 620 S, BEE CAVE, TX 78738

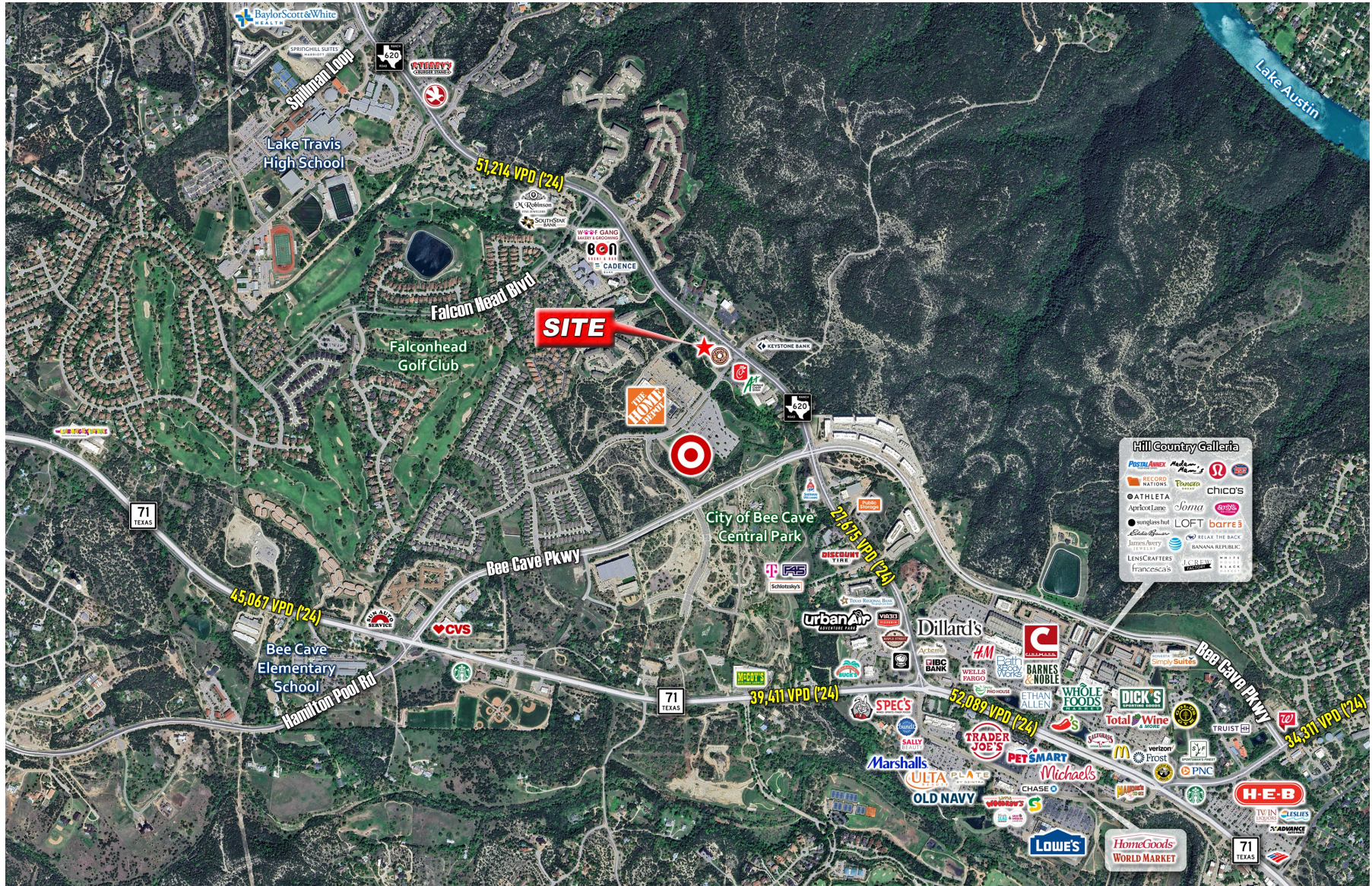



AREA INFO

2024 Demographics

	2 Miles	5 Miles	10 Miles
Total Population	12,009	65,523	239,317
2029 Population	12,888	71,046	263,523
Median Age	42.8	44.9	43.1
Avg HH Income	\$150,458	\$184,343	\$164,543
Households	4,725	23,738	92,030

Traffic counts

Ranch Rd 620 S	51,214 vpd
Bee Cave Pkwy	23,972 vpd



CONTACT US

Phone: (512) 306-1771

joe@carrdevelopment.com

grant@carrdevelopment.com

5121 Bee Cave Rd., Suite 207

Austin, TX 78746

