

FOR LEASE

UP TO 10,000 SF NEW CONSTRUCTION RETAIL AVAILABLE

7976 MAYFIELD ROAD, CHESTERLAND, OH 44026



BUILD TO SUIT

LMI LITIGATION
MANAGEMENT, INC.

Perrino
BUILDERS | REMODELERS | FURNITURE

LOVE'S
LEARNING LOFT

Chesterland Family Experience

CCM
Rental

7,790 SF
Lower Level

KEVIN MOSS
First Vice President
+1 216 363 6453
kevin.moss@cbre.com

CONNOR AMBROSE
Associate
+1 216 535 4730
connor.ambrose@cbre.com

PROPERTY INFO

- + Join Perrino Builders, Litigation Management, Chesterland Family Eyecare, and the Loves Learning Loft!
- + 2 Opportunities Available:
 - Build to Suit up to 10,000 SF (divisible)
 - 7,790 SF lower level, fully built out
- + Brand new construction (2020) available on the high traffic (14,679 VPD) Mayfield Road!
- + Zoned C: General Commercial
- + Ideal for retail, medical, office, service businesses
- + The Chesterland market is a regional retail node servicing a 15+ minute radius with 95,379 people within 15 minutes.
- + Strong average household incomes of \$133,232 in a 15 minute radius

DEMO SNAPSHOT - 15 MINS.



DAYTIME
POPULATION
101,351



2023
POPULATION
95,379



2023
HOUSEHOLDS
40,661



2023
POPULATION 25 & OVER
72,717



2023
AVG. HH INCOME
\$133,232

KEVIN MOSS
First Vice President
+1 216 363 6453
kevin.moss@cbre.com

CONNOR AMBROSE
Associate
+1 216 535 4730
connor.ambrose@cbre.com

CONSTRUCTION PROGRESS - FEBRUARY 12, 2024





LMI LITIGATION
MANAGEMENT, INC.

Perino
BUILDERS | REMODELERS | FURNITURE

LOVE'S
LEARNING LOFT

Chesterland Family | Eye-care
Eyewear

7,790 SF
Lower Level

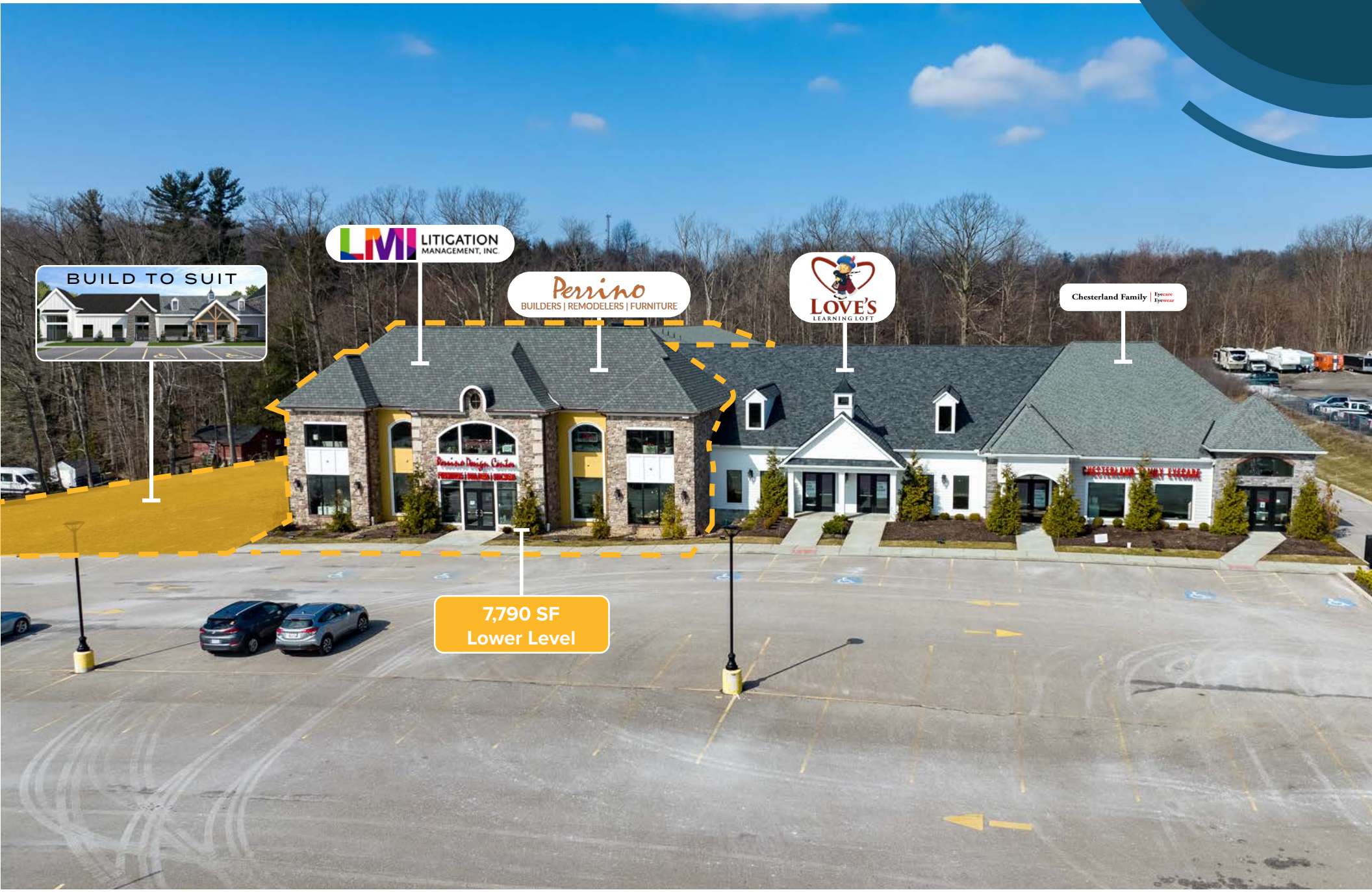



SITE PLAN

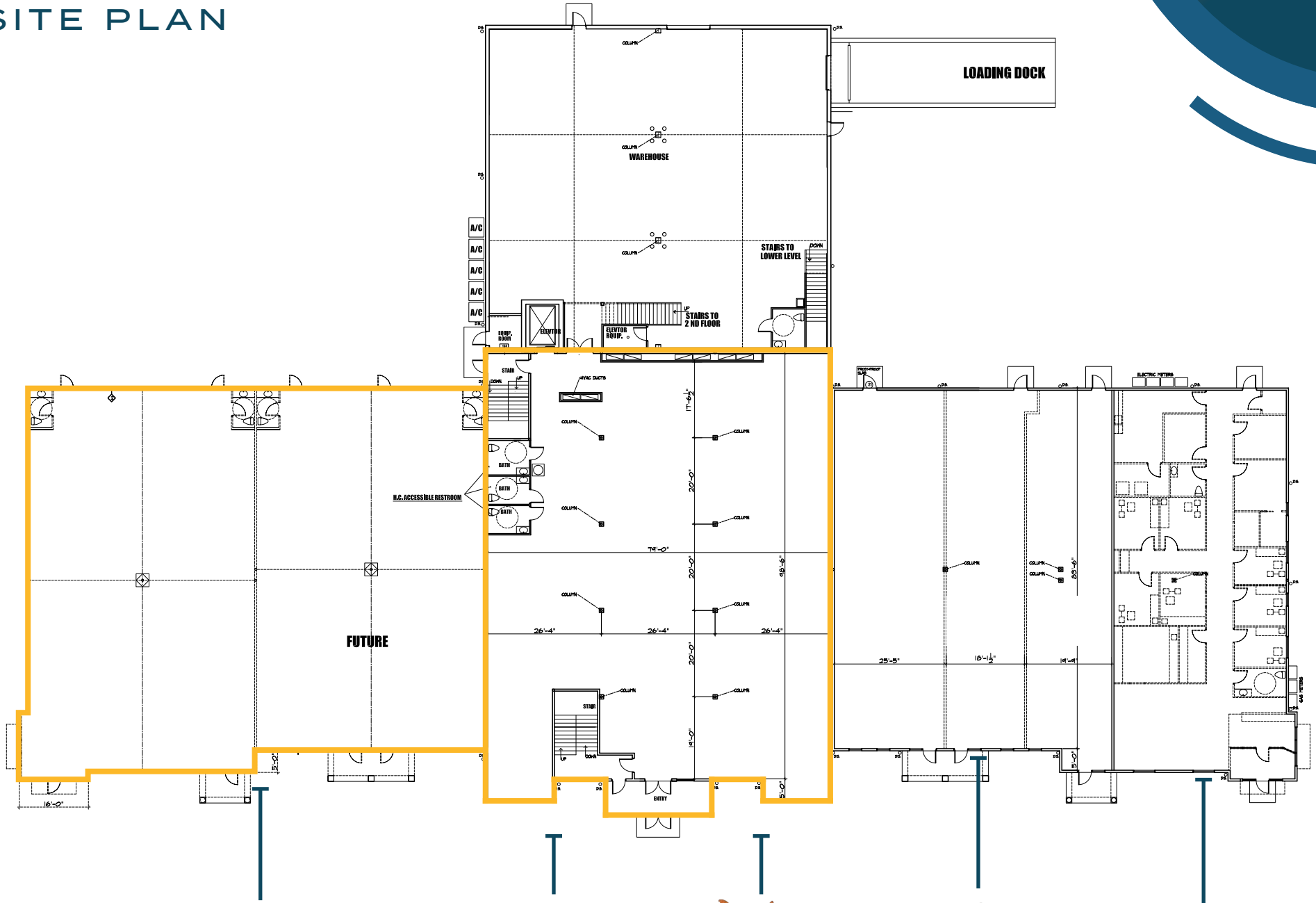

Up to 10,000 SF
Build to Suit

7,790 SF
Lower Level

Perrino
BUILDERS | REMODELERS | FURNITURE

LMI LITIGATION
MANAGEMENT, INC.



Chesterland Family | Eye care
Eyewear



7,790 SF Lower Level

DEMOGRAPHICS

| | 10 MINUTE DT | 15 MINUTE DT | 20 MINUTE DT |
|---|--------------|--------------|--------------|
| 2023 POPULATION - CURRENT YEAR ESTIMATE | 25,452 | 95,379 | 248,487 |
| 2028 POPULATION - FIVE YEAR PROJECTION | 24,987 | 94,225 | 246,722 |
| 2023 DAYTIME POPULATION | 22,405 | 101,351 | 287,479 |
| 2023 HOUSEHOLDS | 11,668 | 40,661 | 107,428 |
| 2023 AVERAGE HOUSEHOLD INCOME | \$120,678 | \$133,232 | \$122,127 |
| 2028 AVERAGE HOUSEHOLD INCOME | \$136,539 | \$150,626 | \$138,315 |
| 2023 MEDIAN INCOME | \$77,928 | \$87,865 | \$79,588 |
| 2028 MEDIAN HOUSEHOLD INCOME | \$86,812 | \$100,481 | \$90,064 |
| 2023 POPULATION 25 AND OVER | 19,748 | 72,717 | 184,021 |

FOR LEASE UP TO 10,000 SF NEW CONSTRUCTION RETAIL AVAILABLE

7976 MAYFIELD ROAD, CHESTERLAND, OH 44026

KEVIN MOSS
First Vice President
+1 216 363 6453
kevin.moss@cbre.com

CONNOR AMBROSE
Associate
+1 216 535 4730
connor.ambrose@cbre.com

© 2023 CBRE, Inc. All rights reserved. This information has been obtained from sources believed reliable, but has not been verified for accuracy or completeness. You should conduct a careful, independent investigation of the property and verify all information. Any reliance on this information is solely at your own risk. CBRE and the CBRE logo are service marks of CBRE, Inc. All other marks displayed on this document are the property of their respective owners, and the use of such logos does not imply any affiliation with or endorsement of CBRE. Photos herein are the property of their respective owners. Use of these images without the express written consent of the owner is prohibited. Licensed Real Estate Broker.

CBRE