

# 217 CEMBER WAY UNIT D FLOOR PLAN

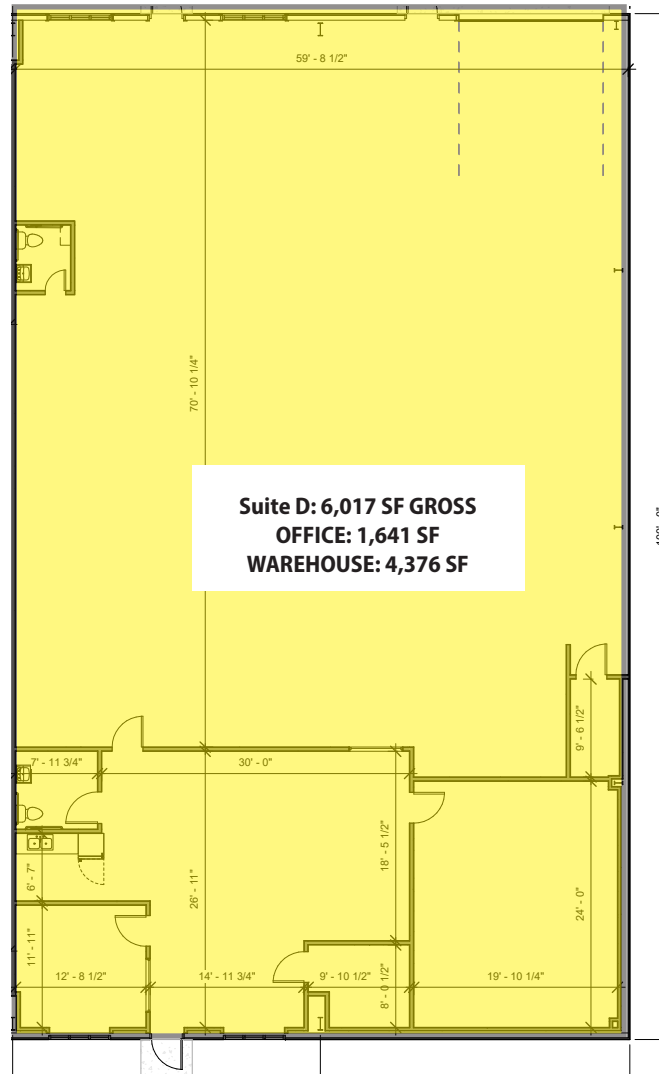

**Hensley Commercial Park**

Cember Way, Summerville, SC 29483

**217 Cember - Floor Plan**

October 14, 2022

**217**

The information contained herein was obtained from sources believed reliable, however, WRS Inc. makes no guarantees, warranties, or representations as to the completeness or accuracy thereof.

The presentation of this property is submitted subject to errors, omissions, change of tenants or conditions prior to sale or lease, or withdrawal without notice.

WRS Inc. | 410 Mill Street, Bldg. 1, Suite 200 | Mount Pleasant, SC 29464 | main 843.654.7888 | fax 843.654.7889