

SEE ARCHITECTURAL DRAWINGS FOR EXACT LOCATION & POSITIONING OF COMPACTORS & COMPACTOR/TOTE ENCLOSURE

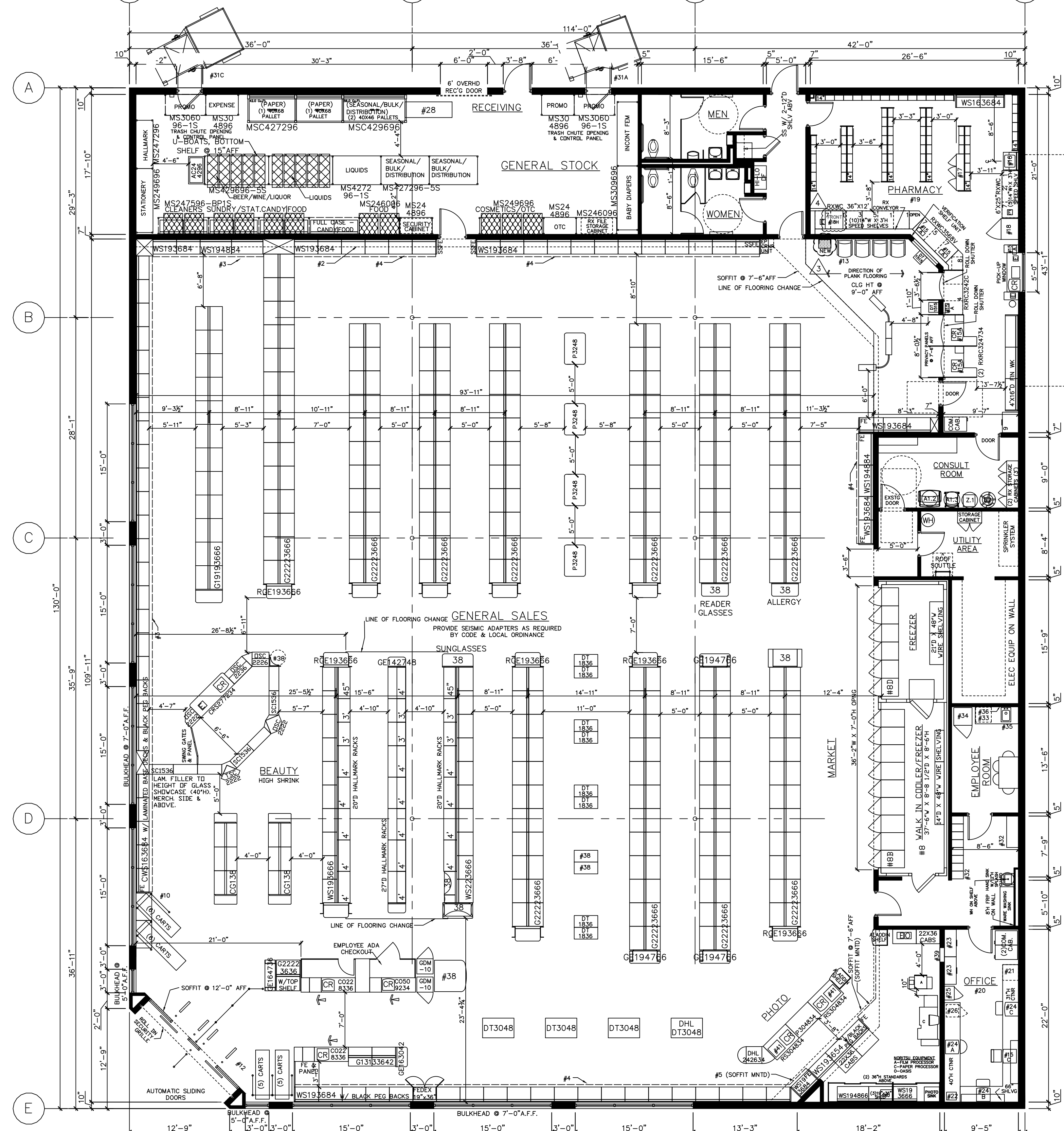

**1 FURNITURE FLOOR PLAN**  
1/8" = 1'-0"

02-22-2007 D105 TBG  
REVISE WALK-IN COOLER FROM OPEN FRONTS TO DOORS PER UPPER MANAGEMENT; CHANGED GONDOLA HEIGHT IN COSMETIC CUL-DE-SAC PER MARKETING.

12-18-2006 D104 TBG  
PREVENTION-ADD COSMETIC CUL-DE-SAC, REWORK SHELVING ACCORDINGLY; RELOCATE "E" FOR FUTURE 2ND DROP-OFF TERMINAL FROM FILLING COUNTER TO 6' SIDE WORK COUNTER; ELIMINATE "E" FOR FUTURE 3RD WINDOW PER PHARMACY SERVICES; REPLACE FUJI PHOTO EQUIPMENT WITH VORTSIU PHOTO EQUIPMENT PER PHOTOFINISHING; REPLACE TECHNICAL EQUIPMENT CABINET BY OFFICE WITH (2) COMMUNICATION CABINETS PER CORPORATE PURCHASING & IT; ADD (2) GDM-10 COOLERS AT TANDEM CHECKOUT PER PURCHASING.

08-21-06 AY (1013)  
UPDATE WOMEN'S RESTROOM PER PLUMBING CODE; UPDATE FRONT CHECKOUTS TO NEW DESIGN; REVISION SIZE OF TEL REFRIGERATION BOXES IN GENERAL SALES; UPDATE FREEZER COOLER PER CA ENERGY REQS.; REVISE # OF CARTS PER CORP. PURCH.; REVISE SOFFIT @ RESTROOM CORRIDOR AND WIDEN PASSAGE TO UTILITY/TRAINING ROOM PER PA SUGGESTION; REPLACE 18" COAT LOCKERS W/ 4" W COAT CABINET; REMOVE DROP-OFF & PICK-UP SIGNS AT PHARMACY COUNTER & 3' OF WS AT VERIFICATION WINDOW PER PHARMACY SERVICES; ADD CHASE IN CORNER OF PHARMACY FOR GAS LINE PER CRITERIA; ADD BABY CHANGING STATION IN MEN'S ROOM PER DREAM TEAM; REVISE NOTE CA HANGING SIGN TO 8'-0" AFF.

01-27-06 AY (1012)  
UPDATE PER PA-REWORK WALL SHELVING PER MERCHANDISING - SHIFT DOOR FROM GENERAL SALES TO STOCK 3' TOWARD PHARMACY & REMOVE WALL OPENING TO TRAINING/MULTIPURPOSE ROOM TO 3'-6" AND REPLACE (2) 3' WALL SECTIONS WITH (2) 4' WALL SECTIONS; SHIFT LOCATION OF CRX CABINET IN PHARMACY ADD THEATER ROPES PER PHARMACY SERVICES; REWORK PHARMACY BOTTLE BAYS TO ACCOMMODATE GAS PIPE PER ENGINEERING; REVISE COMPACTOR DOORS TO 3'-4" PER CONSTRUCTION BULLETIN; UPDATE PER FISCAL 2006 CRITERIA; REVISE COMPACTOR POSITION PER RECOMMENDATION FROM A.C.E.S. & REWORK STOCK SHELVING & RECEIVING DOOR LOCATION ACCORDINGLY; REVISE EMPLOYEE COUNTER DEPTH & POSITION OF SINK ENLARGE OF ALCOVE TO 4'-0" W & REWORK PORTER CLOSET & TOILET ROOM LAYOUT ACCORDINGLY; REVISE WIDTH OF ROOF SCUTTLE LADDER; ADD SSFE'S NEXT TO E.A.S. AT REST ROOM CORRIDOR; REVISE ROLLING GONDOLA ENDS TO CORRECT DEPTH & ADJUST AISLE SPACING; REVISE SHELVING IN WALK-IN COOLER TO 14"D PER CORP. PURCH.

PROTOTYPE: L114130  
(06-23-2005)

**PHR FURNITURE LEGEND**

A1.1	GUEST CHAIR - NEW	0
A1.1	GUEST CHAIR - EXISTING	4
A1.2	BARITRAC GUEST CHAIR-NEW	1
A1.3	GUEST CHAIR WITH CASTERS-NEW	1
D2	MEDICAL STOOL-NEW	1
Z.1	MOBILE STORAGE CART-NEW	1

**FIXTURE COLOR LEGEND**

WT	WHITE
PT	PUTTY
AB	ARCHITECTURAL BRONZE
TP	TAUPE
GM	GUNMETAL GREY
SR	SILVER

- GENERAL NOTES**
- PLEASE PROVIDE PROPER A.D.A. CLEARANCES ON BOTH SIDES OF ALL DOORS
  - MIRROR ON REAR WALL
  - BEAUTY CORNICHE (FIXTURE MOUNTED)
  - SALES AREA CORNICHE (FIXTURE MOUNTED)
  - PHOTO CORNICHE (FIXTURE MTD UNLESS NOTED)
  - CARPET TILES & DESIGN LINKS FURNISHED AND INSTALLED BY WALGREENS (WHEN SHOWN)
  - MASTER-BILT REACH-IN REFRIGERATION: MODEL TEM - ENDLESS REACH-IN REFRIGERATORS AND MODEL TEL - ENDLESS REACH-IN FREEZERS (ADD 2" AT EACH END, FOR END PANELS)  
A. TEM-3-24: 74 1/4"W X 37 3/4"D X 80"H  
B. TEL-3-24: 74 1/4"W X 37 3/4"D X 80"H  
C. BMG-74: 78"W X 35 3/8"D X 79"H  
D. BLG-74: 78"W X 35 3/8"D X 79"H  
E. SMB-580: 70"W X 32 1/4"D X 76 1/2"H  
F. BACK-UP REFRIGERATORS AND FREEZERS  
G. TAF-48HD: 52"W X 35 3/4"D X 80 1/2"H  
H. TAF-48HD: 52"W X 35 3/4"D X 80 1/2"H
  - MASTER-BILT WALK-IN COOLER: PROVIDE 9 #1000 COOLMASTER DOORS  
A. 26 3/4" X 73" EACH AND  
B. 1000R FREEZER MASTER DOORS  
C. 26 3/8" X 73" EACH BY ANTHONY  
D. (7) D BEV-O-FLOW GRAVITY SHELVES; UPPER (5) WITH SLIDES AND LOWER (2) WITH ROLLERS COMPLETE WITH UPRIGHTS  
E. 9 DOOR(S); FOR EACH DOOR PROVIDE 36"D B-O-F NYLON-LITE SHELVING SYSTEM  
F. (2) DOOR(S); FOR EACH DOOR PROVIDE AT FLOOR LEVEL  
G. 6 DOOR(S); FOR EACH DOOR PROVIDE 27"D ANTHONY SHELVES  
H. (2) DOOR(S); FOR EACH DOOR PROVIDE (2) 27"D ANTHONY SHELVES AND (4) 36"D MERCHANDISER SHELVES  
I. (2) DOOR(S); D DOUBLE DECK ROLLER CONVEYOR  
J. ICE CHEST BY VENDOR  
K. CART RAILS W/ DISPLAY SHELF & SLAT WALL ABOVE  
L. PROVIDE A 6"H BLACK VINYL BASE AT ALL CHECKOUTS  
M. ELECTRONIC ARTICLE SURVEILLANCE SYSTEM PHARMACY DEPARTMENT  
N. PATIENT SEATING AREA: (4) SEATS & TRAFFIC CONTROL FIXTURE  
O. PROVIDE FRAMING FOR 3'-6" X 7" H OPENING FOR FUTURE DROP-OFF WINDOW  
P. COMPUTER TERMINAL  
Q. INTERCOM PLUS TERMINAL  
R. TRAINING TERMINAL (IN TRAINING ROOM)  
S. RX SINK AND CABINET  
T. CRX CABINET  
U. RX REFRIGERATOR  
V. STIRLING ULT105 FREEZER  
W. PROVIDE A CARPETED FLOOR WITH A RUBBER RUNNER - RX UNDERCOUNTER INSERTS:  
#1 - RX 3 DRAWER VIAL INSERT  
#2 - RX 3 DRAWER FILE INSERT  
#3 - RX OPEN INSERT  
#4 - RX CONSULTATION COUNTER UNIT  
#5 - RX PRINTER INSERT  
#6 - RX 5 DRAWER FILE INSERT  
#7 - RX OPEN INSERT WITH CPU SHELF (39" CNTR)  
#8 - RX OPEN INSERT WITH CPU SHELF (34" CNTR)  
#9 - RX OPEN CABINET (39" CNTR)  
#10 - RX 10 DRAWER FILE CABINET

**PROJECT DATA**

TYPE	GENERAL SALE	<input checked="" type="checkbox"/>	MARKET	<input checked="" type="checkbox"/>	
NEW LOCATION	<input type="checkbox"/>	SECURITY	<input type="checkbox"/>	MARKET	<input checked="" type="checkbox"/>
EXISTING BLDGS	<input type="checkbox"/>	PHOTO	<input type="checkbox"/>	LIQUOR	<input type="checkbox"/>
REMODEL	<input checked="" type="checkbox"/>	PHARMACY	<input checked="" type="checkbox"/>	24 HOUR	<input type="checkbox"/>

**SQUARE FOOT AREA SUMMARY**

DEPARTMENT	SALES	STOCK	SERVICE	TOTAL EXIST'G	TOTAL NEW
GEN SALES	9425	1813	1323	12561	12561
MARKET	900	0	0	900	900
PHOTO	900	0	0	900	900
RX	723	0	182	905	905
WINE + BEER	723	0	0	723	723
CLINIC	204	0	0	204	204
HHC	204	0	0	204	204
BSMT	204	0	0	204	204
2ND FLOOR	204	0	0	204	204
TOTAL NEW	11502	1813	1505	14820	14820
TOTAL EXST'G	11502	1813	1505	14820	14820

TOTAL AREA: FIRST FLOOR: 14,820 SQ. FT.  
TOTAL AREA: OTHER LEVELS: 0 SQ. FT.  
GROSS AREA INCLUDING ALL DEPARTMENTS & ALL LEVELS: 14,820 SQ. FT.

**SUMMARY OF CHANGES**

**LINEAL FOOTAGE**

	EXISTING	PROPOSED	CHANGE
TOTAL LINEAL FOOTAGE	1,369 In Ft	1,303 In Ft	-4.8%
SHELVING	1,220 In Ft	1,154 In Ft	-5.4%
GREETING CARDS	116 In Ft	116 In Ft	0%
SEASONAL	0 In Ft	0 In Ft	##
COOLERS	20 In Ft	20 In Ft	0%
FREEZERS	13 In Ft	13 In Ft	0%
LOOK BOUTIQUE	0 In Ft	0 In Ft	##
UP-MARKET	0 In Ft	0 In Ft	####
TOTAL LIQUOR STORE LINEAL FOOTAGE	0 In Ft	0 In Ft	####
LIQUOR STORE SHELVING	0 In Ft	0 In Ft	##
LIQUOR STORE COOLERS	0 In Ft	0 In Ft	##
LIQUOR STORE FREEZERS	0 In Ft	0 In Ft	####
STOCK ROOM SHELVING	0 cu ft	0 cu ft	####
PHARMACY LINEAL FOOTAGE	90 In Ft	90 In Ft	0%
STOCK ROOM OPTIMIZER		0.00%	

**PROMO FOOTAGE**

	EXISTING	PROPOSED	CHANGE
END STAND QTY	15	15	0 qty
SIDE PANEL QTY	30	30	0 qty
TABLE QTY	13	13	0 qty
QUEUEING	10	10	0 In Ft
BEAUTY	36	36	0 In Ft

**SQUARE FOOTAGE**

	EXISTING	PROPOSED	CHANGE
BUILDING SQ. FT.	14,820 sq ft	14,820 sq ft	0%
STOCK SQ. FT.	1,140 sq ft	1,140 sq ft	0%
RX INTERIOR SQ. FT.	723 sq ft	723 sq ft	0%
HEALTHCARE SQ. FT.	984 sq ft	1,145 sq ft	16.4%
DAILY LIVING SQ. FT.	10,684 sq ft	10,684 sq ft	0%

**FIXTURE LEGEND**

	EXISTING	NEW
G GONDOLA	1919 36 66" WT D. W. H. COLOR	ALL OTHER FIXTURES ARE TYPICALLY CALLED OUT DEPTH BY WIDTH.
GE GONDOLA	19 47 66" WT D. W. H. COLOR	EXAMPLE: DT 30 48
END	19 36 84" WT D. W. H. COLOR	DISPLAY D. W. TABLE

\*DOES NOT INCLUDE STANDARDS, WOOD GROUNDS OR FINISHED END PANELS

**REMODEL & HATCH LEGEND**

	EXISTING
	NEW
	RESET

**BUSINESS OWNER APPROVAL**

	DATE
DAILY LIVING	F. LASTNAME XX/XX/XX
PHARMACY SERVICES	F. LASTNAME XX/XX/XX
BRANDING	F. LASTNAME XX/XX/XX
STORE OPERATIONS	F. LASTNAME XX/XX/XX
STORE PLANNING	MALCULESQU XX/XX/XX

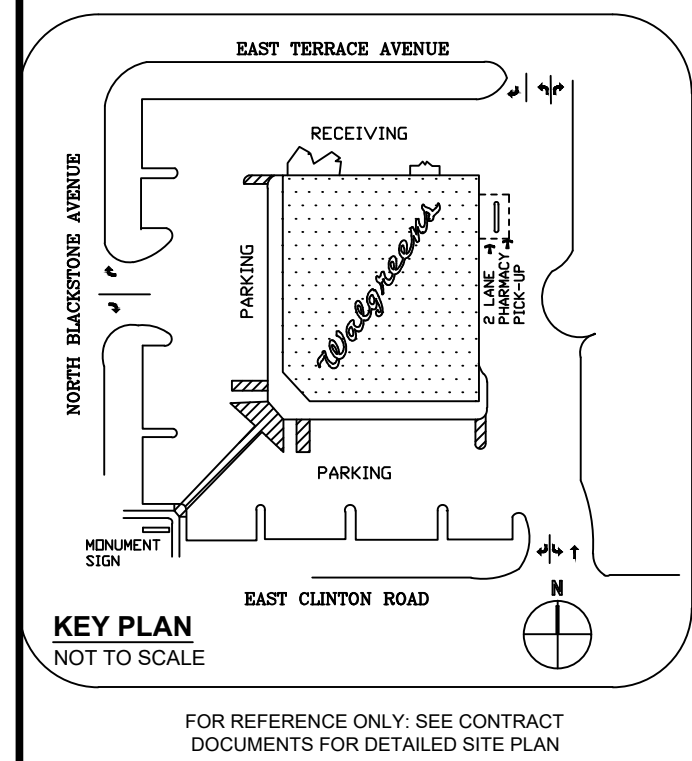

**\*A.D.A. DOOR CLEARANCES**

	1'-6"
	1'-0"

\*ACCESSIBLE REQUIREMENTS MAY VARY WITH LOCAL JURISDICTIONS & APPROACH TO DOOR SWING

I HEREBY CERTIFY THAT THIS PLAN AND ALL WORK PREPARED BY ME OR UNDER MY DIRECT SUPERVISION AND THAT I AM A DULY REGISTERED ARCHITECT OR ENGINEER IN THE STATE OF CALIFORNIA AND SIGNIFIED BY MY HAND AND SEAL.

**REVISIONS**

NO.	DATE	BY	DESCRIPTION
4	04/06/21	JVM	COVID RABD RESPONSE-ADD ULT105 FREEZER
3	02/15/21	BT	STRE20020BT-NEW RX HEARING AID BATTERY
2	07/25/17	JQ	SHELVING & TERRY'S FILING CABINETS - SEE SCORE DOCUMENTS FOR DETAILED SCOPE OF WORK
1	01/20/17	NHN	FY17 PHR PROGRAM REVISION NOTES

FIXTURE FLOOR PLAN  
STORE NUMBER 10243  
**WALGREENS**  
2420 N. BLACKSTONE AVENUE  
FRESNO, CALIFORNIA  
DRAWN BY: M.JULIETT  
SP CONTACT: A.GARVIN  
COVID RABD RESPONSE