

# 17,849± SF SHOP & OFFICE ON 8.75± ACRES

## FOR LEASE

1200 Conroy Place, Easton, PA 18040



### CALL FOR PRICING DETAILS

#### PROPERTY DETAILS

17,849± SF  
MAINTENANCE SHOP

- 12,849± SF shop
- 5 drive-in bays, including 1 drive-through wash bay
- 5,000± SF office (2-levels)

8.75± ACRE SITE:

- 5,000± SF outbuilding
- Paved, fenced & lit yard
- (EC) - Employment Center zoning



#### LOCATION HIGHLIGHTS

Located at the northwest corner of the intersection of Uhlert Road and Conroy Place.

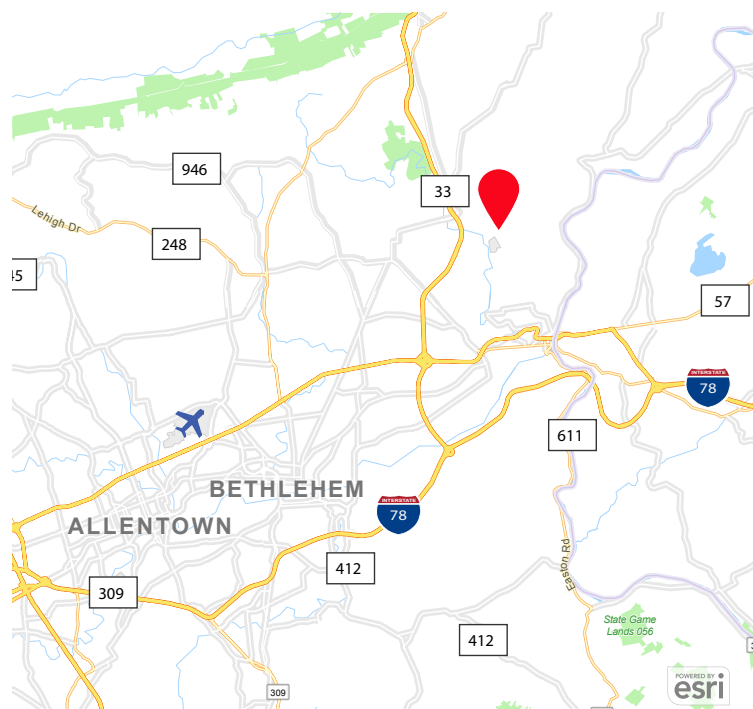

**Burr & Temkin**

Transportation Real Estate Specialists Since 1983



Chuck Dombrowski  
Regional Vice President  
724.554.6681  
[chuck@burrtemkin.com](mailto:chuck@burrtemkin.com)

Eric McFarlin  
Principal  
336.996.2550  
[ericm@burrtemkin.com](mailto:ericm@burrtemkin.com)



CROSSWEST CAPITAL

This statement is based upon information we believe to be correct and is obtained from sources we regard as reliable, but we assume no liability for errors or omissions therein.



# 17,849± SF SHOP & OFFICE ON 8.75± ACRES

## FOR LEASE

1200 Conroy Place, Easton, PA 18040



**Burr & Temkin**  
Transportation Real Estate Specialists Since 1983



Chuck Dombrowski  
Regional Vice President  
724.554.6681  
[chuck@burrtemkin.com](mailto:chuck@burrtemkin.com)

Eric McFarlin  
Principal  
336.996.2550  
[ericm@burrtemkin.com](mailto:ericm@burrtemkin.com)



CROSSWEST CAPITAL

This statement is based upon information we believe to be correct and is obtained from sources we regard as reliable, but we assume no liability for errors or omissions therein.



# 17,849± SF SHOP & OFFICE ON 8.75± ACRES

## FOR LEASE

1200 Conroy Place, Easton, PA 18040

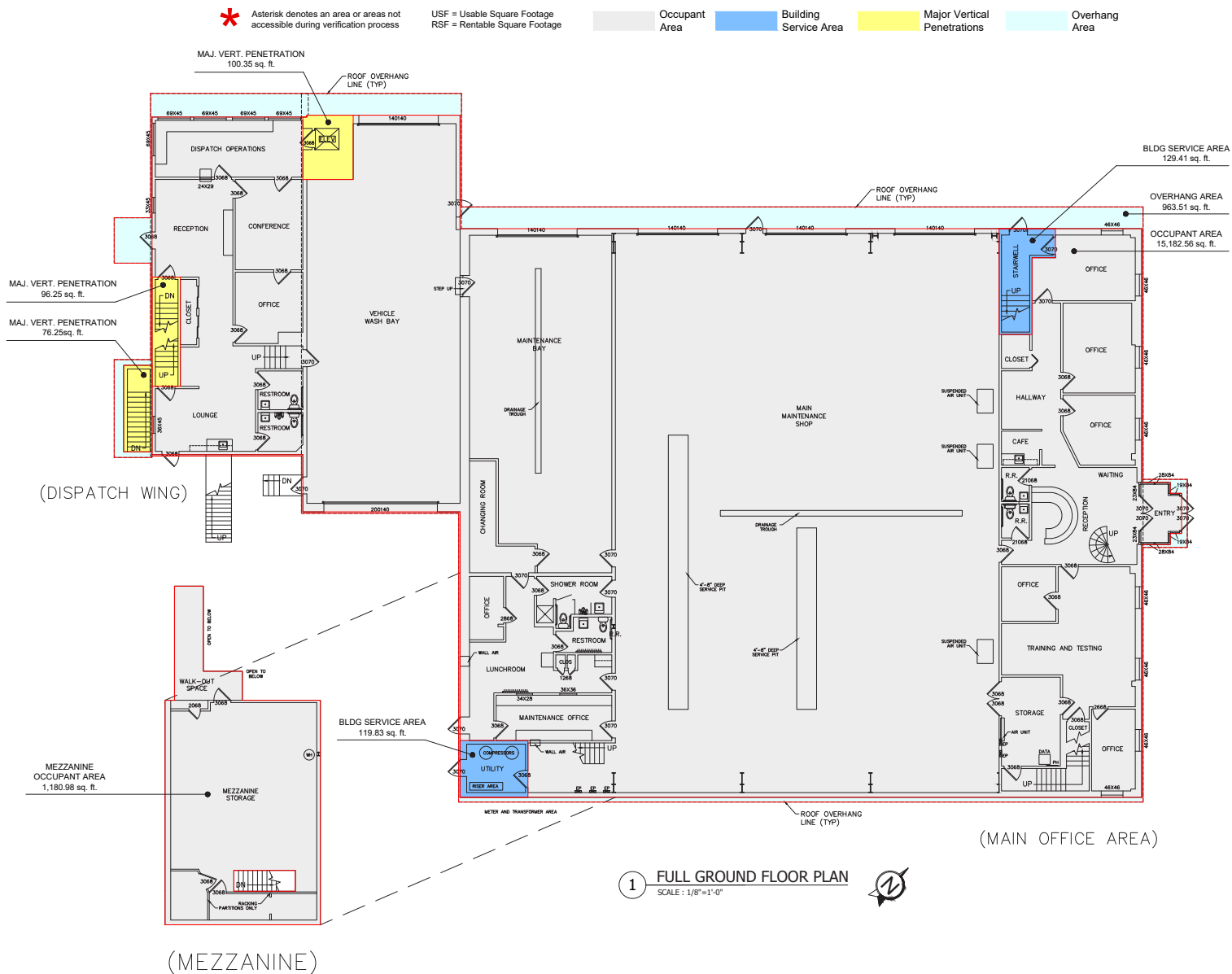

**Burr & Temkin**  
 Transportation Real Estate Specialists Since 1983



Chuck Dombrowski  
 Regional Vice President  
 724.554.6681  
[chuck@burrtemkin.com](mailto:chuck@burrtemkin.com)

Eric McFarlin  
 Principal  
 336.996.2550  
[ericm@burrtemkin.com](mailto:ericm@burrtemkin.com)



CROSSWEST CAPITAL

This statement is based upon information we believe to be correct and is obtained from sources we regard as reliable, but we assume no liability for errors or omissions therein.





# Burr & Temkin

Transportation Real Estate Specialists Since 1983

201 King of Prussia Road  
Suite 650  
Radnor, PA 19087



Chuck Dombrowski  
Regional Vice President  
724.554.6681  
[chuck@burrtemkin.com](mailto:chuck@burrtemkin.com)



Eric McFarlin  
Principal  
336.996.2550  
[ericm@burrtemkin.com](mailto:ericm@burrtemkin.com)