

14225 Schaefer Hwy

DETROIT, MI 48227

**FOR SALE \$599,900 | INDOOR WARHOUSE | WAREHOUSE | APPROVED
FOR CANNABIS CULTIVATION & PROCESSING**

FOR LEASE \$4 PSF + NNN



Sale Price:	\$599,900
Address:	14225 Schaefer, Detroit, MI 48227
Lease:	Starting at \$4 PSF plus NNN
Leasable Space Minimum:	20K SF up to 44K SF
Building Best Use:	City Approved for Cannibas, Auto Repair & Collision Shop, Transportation, Self Storage Facility, Manufacturing, Commissary, Trucking, Distribution Center
Building Sq. Ft.:	44,000 Sq. Ft.
Ceiling Height:	13'
Total Acreage:	1.76 Acres
Zoning:	M4

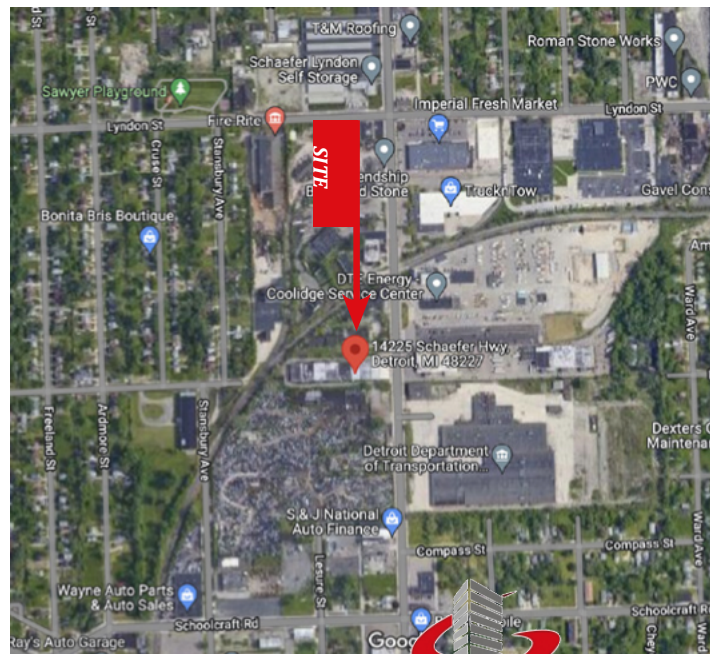

FOR MORE INFORMATION PLEASE CONTACT:

Maurice Khalifa

Principal Broker | (586) 615-0101 | maurice@showcaseonerealestate.com

www.showcaseonerealestate.com

SHOWCASE ONE
REAL ESTATE GROUP

14225 Schaefer Hwy

DETROIT, MI 48227

Site Plan

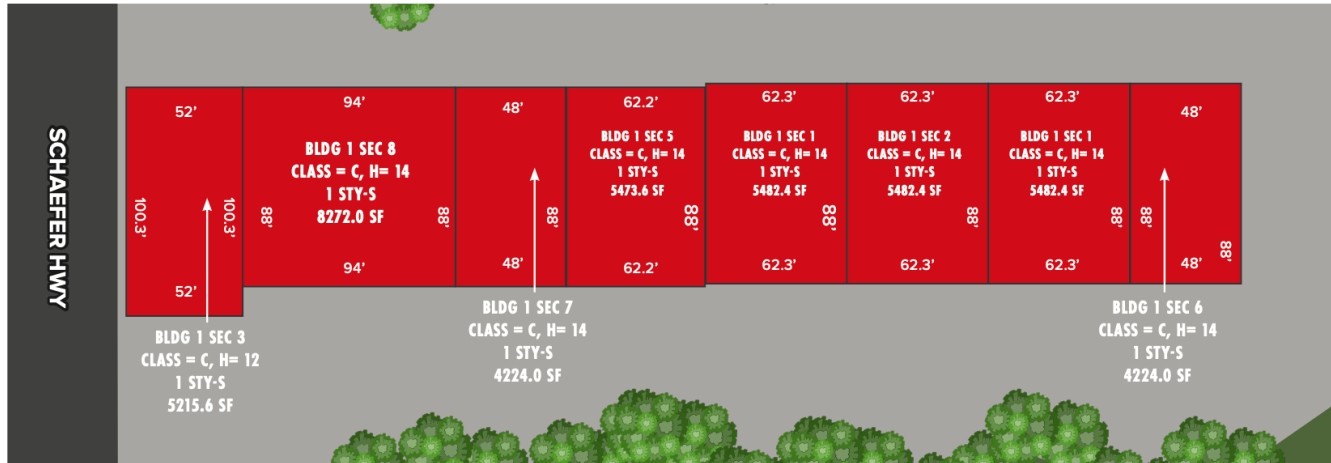

Property Photos



FOR MORE INFORMATION PLEASE CONTACT:

Maurice Khalifa

Principal Broker | 📞 (586) 615-0101 | ✉️ maurice@showcaseonerealestate.com



www.showcaseonerealestate.com

© 2022 Showcase One Real Estate Group. - This Marketing Flyer and any addendums have been exclusively created for and prepared by Showcase One Real Estate Group for real property marketing and advertising purposes. Showcase One Real Estate Group makes no guarantees, representations, or warranties of any kind, express or implied, regarding the information contained within this document; all interested parties and/or their agents are advised to research and verify the accuracy of all information provided herein and to conduct their own investigations.

14225 Schaefer Hwy

DETROIT, MI 48227

Regional Map

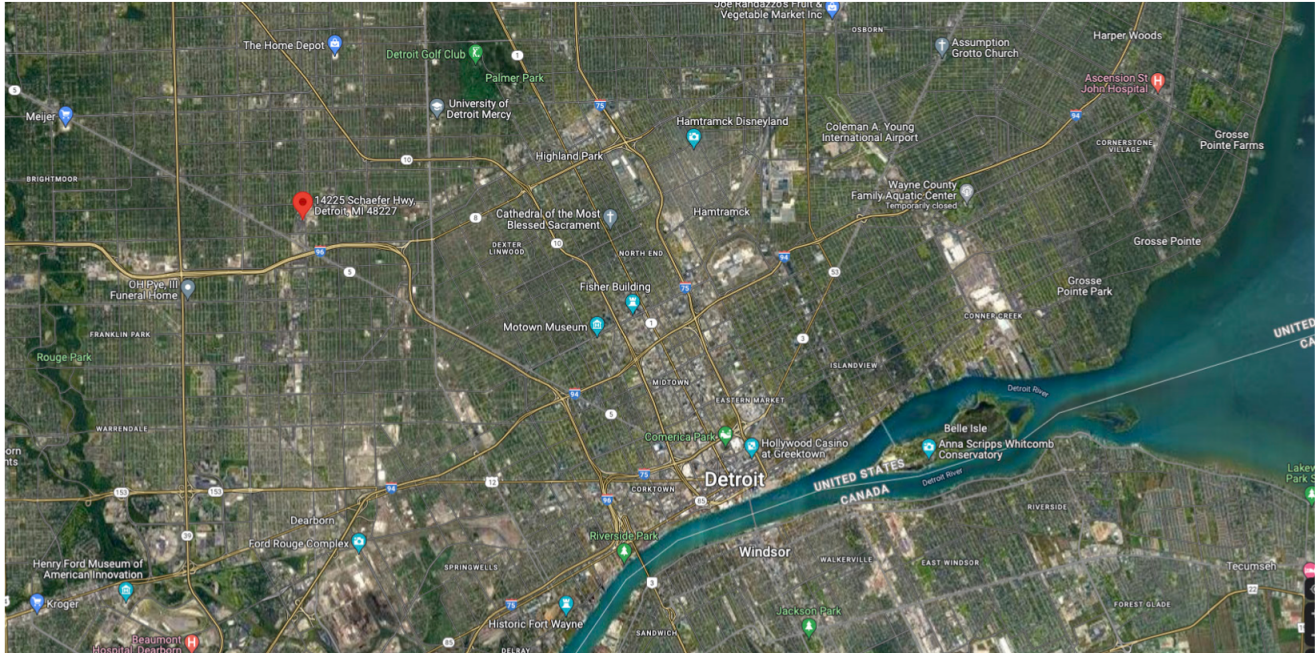

Demographics

Population	1 mile	3 mile	5 mile
2022 Total Population	14,888	159,148	415,452
2027 Population	14,751	156,288	409,943
Average Age	38	39	38
2022 Total Households	5,416	59,836	153,260
HH Growth 2022-2027	(1.07%)	(1.98%)	(1.49%)
Median Household Income	\$29,166	\$33,598	\$34,189
Avg Household Size	2.70	2.60	2.70
Median Home Value	\$62,130	\$70,357	\$76,863

FOR MORE INFORMATION PLEASE CONTACT:

Maurice Khalifa

Principal Broker | 📞 (586) 615-0101 | ✉️ maurice@showcaseonerealestate.com



www.showcaseonerealestate.com

© 2022 Showcase One Real Estate Group. – This Marketing Flyer and any addendums have been exclusively created for and prepared by Showcase One Real Estate Group for real property marketing and advertising purposes. Showcase One Real Estate Group makes no guarantees, representations, or warranties of any kind, express or implied, regarding the information contained within this document; all interested parties and/or their agents are advised to research and verify the accuracy of all information provided herein and to conduct their own investigations.