

**FOR LEASE**

# TWO INDUSTRIAL SPACES WITH AMPLE PARKING AVAILABLE

LOCATED IN THE ESQUIMALT INDUSTRIAL PARK

785 LAMPSON STREET | ESQUIMALT, BC



**CBRE**



# THE OPPORTUNITY

CBRE Victoria is pleased to present the opportunity to lease two industrial spaces located in the heart of the Esquimalt Industrial Park. One unit is 4,402 square feet, comprised of a mix of office and industrial/storage space. The second unit is a 1,051 square foot standalone building, featuring an enclosed shop and a covered truck maintenance area. The two units can be leased together or separately. The I-1 zoning allows for a wide range of light industrial and service commercial uses. The property also features significant yard space for additional parking, please contact listing agents for more information.

## HIGHLIGHTS

### ① Main Building (Lower)

- 4,402 SF of floor area
- Ceiling heights: 9'2" - 9'5"
- 8'x10' grade level loading door
- Electric heating
- Includes a washer/dryer and shower

### ② Outbuilding

- 1,051 SF of shop space
- Features an 18' high covered truck parking area
- Ceiling heights: 18'1" at the front of the unit and 9'3" under the mezzanine.

## DETAILS

<b>Address:</b>	785 Lampson Street
<b>Neighbourhood:</b>	Esquimalt
<b>Zone Code:</b>	I1 Light Industrial
<b>Lease Rate:</b>	\$15.00 PSF
<b>Additional Rent:</b>	Contact Agents
<b>Availability:</b>	Immediately

## ZONING | I-1 Light Industrial

Permitted Uses - Including, but not limited to:

- Auto servicing and body shop
- Cold storage plant
- Commercial laundry or drycleaning
- Fitness centre
- Light manufacturing / processing
- Trade contractor establishment
- Warehousing and storage
- Wholesaling and wholesale distribution



## FLOOR PLANS

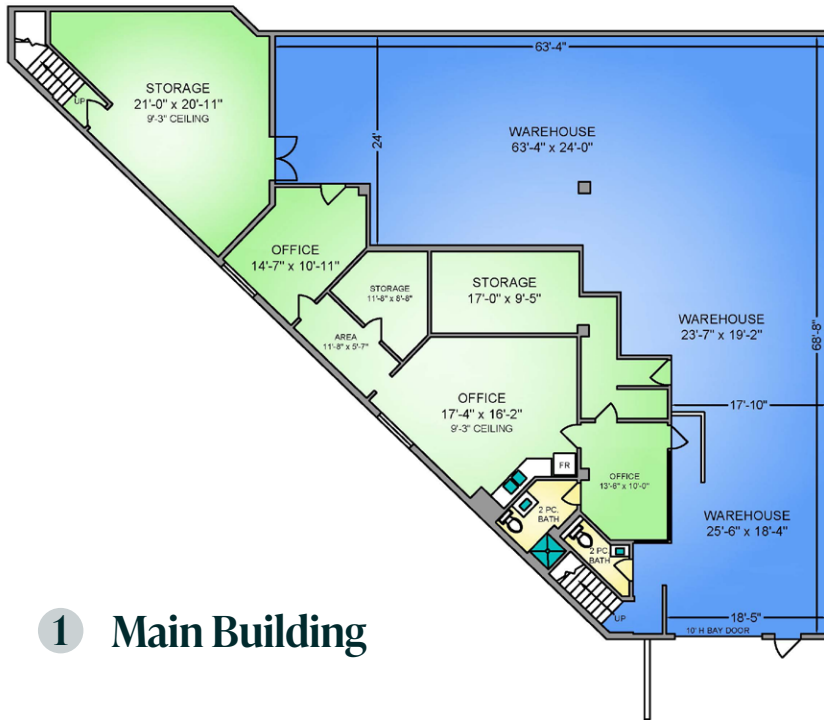

## 1 Main Building

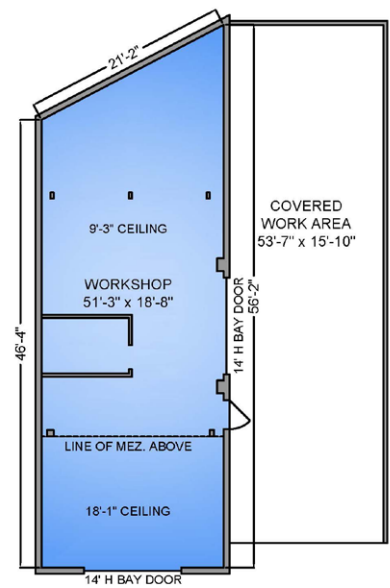

## 2 Outbuilding





**FOR LEASE**

# TWO INDUSTRIAL SPACES WITH AMPLE PARKING AVAILABLE

LOCATED IN THE ESQUIMALT INDUSTRIAL PARK

785 LAMPSON STREET | ESQUIMALT, BC



## EXCLUSIVE ADVISORS:

### Cooper Anderson

Sales Associate

CBRE Victoria

250 386 0276

[cooper.anderson@cbre.com](mailto:cooper.anderson@cbre.com)

### Chris Rust

Senior Vice President

CBRE Victoria

250 386 0005

[chris.rust@cbre.com](mailto:chris.rust@cbre.com)

**CBRE**

## SPECIALIZING IN INVESTMENT & DEVELOPMENT PROPERTY

CBRE LIMITED | 110-800 YATES STREET | VICTORIA, BC V8W 1L8

[www.cbre.ca](http://www.cbre.ca)  
[www.cbrevictoria.com](http://www.cbrevictoria.com)

This disclaimer shall apply to CBRE Limited, Real Estate Brokerage, and to all other divisions of the Corporation; to include all employees and independent contractors ("CBRE"). The information set out herein, including, without limitation, any projections, images, opinions, assumptions and estimates obtained from third parties (the "Information") has not been verified by CBRE, and CBRE does not represent, warrant or guarantee the accuracy, correctness and completeness of the Information. CBRE does not accept or assume any responsibility or liability, direct or consequential, for the Information or the recipient's reliance upon the Information. The recipient of the Information should take such steps as the recipient may deem necessary to verify the Information prior to placing any reliance upon the Information. The Information may change and any property described in the Information may be withdrawn from the market at any time without notice or obligation to the recipient from CBRE. CBRE and the CBRE logo are the service marks of CBRE Limited and/or its affiliated or related companies in other countries. All other marks displayed on this document are the property of their respective owners. All Rights Reserved. Mapping Sources: Canadian Mapping Services [canadamapping@cbre.com](http://canadamapping@cbre.com); DMTI Spatial, Environics Analytics, Microsoft Bing, Google Earth.