

**± 800 SF – ±47,234 SF****Class A Office Space****Lease price: \$26.00 /SF****Net tenant electric (lights & plugs only)****AVAILABLE SUITES**

➤ 1 <sup>st</sup> floor	3,046 SF	➤ 7 <sup>th</sup> floor	3,240 SF
➤ 2 <sup>nd</sup> floor	1,800 SF	➤ 8 <sup>th</sup> floor	3,733 SF
➤ 4 <sup>th</sup> floor	11,807 SF	➤ 9 <sup>th</sup> floor	5,385 SF
➤ 5 <sup>th</sup> floor	5,613 SF	➤ 12 <sup>th</sup> floor	11,807 SF
➤ 7 <sup>th</sup> floor	800 SF		

**Property Highlights**

- Located in the heart of Providence Financial District
- 23-stories, 266,000 SF Class 'A' office building
- Newly renovated lobby
- All elevators have been modernized with computerized equipment and upgraded operating panel equipment for safety and efficiency
- First floor banking, deli and elevator access to parking
- Electronic card access system to building, two security agents in lobby, and visitor badge system provides high level of security to access building

**Area Amenities**

- Downtown Location
- Central Business District
- Retail
- Restaurants
- Bus Terminal
- Train Station
- City Hall
- Courts
- Easy Highway Access

For more information, please contact:

**Karl Sherry, SIOR**  
Partner  
401 273 7428  
ksherry@hayessherry.com

**Matt Fair**  
Partner  
401 273 2053  
mfair@hayessherry.com

146 Westminster Street, 2<sup>nd</sup> floor  
Providence, RI 02903  
phone: 401 273 1980

hayessherry.com

**CLASS A OFFICE TOWER**



5<sup>th</sup> Floor Plan

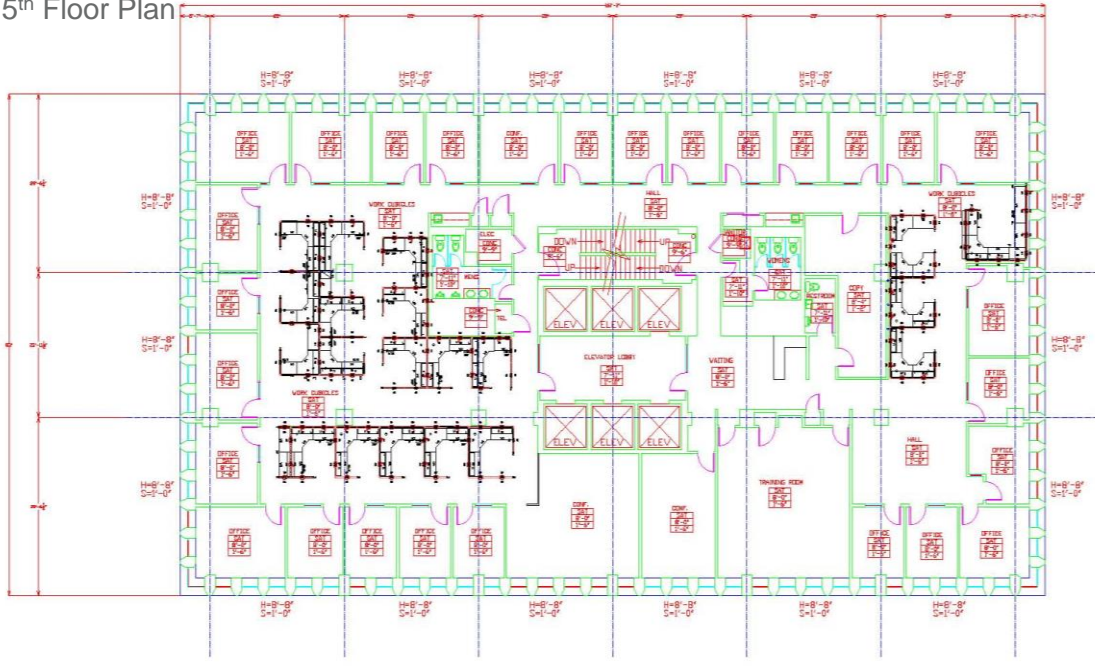

*Independently Owned and Operated / A Member of the Cushman & Wakefield Alliance*  
Cushman & Wakefield Copyright 2023. No warranty or representation, express or implied, is made to the accuracy or completeness of the information contained herein, and same is submitted subject to errors, omissions, change of price, rental or other conditions, withdrawal without notice, and to any special listing conditions imposed by the property owner(s). As applicable, we make no representation as to the condition of the property (or properties) in question.