



WEWORK AT

Tabor Center

DENVER, CO

wework

© 2020 WeWork

Tabor Center at a glance

30

TOTAL BUILDING FLOORS

645,159

TOTAL BUILDING SQ FT

3

WEWORK FLOORS + FULL FLOOR OPPORTUNITIES

106,153

TOTAL WEWORK SQ FT

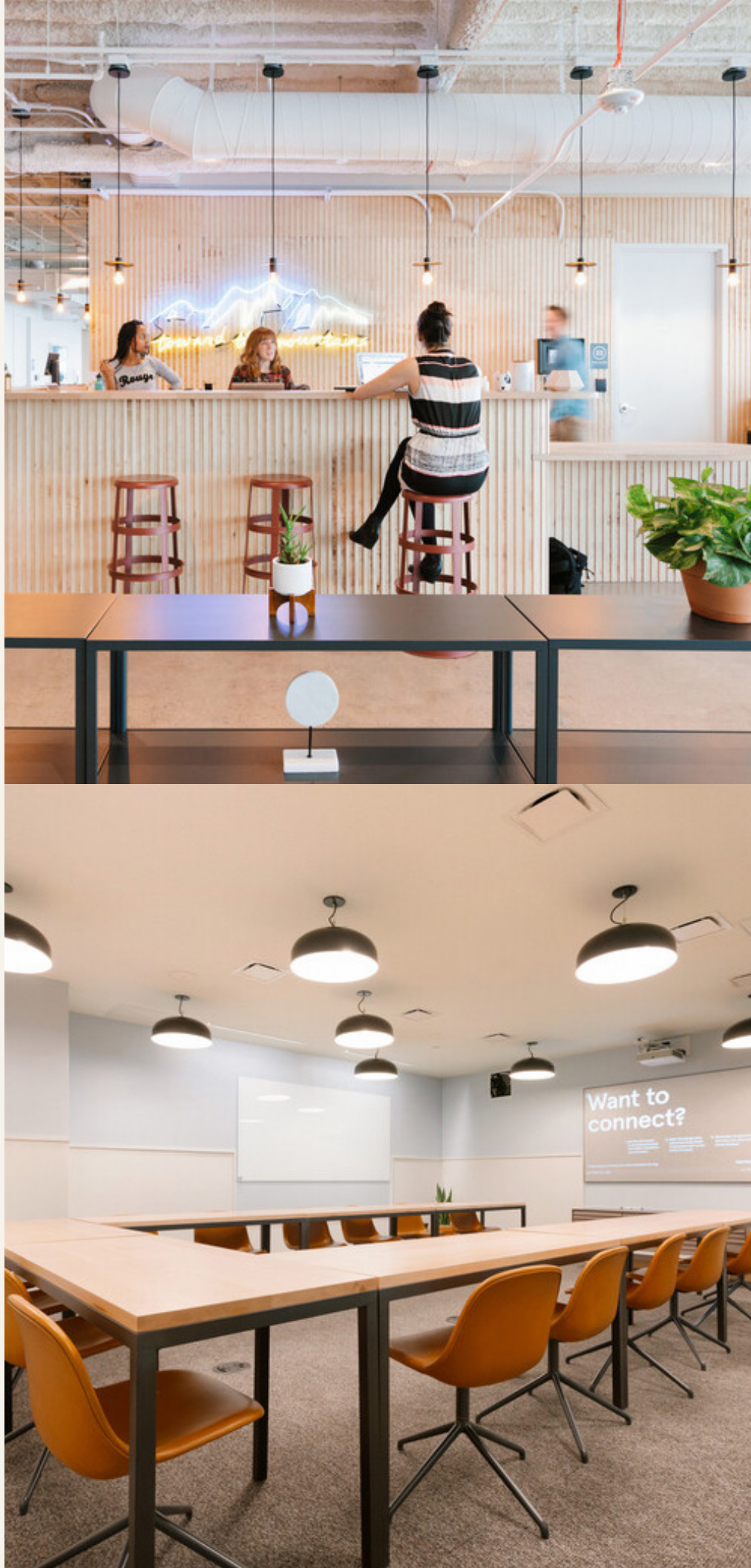

Soaring Class A Complex in Denver's CBD

BUILDING OVERVIEW

Tabor Center is a 30-floor, 645,159 square foot mixed-use complex located in the heart of Denver's CBD. Originally built in 1985 and renovated 2000, this LEED Certified Gold building boasts an impressive lobby, floor-to-ceiling windows, tons of onsite retail, dining, and hotel options—as well as banking, dry cleaning, convenience store, and fitness center all within the complex.

Designed for efficiency, collaboration, and productivity

In addition to WeWork's full suite of amenities and perks—from super-fast WiFi to 24/7 security—Tabor Center members also have access to the building's unique amenities like covered parking, bike storage, an event space, creator lab, swimming pool, wellness room, and a mother's room. Plus, members can bring their dogs to work as the location is pet friendly. Looking for something in particular? Our onsite staff will be sure to point members in the right direction.

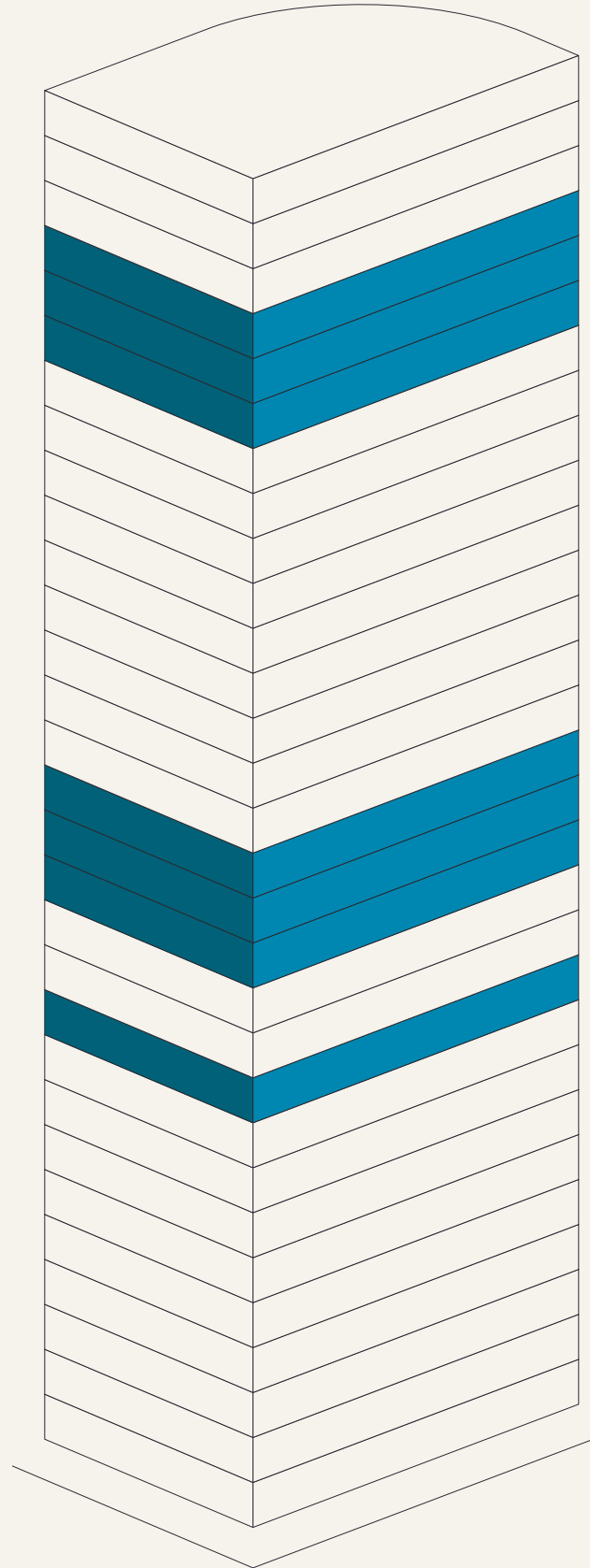

WEWORK FOOTPRINT

FLOOR	RSF
10	21,192
13	20,894
14	20,894
15	20,812
25	21,383
26	21,106
27	21,660

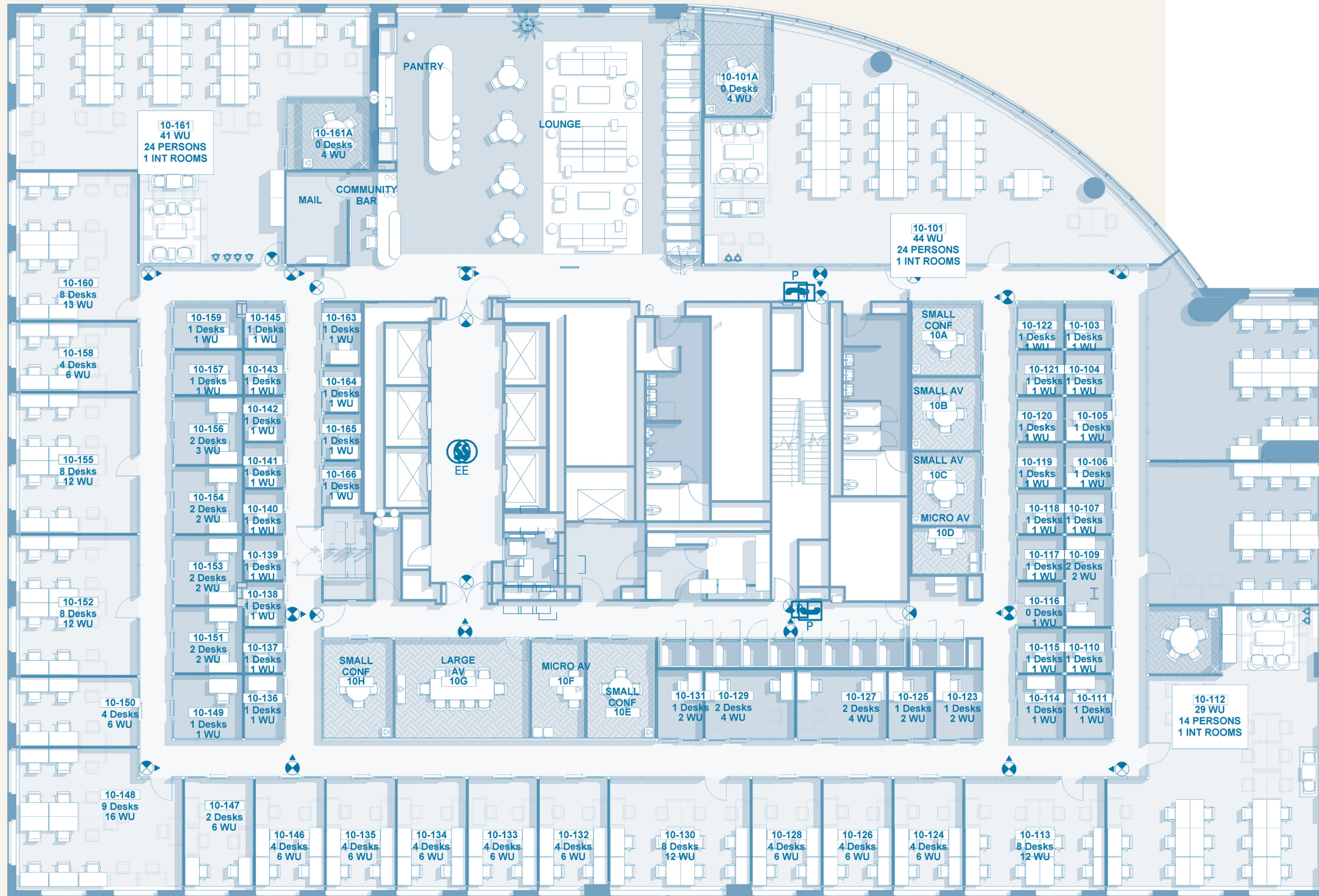

10th Floor

21,192 RSF

13th Floor

20,894 RSF

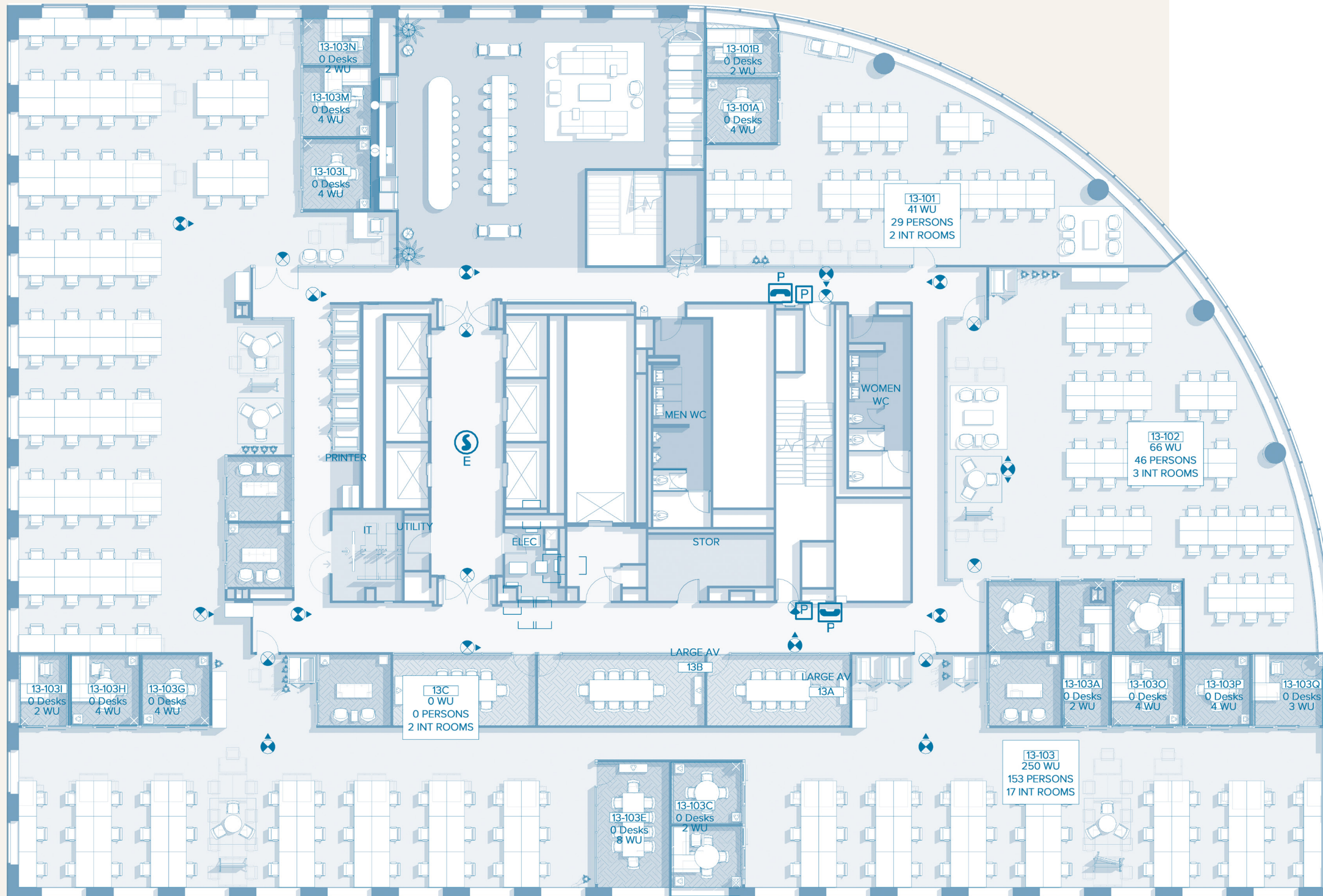

14th Floor

20,894 RSF



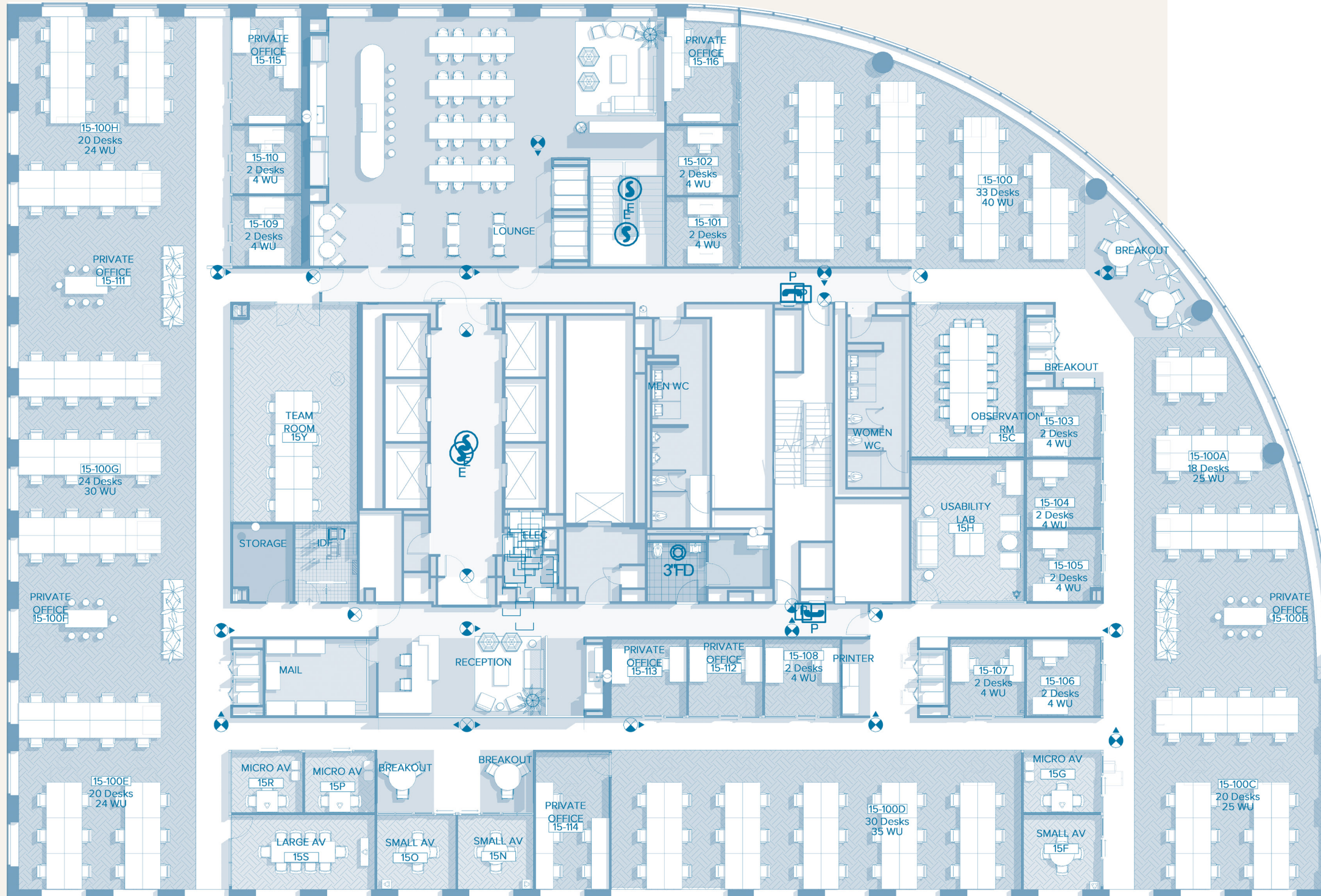

15th Floor

20,812 RSF

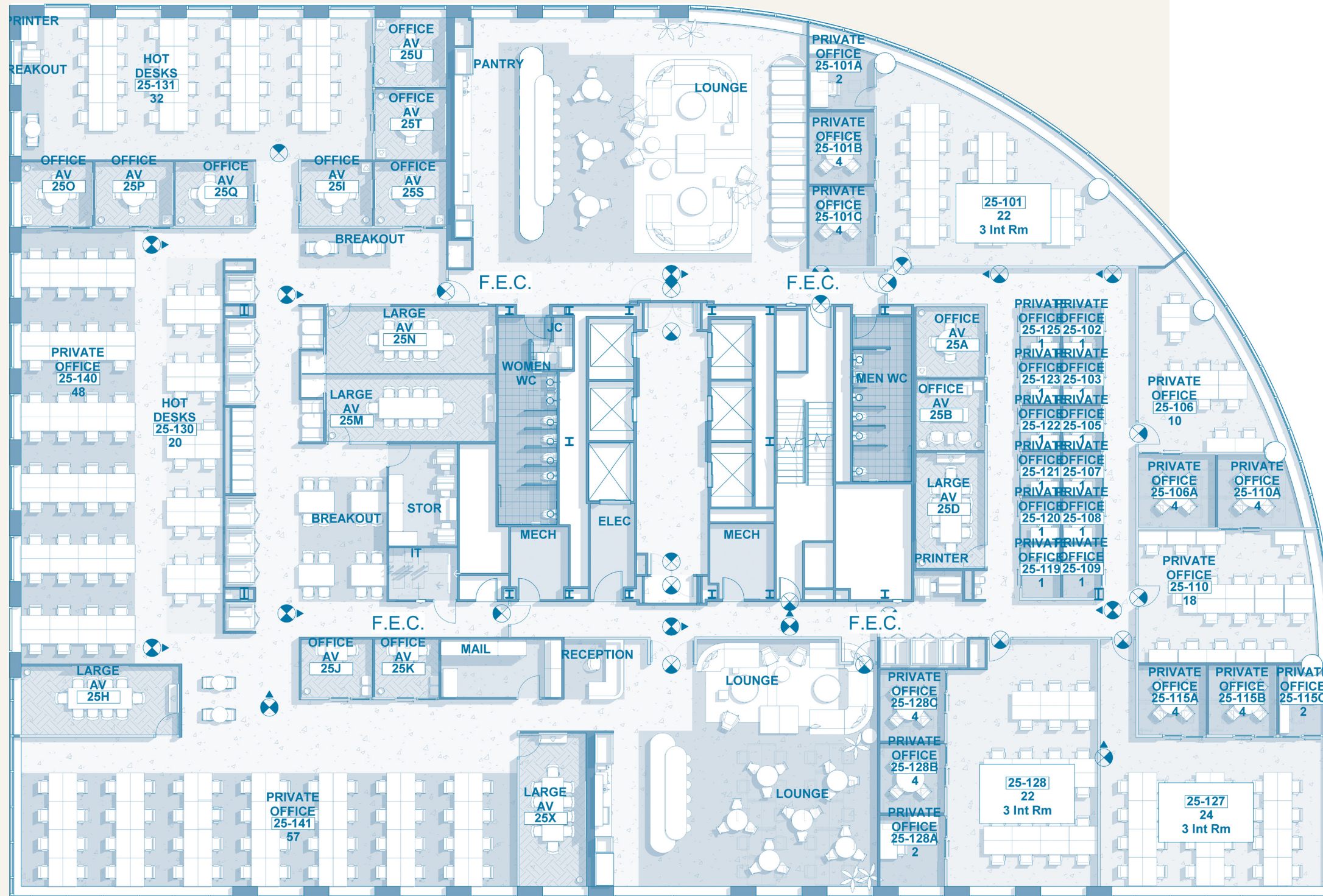

25th Floor

21,383 RSF

26th Floor

21,106 RSF

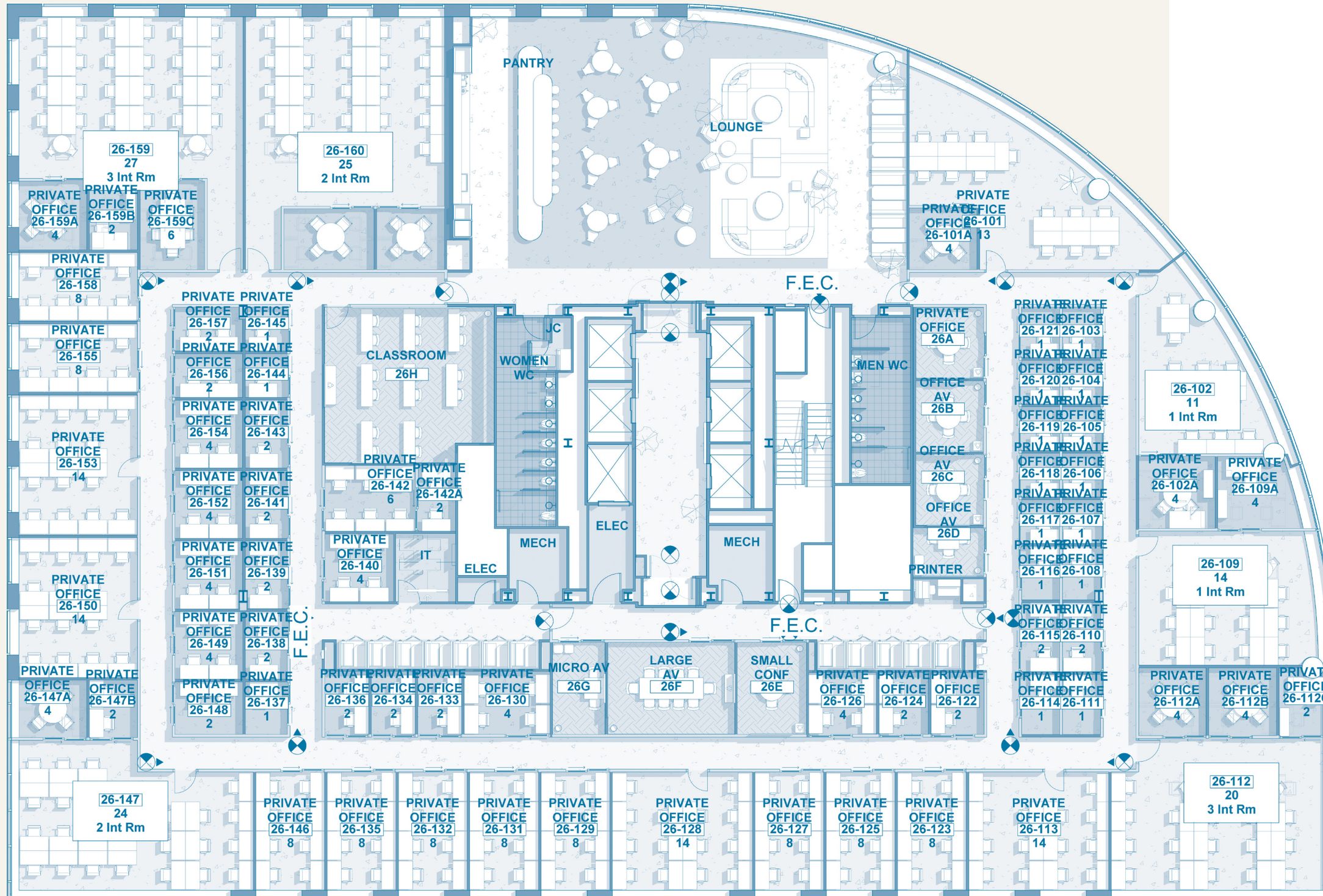

27th Floor

21,660 RSF

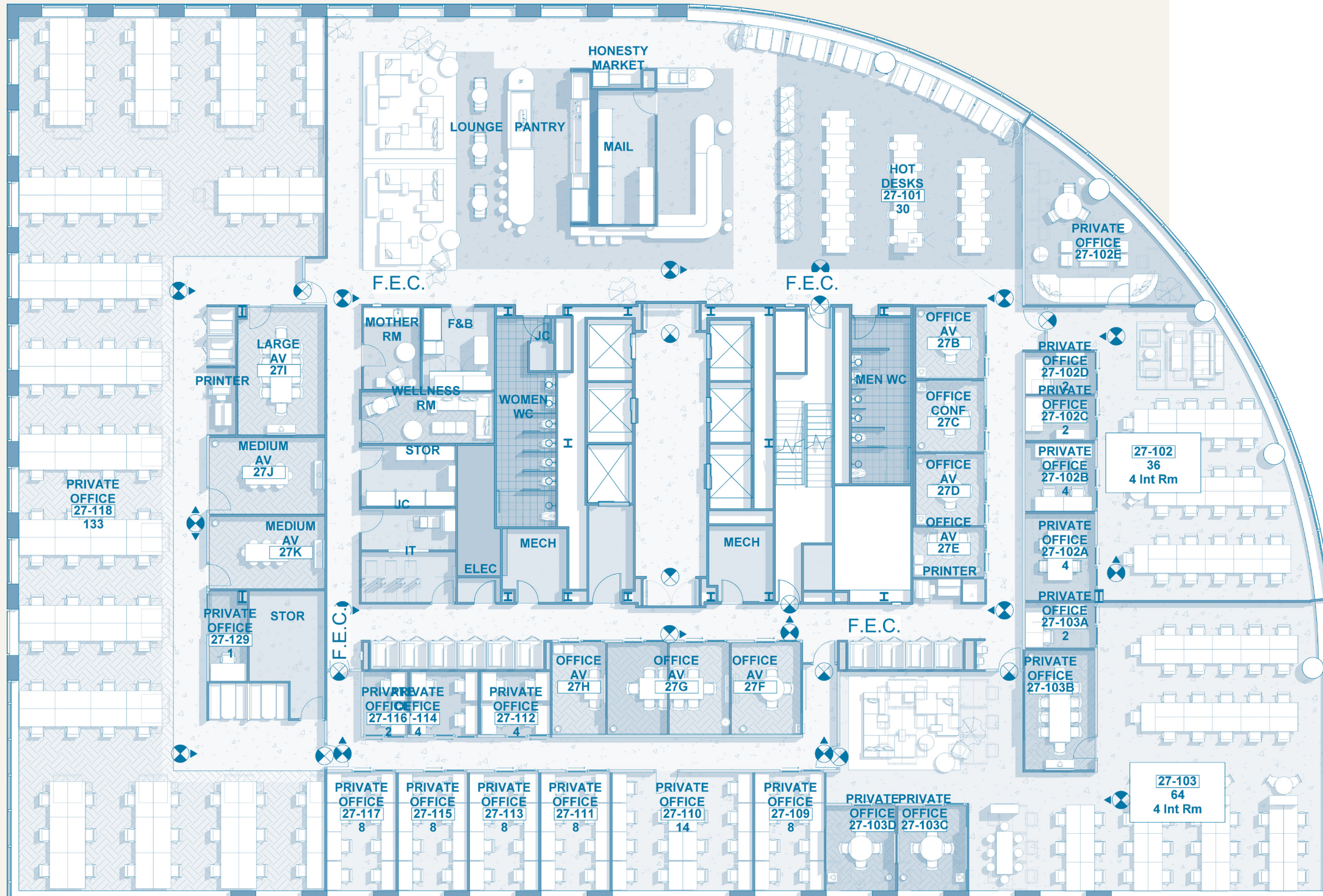



The city at your doorstep

Tabor Center's prime LoDo location allows for quick and easy access to Interstate I-25, Union Station, and the 16th Street pedestrian mall. Surrounded by bars, restaurants, and shops and steps from Larimer Square, the Denver Performing Arts Complex, and the Colorado Convention Center, Tabor Center's convenient location offers something for everyone.

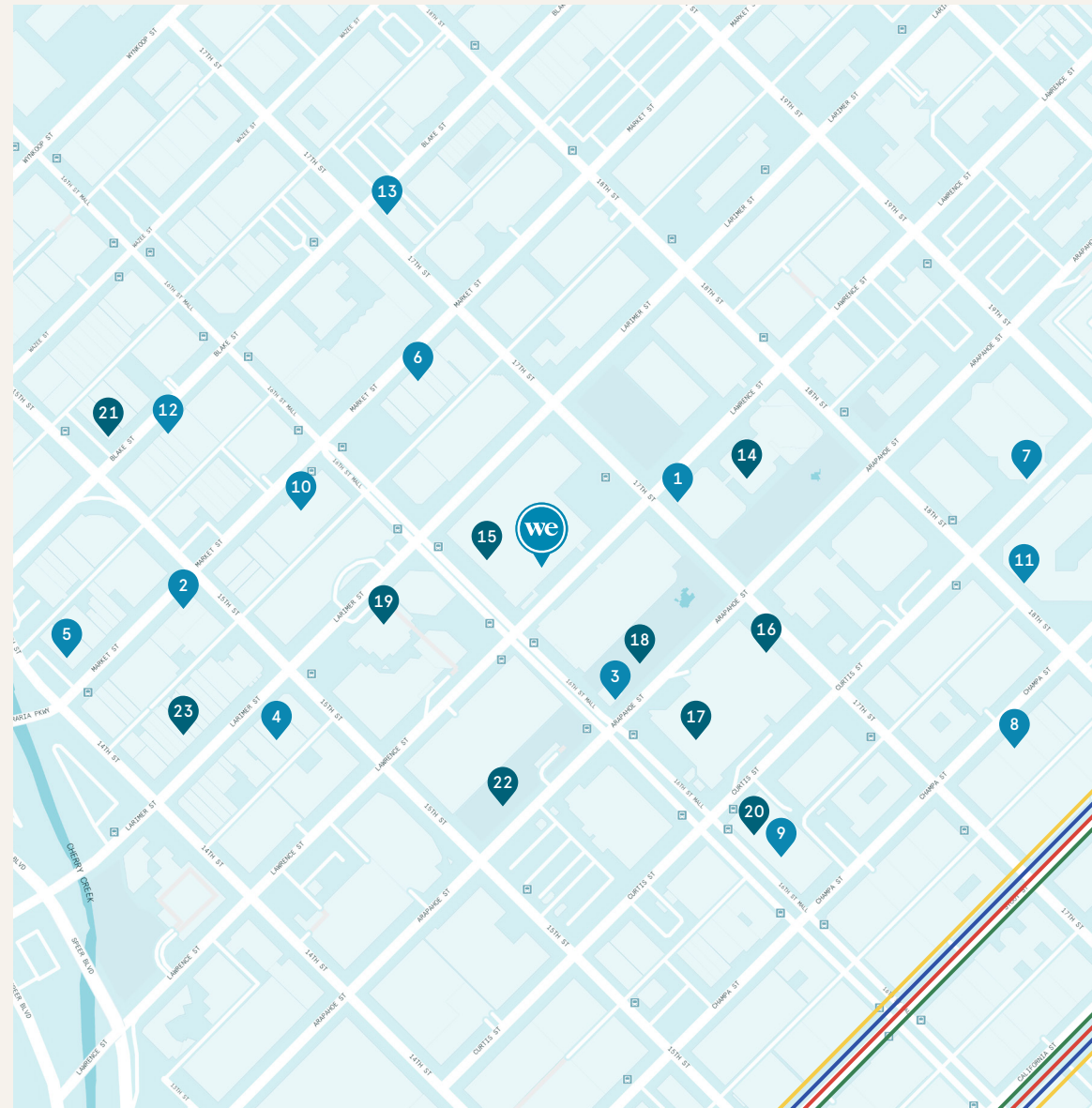

EAT & DRINK

- | | |
|------------------------|------------------------|
| 1. Starbucks | 8. 7-Eleven |
| 2. EVOO Marketplace | 9. Chili's Grill & Bar |
| 3. Skyline Beer Garden | 10. STK Steakhouse |
| 4. The Capital Grille | 11. Syrup Downtown |
| 5. Rhein Haus Denver | 12. Freshcraft |
| 6. The Delectable Egg | 13. Slice Works |
| 7. ELWAY'S DOWNTOWN | |

RETAIL, LIFESTYLE, & ENTERTAINMENT

- | | |
|--|--------------------------------------|
| 14. Club Form Denver | 19. Writer Square |
| 15. Colorado Athletic Club - 16th Street | 20. Verizon |
| 16. Wells Fargo Bank | 21. FedEx Office Print & Ship Center |
| 17. 16th Street Mall | 22. Skyline Park |
| 18. Southwest Rink at Skyline Park | 23. Cry Baby Ranch |

NEARBY TRANSPORTATION

Union Station (Amtrak, Metroride)	13 min
Interstate I-25	2.6 mi



1200 17th Street Denver, CO 80202



wework

© 2020 WeWork. The WeWork trademark and related logos are the property of WeWork Companies LLC. Any reference to third party names are for reference and informational purposes only and should not be considered an endorsement or association of WeWork or vice versa. Photographs contained herein are representative examples of various WeWork locations and do not necessarily depict the WeWork location referenced in the brochure. While reasonable efforts have been made to check the accuracy of the information contained here, WeWork, its officers, employees, directors, and representatives, make no warranty, express or implied, regarding the accuracy of the information and disclaim any liability arising from the use of the information contained herein. All dimensions are approximate and subject to variances. It is your obligation to independently verify particulars of the property. WeWork reserves the right to make changes.