

Up to 42,073 square feet of contiguous space

NOW AVAILABLE!



Eureka Mall

800 W. Harris Street, Eureka, CA 95503



- Over 60% of Humboldt County's food sales are at the Eureka Mall WinCo Foods—which does over 35,000 transactions per week.
- Eureka is a unique market featuring high consumer demand with minimal competition.
- \$320 Million dollar tourist industry in Humboldt County
- Education level is higher than the U.S. average
- Excellent mix of co-tenants including:

WinCo
Dollar Tree
AutoZone
Subway

CVS/pharmacy
Provident Credit Union
Tri Counties Bank
State Fund Insurance

Michaels
Tuesday Morning
Happy Donuts
VA Clinic
Cosmo Prof



1200 W. Harris Street, Eureka, CA 95503
(707) 268-1800
(707) 268-1801 Fax

greg.p@piersoncompany.com
www.piersoncompany.com/Available Space
www.theeurekamall.com

Eureka Mall Trade Area

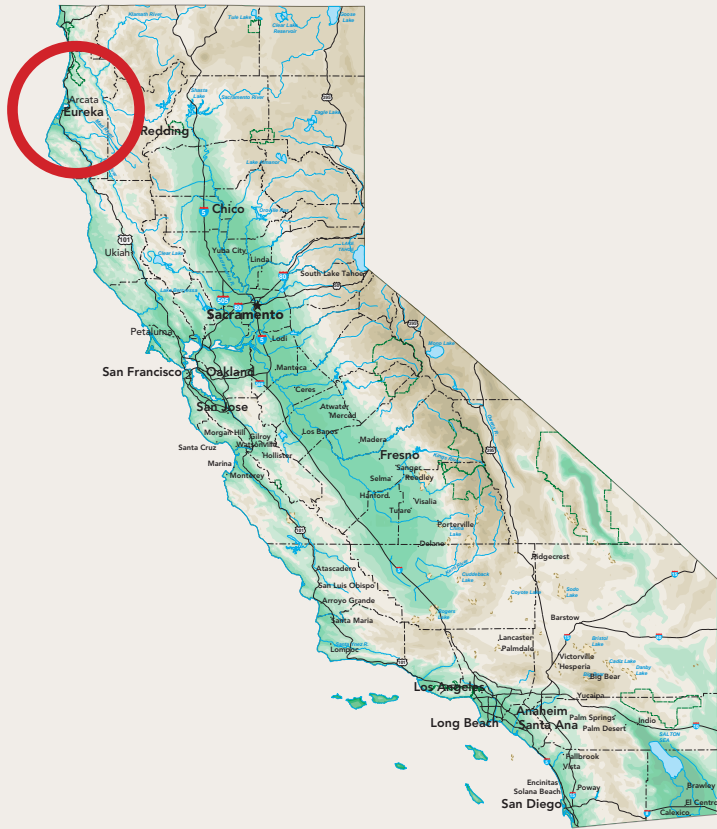

Traffic Counts (cars per day)

W. Henderson @ Central:	10,050
Central @ Harris:	3,200
W. Harris @ Central:	11,200

2016 Demographic Information

Household Income:

Trade Area	\$59,588
Estimated to increase in the next 5 years to	\$65,438

Population:

Trade Area	105,795
------------------	---------

Consumer Spending (Trade Area, Annual):

Grocery & Alcohol (for home consumption)	\$387,321,848
Apparel	\$200,957,428
Photo, Video, Audio & Computer	\$76,206,655



1200 W. Harris Street, Eureka, CA 95503
 (707) 268-1800
 (707) 268-1801 Fax

greg.p@piersoncompany.com
 www.piersoncompany.com/Available Space
 www.theeurekamall.com

Eureka Mall

tri counties bank

WinCo FOODS
 Tuesday Morning
 Everything 50% to 80% Off

Michaels
 Where Creativity Happens™

DOLLAR TREE

SUBWAY

CVS/pharmacy
 Expect something extra.

 Department of Veterans Affairs

AutoZone



Broadway Sign. Sign on US Highway 101 with excellent visibility in both directions

Bayshore Mall

Walmart
 Save money. Live better.

KOHL'S
 expect great things

PETCO
 Where the pets go.

Sears

BED BATH & BEYOND
 Beyond any store of its kind.

Pier 1 imports

ROSS
 DRESS FOR LESS

T.J. maxx

SPORTS AUTHORITY

STAPLES

Party City

planet fitness

ULTA BEAUTY



City of Eureka

Up to 42,073 s.f. of contiguous space available!

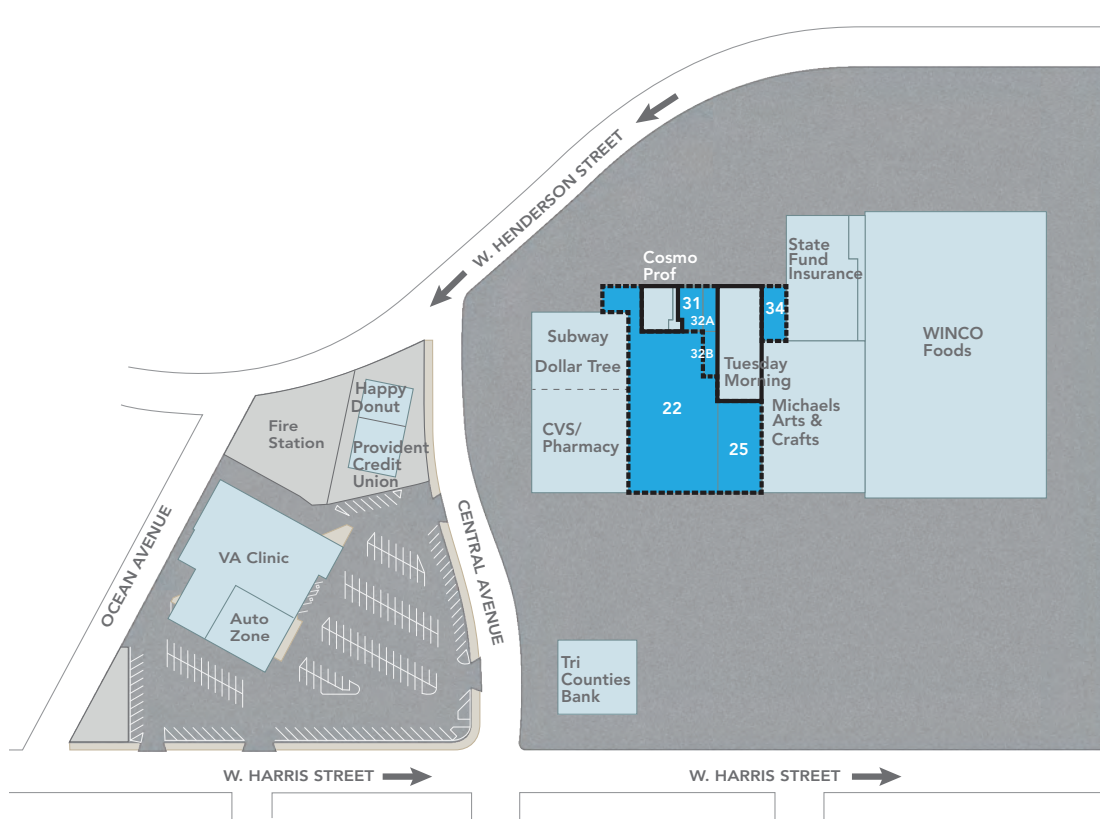
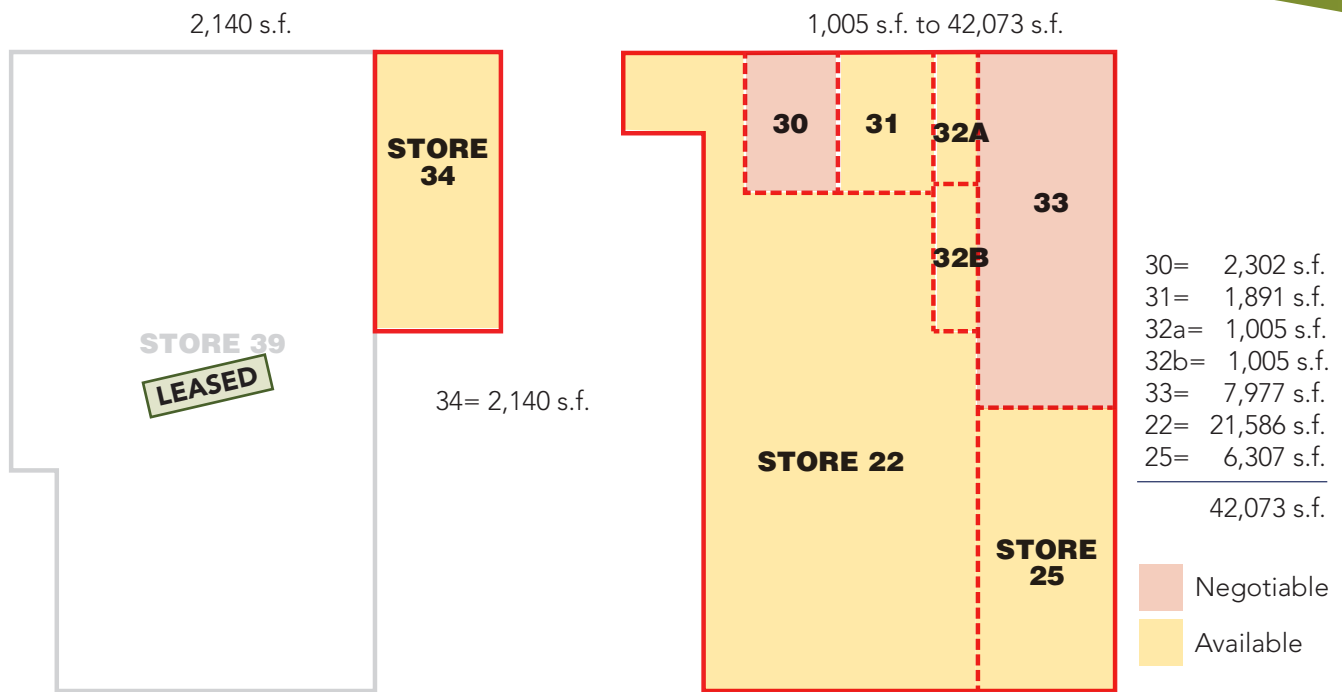

For leasing information call: (707) 268-1800 Ext. 11
www.piersoncompany.com/Available Space
www.theeurekamall.com

Eureka Mall

800 W. Harris Street, Eureka, CA 95503



1200 W. Harris Street, Eureka, California 95503
 Tel. (707) 268-1800 Fax. (707) 268-1801
 greg.p@piersoncompany.com
www.piersoncompany.com/Available Space
www.theeurekamall.com





LANDLORD WILL BE REBUILDING THIS SECTION WITH 23,761 S.F. ROOF AND ONLY 4 COLUMNS. ALSO - 19' CLEARANCE BELOW BOTTOM OF BAR JOISTS. DESIGN YOUR FACADE NOW!

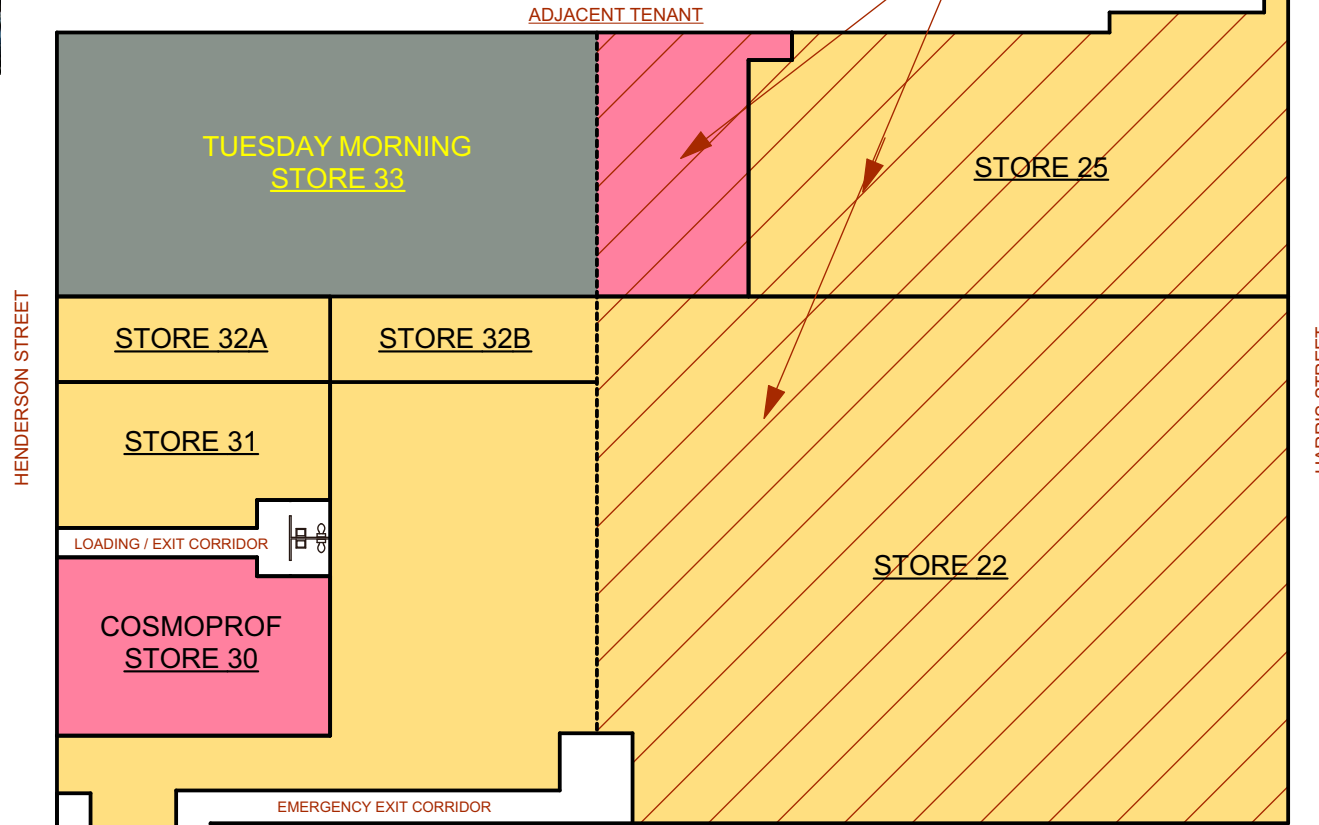
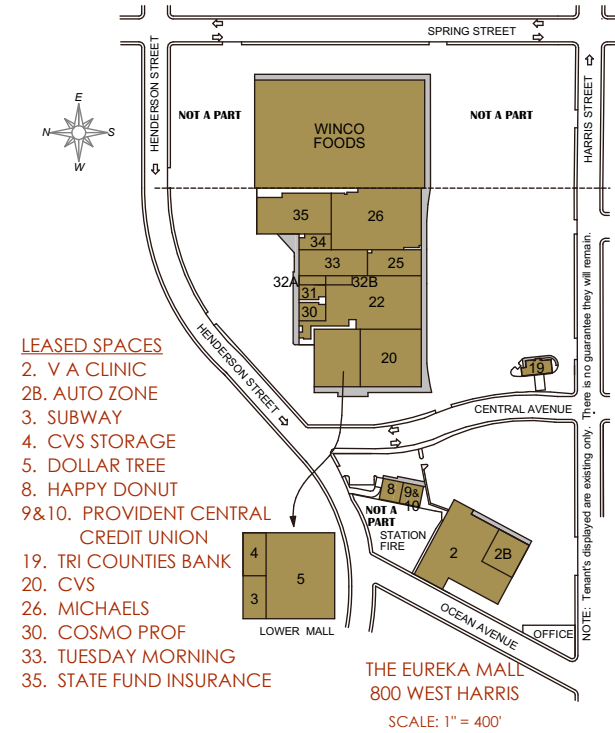

HENDERSON STREET

HARRIS STREET

AREA SUMMARY	NET	GROSS
STORE 22.....	21,347 S.F.	21,586 S.F.
STORE 25.....	6,203 S.F.	6,307 S.F.
STORE 30.....	2,258 S.F.	2,302 S.F.
STORE 31.....	1,852 S.F.	1,891 S.F.
STORE 32A.....	966 S.F.	1,005 S.F.
STORE 32B.....	966 S.F.	1,005 S.F.
STORE 33.....	7,860 S.F.	7,977 S.F.
TOTAL.....	41,452 S.F.	42,073 S.F.

CURRENT CONDITION
STORE 22: Vacant
STORE 25: Vacant
STORE 30: Negotiable (Relocation Possible)
STORE 31: Vacant
STORE 32A: Unfinished, Storage
STORE 32B: Unfinished, Storage
STORE 33: Negotiable (Relocation Possible)



1200 West Harris St.
Eureka, CA 95501

T: (707) 268-1800
www.piersoncompany.com



800 West Harris St.

Eureka, CA 95501

MAY 2016