

FOR SUBLEASE

LEASE EXPIRES ON APRIL 14, 2028

±5,589 SF INDUSTRIAL SPACE AVAILABLE

22 RICKENBACKER CIRCLE, LIVERMORE, CA 94551

LOCAL EXPERTISE. INTERNATIONAL REACH. WORLD CLASS.

Jack Snook

Associate

jsnook@lee-associates.com

925-737-4164

LIC NO 02224052

Blake Dicus

Principal

bdicus@lee-associates.com

925-786-1015

LIC NO 02074870



PROPERTY HIGHLIGHTS



±5,589 SF Industrial Space



Warehouse: ±3,000 SF
Storage: ±745 SF
Bonus Storage Shed: ±90 SF



13' - 14' Clear Height



Power: 120/208 @ 400Amps (Tenant to confirm)



17 Parking Stalls



Easily accessible from I-580 via Isabel Ave



Asking rent: \$1.29/SF Gross
Tenant pays water & electric



LED: April 14, 2028

22 RICKENBACKER CIRCLE

±5,589 SF Industrial Space

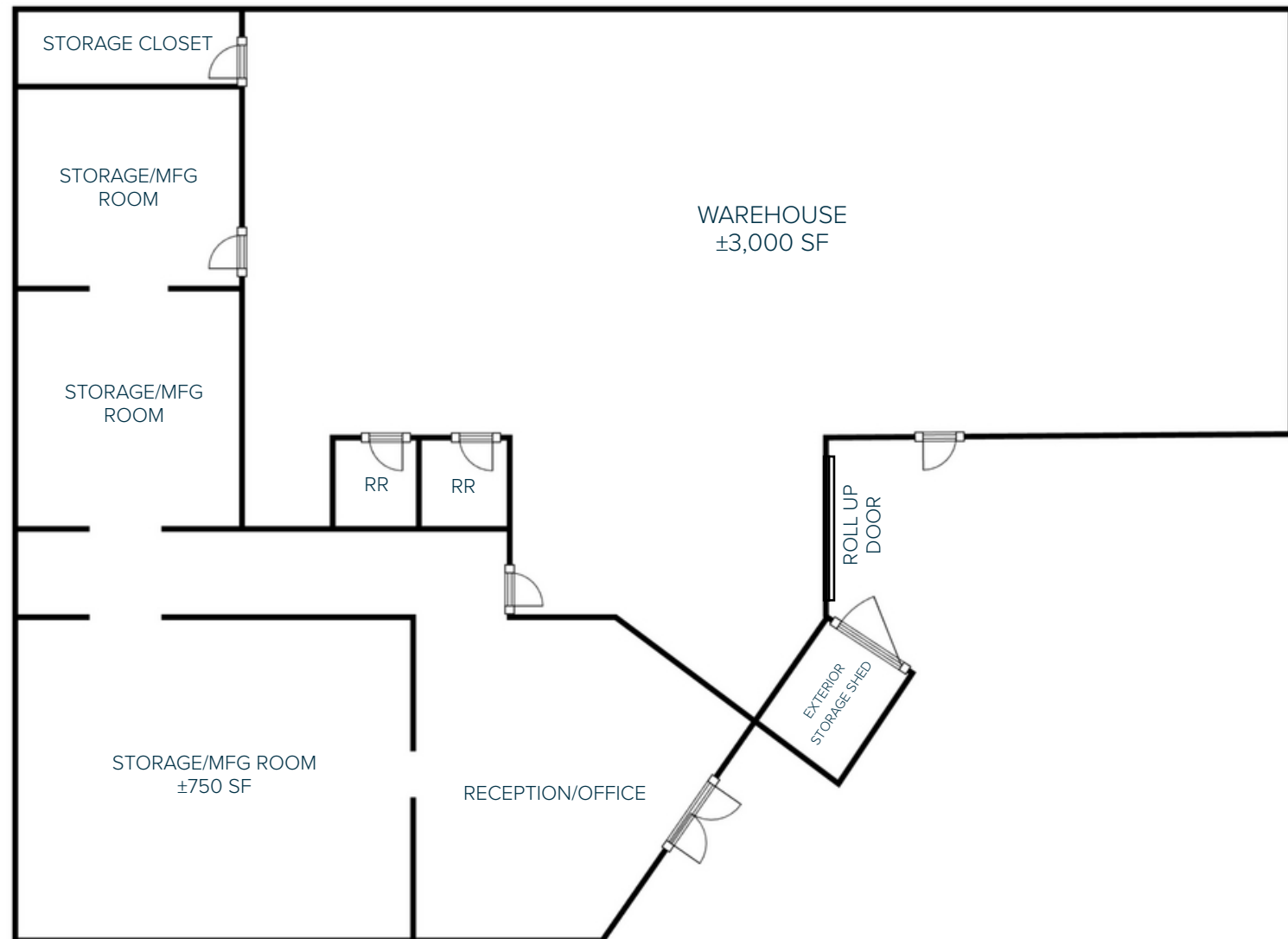

*FLOOR PLAN NOT TO SCALE



FOR SUBLEASE

±5,589 SF INDUSTRIAL SPACE AVAILABLE

22 RICKENBACKER CIRCLE | LIVERMORE, CA 94551



Jack Snook

Associate
jsnook@lee-associates.com
925-737-4164
LIC NO 02224052



Blake Dicus

Principal
bdicus@lee-associates.com
925-786-1015
LIC NO 02074870

All information furnished regarding property for sale, rental or financing is from sources deemed reliable, but no warranty or representation is made to the accuracy thereof and same is submitted to errors, omissions, change of price, rental or other conditions prior to sale, lease or financing or withdrawal without notice. No liability of any kind is to be imposed on the broker herein.

Lee & Associates® East Bay, Inc. | Corp. ID 01194869 | 5000 Pleasanton Ave, Suite 220, Pleasanton, CA 94566

LEE-ASSOCIATES.COM

22
RICKENBACKER CIRCLE