

# FURNISHED SUBLEASE

1101 14TH STREET, NW

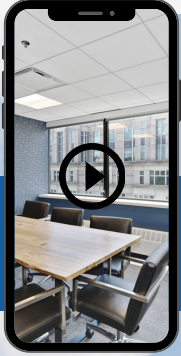

←  
3D VIDEO  
PHOTOS  
& MORE

## AVAILABLE TERMS

- 100-3,061 sq ft
- \$45.00 psf negotiable
- Tenant willing to fully vacate/cohabitate
- Fully furnished
- Available immediately

FLEXIBLE LEASE AVAILABLE



# 1101

14TH STREET NW, WASHINGTON DC

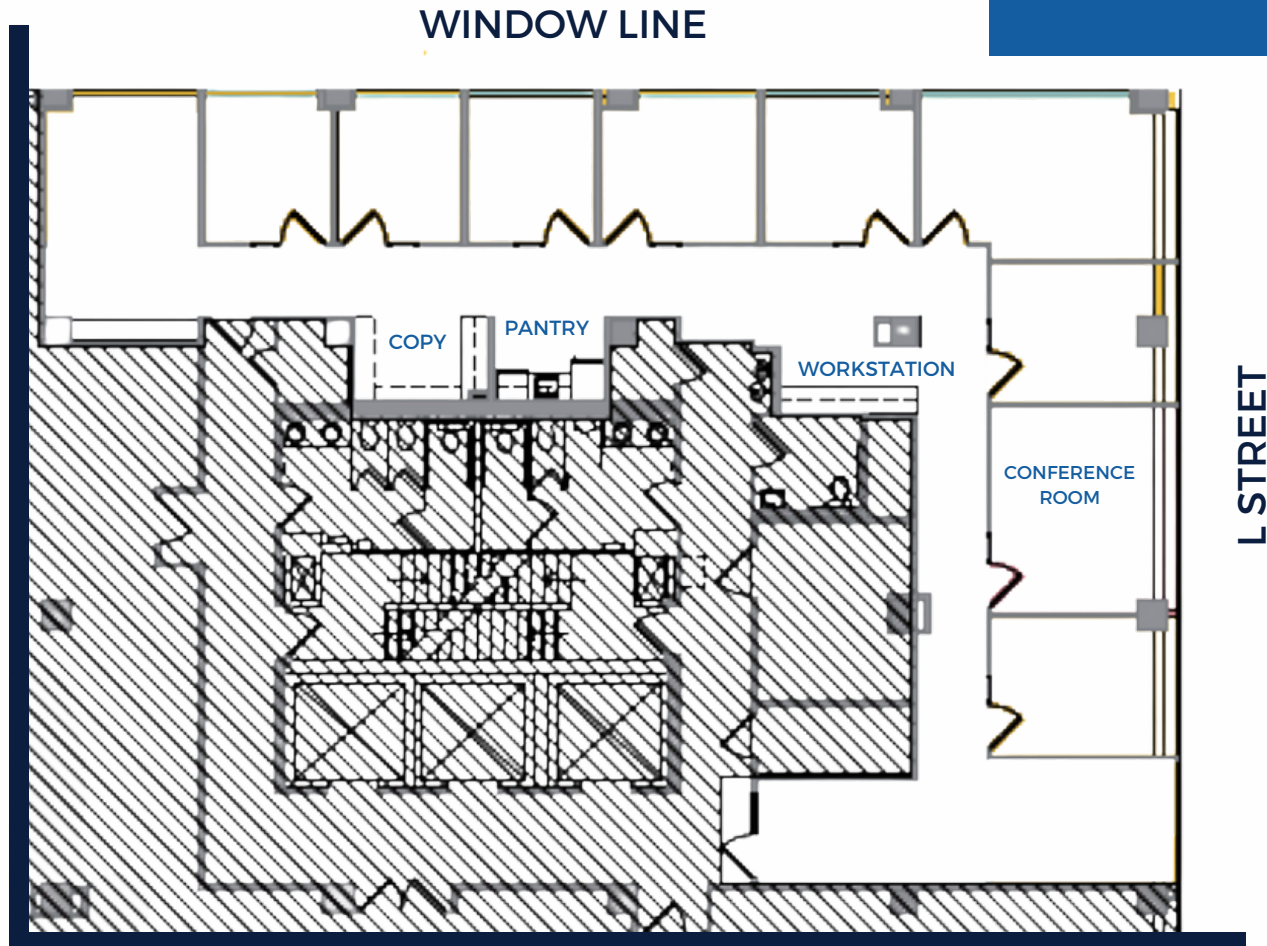

## SPACE HIGHLIGHTS

- Built out July 2019
- Untouched space (due to covid)
- Large reception area
- Corner office with excellent views
- Back door with the open bullpen, copy area, and pantry
- Eight offices
- Large conference room

FOR MORE INFORMATION PLEASE CONTACT

NORA BOWEN, Director  
(202)-290-1582  
norabowen@thegenaugroup.com

ARCHER RYMISZEWSKI, ASSOCIATE  
(610) 241-6798  
ArcherRymiszewski@thegenaugroup.com

The above information was obtained from sources we deem to be reliable. However, we have not verified its accuracy, and make no warranties thereof. It is submitted subject to the possibility of errors and omissions, as well as prior leasing and change of price. Furthermore, it may be withdrawn with or without notice without penalty.

# 1101 14th St NW, Washington DC

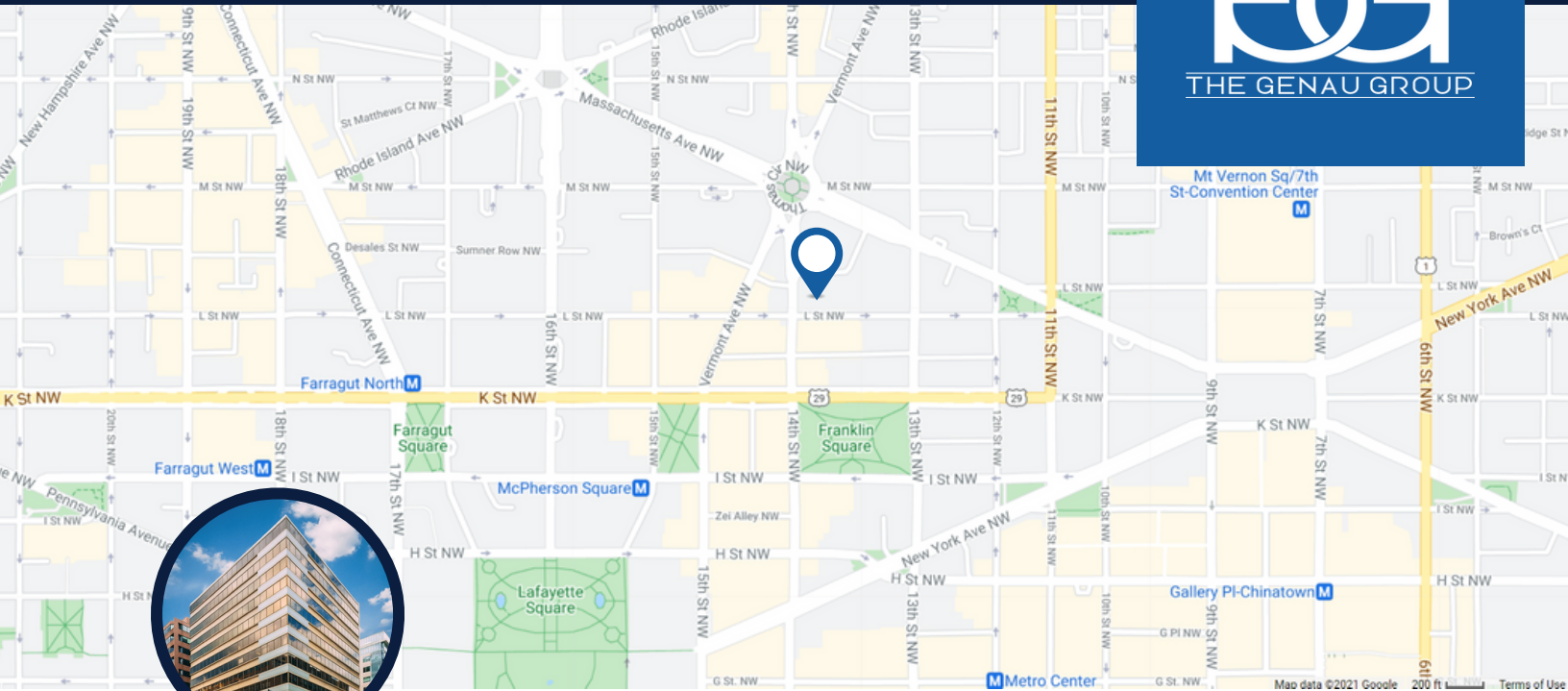

## IN WALKING DISTANCE OF



**PARKING** 80 Available (Covered)

**TRANSIT/METRO** 2 min drive to McPherson Square Transit Stop (Blue, Orange, Silver)

**COMMUTER RAIL** 5 min drive to L'Efant Commutor Rail

**AIRPORT** 12 min drive to Ronald Reagan National Airport

**WALK SCORE** Walker's Paradise (98)

**TRANSIT SCORE** Rider's Paradise (100)

The above information was obtained from sources we deem to be reliable. However, we have not verified its accuracy, and make no warranties thereof. It is submitted subject to the possibility of errors and omissions, as well as prior leasing and change of price. Furthermore, it may be withdrawn with or without notice without penalty.



1101 14th St NW, Washington DC



The above information was obtained from sources we deem to be reliable. However, we have not verified its accuracy, and make no warranties thereof. It is submitted subject to the possibility of errors and omissions, as well as prior leasing and change of price. Furthermore, it may be withdrawn with or without notice without penalty.



1101 14th St NW, Washington DC



The above information was obtained from sources we deem to be reliable. However, we have not verified its accuracy, and make no warranties thereof. It is submitted subject to the possibility of errors and omissions, as well as prior leasing and change of price. Furthermore, it may be withdrawn with or without notice without penalty.



1101 14th St NW, Washington DC



The above information was obtained from sources we deem to be reliable. However, we have not verified its accuracy, and make no warranties thereof. It is submitted subject to the possibility of errors and omissions, as well as prior leasing and change of price. Furthermore, it may be withdrawn with or without notice without penalty.



1101 14th St NW, Washington DC



The above information was obtained from sources we deem to be reliable. However, we have not verified its accuracy, and make no warranties thereof. It is submitted subject to the possibility of errors and omissions, as well as prior leasing and change of price. Furthermore, it may be withdrawn with or without notice without penalty.



1101 14th St NW, Washington DC



PLEASE **CONTACT** THE SUBLEASING TEAM FOR INFORMATION



**Nora Bowen, Director**

Phone: (202) 290-1582

Fax: (844) 839-1867

[NoraBowen@thegenaugroup.com](mailto:NoraBowen@thegenaugroup.com)



**Archer Rymiszewski, Associate**

Phone: (610) 241-6798

Fax: (844) 839-1867

[ArcherRymiszewski@thegenaugroup.com](mailto:ArcherRymiszewski@thegenaugroup.com)