

Commercial Pad for Lease

583 Berlin Cross Keys Road, Sicklerville, NJ 08081



DEMOGRAPHICS

	1 mile	3 miles	5 miles
Population:	7,368	60,848	141,845
Average HHI:	\$124,673	\$109,516	\$105,162
Employees:	3,330	17,178	41,103
Total Businesses:	468	1,999	4,737

TRAFFIC COUNTS

Berlin Crosskeys Rd (& Sicklerville Rd):	30,057
--	--------

PROPERTY HIGHLIGHTS

- +/- 5,000 SF Pad available for lease
- Potential Drive-Through available
- Ideal for free standing Retail, QSR or Medical
- Great visibility directly from Berlin Cross Keys Rd
- Located in the heart of Sicklerville Retail Corridor
- Easy & quick access to the AC Expressway & Rte 42



ARROW

Real Estate Services

Admin: 717 Limekiln Road, Doylestown, PA 18901
 HQ: 555 E. City Line Ave, Bala Cynwyd, PA 19004
 610.400.3018 | ArrowRealEstateServices.com

TCN
 WORLDWIDE
 REAL ESTATE SERVICES

RUSS MENK

609.471.7893

RussM@arrowcre.com

TAMMY RATTACASA

856.392.3735

TammyR@arrowcre.com

Commercial Pad for Lease

583 Berlin Cross Keys Road, Sicklerville, NJ 08081

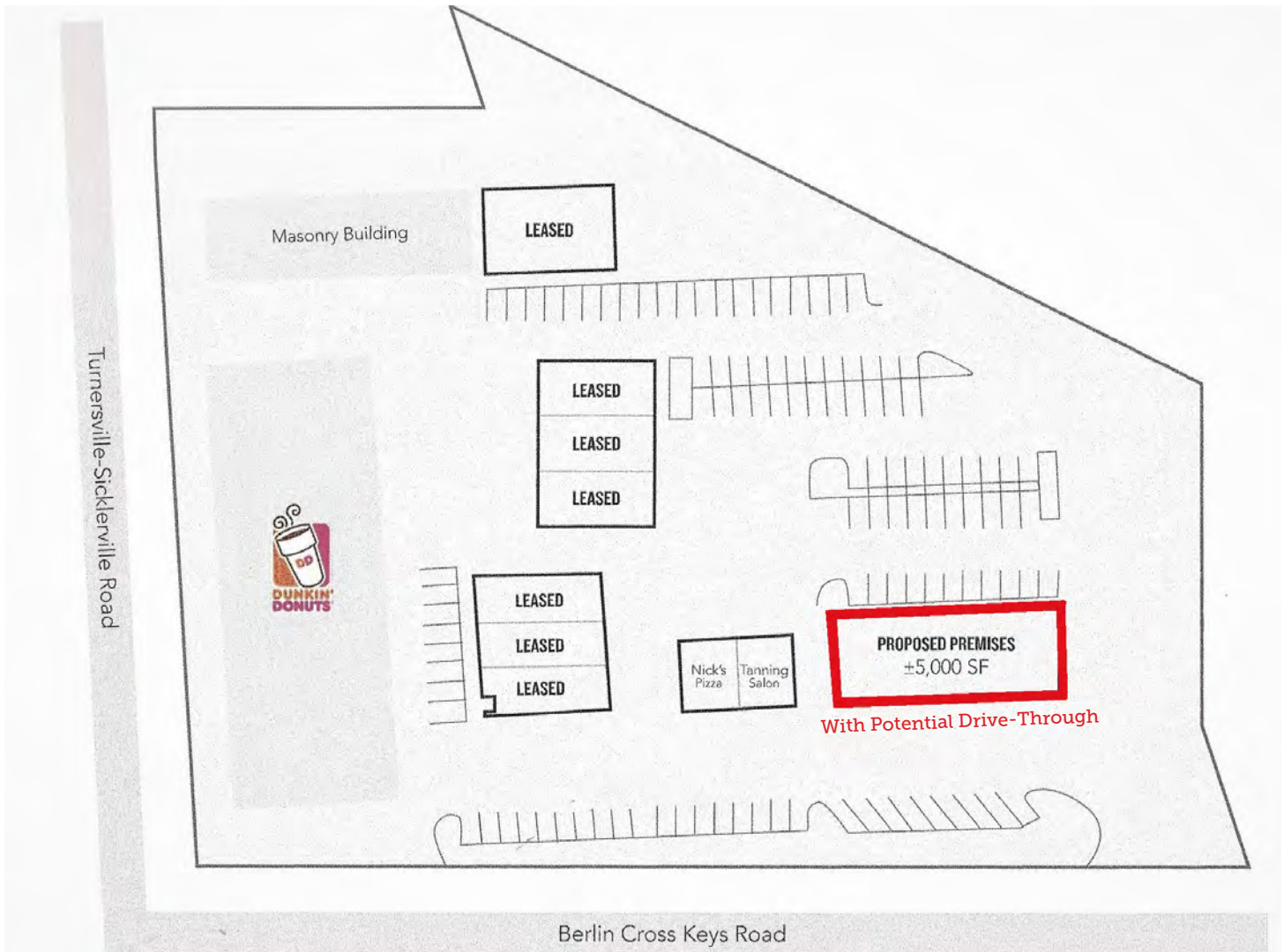

ARROW

TCN
WORLDWIDE
REAL ESTATE SERVICES

Real Estate Services

Admin: 717 Limekiln Road, Doylestown, PA 18901

HQ: 555 E. City Line Ave, Bala Cynwyd, PA 19004

610.400.3018 | ArrowRealEstateServices.com

RUSS MENK

609.471.7893

RussM@arrowcre.com

TAMMY RATTACASA

856.392.3735

TammyR@arrowcre.com

Commercial Pad for Lease

583 Berlin Cross Keys Road, Sicklerville, NJ 08081

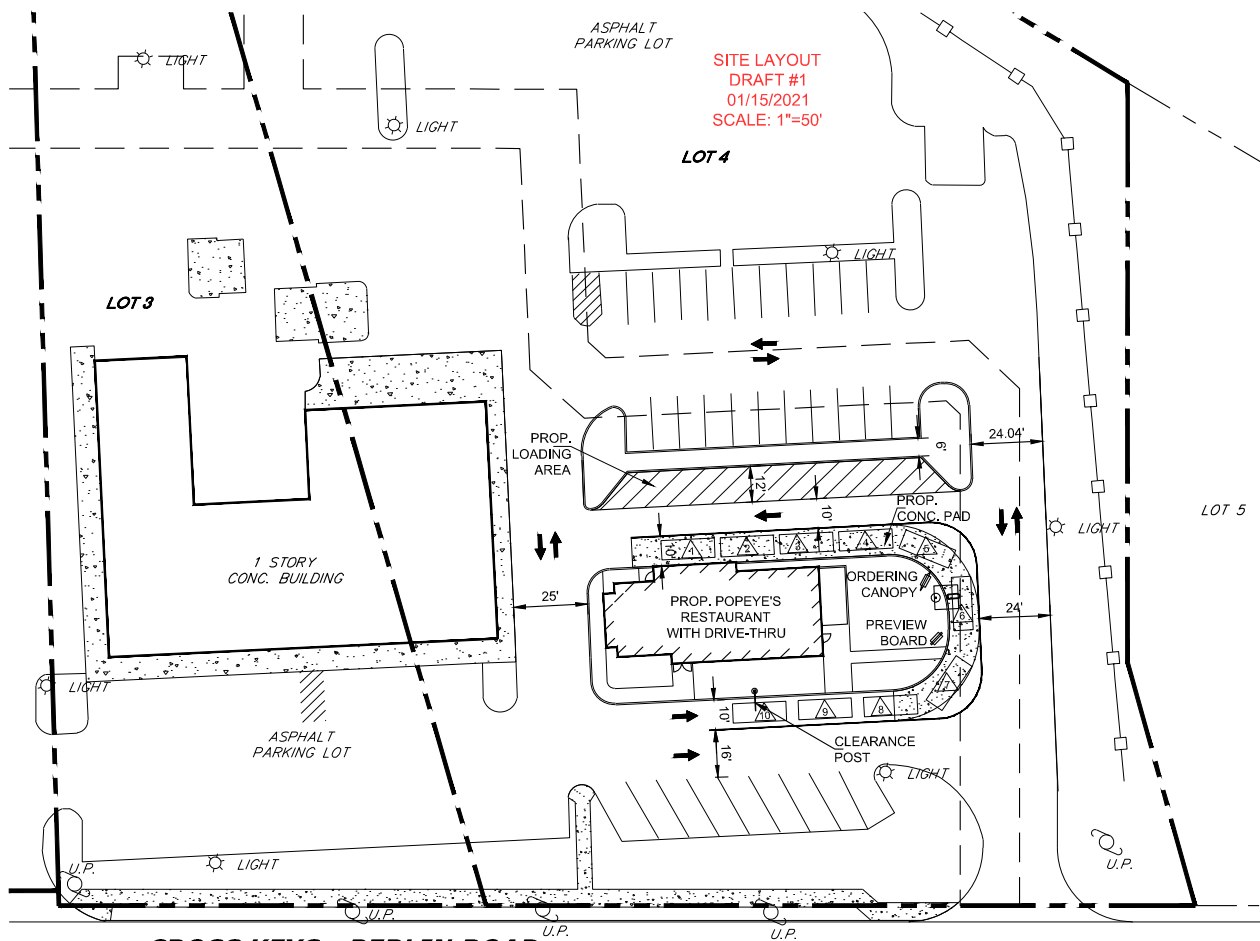

**CROSS KEYS - BERLIN ROAD
(A.K.A. COUNTY ROUTE NO. 689)
(A.K.A. CROSSKEYS ROAD)
(R.O.W. VARIES)**



ARROW

TCN
WORLDWIDE
REAL ESTATE SERVICES

Real Estate Services

Admin: 717 Limekiln Road, Doylestown, PA 18901
HQ: 555 E. City Line Ave, Bala Cynwyd, PA 19004
610.400.3018 | ArrowRealEstateServices.com

TAMMY RATTACASA RUSSE MENK

856.392.3735 609.471.7893

TammyR@arrowcre.com RussM@arrowcre.com

Commercial Pad for Lease

583 Berlin Cross Keys Road, Sicklerville, NJ 08081



Google

Map data ©2021 Imagery ©2021, Landsat / Copernicus, Maxar Technologies, U.S. Geological Survey, USDA Farm Service Agency



ARROW

Real Estate Services

Admin: 717 Limekiln Road, Doylestown, PA 18901
HQ: 555 E. City Line Ave, Bala Cynwyd, PA 19004
610.400.3018 | ArrowRealEstateServices.com



TCN
WORLDWIDE
REAL ESTATE SERVICES

TAMMY RATTACASA **RUSS MENK**

856.392.3735 609.471.7893

TammyR@arrowcre.com RussM@arrowcre.com