

CARDINAL CIRCLE INDUSTRIAL PARK

11615-11749 CARDINAL CIRCLE | GARDEN GROVE, CA 92843



PROPERTY HIGHLIGHTS

Industrial Units Available: \pm 8,640 SF at \$1.20/SF Gross

Yard Available: Approximately \pm 14,000 SF, Fenced & Paved

- Professionally Managed & Maintained Business Park
- Recently Refurbished Industrial Units
- Immediate Access to 22 Freeway
- Close Access to 405 & 5 Freeways
- M1 Zoning ([Click For Allowable Uses](#))
- \$.08/SF Common Area Maintenance Fee
- 3D Matterport Virtual Tour Available to View

For more information, please contact:

MAX P. EDDY

Associate

DRE#: 02163858

T: 562.354.2538

E: meddy@leelalb.com

BRANDON CARRILLO

Principal

DRE#: 01745362

T: 562.354.2510

E: bcarrillo@leelalb.com

GARRETT MASSARO. SIOR

Principal

DRE#: 01771471

T: 562.354.2516

E: gmassaro@leelalb.com

CARDINAL CIRCLE INDUSTRIAL PARK

11615-11749 CARDINAL CIRCLE | GARDEN GROVE, CA 92843

AVAILABLE SUITES

SUITE	SQ FT	RATE	DESCRIPTION	3D TOUR
11621	±8,640 SF	\$1.20/SF + \$.08/SF CAM	Available Now. Fully Refurbished in May, 2025. 2 (12'x12') GL Doors. 14' – 16' Clear Height. 400 Amps, 120/240V, 3 Phase Power, Clear Span Warehouse. LED Lights Throughout, Yard can be packaged. Monument Freeway Signage can be available.	 CLICK HERE TO VIEW 3D TOUR
Yard	±14,000 SF (Tenant to Verify)	TBD	Available within 30 Days of Signed Lease, Fenced & Paved Yard	

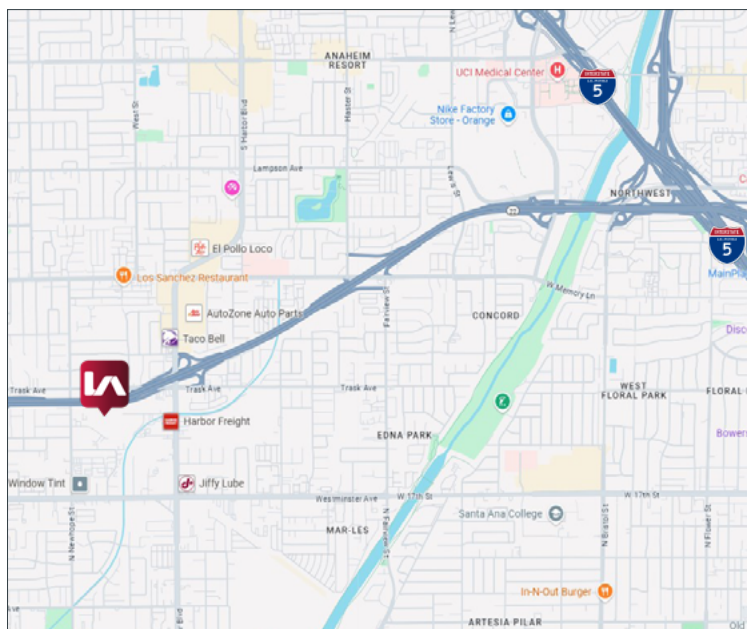

Copyright © Lee & Associates. All rights reserved. No part of this work may be reproduced or distributed without written permission of the copyright owner. The information contained in this report was gathered by Lee & Associates from sources believed to be reliable. Lee & Associates, however, makes no representation concerning the accuracy or completeness of such information and expressly disclaims any responsibility for any inaccuracy contained herein. 02.20.25

CARDINAL CIRCLE INDUSTRIAL PARK

11615-11749 CARDINAL CIRCLE | GARDEN GROVE, CA 92843

SUITE 11621 FLOOR PLAN (NOT DRAWN TO SCALE)

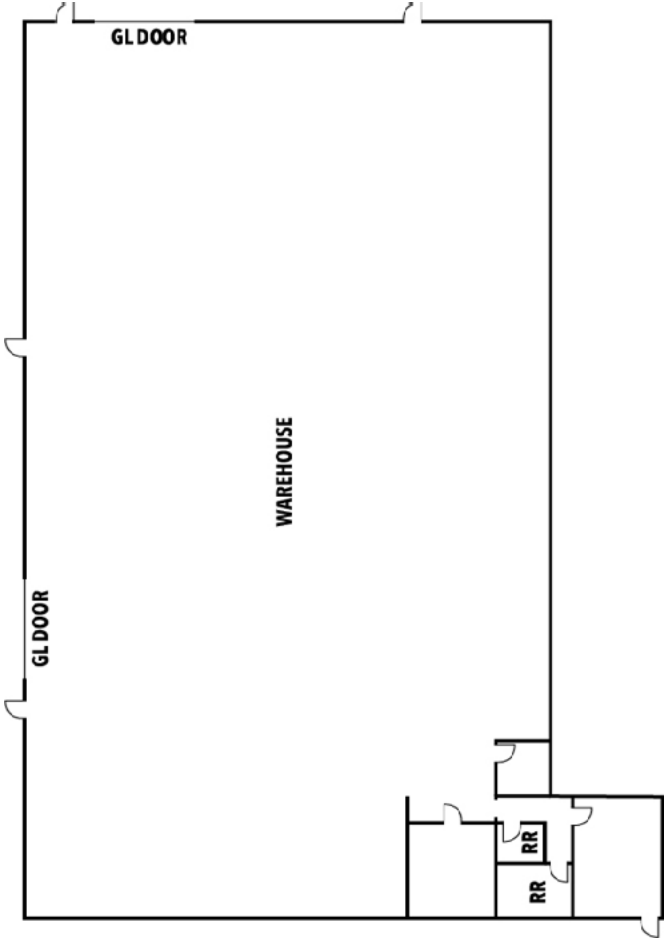

Copyright © Lee & Associates. All rights reserved. No part of this work may be reproduced or distributed without written permission of the copyright owner. The information contained in this report was gathered by Lee & Associates from sources believed to be reliable. Lee & Associates, however, makes no representation concerning the accuracy or completeness of such information and expressly disclaims any responsibility for any inaccuracy contained herein. 02.20.25