

Zachary Zakas
Partner | Co-Founder
Elmwood & Company
912.417.0009
zachary.zakas@elmwood.co

**Elmwood
& Company**



5516 Export Blvd
Garden City, GA 31408



AVAILABLE FOR
LEASE

±7,200 SF

Available May 1, 2026

EXPORT INDUSTRIAL WAREHOUSE

Only 1 Mile from Garden City Terminal • Near Highway 21 • Multi-Tenant

PROPERTY DETAILS

ADDRESS	5516-C Export Blvd
CITY, STATE, ZIP CODE	Garden City, GA 31408
PARCEL ID	60890 02004
COUNTY	Chatham
LEASE TYPE	NNN
LEASE RATE	Upon Request
ZONING	I-1 Light Industrial
AVAILABILITY	May 1, 2026
TOTAL BUILDING SIZE	±43,200 SF
AVAILABLE SF	±7,200 SF
OFFICE	±526 SF
DOCK DOORS	1 with Edge of Dock Leveler
DRIVE IN DOORS	1 Drive In Door
BUILDING HEIGHT	22'
TRUCK COURT	Concrete
FLOOR	6" Reinforced Concrete
LIGHTING	Warehouse LED Lighting
POWER	3 Phase, 4-Wire, 200 Amp
FIRE SUPPRESSION	Wet Sprinkler System
UTILITIES	Electric, Gas, Water, Sewer, Heating

SITE PLAN

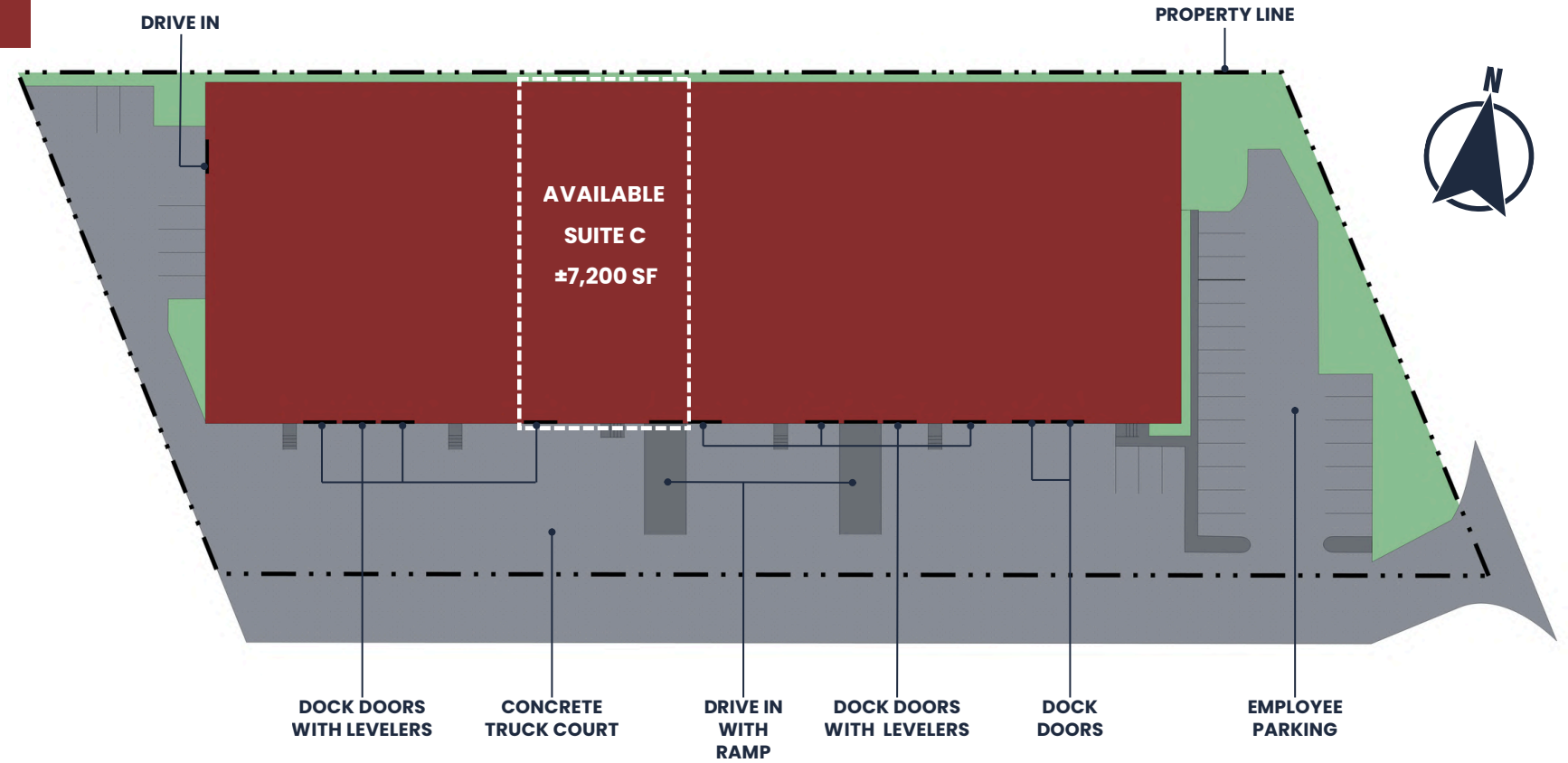

FLOOR PLAN

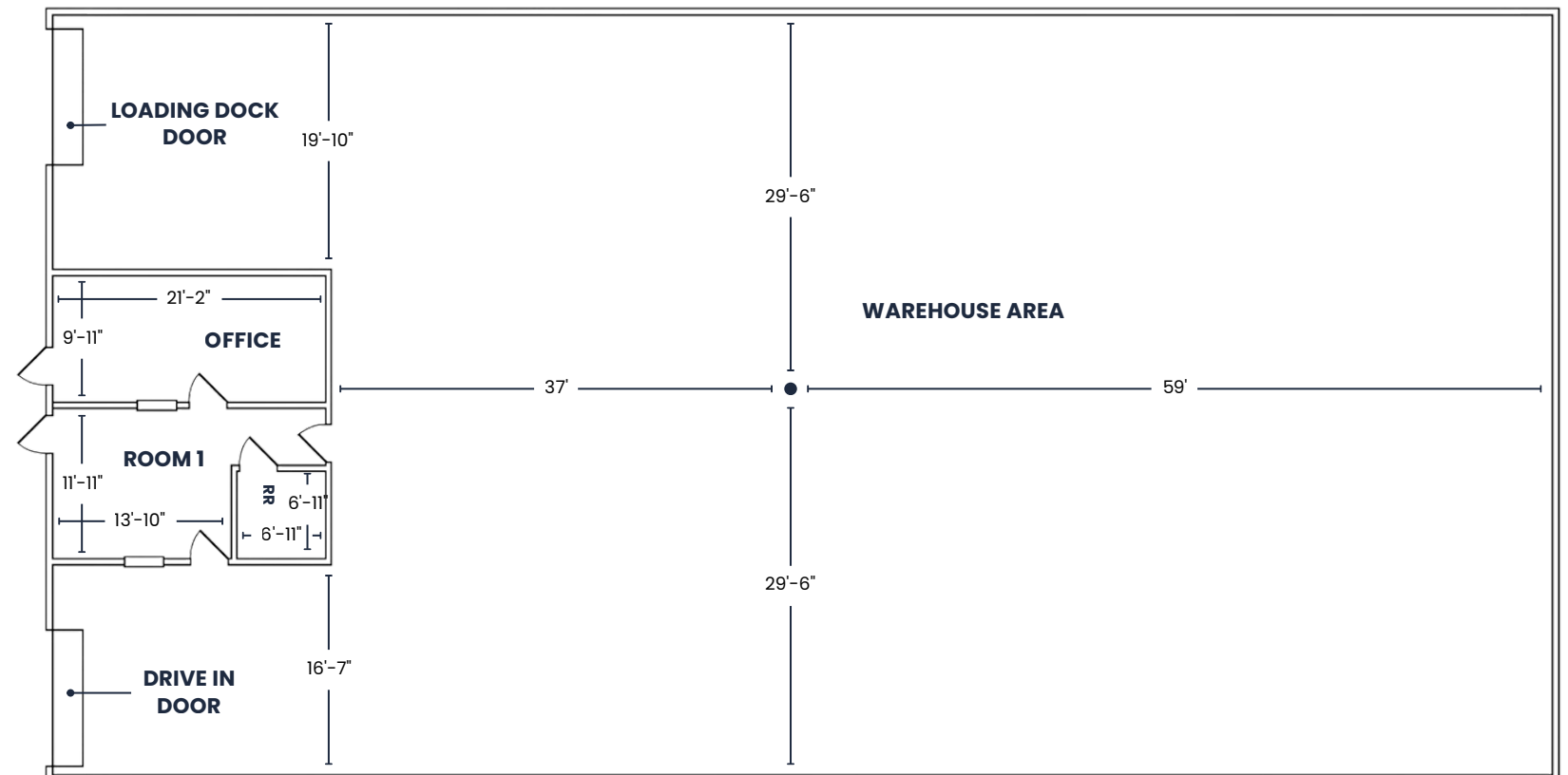

PROPERTY PHOTOS



PROPERTY PHOTOS



LOCATION OVERVIEW



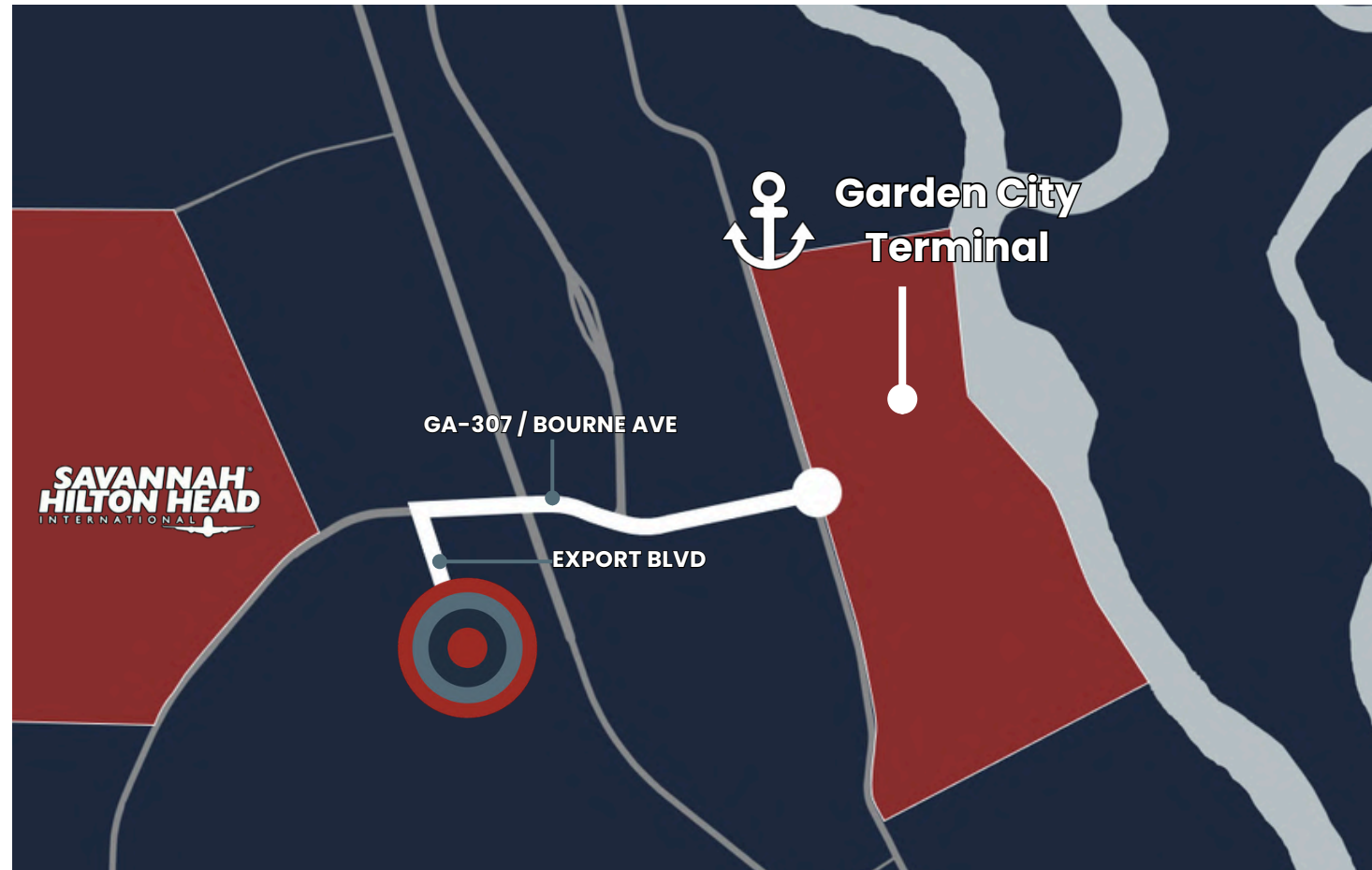

To Garden City Terminal

via **GA-307 / Bourne Ave**

- ↑ **Head** toward **GA-307 / Bourne Ave**
- ↪ **Turn right** onto **GA-307 / Bourne Ave**
- ☑ **Continue** to enter **Garden City Terminal**



To Ocean Terminal

via **GA-21 and I-516**

- ↑ **Head** toward **GA-307 / Bourne Ave**
- ↪ **Turn right** onto **GA-307 / Bourne Ave**
- ↪ **Turn right** onto **GA-21 / Augusta Rd**
- ↑ **Continue** onto **I-516**
- ↪ Take exit 5 to **merge** onto **I-16** toward Savannah
- ↪ **Turn slightly right** onto **US-17**
- ☑ **Take** the Louisville Rd exit and enter **Ocean Terminal**



5516 Export Blvd

Garden City, GA 31408

CONTACT

Zachary Zakas

Partner | Co-Founder
Elmwood & Company
912.417.0009
zachary.zakas@elmwood.co

Savannah:

2100 Bull Street
Savannah, GA 31401

Atlanta:

1447 Peachtree St NE
Atlanta, GA 30309

Los Angeles:

9460 Wilshire Blvd.
Beverly Hills, CA 90212

Confidentiality & Disclaimer: This marketing flyer has been prepared by Elmwood & Company LLC for informational purposes only and does not constitute an offer to lease or a solicitation to lease the property described herein (the "Property"). The information contained herein has been obtained from sources believed to be reliable; however, Elmwood & Company LLC, its affiliates, and their respective agents, employees, and representatives make no representation or warranty, express or implied, as to the accuracy or completeness of the information contained herein, and nothing contained herein shall be relied upon as a promise or representation of fact. All property information, including but not limited to property descriptions, site plans, dimensions, renderings, photographs, zoning references, financial information, and availability, is provided for illustrative purposes only and is subject to errors, omissions, changes in price or terms, prior lease or withdrawal without notice. Any projections, opinions, assumptions, or estimates contained herein are provided for example only and may not represent current or future performance of the Property. Prospective tenants and other interested parties are encouraged to conduct their own independent investigations and due diligence regarding the Property, including but not limited to verification of all physical, financial, legal, and zoning information. Elmwood & Company LLC expressly disclaims any and all liability for any loss or damage arising from reliance upon the information contained herein.

PORT
INDUSTRIAL
PARK

Elmwood
& Company

 **LRC**
PROPERTIES