

Rexford Industrial Center
Dock High Loaded Project
Outstanding Industry Location
Immediate Access to (60), (605),
(10), and (57) Freeways



INDUSTRIAL SPACE - FOR LEASE

REXFORD INDUSTRIAL CENTER
City of Industry, CA



PROPERTY FEATURES

Rexford Industrial Center

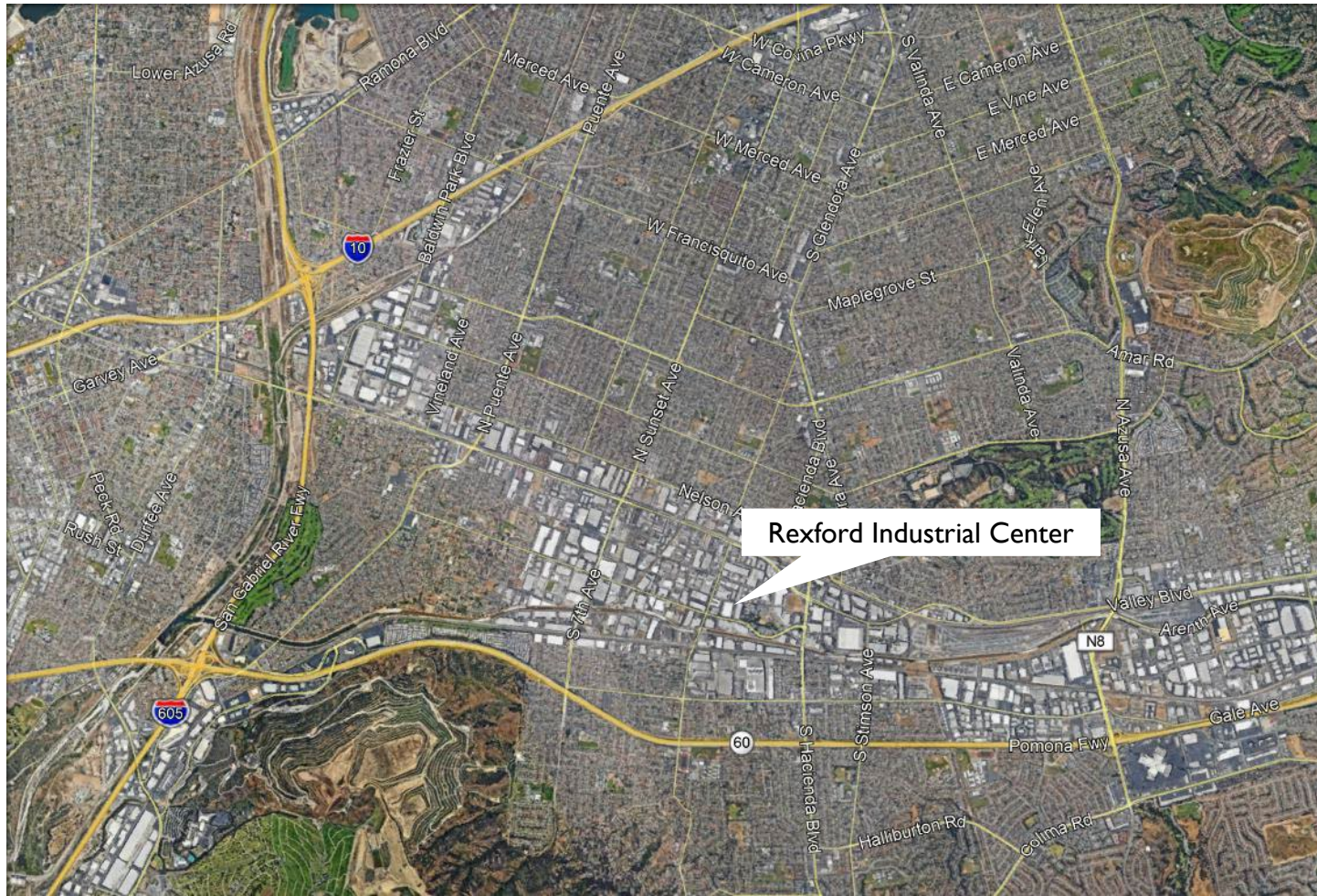

PROPERTY HIGHLIGHTS

AVAILABLE UNITS

- Outstanding Industry Location
- Immediate (60), (605), (10), & (57) Access
- Institutionally Managed Business Park
- Dock High Loaded Units
- 22-24' Minimum Clear Height
- Calculated Sprinkler System
- Newly Refurbished Offices

UNIT	SIZE	OFFICE	LOADING	AVAILABLE	PRICE
15319 Don Julian	14,756 SF	3,762 SF	3 DH, 1 GL	NOW	\$1.89 IG

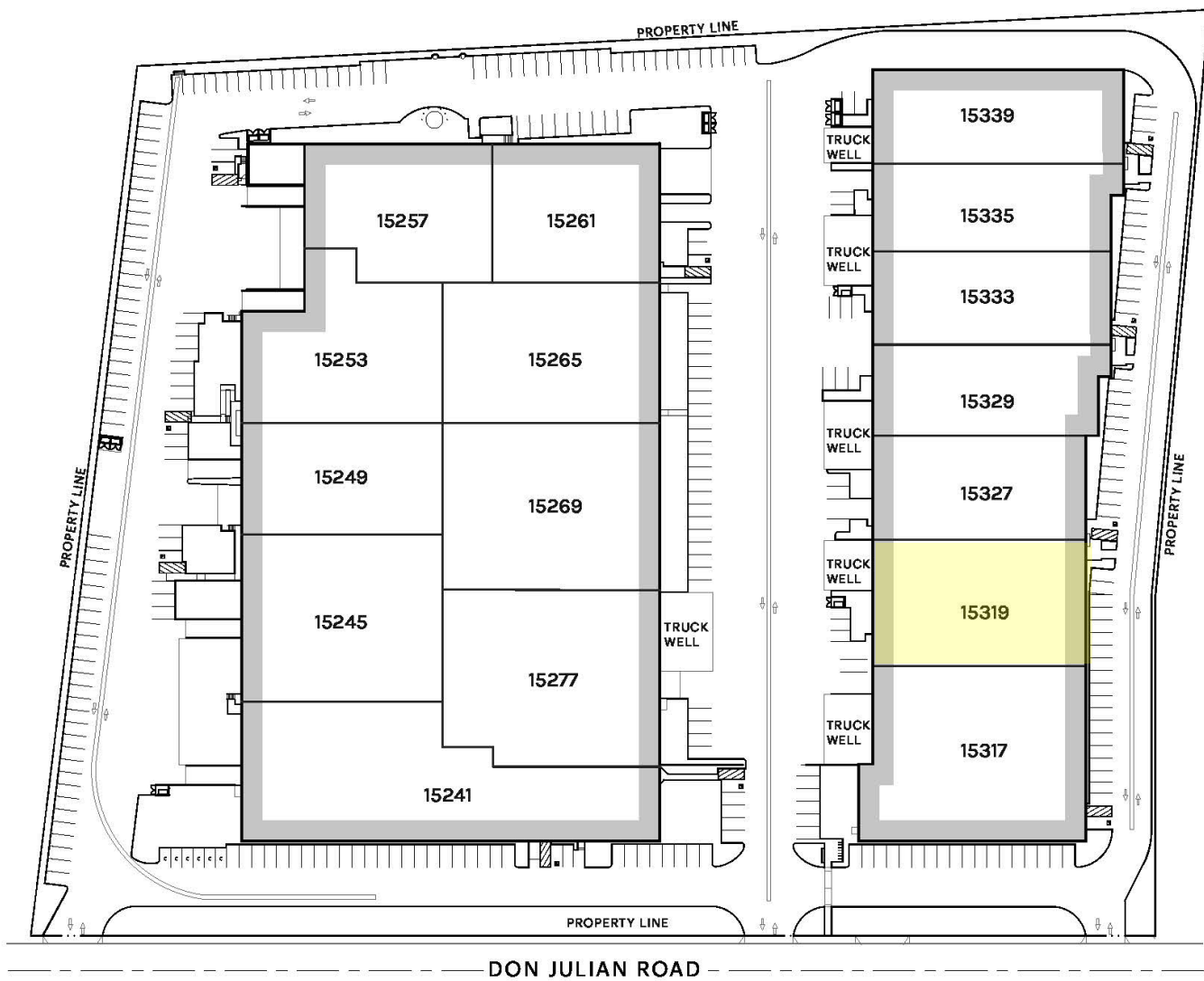

NOT TO SCALE
DATE: 11.07.18

15241-15277 & 15317-15339 DON JULIAN ROAD | CITY OF INDUSTRY

PLAN LAYOUT SUBJECT TO FIELD CONDITIONS & MAY DIFFER FROM PLAN AS SHOWN. ALL INFORMATION PRESENTED ON THIS DRAWING IS PRESUMED TO BE ACCURATE, HOWEVER TENANT SHOULD VERIFY PERTINENT INFORMATION PRIOR TO COMMITTING TO A LEASE.

SITE PLAN

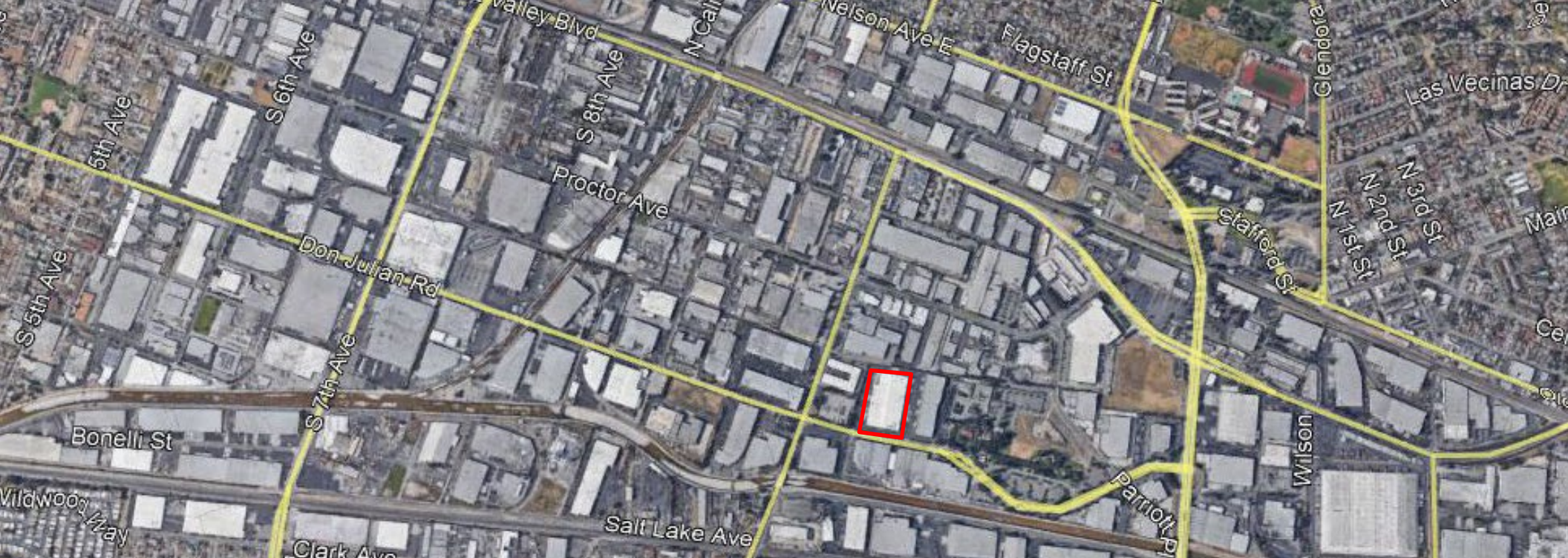

LEASING CONTACTS

Chris Tolles

Executive Managing Director | Brokerage
+1 213 955 5129
chris.tolles@cushwake.com
License: 01459899

Maya Schirn

Associate | Brokerage
+1 213 236 4931
maya.schirn@cushwake.com
License: 02237054

Erik Larson

Executive Managing Director | Brokerage
+1 213 955 5126
erik.larson@cushwake.com
License: 01213790



900 Wilshire Boulevard,
Suite, 2400
Los Angeles, CA 90017
+1 213 955 5100
License: 0061635 [Covid-19 Prevention Plan](#)

Cushman & Wakefield Copyright 2018. No warranty or representation, express or implied, is made to the accuracy or completeness of the information contained herein, and same is submitted subject to errors, omissions, change of price, rental or other conditions, withdrawal without notice, and to any special listing conditions imposed by the property owner(s). As applicable, we make no representation as to the condition of the property (or properties) in question.