

# Fremont Plaza

1791 E. State St.  
Fremont, OH 43420  
Sandusky County



## key features

- high visibility on State Street, the main street through Fremont, the seat of Sandusky County (population 60,000)
- anchor space available
- outlot also available
- daily traffic count: 12,000 on State Street / U.S. 20 Business

## demographics

	1 mile	3 miles	5 miles
population	4,287	21,591	27,649
households	1,887	9,292	11,947
avg. household income	\$65,240	\$62,195	\$62,631
daytime population	2,867	18,571	25,340

2019 estimates. Source: Applied Geographic Solutions 4/2019, TIGER Geography

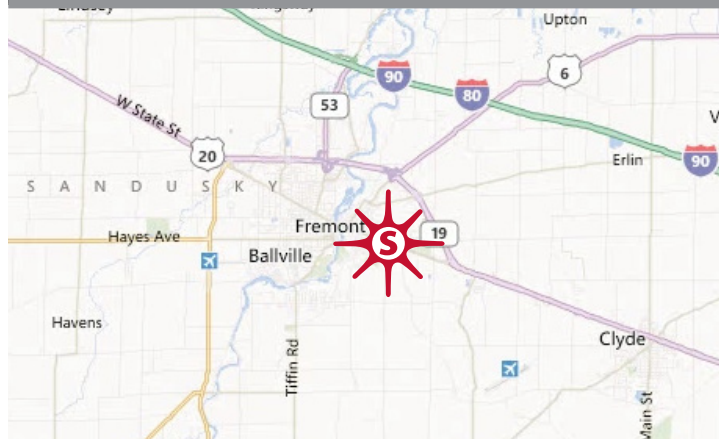

**retail space for lease**      **38,750 sf**

Nick Allred    480.385.1314    [nallred@sandordev.com](mailto:nallred@sandordev.com)

5725 N. Scottsdale Rd., Suite C-195, Scottsdale, AZ 85250

www.sandordev.com  
**sandor**

# Fremont Plaza

1791 E. State St.  
Fremont, OH 43420  
Sandusky County



UNIT	TENANT	DIMS.	S.F.
1791	AVAILABLE	125 x 310	38,750

FUTURE DEVELOPMENT	SIZE
OUTLOT AVAILABLE	±0.6 AC

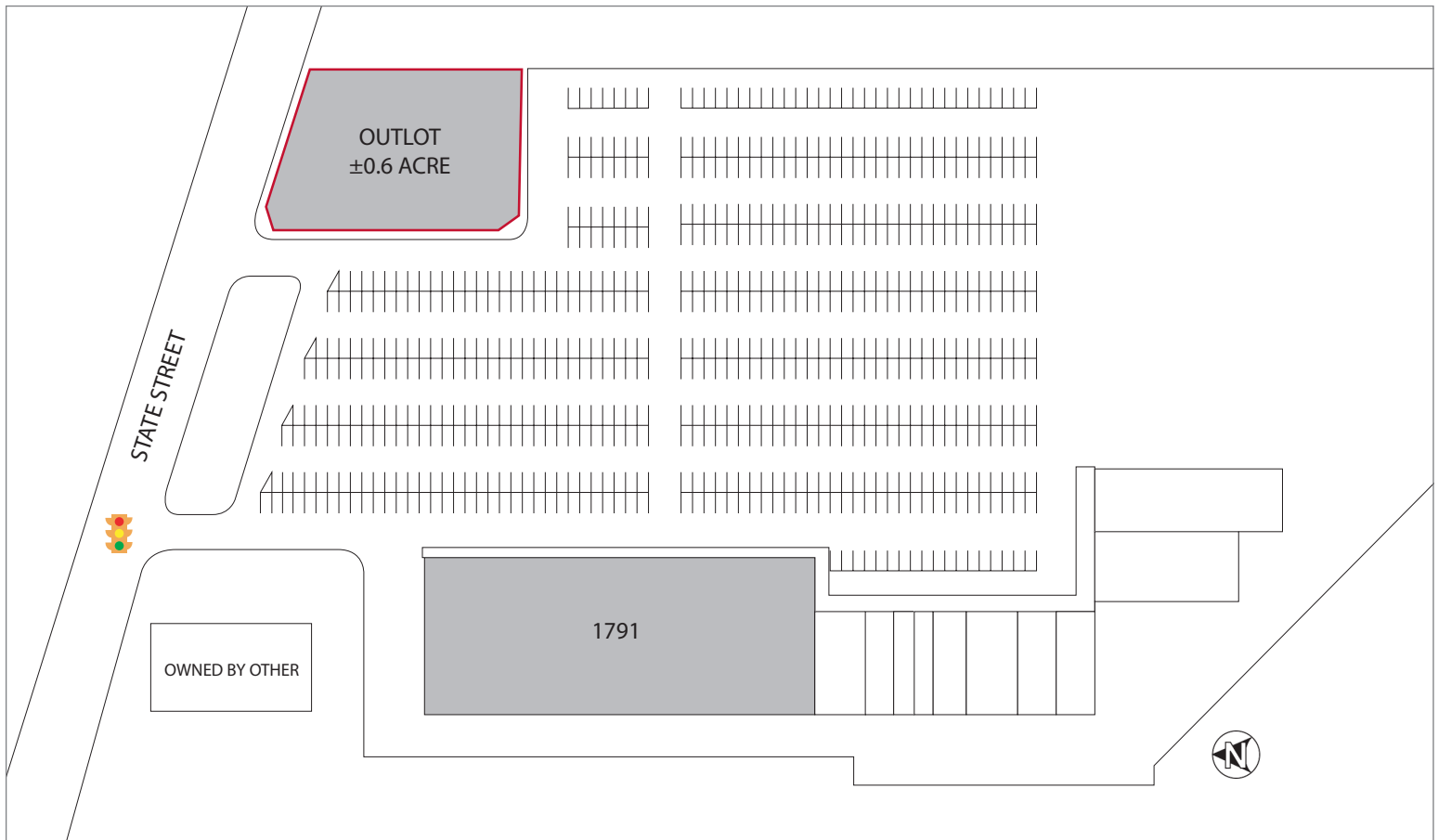

Nick Allred 480.385.1314 [nallred@sandordev.com](mailto:nallred@sandordev.com)

5725 N. Scottsdale Rd., Suite C-195, Scottsdale, AZ 85250

[www.sandordev.com](http://www.sandordev.com)  
**sandor**