

# CARLSON BUSINESS CENTER III

SOUTHWEST INDUSTRIAL  
MINNEAPOLIS-ST. PAUL

131 Cheshire Lane North  
Minnetonka, MN 55305



FOR LEASE

Suite 500

63,645 SF Available



LEASED BY



ODNEYGROUP





## CARLSON BUSINESS CENTER III

Building Size	90,166 SF
Year Built	1996
Clear Height	24'
Column Spacing	35' x 40'
Loading	Nine (9) Dock Doors Four (4) Glass Packs* <i>*can be converted to dock doors</i>

Power	800 Amp 480/277 Volt Service
-------	------------------------------

2025 CAM & Tax	\$1.96 PSF CAM \$3.30 PSF Tax \$5.26 PSF Total
----------------	--

Suite 500	28,030 SF Office 10,221 SF Tech Area 25,394 SF Warehouse 63,645 SF Total
-----------	---

Carlson Business Center is an eight building campus that can accomodate a wide range of square footages enabling its tenants to grow within the portfolio.

FOR LEASE

63,645 SF

- Freeway Visibility
- Class A Flex/light industrial/showroom space
- ESFR sprinkler system
- Truck-high docks and drive-ins
- Abundant parking for employees and guests
- Outdoor seating areas
- Convenient access to I-494, Hwy 55 & I-394
- Access to running and walking paths & trails



This is not an offer or acceptance of an offer to lease space. A lease will only be offered or made in a written agreement signed by landlord. No representation or warranty of any kind is made by landlord unless set forth in a written definitive lease executed by the landlord.

131 CHESHIRE LANE NORTH, PLYMOUTH, MN  
CARLSON BUSINESS CENTER III

# Suite 500

## Floor Plan

★ Existing Dock Doors

★ Glass Packs  
(Can be converted to dock doors)

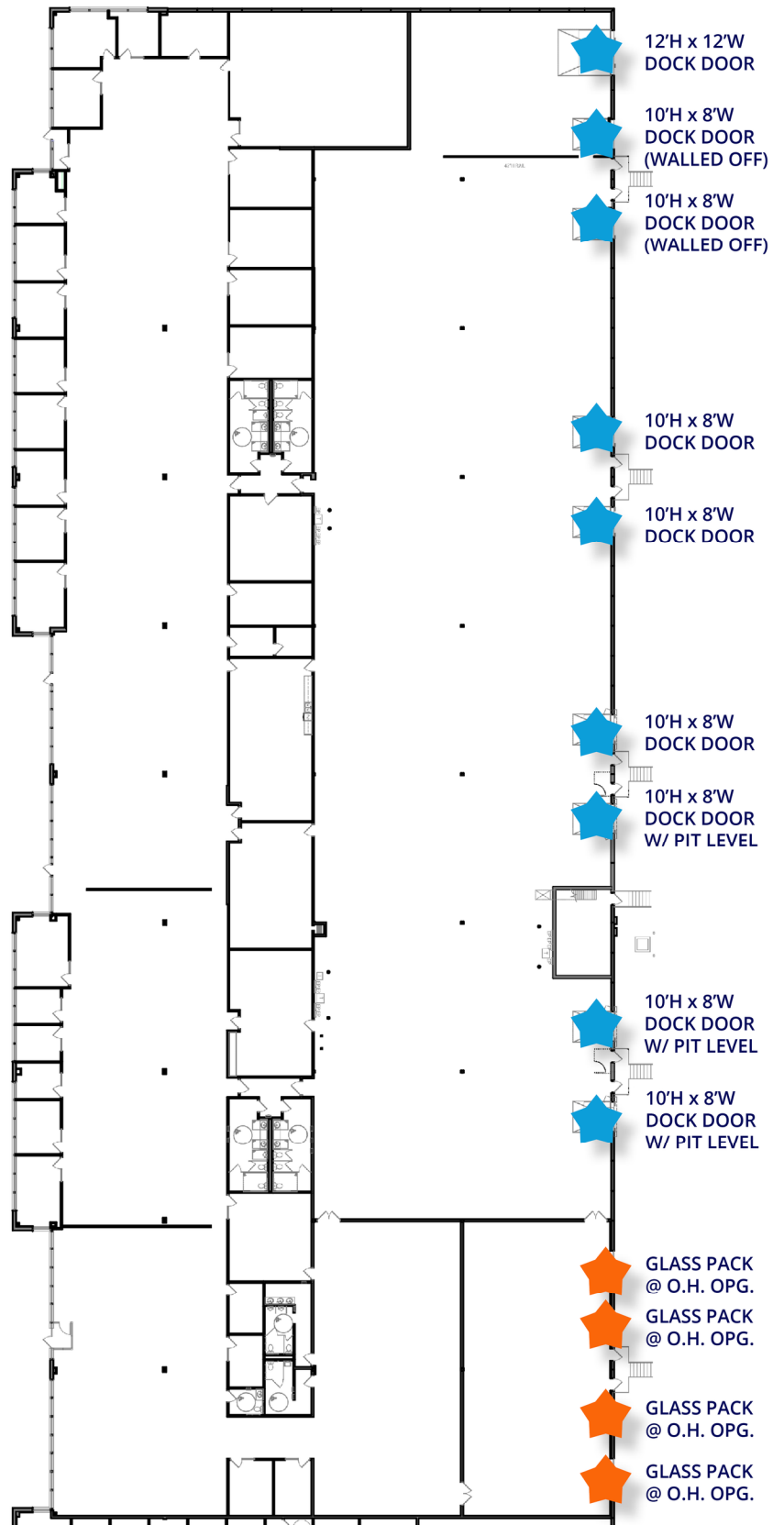



# SITE MAP



# NEARBY AMENITIES



# CONTACT INFORMATION

131 Cheshire Lane North  
Minnetonka, MN 55305

**Ryan Krzmarzick**

ryan.k@colliers.com

952 897 7746

**Andrew Odney**

andrew@odneygroup.com

612 614 0053

This is not an offer or acceptance of an offer to lease space. A lease will only be offered or made in a written agreement signed by landlord. No representation or warranty of any kind is made by landlord unless set forth in a written definitive lease executed by the landlord.



LEASED BY



 ODNEYGROUP