

# DRIVE-THRU PAD AVAILABLE FOR LEASE

**10340-10368 CENTRAL AVE**

**MONTCLAIR, CA 91763**

**±3,700 SF CONTIGUOUS**



## PROPERTY FEATURES

- ±3,700 SF of contiguous space.
- High traffic counts of: ±61,000 CPD on Central Ave.
- Walking distance from Our Lady of Lourdes Church, Saratoga Park, and Kingsley Elementary.
- High street exposure.
- Ground lease or build-to-suit drive-thru available.
- Considerable population in immediate proximity.
- An abundance of schools within a one-mile radius.

## 3 MILE RADIUS DEMOS

**206,590**  
POPULATION



**\$103,329**  
AVERAGE  
HOUSEHOLD  
INCOME

AVERAGE  
HOUSEHOLD  
INCOME

**DAYTIME**  
DEMOGRAPHICS

**123,966**

## TRAFFIC COUNTS

At Central Ave & Holt Blvd: 63,637 CPD

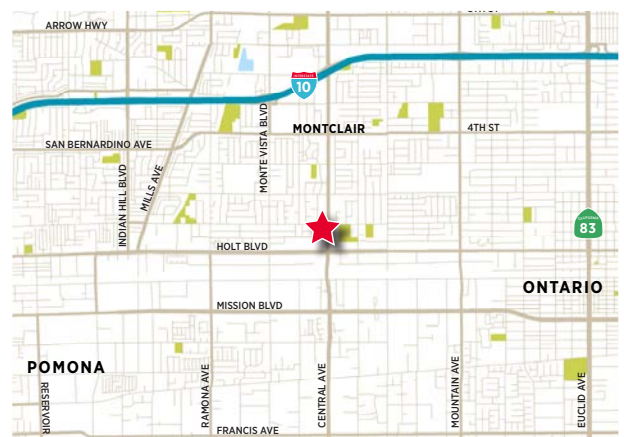

**Jack Meyer**  
Associate  
+1 909 406 4000  
jmeyer@catalystretail.com  
Lic. #02030240

**Chase Harvey**  
Partner  
+1 909 406 4000  
charvey@catalystretail.com  
Lic. #01954291

**Jay Nichols**  
Managing Partner  
+1 909 406 4000  
jnichols@catalystretail.com  
Lic. #01905191

This information has been obtained from sources believed reliable. We have not verified it and make no guarantee, warranty or representation about it. Any projections, opinions, assumptions or estimates used are for example only and do not represent the current or future performance of the property. You and your property advisors should conduct a careful, independent investigation of the property to determine to your satisfaction the suitability of the property for your needs. Revised: September 25, 2024 4:39 PM

# DRIVE-THRU PAD AVAILABLE FOR LEASE

**10340-10368 CENTRAL AVE**  
MONTCLAIR, CA 91763

AVAILABILITIES	
<b>DRIVE THRU</b>	±13,730 SF ±0.31 ACRES
<b>10360A</b>	±2,000 SF
<b>10360B</b>	±775 SF
<b>10368</b>	±925 SF

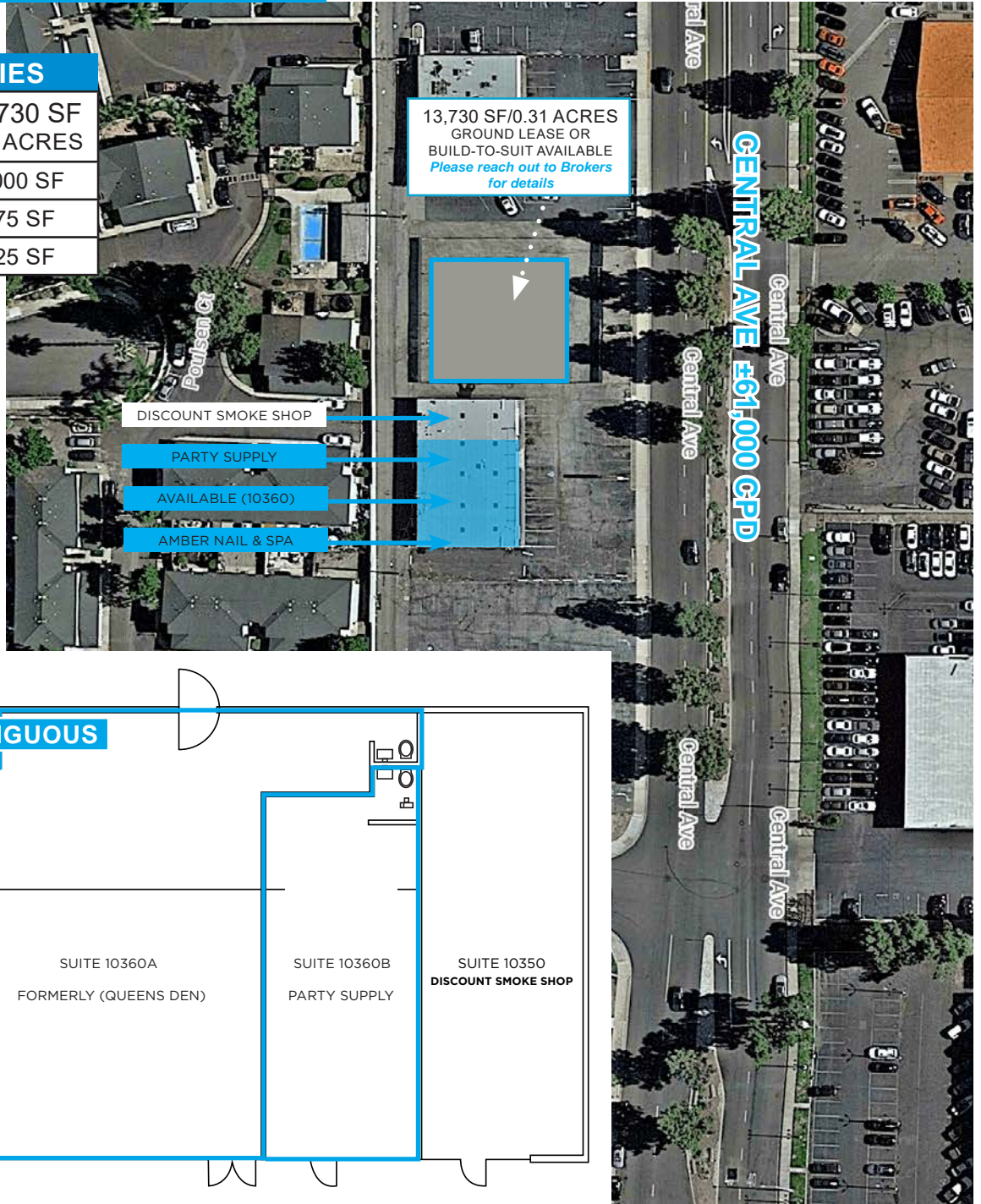

**±3,700 SF CONTIGUOUS**

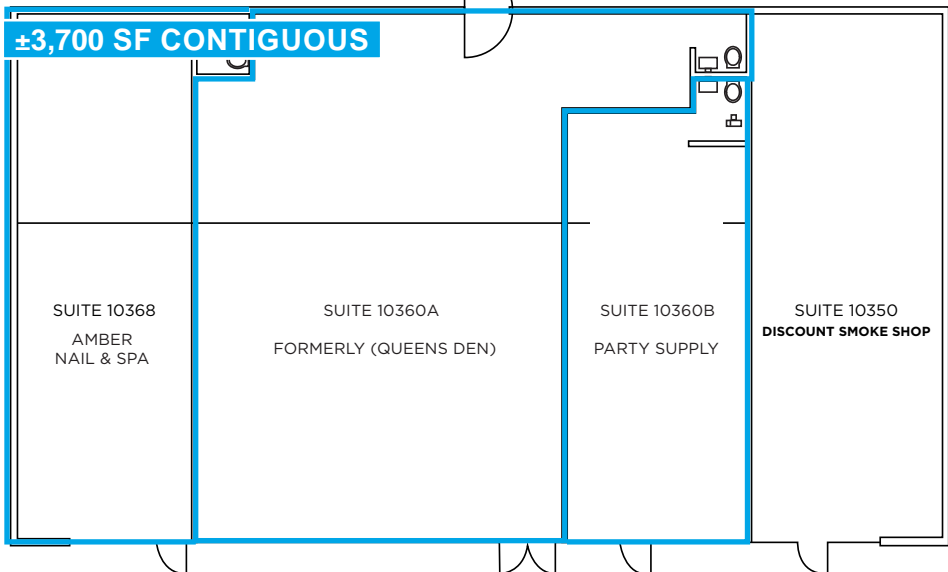

# DRIVE-THRU PAD AVAILABLE FOR LEASE

10340-10368 CENTRAL AVE  
MONTCLAIR, CA 91763



±3,700 SF CONTIGUOUS



**Jack Meyer**  
Associate  
+1 909 406 4000  
jmeyer@catalystretail.com  
Lic. #02030240

**Chase Harvey**  
Partner  
+1 909 406 4000  
charvey@catalystretail.com  
Lic. #01954291

**Jay Nichols**  
Managing Partner  
+1 909 406 4000  
jnichols@catalystretail.com  
Lic. #01905191

This information has been obtained from sources believed reliable. We have not verified it and make no guarantee, warranty or representation about it. Any projections, opinions, assumptions or estimates used are for example only and do not represent the current or future performance of the property. You and your property advisors should conduct a careful, independent investigation of the property to determine to your satisfaction the suitability of the property for your needs. Revised: September 25, 2024 4:39 PM

# DRIVE-THRU PAD AVAILABLE FOR LEASE



**10340-10368 CENTRAL AVE  
MONTCLAIR, CA 91763**

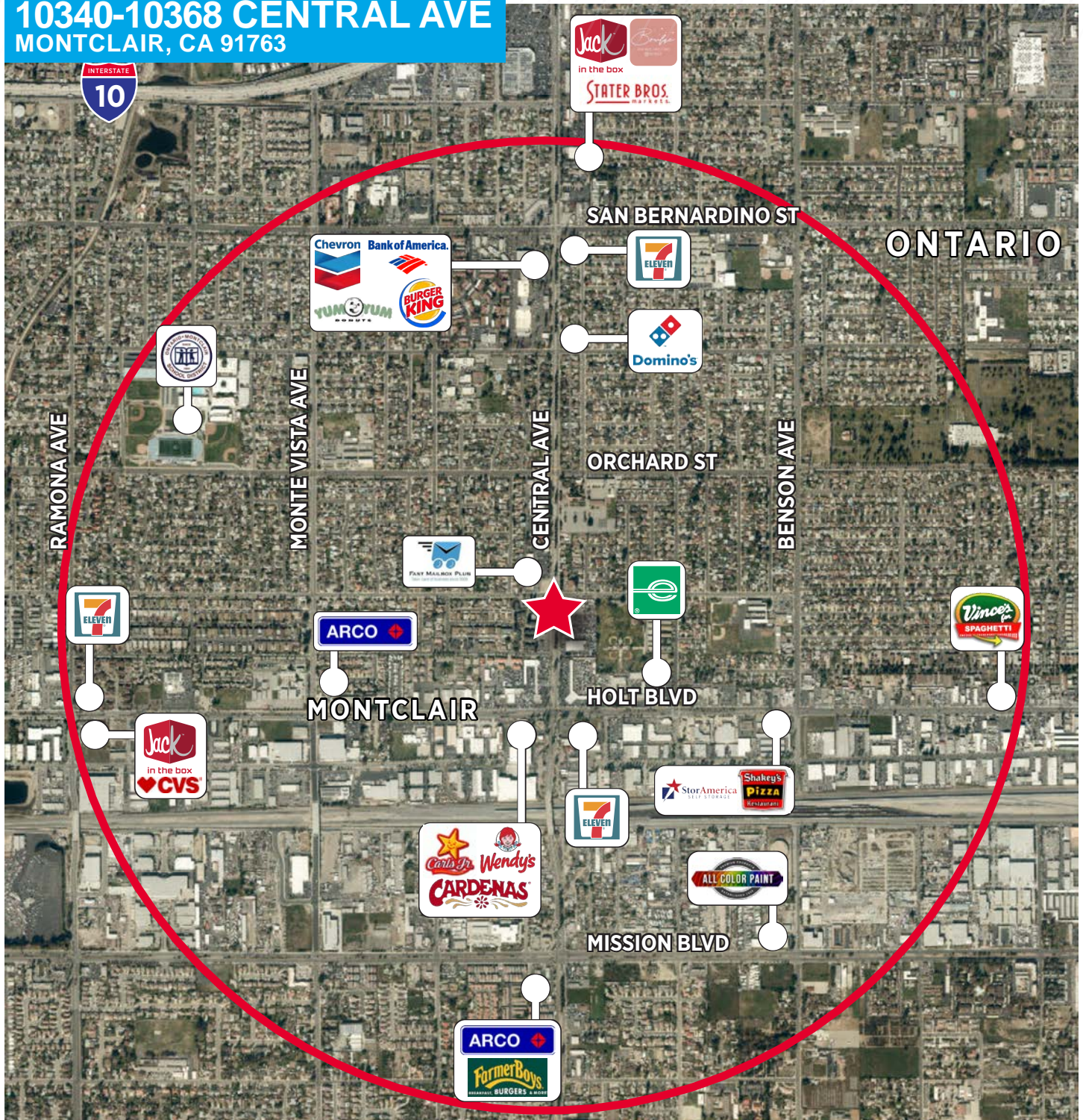

**Jack Meyer**  
Associate  
+1 909 406 4000  
jmeyer@catalystretail.com  
Lic. #02030240

**Chase Harvey**  
Partner  
+1 909 406 4000  
charvey@catalystretail.com  
Lic. #01954291

**Jay Nichols**  
Managing Partner  
+1 909 406 4000  
jnichols@catalystretail.com  
Lic. #01905191

This information has been obtained from sources believed reliable. We have not verified it and make no guarantee, warranty or representation about it. Any projections, opinions, assumptions or estimates used are for example only and do not represent the current or future performance of the property. You and your property advisors should conduct a careful, independent investigation of the property to determine to your satisfaction the suitability of the property for your needs. Revised: September 25, 2024 4:39 PM