



**425**

# JOHN QUINCY ADAMS ROAD

TAUNTON, MA

3 PAVED ACRES FENCED & SECURE WITH AN  
ADDITIONAL 4.4 ADJACENT ACRES AVAILABLE

±1,880 SF EXISTING STORAGE BUILDING



**OUTDOOR STORAGE &  
PARKING OPPORTUNITY**

**CBRE**

**MARCUS PARTNERS**

# EXISTING SITE





3 PAVED  
ACRES



±1,880 SF EXISTING  
STORAGE BUILDING

# PROPOSED SITE PLANS

## AUTO PARKING

**OPTION 1** | 376 AUTO SPACES | ±1,880 SF EXISTING BUILDING

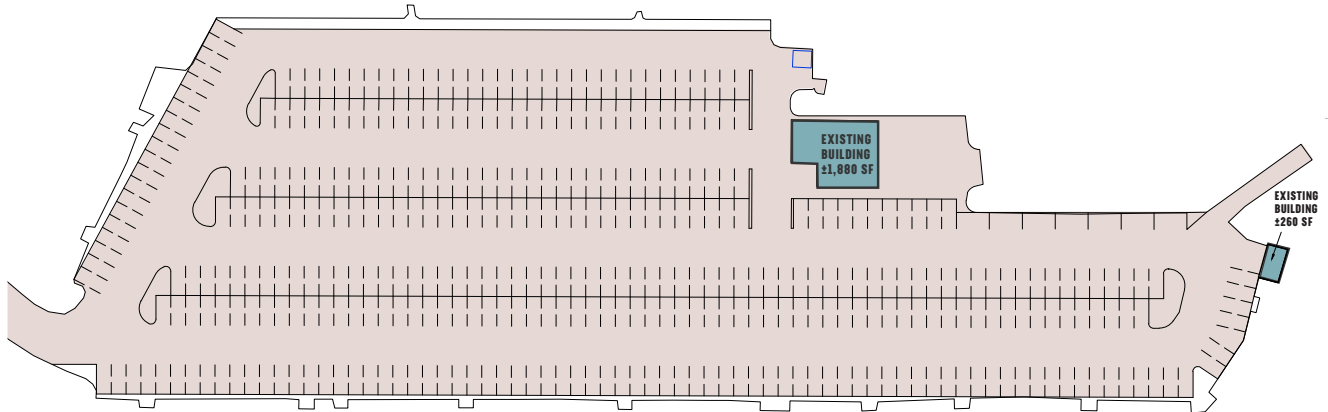

## TRAILER PARKING

**OPTION 2** | 85 TRAILER SPACES | ±1,880 SF EXISTING BUILDING

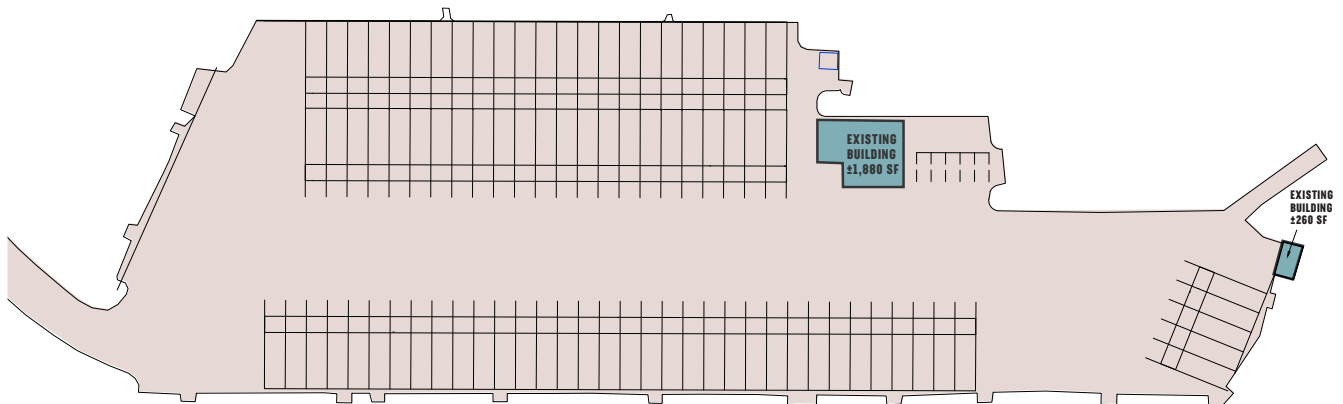

## OUTDOOR STORAGE

**OPTION 3** | ±130,890 SF (3 ACRES)

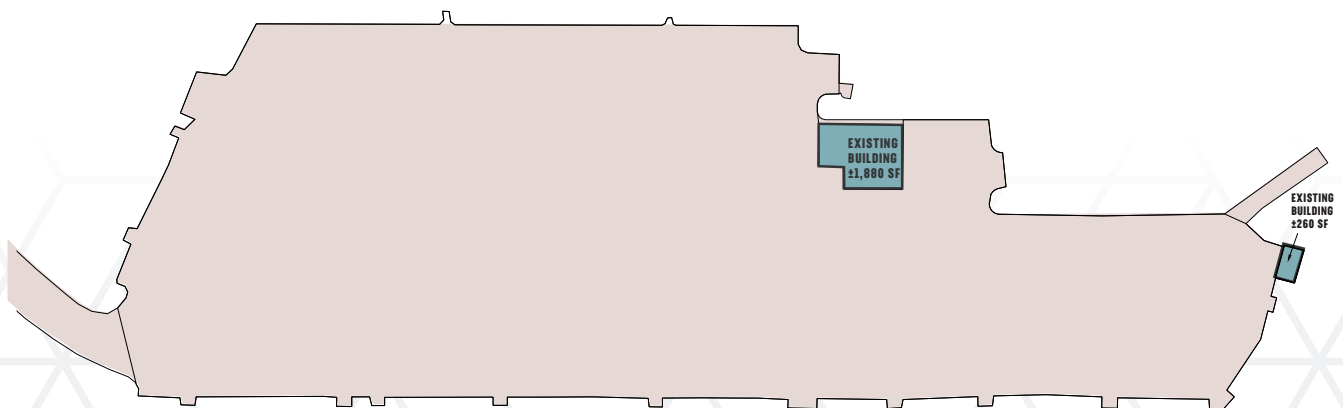

# SITE LOCATION



## TRAVEL DISTANCES

LOCATED WITHIN MYLES  
STANDISH INDUSTRIAL PARK

1.5 MILES FROM I-495

8.0 MILES TO ROUTE 24

11.0 MILES TO I-95

34.0 MILES TO  
DOWNTOWN BOSTON

## FOR MORE INFORMATION

**Rob Byrne**  
Executive Vice President  
+1 617 827 7486  
robert.byrne@cbre.com

**Danielle Frisch**  
Senior Vice President  
+1 781 964 0575  
danielle.frisch@cbre.com

**Kendall Lynch**  
Vice President  
+1 781 812 6435  
kendall.lynch@cbre.com

© 2024 CBRE, Inc. All rights reserved. This information has been obtained from sources believed reliable, but has not been verified for accuracy or completeness. You should conduct a careful, independent investigation of the property and verify all information. Any reliance on this information is solely at your own risk. CBRE and the CBRE logo are service marks of CBRE, Inc. All other marks displayed on this document are the property of their respective owners, and the use of such logos does not imply any affiliation with or endorsement of CBRE. Photos herein are the property of their respective owners. Use of these images without the express written consent of the owner is prohibited.