

+/- 16,250 SF WAREHOUSE/OFFICE FOR LEASE

- 3251 Newell Blvd
Jacksonville, FL 32216
- Warehouse: 13,250 SF
- Office: +/-3,000 SF
- Outside Storage: .30 AC
- Zoning: CCG-2
- Pricing: Call for Pricing

Walmart

PROPERTY
THEATER

BEACH BLVD

ADT 58,500

3251 NEWELL BLVD

ADT 33,500

SOUTHSIDE BLVD

ADT 52,500

Wawa



AERIAL OVERVIEW & SITE DETAILS



Premium location and visibility at the intersection of Southside Blvd. and Beach Blvd.

Signage available to be placed on the building for maximum impact

Outside storage of up to .30 AC or additional parking available

Building Details

- Metal building construction
- (2) 12 x 12 Roll Up Doors
- Sprinklered
- 26ft ceiling height at the gable

FLOORPLAN

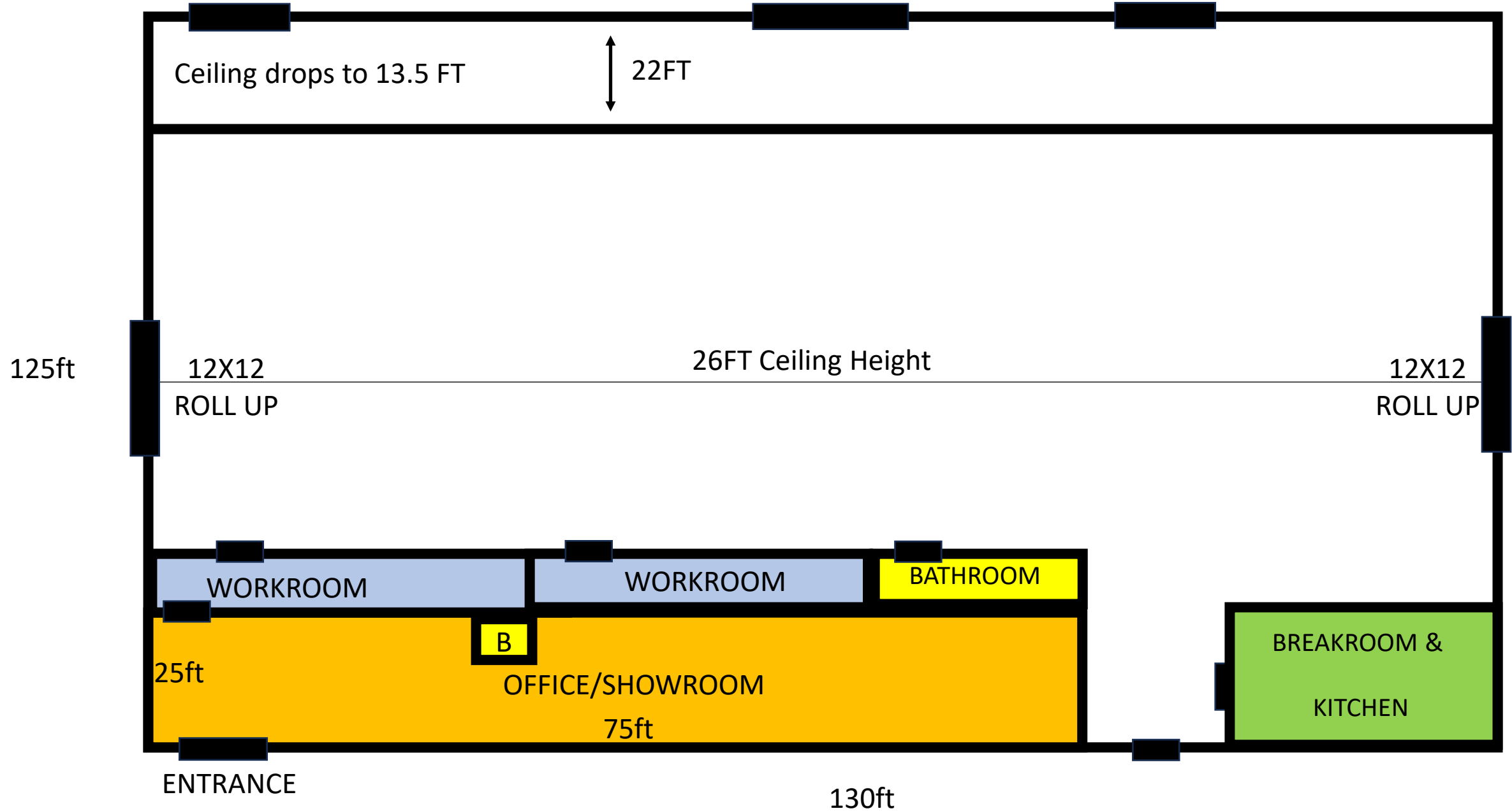

EXCELLENT VISIBILITY

VIEW FROM SOUTHSIDE BOULEVARD



VIEW FROM BEACH BLVD



ENTRANCE AND OFFICE/SHOWROOM SPACE



WAREHOUSE

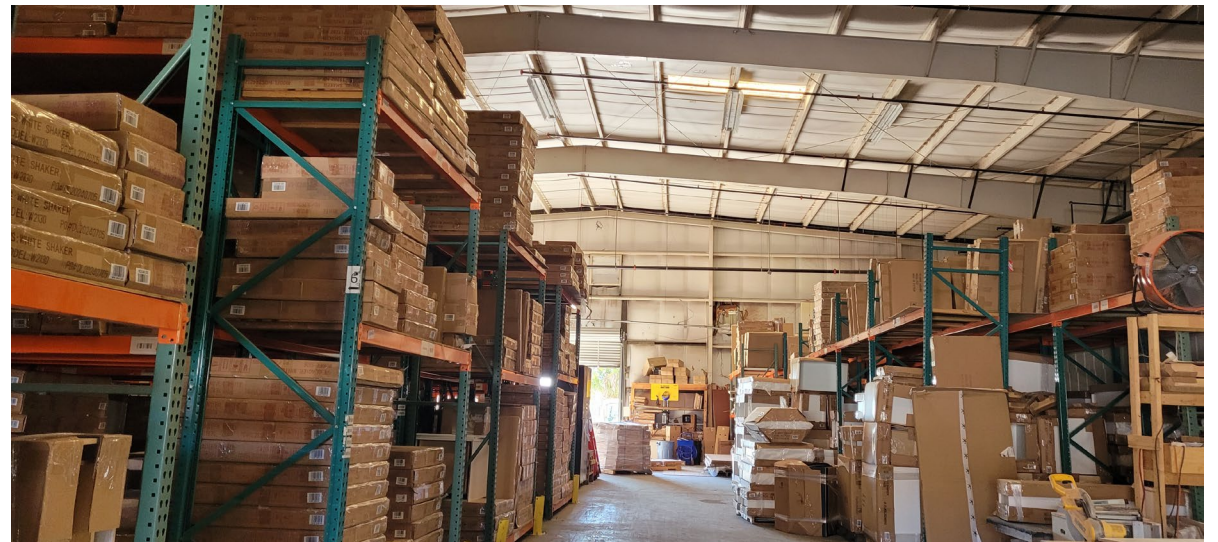
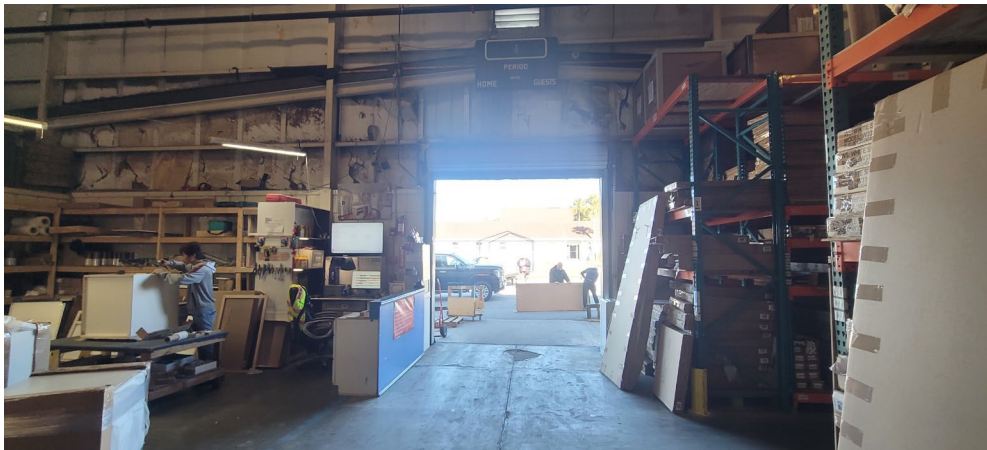

CONTACT INFORMATION

Sina Venus, MBA
Property Theater, LLC
8833 Perimeter Park Blvd.
Suite #603
Jacksonville, FL 32216

Cell: (904) 704-0296
Work: (904) 373-8778
E-Mail: sina@propertytheater.com

