



COLDWELL BANKER
PREFERRED.
REALTORS®

FOR SALE OR LEASE
MEDICAL OFFICE CONDOMINIUMS
3550 "Q" STREET
Bakersfield, CA 93301



PROPERTY INFORMATION

SALES PRICE:
\$110 - \$125 / sq ft

LEASE RATE:
\$1.25 - \$1.50 / sq ft Mod Gross

Approximate 35,000 sq ft

Three-Story Building

179 parking spaces

**Suites individually metered
for utilities**

Two stairwells and elevator

Great visibility

**Located within walking distance
to Memorial Hospital**



COLDWELL BANKER
PREFERRED.
REALTORS®

FOR SALE OR LEASE MEDICAL OFFICE CONDOMINIUMS 3550 "Q" STREET Bakersfield, CA 93301



Vikram Reddy

Coldwell Banker Preferred, Realtors

DRE #01845883 | Co.DRE# 01100927

661 836 2345 office | 661 900 1596 cell

vreddy1@yahoo.com



COLDWELL BANKER
PREFERRED,
REALTORS®

FOR SALE OR LEASE MEDICAL OFFICE CONDOMINIUMS 3550 "Q" STREET Bakersfield, CA 93301

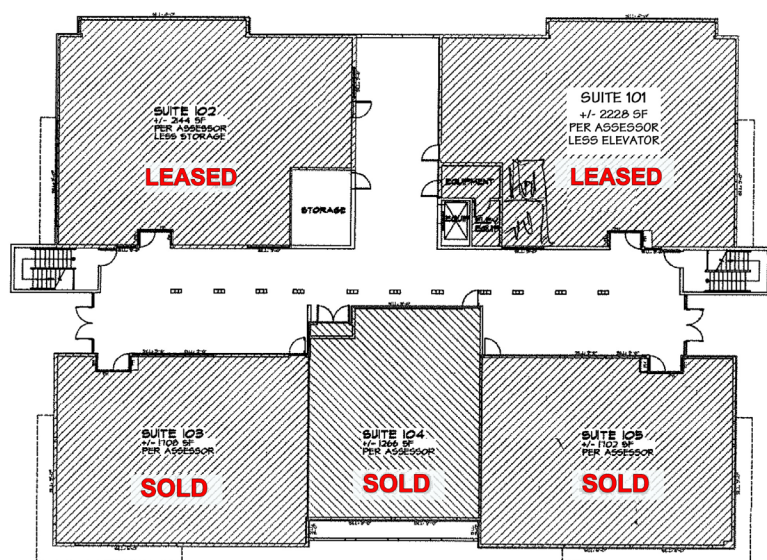

First Floor



Second Floor

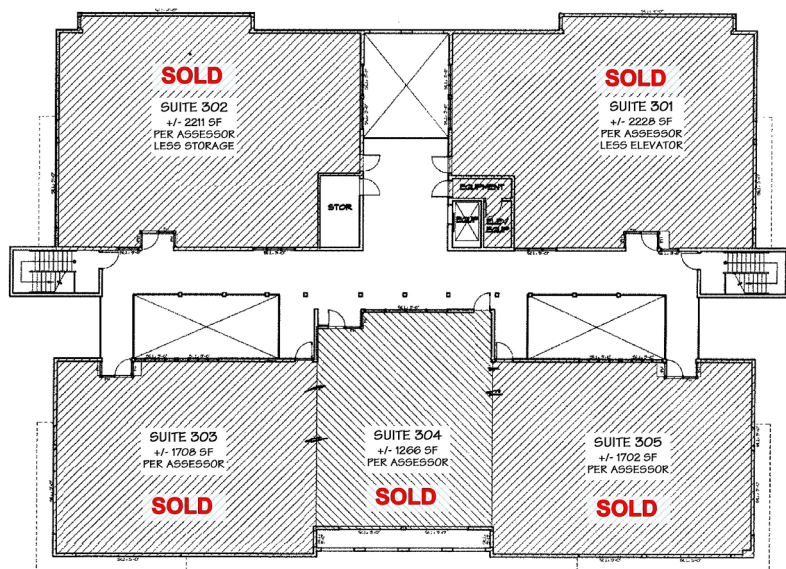

Third Floor



COLDWELL BANKER
PREFERRED.
REALTORS®

FOR SALE OR LEASE MEDICAL OFFICE CONDOMINIUMS 3550 "Q" STREET Bakersfield, CA 93301

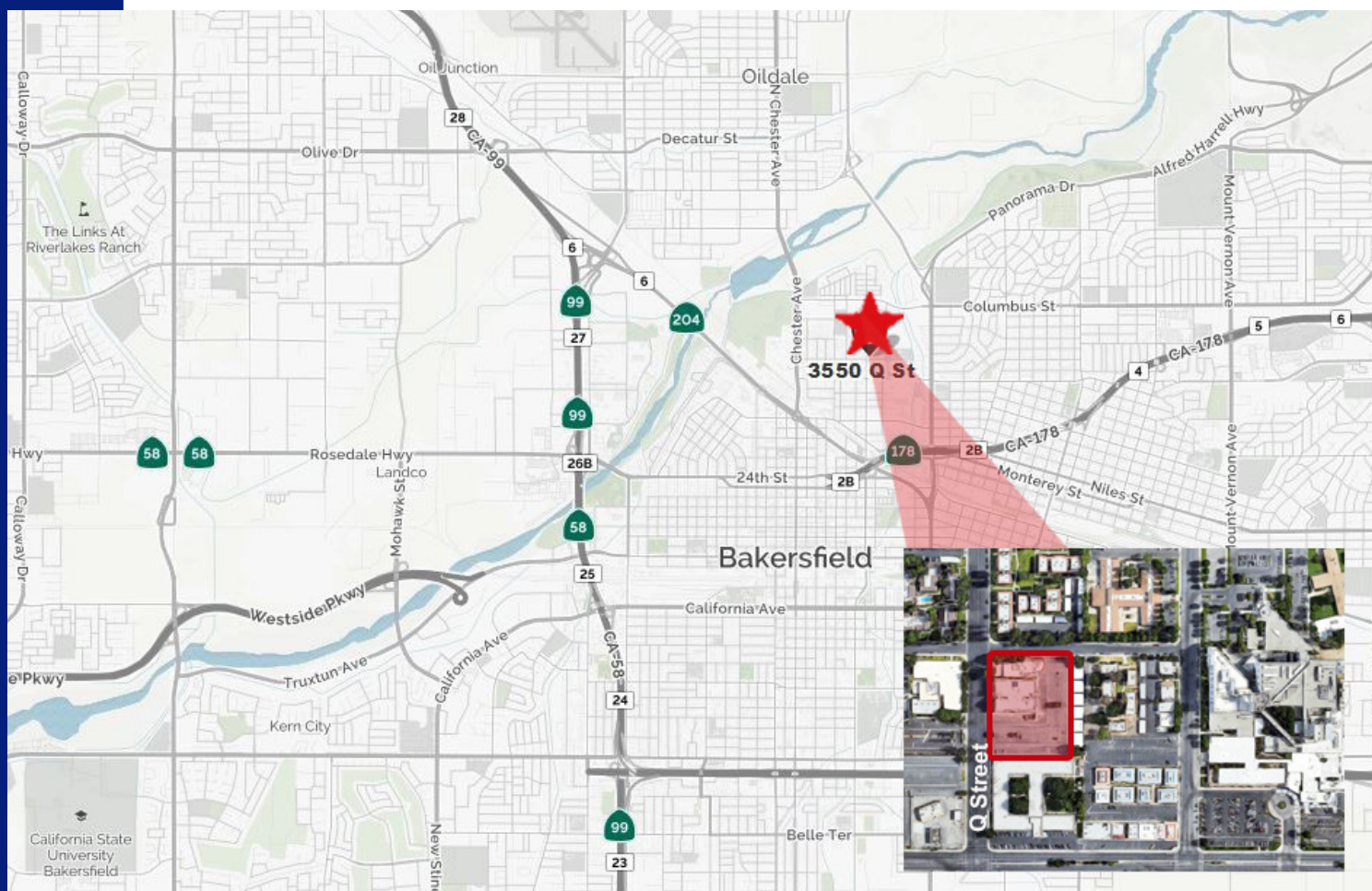

Vikram Reddy

Coldwell Banker Preferred, Realtors

DRE #01845883 | Co.DRE# 01100927

661 836 2345 office | 661 900 1596 cell

vreddy1@yahoo.com