

# PURCHASE PROFESSIONAL PARK

3000-3030 Westchester Avenue



## IN THE HEART OF WESTCHESTER'S MEDICAL MILE

### FEATURES:

- Available units from 1,000 - 20,000 RSF
- Turnkey Medical prebuilt campaign underway
- On-site pharmacy and patient drop-off areas
- Newly renovated lobbies and common areas
- First-class medical space with experienced ownership
- Only medical campus with direct east/west access to Westchester Avenue
- Easy access to 1-287 and 1-95
- Ample parking
- Turnkey Medical prebuilts
- On-site café and fitness center
- Landscaped courtyard with seating areas

For more information, please contact:

KEVIN MCCARTHY  
Managing Director  
203 326 5868  
kevin.mccarthy@cushwake.com

MATTHEW LISK  
Senior Director  
914 305 9303  
matthew.lisk@cushwake.com

MICHAEL MCCARTHY  
Director  
914 305 9304  
michael.mccarthy@cushwake.com



CUSHMAN & WAKEFIELD  
7 Renaissance Square, 5th Floor  
White Plains, NY 10601  
cushmanwakefield.com

A full commission computed and earned in accordance with the rates and conditions of our agency agreement with our principal, when received from our principal, will be paid to a cooperating broker who consummates a sublease which is unconditionally executed and delivered by and between sublandlord and subtenant. (A copy of the rates and conditions referred to above are available upon request.)



# PROPERTY PHOTOS

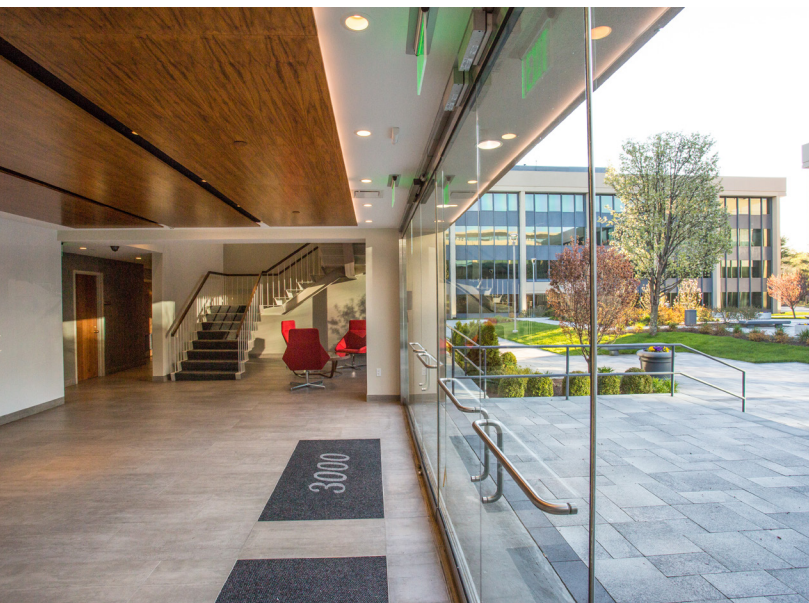



# NEARBY MEDICAL LOCATIONS

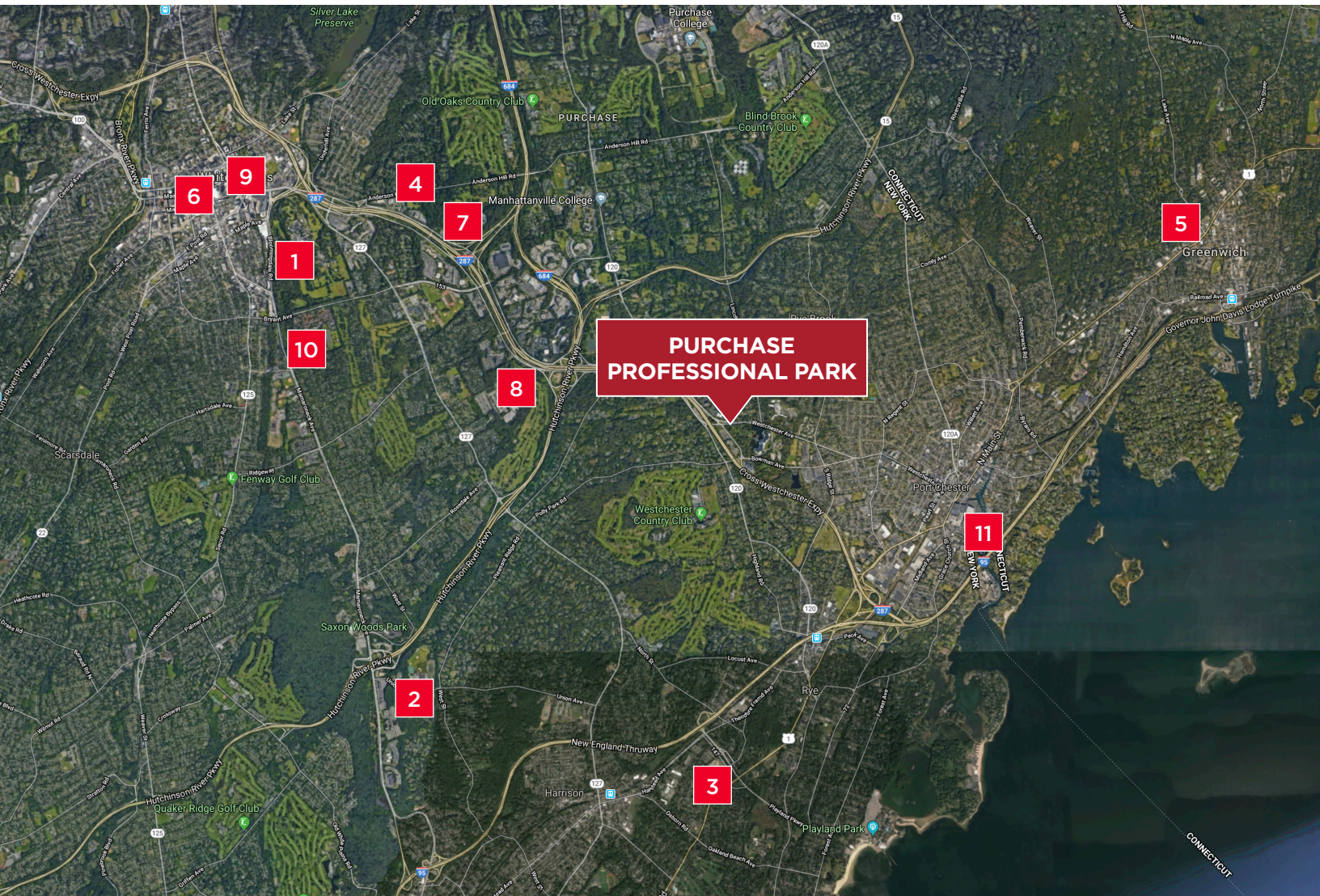

- 1 NY Presbyterian
- 2 Scarsdale Medical Group
- 3 West Med (Rye)
- 4 West Med (White Plains)
- 5 Greenwich Hospital
- 6 White Plains Hospital

- 7 Memorial Sloan Kettering
- 8 Hospital for Special Surgery
- 9 Columbia Doctors
- 10 Burke Rehabilitation
- 11 Open Door