

NEWMARK



AVAILABLE FOR LEASE *40 COMMERCE DRIVE | HAUPPAUGE, NY*

BUILDING SIZE:

47,700 SF

PLOT SIZE:

3.48 Acres

RENTAL RATE:

\$14.00 PSF Net

REAL ESTATE TAXES:

\$2.03 PSF

OCCUPANCY:

Immediate

BUILDING SPECIFICATIONS

- +/- 7,000 sf office space
- +/- 8,580 sf R&D area – can be removed
- 18' clear ceiling height
- 2 drive-in doors; 3 loading docks
- 97 parking spaces
- 1,600 amps @ 480 volts
- Gas heat
- Sprinklers
- Sewers

PROPERTY FEATURES

- Oversized plot can allow for additional parking
- Located in a prestigious corporate park setting
- Situated at the Long Island Expressway, Northern State and Sunken Meadow Parkways

FOR MORE INFORMATION, PLEASE CONTACT EXCLUSIVE BROKERS:

Daniel Gazzola
Managing Director

t 631-673-0829
daniel.gazzola@nmrk.com

Chuck Tabone, SIOR
Executive VP-Managing Director

t 631-673-0803
charles.tabone@nmrk.com

NEWMARK

40 COMMERCE DRIVE
HAUPPAUGE, NY

FLOOR PLAN

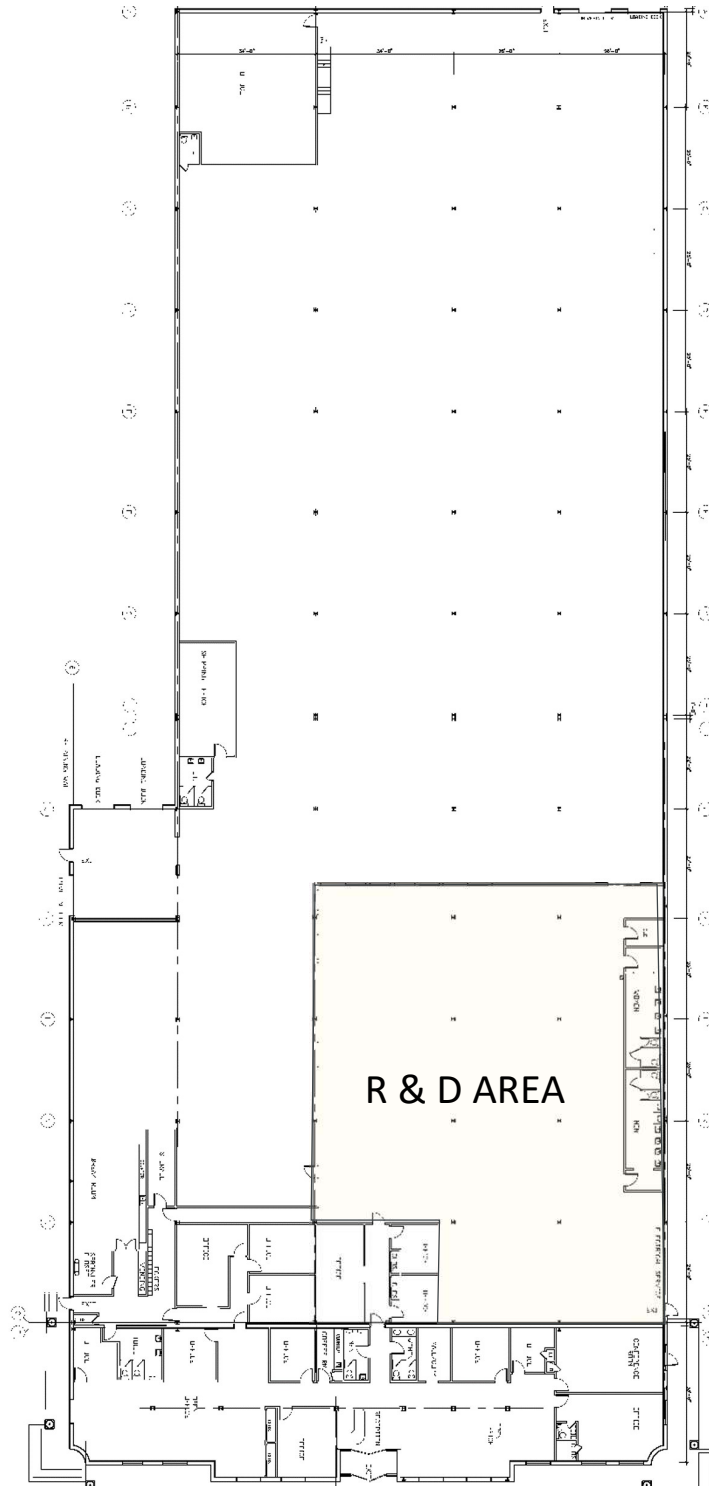

FOR MORE INFORMATION, PLEASE CONTACT EXCLUSIVE BROKERS:

Daniel Gazzola
Managing Director
t 631-673-0829
daniel.gazzola@nmrk.com

Chuck Tabone, SIOR
Executive VP-Managing Director
t 631-673-0803
charles.tabone@nmrk.com

NEWMARK

40 COMMERCE DRIVE
HAUPPAUGE, NY

SITE PLAN

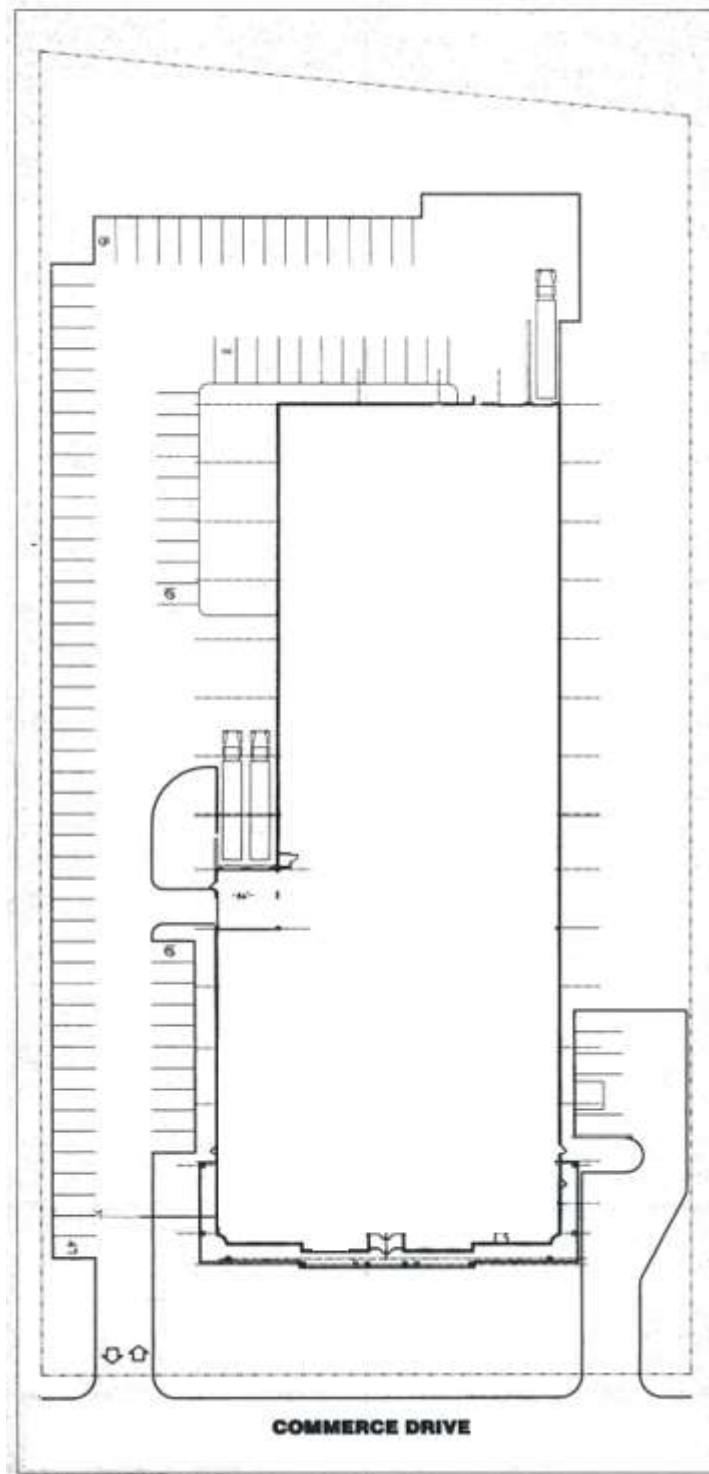

FOR MORE INFORMATION, PLEASE CONTACT EXCLUSIVE BROKERS:

Daniel Gazzola
Managing Director
t 631-673-0829
daniel.gazzola@nmrk.com

Chuck Tabone, SIOR
Executive VP-Managing Director
t 631-673-0803
charles.tabone@nmrk.com