

**Map of Statutory Natural Hazards
For SANTA CLARA County**

Property Address: 1180 N 5TH ST
SAN JOSE, SANTA CLARA COUNTY, CA 95112
("Property")

APN: 235-12-009
Report Date: 09/22/2025
Report Number: 3506289

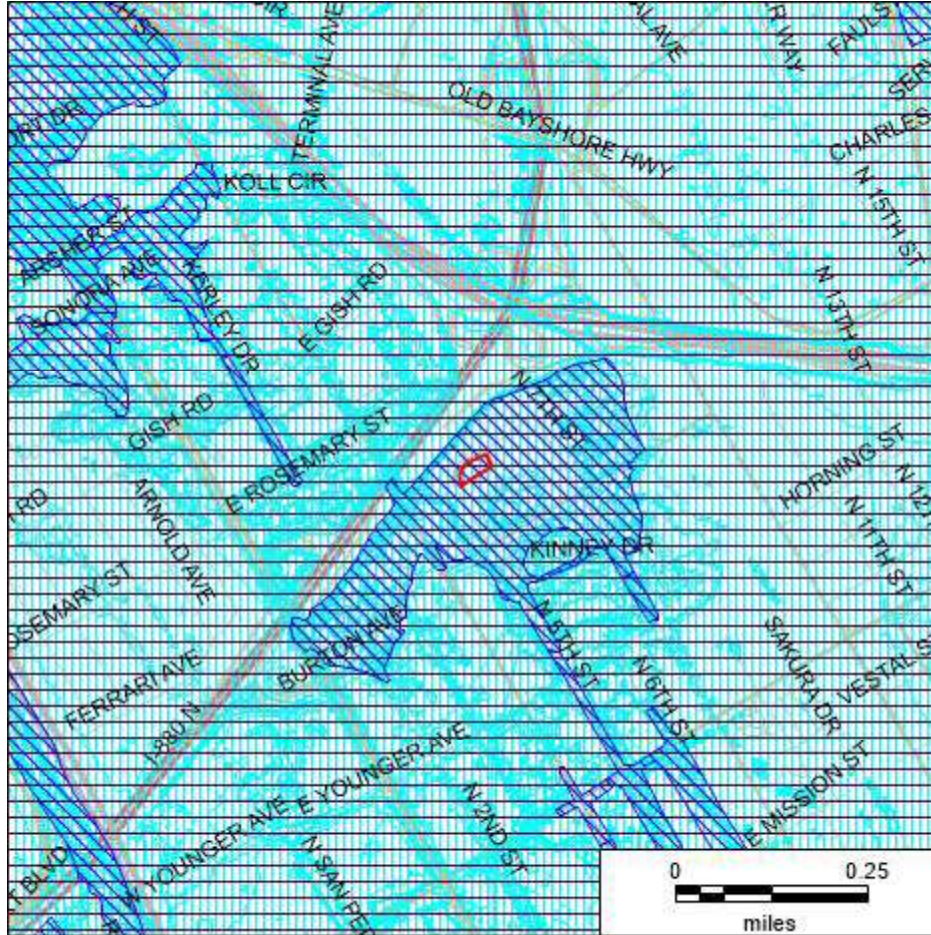

Subject Property

-  Special Flood Hazard Area
-  Area of Potential Flooding, Dam Failure
-  Very High Fire Hazard Severity Zone
-  Wildland Area, Substantial Forest Fire Risk
-  Earthquake Fault Zone
-  Seismic Hazard Zone, Landslide
-  Seismic Hazard Zone, Liquefaction

This map is provided for convenience only to show the approximate location of the Property and is not based on a field survey.

This COMMERCIAL PROPERTY DISCLOSURE REPORT contains the Commercial Natural Hazard Disclosure Report, the Commercial Tax Report and the Commercial Environmental Report.

THIS REPORT PROVIDES THE STATUTORY DISCLOSURES MANDATED BY CALIFORNIA LAWS SPECIFIED HEREIN AND DELIVERY OF THIS REPORT AND THE EXECUTED STATUTORY FORM IS SUFFICIENT TO MEET THE SAFE HARBOR FOR THE SELLER AND SELLER'S AGENT. THIS REPORT ALSO CONTAINS OTHER IMPORTANT DISCLOSURES AND INFORMATION. SELLER AND SELLER'S AGENT MAY HAVE ADDITIONAL RESPONSIBILITIES FOR CERTAIN DISCLOSURES WITHIN THEIR ACTUAL KNOWLEDGE.

**Map of Environmental Hazard Sites
For SANTA CLARA County**

Property Address: 1180 N 5TH ST
SAN JOSE, SANTA CLARA COUNTY, CA 95112
("Property")

APN: 235-12-009
Report Date: 09/22/2025
Report Number: 3506289

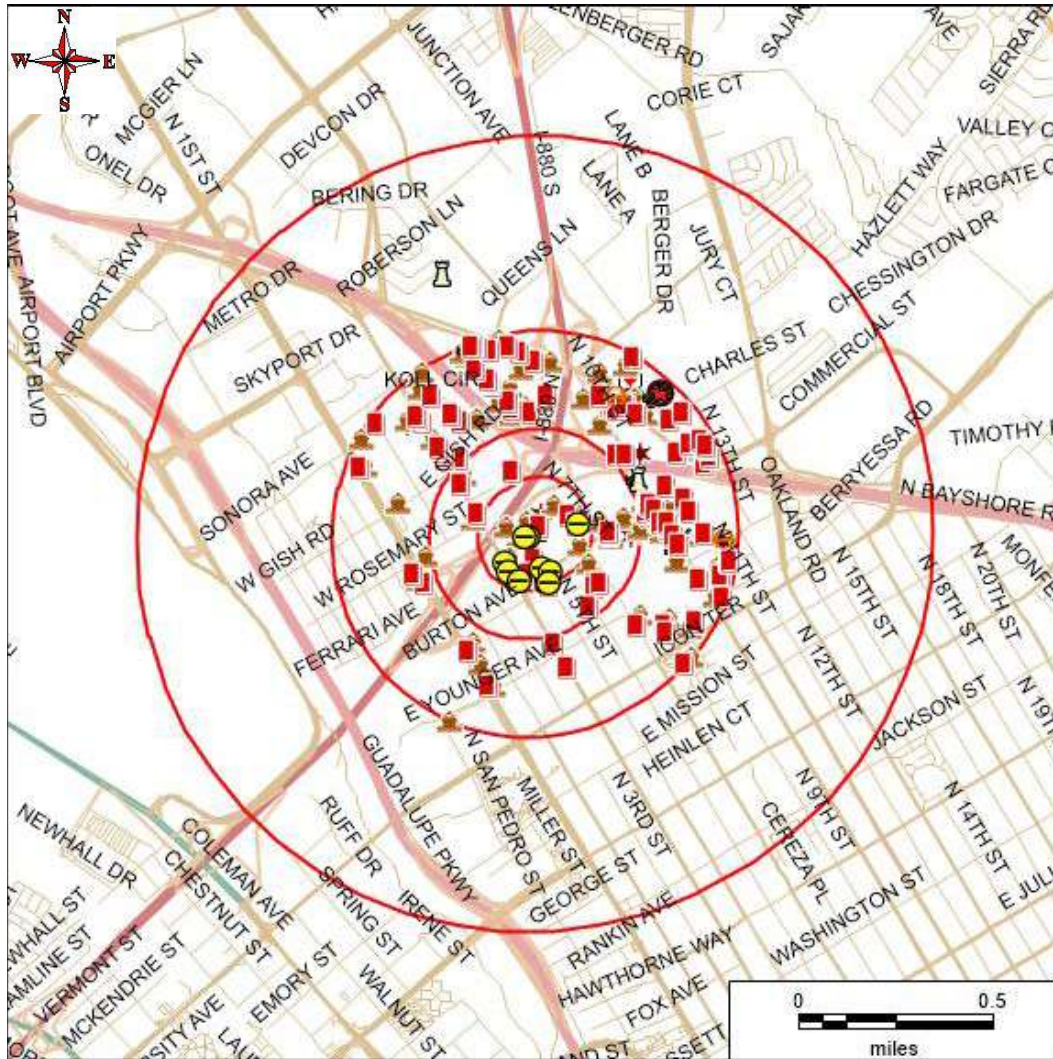

□ Subject Property

NOTE: The foregoing map may show more sites than are reported in the "Environmental Risk Screening Summary" table on Page 1. The map shows all sites found within the square coverage area. The table reports only those sites found within the circular AAI standard search distance for the database listed, which covers a smaller area. Outside of that standard search distance the table reports "NA" (not applicable). The AAI standard search distance differs between database categories, depending upon degree of potential hazard. See the selection called "Description of Databases Searched" for the actual AAI standard search distance used for each database category.

| | |
|---|---|
| (SEMS NPL) Federal National Priorities List or "Superfund" sites | (LUST) Leaking Underground Storage Tanks |
| (SEMS) Fed. Sites investigated for poss. inclusion in the NPL | (UST) Underground Storage Tanks |
| (RCRA TSD) Treatment, Storage & Disposal Sites for Haz. Materials | (RCRA GEN) Potential Generator of hazardous materials Sites |
| (RCRA COR) Corrective Action Sites | (SWIS) Solid Waste Landfill Facilities |
| (SEMS ARCHIVED) SEMS-Archived | (SLIC) Spills, Leaks, Investig. & Cleanup |
| Tribal LUST | (ENVIROSTOR) State EnviroStor Cleanup Sites Database |
| Tribal UST | (CONTROLS) Deed Restriction Or Other Controls |
| (ERNS) Emergency Response Notification System | (Hist-UST) Historical Underground Storage Tanks |
| (HWIS) Hazardous Waste Information Summary | (AST) Aboveground Storage Tanks |



The Natural Hazard Disclosure Report For SANTA CLARA County

Property Address: 1180 N 5TH ST
SAN JOSE, SANTA CLARA COUNTY, CA 95112
("Property")

APN: 235-12-009
Report Date: 09/22/2025
Report Number: 3506289

Table of Contents

Map of Statutory Natural Hazards..... [1](#)

Environmental Hazard Map..... [2](#)

NHD Statement and Acknowledgment of Receipt..... [3](#)

Table of Contents..... [4](#)

Summary of Disclosure Determinations..... [5-7](#)

NHD Report..... [8-26](#)

Tax Report..... [27-33](#)

Environmental Screening Report..... [34-46](#)

Terms and Conditions..... [47-48](#)

**The Natural Hazard Disclosure Report
For SANTA CLARA County**

Property Address: 1180 N 5TH ST
SAN JOSE, SANTA CLARA COUNTY, CA 95112
("Property")

APN: 235-12-009
Report Date: 09/22/2025
Report Number: 3506289

PROPERTY DISCLOSURE SUMMARY - READ FULL REPORT

| Statutory NHD Determinations | IN | NOT IN | Map N/A* | Property is: | NHD Report page: |
|-------------------------------------|-----------|---------------|-----------------|--|-------------------------|
| Flood | X | | | IN a Special Flood Hazard Area. The Property is IN a FEMA-designated Flood Zone(s) AH. | 8 |
| Dam | X | | | IN an area of potential dam inundation. | 8 |
| Very High Fire Hazard Severity | | X | | NOT IN a very high fire hazard severity zone. | 9 |
| Wildland Fire Area | | X | | NOT IN a Wildland-State Responsibility Area. | 9 |
| Fault | | X | | NOT IN an earthquake fault zone designated pursuant to the Alquist-Priolo Act. | 9 |
| Landslide | | X | | NOT IN an area of earthquake-induced land sliding designated pursuant to the Seismic Hazard Mapping Act. | 10 |
| Liquefaction | X | | | IN an area of potential liquefaction designated pursuant to the Seismic Hazard Mapping Act. | 10 |

| County-level NHD Determinations | IN | NOT IN | Map N/A* | Property is: | NHD Report page: |
|--|-----------|---------------|-----------------|---|-------------------------|
| Fault | | X | | NOT IN a county-designated fault rupture hazard zone. | 12 |
| Landslide | | X | | NOT IN a county-designated landslide hazard zone. | 12 |
| Liquefaction | X | | | IN a county-designated liquefaction hazard zone. | 12 |
| Compressible Soils | | X | | NOT IN a county-designated compressible soils hazard zone. | 12 |
| Dike Failure | | X | | NOT IN a county-designated dike failure flooding hazard zone. | 12 |

| City-level NHD Determinations | IN | NOT IN | Map N/A* | Property is: | NHD Report page: |
|--------------------------------------|-----------|---------------|-----------------|--|-------------------------|
| Fault | | X | | NOT IN for Fault hazard area. | 13 |
| Landslide | X | | | IN a mapped area of Least, Low, or Low to Moderate Landslide Susceptibility. Please see City of San Jose Regulatory Zones Discussion for more information. | 13 |
| Redevelopment Area | | X | | NOT IN for Redevelopment Area hazard area. | 13 |
| Special Geologic Hazard Study Area | | X | | NOT IN for Special Geologic Hazard Study Area hazard area. | 13 |

| Additional Statutory Disclosures | IN | NOT IN | Map N/A* | Property is: | NHD Report page: |
|---|-----------|---------------|-----------------|--|-------------------------|
| Senate Bill 63 (SB 63): Fire Protection Building Standards for New Construction | | X | | NOT IN a very high, high, or moderate fire hazard severity zone identified by CAL FIRE in the local responsibility area. | 15 |
| Former Military Ordnance | | X | | NOT WITHIN one mile of a formerly used ordnance site. | 16 |
| Airport Influence Area | | X | | NOT IN an airport influence area. | 17 |
| Airport Noise Area for 65 Decibel | | X | | NOT IN a delineated 65 dB CNEL or greater aviation noise zone. | 18 |
| Bay Conservation and Development Commission | | X | | NOT IN an area that is within the jurisdiction of the San Francisco Bay Conservation and Development Commission. | 19 |

| General Advisories | Description | NHD Report page: |
|-------------------------------|---|-------------------------|
| Methamphetamine Contamination | Provides an advisory that a disclosure may be required pursuant to the "Methamphetamine Contaminated Property Cleanup Act of 2005". | 20 |
| Mold | Provides an advisory that all prospective purchasers of residential and commercial property should thoroughly inspect the subject property for mold and sources for additional information on the origins of and the damage caused by mold. | 21 |

**The Natural Hazard Disclosure Report
For SANTA CLARA County**

Property Address: 1180 N 5TH ST
SAN JOSE, SANTA CLARA COUNTY, CA 95112
("Property")

APN: 235-12-009
Report Date: 09/22/2025
Report Number: 3506289

| General Advisories | Description | NHD Report page: |
|----------------------------------|---|--------------------|
| Radon | Provides an advisory on the risk associated with Radon gas concentrations. | 22 |
| Endangered Species | Provides an advisory on resources to educate the public on locales of endangered or threatened species. | 22 |
| Abandoned Mines | Provides an advisory on resources to educate the public on the hazards posed by, and some of the general locales of, abandoned mines. | 23 |
| Oil and Gas Wells | Provides an advisory on the potential existence of oil and gas wells and sources for additional general and/or specific information. | 23 |
| Electromagnetic Fields Advisory | Provides an advisory about electromagnetic fields in the local environment and their assessment. | 24 |
| Tsunami Map Advisory | Provides an advisory about maximum tsunami inundation maps issued for jurisdictional emergency planning. | 25 |
| Residential Fireplace Disclosure | Provides disclosure of restrictions on the use of wood-burning fireplaces imposed by the Bay Area Air Quality Management District. | 26 |

| Property Tax Determinations | IS | IS NOT | Property is: | Tax Report page: |
|-----------------------------|----------|----------|--|--------------------|
| Mello-Roos Districts | | X | NOT SUBJECT TO a Mello-Roos Community Facilities District. | 28 |
| 1915 Bond Act Districts | | X | NOT SUBJECT TO a 1915 Bond Act District. | 28 |
| PACE Contract Assessment | | X | NOT SUBJECT TO a Property Assessed Clean Energy (PACE) Contract. | 28 |
| Other Direct Assessments | X | | SUBJECT TO one or more other direct assessments. | 29 |
| SRA Fire Prevention Fee | | X | NOT SUBJECT TO the State Responsibility Area Fire Prevention Fee (SRA Fee is suspended until 2031 by Assembly Bill 398 of 2017). | 33 |

| Environmental Screening Determinations | IS | IS NOT | Property is: | Environmental Report page: |
|---|----------|----------|---|----------------------------|
| Subject Property listed in a Disclosed Database? | | X | NOT LISTED in any of the databases searched for this Report. | 34 |
| Federal National Priorities List or "Superfund" sites (NPL) | | X | NOT WITHIN one mile of a NPL site. | 43 |
| Corrective Action Sites (RCRA COR) | X | | WITHIN one mile of a RCRA COR site. | 43 |
| Federal Sites investigated for possible inclusion in the NPL (SEMS) | | X | NOT WITHIN one-half mile of a SEMS site. | 43 |
| SEMS Sites That Have Been Archived (SEMS-Archived) | X | | WITHIN one-half mile of a SEMS-Archived site. | 43 |
| Treatment, Storage & Disposal Sites for Hazardous Materials (RCRA TSD) | X | | WITHIN one-half mile of a RCRA TSD site. | 44 |
| Tribal UST And/Or Tribal LUST | | X | NOT WITHIN one-half mile of a Tribal UST or Tribal LUST site. | 44 |
| State EnviroStor Cleanup Sites Database (ENVIROSTOR) | X | | WITHIN one-half mile of a ENVIROSTOR site. | 44 |
| State List of Spills, Leaks, Investigation & Cleanup (SLIC) | X | | WITHIN one-half mile of a SLIC site. | 44 |
| State List of Solid Waste Landfill Facilities (SWS) | | X | NOT WITHIN one-half mile of a SWS site. | 45 |
| State List of Leaking Underground Storage Tanks (LUST) | X | | WITHIN one-half mile of a LUST site. | 45 |
| EnviroStor Site With Deed Restriction Or Other Controls (CONTROLS) | X | | WITHIN one-half mile of a CONTROLS site. | 45 |
| Potential Generator of hazardous materials Sites (RCRA GEN) | X | | WITHIN one-eighth mile of a RCRA GEN site. | 45 |
| Emergency Response Notification System (ERNS, National Response Center) | | X | NOT WITHIN one-eighth mile of a ERNS site. | 45 |
| State List of Underground Storage Tanks (UST) | | X | NOT WITHIN one-eighth mile of a UST site. | 46 |
| State List of Historical Underground Storage Tanks (Hist-UST) | | X | NOT WITHIN one-eighth mile of a Hist-UST site. | 46 |



The Natural Hazard Disclosure Report For SANTA CLARA County

Property Address: 1180 N 5TH ST
SAN JOSE, SANTA CLARA COUNTY, CA 95112
("Property")

APN: 235-12-009
Report Date: 09/22/2025
Report Number: 3506289

| Environmental Screening Determinations | IS | IS NOT | Property is: | Environmental Report page: |
|--|----------|----------|---|----------------------------|
| State Hazardous Waste Information Summary (HWIS) | X | | WITHIN one-eighth mile of a HWIS site. | 46 |
| State List of Aboveground Storage Tanks (AST) | | X | NOT WITHIN one-eighth mile of a AST site. | 46 |

Determined by First American Real Estate Disclosures Corporation

For more detailed information as to the foregoing determinations, please read this entire Report.

**The Natural Hazard Disclosure Report
For SANTA CLARA County**

Property Address: 1180 N 5TH ST
SAN JOSE, SANTA CLARA COUNTY, CA 95112
("Property")

APN: 235-12-009
Report Date: 09/22/2025
Report Number: 3506289

Natural Hazard Disclosure Report

Part 1. State Defined Natural Hazard Zones

Statutory Natural Hazard Disclosures

Section 1103 of the California Civil Code mandates the disclosure of six (6) natural hazard zones if the Property is located within any such zone. Those six "statutory" hazard zones, disclosed on the **Natural Hazard Disclosure Statement** ("NHDS") on Page one of this Report, are explained below. Note that the NHDS does not provide for informing buyers if a property is only partially within any of the delineated zones or provide additional flood zone information which could be very important to the process. The following summary is intended to give buyers additional information they may need to help them in the decision-making process and to place the information in perspective.

SPECIAL FLOOD HAZARD AREA

DISCUSSION: Property in a Special Flood Hazard Area (any type of Zone "A" or "V" as designated by the Federal Emergency Management Agency ("FEMA")) is subject to flooding in a "100-year rainstorm." Federally connected lenders require homeowners to maintain flood insurance for buildings in these zones. A 100-year flood occurs on average once every 100 years, but may not occur in 1,000 years or may occur in successive years. According to FEMA, a home located within a SFHA has a 26% chance of suffering flood damage during the term of a 30-year mortgage. Other types of flooding, such as dam failure, are not considered in developing these zones. Flood insurance for properties in Zones B, C, D, X, X500, and X500_Levee is available but is not required.

Zones A, AO, AE, AH, AR, A1-A30: Area of "100-year" flooding - a 1% or greater chance of annual flooding.

Zone A99: An "adequate progress" determination for flood control system construction projects that, once completed, may significantly limit the area of a community that will be included in the Special Flood Hazard Area (SFHA). Such projects reduce but do not eliminate, the risk of flooding to people and structures in "levee-impacted" areas, and allow mandatory flood insurance to be available at a lower cost.

Zones V, V1-V30: Area of "100-year" flooding in coastal (shore front) areas subject to wave action.

Zone B: Area of moderate flood risk. These are areas between the "100" and "500" year flood-risk levels.

Zones C, D: NOT IN an area of "100-year" flooding. Area of minimal (Zone C) or undetermined (Zone D) flood hazard.

Zones X: An area of minimal flood risk. These are areas outside the "500" year flood-risk level.

Zone X500: An area of moderate flood risk. These are areas between the "100" and "500" year flood-risk levels.

Zone X500_LEVEE: An area of moderate flood risk that is protected from "100-year flood" by levee and that is subject to revision to high risk (Zone A) if levee is decertified by FEMA.

Zone N: Area Not Included, no flood zone designation has been assigned or not participating in the National Flood Insurance Program.

Notice: The Company is not always able to determine if the Property is subject to a FEMA Letter of Map Revision ("LOMR") or other FEMA letters of map change. If Seller is aware that the Property is subject to a LOMR or other letters of map change, the Seller shall disclose the map change and attach a copy of the FEMA letter(s) to the Report. Contact FEMA at <http://msc.fema.gov> for additional information.

For more information about flood zones, visit: https://efotg.sc.egov.usda.gov/references/public/NM/FEMA_FLD_HAZ_guide.pdf

PUBLIC RECORD: Official Flood Insurance Rate Maps ("FIRM") compiled and issued by the Federal Emergency Management Agency ("FEMA") pursuant to 42 United States Code §4001, et seq.

AREA OF POTENTIAL FLOODING (DAM FAILURE)

Since 1998 California law has required seller disclosure of areas of potential inundation due to sudden or total dam failure as delineated on inundation maps submitted by dam owners to the California Office of Emergency Services ("OES") for review and approval; however, as of June 27, 2017, the date on which Senate Bill 92 (SB 92) became operative, the review and approval of inundation maps prepared by licensed civil engineers and submitted by dam owners became the statutory responsibility of the California Department of Water Resources ("DWR") Division of Safety of Dams ("DSOD") as required by California Water Code Section 6161. These inundation maps are a component of emergency action plans submitted by dam owners to comply with statutory requirements set forth under the California Water Code for extremely high, high, and significant hazard dams and their critical appurtenant structures. Inundation maps are not required by the California Water Code for low hazard dams. SB 92 further requires dam owners to update the emergency action plan, including an inundation map, no less frequently than every 10 years or sooner.

To date DWR has yet to review, approve, and make publicly available inundation maps and data for many facilities with inundation areas that are subject to disclosure requirements. Inundation maps will continue to be posted and updated maps will replace outdated maps as they are approved by DSOD. In the absence of DSOD-approved data, inundation maps previously approved by

**The Natural Hazard Disclosure Report
For SANTA CLARA County**

Property Address: 1180 N 5TH ST
SAN JOSE, SANTA CLARA COUNTY, CA 95112
("Property")

APN: 235-12-009
Report Date: 09/22/2025
Report Number: 3506289

the OES will be used by the Company to facilitate compliance with specified statutory real estate transfer disclosure requirements. These include inundation maps for federally owned dams over which DSOD has no jurisdictional authority and for which inundation maps are not available from DSOD. These dams include, among others, Folsom Dam, Isabella Dam, Hansen Dam, Prado Dam, and Seven Oaks Reservoir (owned by the U.S. Army Corps of Engineers) as well as Monticello Dam, New Melones Dam, and Shasta Dam (owned by the U.S. Bureau of Reclamation). The Company may also use OES-approved maps should the mapped inundation area for a given facility be greater than that depicted on a DSOD-approved map.

PUBLIC RECORD: (1) Official dam inundation maps made publicly available prior to June 27, 2017 by the State of California Office of Emergency Services ("OES") pursuant to California Government Code §8589.5; (2) Official inundation boundary digital data made publicly available since June 28, 2017 by the State of California Department of Water Resources (DWR) pursuant to California Water Code §6161. DWR states that its inundation boundary data typically includes flooding depths greater than one foot but some information may be redacted for security purposes.

VERY HIGH FIRE HAZARD SEVERITY ZONE (VHFHSZ)

DISCUSSION: VHFHSZs can be defined by the California Department of Forestry and Fire Protection ("Calfire") as well as by local fire authorities within "Local Responsibility Areas" where fire suppression is the responsibility of a local fire department. Properties located within VHFHS Zones may have a higher risk for fire damage and, therefore, may be subject to (i) additional construction requirements such as a "Class A" roof for new construction or replacement of existing roofs; and (ii) additional maintenance responsibilities such as adequate vegetation clearance near the structure, spark screens on chimneys and stovepipes, leaf removal from roofs, and other basic fire-safety practices. Contact the local fire department for a complete list of requirements and exceptions.

PUBLIC RECORD: Maps issued by Calfire pursuant to California Government Code § 51178 recommending VHFHSZs to be adopted by the local jurisdiction within its Local Responsibility Area, or VHFHSZs adopted by the local jurisdiction within the statutory 120-day period defined in California Government Code § 51179.

WILDLAND FIRE AREA (STATE RESPONSIBILITY AREA)

DISCUSSION: The State Board of Forestry classifies all lands within the State of California based on various factors such as ground cover, beneficial use of water from watersheds, probable damage from erosion, and fire risks. Fire prevention and suppression in all areas which are not within a Wildland - State Responsibility Area ("WSRA") is primarily the responsibility of the local or federal agencies, as applicable.

For property located within a WSRA, please note that (1) there may be substantial forest fire risks and hazards; (2) except for property located within a county which has assumed responsibility for prevention and suppression of all fires, it is NOT the state's responsibility to provide fire protection services to any building or structure located within a WSRA unless the Department has entered into a cooperative agreement with a local agency; and (3) the property owner may be is subject to (i) additional construction requirements such as a "Class A" roof for new construction or replacement of existing roofs; and (ii) additional maintenance responsibilities such as adequate vegetation clearance near the structure, spark screens on chimneys and stovepipes, leaf removal from roofs, and other basic fire-safety practices.

The existence of local agreements for fire service is not available in the Public Record and, therefore, is not included in this disclosure. For very isolated properties with no local fire services or only seasonal fire services there may be significant fire risk. If the Property is located within a WSRA, please contact the local fire department for more detailed information.

PUBLIC RECORD: Official maps issued by the California Department of Forestry and Fire Protection ("Calfire") pursuant to California Public Resources Code § 4125.

SRA Fire Prevention Benefit Fee Advisory

In 2011, the California Legislature and Governor enacted a "Fire Prevention Fee" on habitable structures in the State's wildland fire responsibility area. The yearly fee, levied on property owners, paid for various activities to prevent and suppress wildfires in the SRA, and was most recently at the rate of \$152.33 per habitable structure on the property.

Effective July 1, 2017, as authorized by Assembly Bill 398 and signed by the Governor, that fire prevention fee is suspended until 2031.

For more information, please refer to "Part 6. State Responsibility Area Fire Prevention Fee" in the JCP-LGS Property Tax Report.

EARTHQUAKE FAULT ZONE

DISCUSSION: Earthquake Fault Zones are delineated and adopted by California as part of the Alquist-Priolo Earthquake Fault Zone Act of 1972. Property in an Earthquake Fault Zone ("EF Zone") does not necessarily have a fault trace existing on the site. EF Zones are areas or bands delineated on both sides of known active earthquake faults. EF Zones vary in width but average one-quarter (1/4) mile in width with the "typical" zone boundaries set back approximately 660 feet on either side of the fault trace. The potential for "fault rupture" damage (ground cracking along the fault trace) is relatively high only if a structure is located

**The Natural Hazard Disclosure Report
For SANTA CLARA County**

Property Address: 1180 N 5TH ST
SAN JOSE, SANTA CLARA COUNTY, CA 95112
("Property")

APN: 235-12-009
Report Date: 09/22/2025
Report Number: 3506289

directly on a fault trace. If a structure is not on a fault trace, shaking will be the primary effect of an earthquake. During a major earthquake, shaking will be strong in the vicinity of the fault and may be strong at some distance from the fault depending on soil and bedrock conditions. It is generally accepted that properly constructed wood-frame houses are resistant to shaking damage.

PUBLIC RECORD: Official earthquake fault zone or special study zone maps approved by the State Geologist and issued by the California Department of Conservation, California Geological Survey pursuant to California Public Resources Code §2622.

SEISMIC HAZARD MAPPING ACT ZONE

DISCUSSION: Official Seismic Hazard Zone ("SH Zone") maps delineate Areas of Potential Liquefaction and Areas of Earthquake-Induced Landsliding. A property that lies partially or entirely within a designated SH Zone may be subject to requirements for site-specific geologic studies and mitigation before any new or additional construction may take place.

Earthquake-Induced Landslide Hazard Zones are areas where the potential for earthquake-induced landslides is relatively high. Areas most susceptible to these landslides are steep slopes in poorly cemented or highly fractured rocks, areas underlain by loose, weak soils, and areas on or adjacent to existing landslide deposits. The CGS cautions these maps do not capture all potential earthquake-induced landslide hazards and that earthquake-induced ground failures are not addressed by these maps. Furthermore, no effort has been made to map potential run-out areas of triggered landslides. It is possible that such run-out areas may extend beyond the zone boundaries. An earthquake capable of causing liquefaction or triggering a landslide may not uniformly affect all areas within a SH Zone.

Liquefaction Hazard Zones are areas where there is a potential for, or an historic occurrence of liquefaction. Liquefaction is a soil phenomenon that can occur when loose, water saturated granular sediment within 40 feet of the ground surface, are shaken in a significant earthquake. The soil temporarily becomes liquid-like and structures may settle unevenly. The Public Record is intended to identify areas with a relatively high potential for liquefaction but not to predict the amount or direction of liquefaction-related ground displacement, nor the amount of damage caused by liquefaction. The many factors that control ground failure resulting from liquefaction must be evaluated on a site specific basis.

PUBLIC RECORD: Official seismic hazard maps or digital data thereof approved by the State Geologist and issued by the California Department of Conservation, California Geological Survey pursuant to California Public Resources Code §2696.

STATUTORY NATURAL HAZARD DISCLOSURE REPORTING STANDARD: "IN" shall be reported if any portion of the Property is located within any of the above zones as delineated in the Public Record. "NOT IN" shall be reported if no portion of the Property is located within any of the above zones as delineated in the Public Record. Map Not Available shall be reported in areas not yet evaluated by the governing agency according to the Public Record. Please note that "MAP NOT AVAILABLE" will be applicable to most portions of the state.

The Natural Hazard Disclosure Report For SANTA CLARA County

Property Address: 1180 N 5TH ST
SAN JOSE, SANTA CLARA COUNTY, CA 95112
("Property")

APN: 235-12-009
Report Date: 09/22/2025
Report Number: 3506289

Part 2. County and City Defined Natural Hazard Zones

HAZARD MAPS IN THE LOCAL GENERAL PLAN

General Plan regulates property development. There are currently over 530 incorporated cities and counties in California. The state Government Code (Sections 65000 et seq.) requires each of those jurisdictions to adopt a comprehensive, long-term "General Plan" for its physical development. That General Plan regulates land uses within the local jurisdiction in order to protect the public from hazards in the environment and conserve local natural resources. The General Plan is the official city or county policy regarding the location of housing, business, industry, roads, parks, and other land uses.

Municipal hazard zones can affect the cost of ownership. Each county and city adopts its own distinct General Plan according to that jurisdiction's unique vegetation, landscape, terrain, and other geographic and geologic conditions. The "Safety Element" (or Seismic Safety Element) of that General Plan identifies the constraints of earthquake fault, landslide, flood, fire and other natural hazards on local land use, and it delineates hazard zones within which private property improvements may be regulated through the building-permit approval process, which can affect the future cost of ownership. Those locally regulated hazard zones are in addition to the federal and state defined hazard zones associated with statutory disclosures in the preceding section.

City and/or County natural hazard zones explained below. Unless otherwise specified, only those officially adopted Safety Element or Seismic Safety Element maps (or digital data thereof) which are publicly available, are of a scale, resolution, and quality that readily enable parcel-specific hazard determinations, and are consistent in character with those statutory federal or state disclosures will be considered for eligible for use as the basis for county- or city-level disclosures set forth in this Report. Please also note:

- If an officially adopted Safety Element or Seismic Safety Element map relies on data which is redundant of that used for state-level disclosures, this Report will indicate so and advise Report recipients to refer to the state-level hazard discussion section for more information.
- If an officially adopted Safety Element or Seismic Safety Element cites underlying maps created by another agency, those maps may be regarded as incorporated by reference and may be used as the basis for parcel-specific determinations if those maps meet the criteria set forth in this section.
- Because county- and city-level maps are developed independently and do not necessarily define or delineate a given hazard the same way, the boundaries for the "same" hazard may be different.

If one or more maps contained in the Safety Element and/or Seismic Safety Element of an officially adopted General Plan are used as the basis for local disclosure, those maps will appear under the "Public Record(s) Searched" for that county or city.

REPORTING STANDARDS

A good faith effort has been made to disclose all hazard features on pertinent Safety Element and Seismic Safety Element maps with well-defined boundaries; however, those hazards with boundaries that are not delineated will be deemed not suitable for parcel-specific hazard determinations. Some map features, such as lines drawn to represent the location of a fault trace, may be buffered to create a zone to facilitate disclosure. Those map features which can not be readily distinguished from those representing hazards may be included to prevent an omission of a hazard feature. If the width of a hazard zone boundary is in question, "IN" will be reported if that boundary impacts any portion of a property. Further explanations concerning specific map features peculiar to a given county or city will appear under the "Reporting Standards" for that jurisdiction.

PUBLIC RECORDS VS. ON-SITE EVALUATIONS

Mapped hazard zones represent evaluations of generalized hazard information. Any specific site within a mapped zone could be at less or more relative risk than is indicated by the zone designation. A site-specific evaluation conducted by a geotechnical consultant or other qualified professional may provide more detailed and definitive information about the Property and any conditions which may or do affect it.

PROPERTY USE AND PERMITTING

No maps beyond those identified as "Public Record(s)" have been consulted for the purpose of these local disclosures. These disclosures are intended solely to make Report recipient(s) aware of the presence of mapped hazards. For this reason -- and because local authorities may use on these or additional maps or data differently to determine property-specific land use and permitting approvals -- Report recipients are advised to contact the appropriate local agency, usually Community Development, Planning, and/or Building, prior to the transaction to ascertain if these or any other conditions or related regulations may impact the Property use or improvement.

**The Natural Hazard Disclosure Report
For SANTA CLARA County**

Property Address: 1180 N 5TH ST
SAN JOSE, SANTA CLARA COUNTY, CA 95112
("Property")

APN: 235-12-009
Report Date: 09/22/2025
Report Number: 3506289

SANTA CLARA COUNTY GEOLOGIC ZONES DISCUSSION

PUBLIC RECORD(S) SEARCHED: The following Public Records are utilized for those county-level disclosures below: Officially adopted digital data of "County Geologic Hazard Zones" as prepared by Santa Clara County Department of Planning and disclosure of which is required by County Ordinance Sec C12-624 as revised March 19, 2002.

FAULT

The County identifies Fault Rupture Hazard Zones as both "active" and "potentially active" fault zones as well as other faulting-related geologic features. Active faults are known to have experienced fault rupture in the last 11,000 years and are usually seismically active (produce earthquakes periodically). Potentially active faults are not seismically active, and it cannot be definitely proven that these faults have moved in the last 11,000 years. Potentially active faults far outnumber active faults in Santa Clara County. Because potentially active faults are included in the zone description, all Fault Rupture Hazard Zone are not necessarily equal to an Alquist-Priolo Earthquake Fault Zone which only includes active faults.

Reporting Standards: If any portion of the Property is situated within a fault zone as delineated in the Public Record, "WITHIN" shall be reported.

LANDSLIDE

Landslide Hazard Zones include areas with a high potential for earthquake-induced landslides. It does not necessarily mean that landslides exist on the Property or that landsliding is imminent or probable in the area. It does mean that the designated area has a greater chance of landsliding than properties in flat-lying areas. The County has also included a United States Geological Survey Report and State of California Geologic Survey Earthquake-Induced Landslide Hazard Zones into the zone description. These include areas where there has been a recent landslide, or where local slope, geological, geotechnical, and ground moisture conditions indicate a potential for landslides as a result of earthquake shaking.

Reporting Standards: If any portion of the Property is situated within a landslide zone as delineated in the Public Record, "IN" shall be reported.

LIQUEFACTION

Liquefaction Hazard Zones include areas the California Geological Survey has defined as areas of historic occurrence or potential for liquefaction. Liquefaction is a rare soil phenomenon that can occur when loose, water saturated, fine-grained sands and silty sands that lie within 50 feet of the ground surface are shaken in a significant earthquake. The soil temporarily becomes liquid-like and structures may settle unevenly. The County has also included zones of liquefaction susceptibility from a United States Geological Survey Report of soil deposits that may be prone to liquefaction.

Reporting Standards: If any portion of the Property is situated within an area of potential liquefaction as delineated in the Public Record, "IN" shall be reported.

COMPRESSIBLE SOILS

Compressible Soils Zones include areas where there is a chance that the ground will settle locally during severe shaking due to the potential compression of peaty-type soils in these areas. Risk of injury is relatively low in these areas as a result of settlement alone.

Reporting Standards: If any portion of the Property is situated within an area of compressible soils as delineated in the Public Record, "IN" shall be reported.

DIKE FAILURE

Dike Failure Flooding Zones include areas where there is a significant chance of flooding following a large earthquake if the perimeter dike systems of the bay fail.

Reporting Standards: If any portion of the Property is situated within an area of potential dike failure as delineated in the Public Record, "IN" shall be reported.

**The Natural Hazard Disclosure Report
For SANTA CLARA County**

Property Address: 1180 N 5TH ST
SAN JOSE, SANTA CLARA COUNTY, CA 95112
("Property")

APN: 235-12-009
Report Date: 09/22/2025
Report Number: 3506289

CITY OF SAN JOSE REGULATORY ZONES DISCUSSION

PUBLIC RECORD(S) SEARCHED: The following Public Records have been incorporated into "The San Jose 2020 General Plan" (including Appendix B, "Seismic Safety") as adopted by the San Jose City Council in 1994 or adopted by City Ordinance or other City Council action pursuant to required disclosures below:

- "City of San Jose Fault Hazard Zone Maps" dated 1983 and on file in the Department of Public Works pursuant to §17 of the City of San Jose Municipal Code.
- "Geotechnical Report, Geological Investigation, City of San Jose Sphere of Influence," produced in 1974 by Cooper, Clark, and Associates pursuant to §17 of the City of San Jose Municipal Code.
- "City of San Jose Special Geologic Hazard Study Area Map" and any map(s) that show any land added by way of amendment pursuant to §17.10.805 of the City of San Jose Municipal Code.
- "Landslide Areas Map, City of San Jose Phase 1A Regional Geologic Study," produced in 1995 by Norfleet Consultants.
- "Strong Neighborhood Initiative ("SNI") / Redevelopment Area" maps produced by the City's Planning Services Division.

By local ordinance, the City of San Jose requires disclosure of these geologic hazard zones, neighborhood and redevelopment areas, and street tree maintenance requirements to potential buyers of real property

FAULT

San Jose Fault Hazard Zones are areas identified by the State of California and the City of San Jose Department of Public Works that include Alquist-Priolo Earthquake Fault Zones as designated by the California Geological Survey, as well as City Special Studies Zones and City Potential Hazard Zones. These three zones are disclosed in this Report as "City Fault Zones." The City has also identified "Reported Faults" which have been buffered on all sides by one-eighth of one mile and are disclosed in this Report as "Reported Faults."

Reporting Standards: If any portion of the Property is located within a City Fault Zone as delineated in the Public Record, "City Fault Zone" shall be reported. If any portion of the Property is located within one-eighth of one mile (660 feet) of a Reported Fault as delineated in the Public Record, "Reported Fault" shall be reported.

LANDSLIDE SUSCEPTIBILITY

Standard Geologic Hazard Study Area: These are areas identified by the City as having a very high, high, or moderate to high landslide susceptibility and are disclosed in this Report as "Moderate to Very High." In most places, these "Standard" areas are equivalent to and replace the old definition of a "Special Geologic Hazard Area" that was used by the City of San Jose prior to the August 23, 1994 updating of their maps. Areas identified by the City as Least, Low, and Low to Moderate are also disclosed in this Report as "Least to Moderate."

Reporting Standards: If any portion of the Property is located within a mapped area of Moderate to High, High, or Very High Landslide Susceptibility as delineated in the Public Record, "Moderate to Very High" shall be reported. If no portion of the Property is within this "Moderate to Very High" area and is within the mapped area, then "Least to Moderate" shall be reported.

SPECIAL GEOLOGIC HAZARD STUDY AREA

Special Geologic Hazard Study Area: A limited zone defined by the City that is undergoing a special phased geologic study to define areas that are underlain by active landsliding. New development, grading or building permits for property improvements in this area will take into consideration information from the first phase of the Final Report, Phase 1A Regional Geologic Special Study that has been completed, this report is titled Study of the Special Geologic Hazard Area, this first phase has delineated the following landslide zones within the City of San Jose. Special Geologic Hazard Area:

- **Zone X** - Not within a landslide area. However, the possibility exists of unrecognized landslides in this area.
- **Zone Y** - Not enough information to determine if the area is within or not within a landslide area. These areas could encompass all types of possible landslides, but it could not be determined with the information available in the Phase 1A Study if this was the case.
- **Zone Z** - Within a landslide area, this area encompasses active, recent, and old landslides.

NOTE: Zones X, Y, and Z were determined using air photo analysis and field studies. No distinctions were made as to the size, age, depth or activity of any landslide. If the subject property is located in a "Standard" or a "Special" Geologic Hazard Study Area, or if other geologic information of concern exists in the City's files, a "Certificate of Geologic Clearance" from the Department of Public Works is required prior to any discretionary approval for development or any grading or building permit for improvements to a site. In order to obtain a Clearance for sites within a "Special Geologic Hazard Study Area," the property owner is required to perform a Geologic Evaluation according to City ordinance (Chapter 17.10, Part 6). An "on" or "off-site" geologic study may have been prepared for the site. Such reports are normally available for review in the office of the City's engineering geologist. The preceding information must be disclosed to the buyer by the agent for the seller of the subject property in accordance with Section 10176(a) of the California Business and Professions Code and "Disclosure to Prospective Purchasers," Title 17, Chapter 17.10, Part 9, Section of the City of San Jose Municipal Code.

Reporting Standards: If any portion of the Property is within one or more of the 3 Special Geologic Hazard Study Areas as delineated in the Public Record, the name of that Zone or Zones shall be reported.

SAN JOSE REDEVELOPMENT AREAS (Strong Neighborhood Initiative Areas)

**The Natural Hazard Disclosure Report
For SANTA CLARA County**

Property Address: 1180 N 5TH ST
SAN JOSE, SANTA CLARA COUNTY, CA 95112
("Property")

APN: 235-12-009
Report Date: 09/22/2025
Report Number: 3506289

The Strong Neighborhoods Initiative ("SNI") is a commitment made by the Mayor and the Council to unite with San Jose communities to strengthen City neighborhoods. SNI is about cleaner, safer neighborhoods and connecting those neighborhoods to resources and to each other. It is listening to San Jose neighborhoods and responding to citywide priorities. By focusing resources from the City of San Jose, San Jose Redevelopment Agency, private investment, and public-private partnerships, the Strong Neighborhoods Initiative will improve conditions, enhance community safety, and strengthen neighborhood associations.

The Agency, under this Plan, is authorized to develop or otherwise participate in certain publicly owned projects in various neighborhoods as may be determined and approved in accordance with California Redevelopment Law, such as community centers, fire stations, libraries, joint school projects, community gardens, open space and cultural facilities. The Agency also sponsors programs to develop affordable housing and to provide funds to rehabilitate residential and commercial properties, like grants for exterior renovations and roofing.

- **Industrial Redevelopment Areas** were created to encourage the expansion and location of research and development, office, manufacturing, warehouse and commercial uses, attract local jobs, and increase various revenue sources to the city.
- **Downtown Redevelopment Area** is modeled after the San Jose of 1900-1950, a 24-hour city where people lived, worked, and shopped.
- **Neighborhood Business Districts** were created to revitalize, and encourage private investment in, San Jose's older commercial neighborhoods. Enhanced by community involvement, the NBD program tackles parking problems, improves building facades, extends street improvements, modernizes underground utilities, and offers marketing advice to small businesses.
- **Neighborhood Business Clusters** were created to revitalize and increase commercial and residential development to better serve the needs of the neighborhood.

For more information please visit the City web site at <http://www.sanjoseca.gov/index.aspx?NID=1745>

Reporting Standards: If the Property is one of the SNI Areas, Districts, or Clusters as delineated in the Public Record, the name of that Area, District, or Cluster shall be reported.

END OF LOCAL AREA DISCLOSURES AND DISCUSSIONS SECTION

**The Natural Hazard Disclosure Report
For SANTA CLARA County**

Property Address: 1180 N 5TH ST
SAN JOSE, SANTA CLARA COUNTY, CA 95112
("Property")

APN: 235-12-009
Report Date: 09/22/2025
Report Number: 3506289

Part 3. Additional Property Specific Disclosures

LOCAL VEGETATION MANAGEMENT ORDINANCE DISCLOSURE

DISCUSSION: In a wildland area, brush clearance around a structure ("defensible space") on private property is typically mandated by law. The required distances and degrees of clearance vary with jurisdiction. Where the state (CAL FIRE) has fire protection responsibility, three clearance zones are specified outward from the foundation (Calif. Public Resources Code Section 4291): 0-5 feet (ember-resistant zone), 5-30 feet (mowed grass and limbed trees), and 30-100 feet (safely spaced shrubs and trees).

Those CAL FIRE zones are the minimum standard where a city or county or local fire protection district has adopted a Very High Fire Hazard Severity Zone pursuant to state law (Calif. Government Code Section 51178 or 51179). However, a local jurisdiction may pass its own law that requires more intensive clearance over greater distances on a property, and over specified districts and within strict compliance deadlines.

Click VEGETATION-ORD@firstam.com (email) to explore whether the Property subject to this transaction may be located in an area where a local vegetation management ordinance requiring defensible space around the property applies.

Senate Bill 63 (SB 63): Fire Protection Building Standards for New Construction

In February 2025, the State of California adopted the 2024 International Wildland-Urban Interface Code (IWUIC) as the basis for Title 24, Part 7, 2025 California Wildland-Urban Interface Code (formerly titled "Chapter 7A"). The IWUIC regulates new construction in a wildland area. Specifically, the IWUIC establishes minimum standards for the protection of life and property by increasing the ability of a building, including residential and commercial occupancy types, to resist the intrusion of flames or burning embers projected by a vegetation fire.

The fire protection building standards under the IWUIC, as adopted, apply to unincorporated lands in a State Responsibility Area ("SRA"). In a Local Responsibility Area ("LRA"), those fire protection building standards currently apply to land within a Very High Fire Hazard Severity Zone or a Wildland Urban Interface ("WUI") Fire Area as designated by cities and other local agencies.

Beginning February 10, 2025, pursuant to California Senate Bill 63, approved in 2021 (Government Code §51178 as amended), the Director of the Department of Forestry and Fire Protection ("Director") is releasing maps of Fire Hazard Severity Zones ("FHSZ") in the LRA, in phases by California region. Those maps include Moderate and High FHSZ, in addition to Very High FHSZ already designated in LRA. The SB 63 law ("SB 63") requires the State Fire Marshal, in consultation with the Director and other state agencies, to propose, and the State Building Standards Commission to adopt, expanded application of specified building standards to the High FHSZ in the LRA—and to consider, if it is appropriate, expanding application of these building standards to the Moderate FHSZ in the LRA.

Affected Disclosures: SB 63 does not itself create a new real estate disclosure. However, expansion of fire protection building standards to High and Moderate FHSZ in the LRA may affect the cost of new construction or modifications to existing structures on properties in those fire zones and, therefore, may be a material fact in a real property transaction. This Report provides that disclosure, if applicable, in the Property Disclosure Summary, in the "Senate Bill 63 (SB 63): Fire Protection Building Standards for New Construction" determination.

In addition, a prior law that still controls, Assembly Bill 38 ("AB 38"), created certain disclosure and vegetation management (defensible space) obligations for property subject to AB 38 that is located in a High or a Very High FHSZ as identified by the Director, or as required by a local vegetation management ordinance. The recently released SB 63 maps extend the area subject to AB 38 by adding a High FHSZ in the LRA—in addition to the Very High FHSZ that already may exist. Therefore, disclosure of a High or a Very High FHSZ in the LRA is now required under AB 38. This Report provides that disclosure, if applicable, in the Property Disclosure Summary, in the "Fire Hazard Severity Zone (AB 38)" determination.

A local agency may, at its discretion, include areas within the jurisdiction of the local agency, not identified as Very High Fire Hazard Severity Zones by the State Fire Marshal, as Very High Fire Hazard Severity Zones. Likewise, a local agency may include areas not identified as Moderate and High Fire Hazard Severity Zones by the State Fire Marshal, as Moderate and High Fire Hazard Severity Zones, respectively. Where a local agency has designated, by ordinance, such an expanded FHSZ, this Report will provide that disclosure in the Property Disclosure Summary, in the "Fire Hazard Severity Zone pursuant to Gov. Code §51179." Please note that any mapped FHSZ boundary modifications submitted by the local agency to CAL FIRE may not be reflected in CAL FIRE data and will have to be obtained from the local agency directly.

JCP-LGS Reports will continue to include the current "NHD Statement" (the one-page statutory form at the front of the report) as specified under California Civil Code 1103.2, until such time that the Legislature officially amends that form with respect to the "Very High Fire Hazard Severity Zone" or any other listed disclosure.

The Natural Hazard Disclosure Report For SANTA CLARA County

Property Address: 1180 N 5TH ST
SAN JOSE, SANTA CLARA COUNTY, CA 95112
("Property")

APN: 235-12-009
Report Date: 09/22/2025
Report Number: 3506289

PUBLIC RECORD: Official digital data of "Fire Hazard Severity Zones in the Local Responsibility Areas [LRA]" as identified by CAL FIRE and as modified concurrent with subsequent official CAL FIRE updates, pursuant to Section 51178 of the Government Code.

REPORTING STANDARD: "IN" shall be reported as will any mapped Fire Hazard Severity Zone ("Very High", "High", or "Moderate") in the local responsibility area affecting any portion of the Property as identified by the State Fire Marshal in the Public Record. "NOT IN" shall be reported if no portion of the Property is located within a Fire Hazard Severity Zone in the local responsibility area as identified by the State Fire Marshal in the Public Record. "Map Not Available" shall be reported if Fire Hazard Severity Zones in the local responsibility area as identified by the State Fire Marshal in the Public Record are not timely available as of the Report Date.

FORMER MILITARY ORDNANCE SITE DISCLOSURE

DISCUSSION: Former Military Ordnance (FUD) sites can include sites with common industrial waste (such as fuels), ordnance or other warfare materiel, unsafe structures to be demolished, or debris for removal. California Civil Code Section 1102 requires disclosure of those sites containing unexploded ordnance. "Military ordnance" is any kind of munitions, explosive device/material or chemical agent used in military weapons. Unexploded ordnance are munitions that did not detonate. NOTE: **MOST** FUD sites do not contain unexploded ordnance. Only those FUD sites that the U.S. Army Corps of Engineers (USACE) has identified to contain Military Ordnance or have mitigation projects planned for them are disclosed in this Report. Additional sites may be added as military installations are released under the Federal Base Realignment and Closure (BRAC) Act. Active military sites are NOT included on the FUD site list.

PUBLIC RECORD: Data contained in Inventory Project Reports, Archives Search Reports, and related materials produced for, and made publicly available in conjunction with, the Defense Environmental Restoration Program for Formerly Used Defense Sites by the U.S. Army Corps of Engineers. Sites for which no map has been made publicly available shall not be disclosed.

REPORTING STANDARD: If one or more facility identified in the Public Record is situated within a one (1) mile radius of the Property, "**WITHIN**" shall be reported. The name of that facility or facilities shall also be reported.

**The Natural Hazard Disclosure Report
For SANTA CLARA County**

Property Address: 1180 N 5TH ST
SAN JOSE, SANTA CLARA COUNTY, CA 95112
("Property")

APN: 235-12-009
Report Date: 09/22/2025
Report Number: 3506289

AIRPORT INFLUENCE AREA DISCLOSURE

DISCUSSION:

Certain airports are not disclosed in this Report. JCP-LGS has made a good faith effort to identify the airports covered under Section 1102.6a. Sources consulted include official land use maps and/or digital data made available by a governing Airport Land Use Commission (ALUC) or other designated government body. Most facilities for which an Airport Influence Area has been designated are included on the "California Airports List" maintained by the California Department of Transportation's Division of Aeronautics. Not disclosed in this Report are public use airports that are not in the "California Airports List", airports that are physically located outside California, heliports and seaplane bases that do not have regularly scheduled commercial service, and private airports or military air facilities unless specifically identified in the "California Airports List". **If the seller has actual knowledge of an airport in the vicinity of the subject property that is not disclosed in this Report, and that is material to the transaction, the seller should disclose this actual knowledge in writing to the buyer.**

Most facilities for which an Airport Influence Area has been designated are included on the "California Airports List" maintained by the California Department of Transportation's Division of Aeronautics. The inclusion of military and private airports varies by County, and heliports and seaplane bases are not included, therefore, airports in these categories may or may not be included in this disclosure.

NOTE: Proximity to an airport does not necessarily mean that the property is exposed to significant aviation noise levels. Alternatively, there may be properties exposed to aviation noise that are greater than two miles from an airport. Factors that affect the level of aviation noise include weather, aircraft type and size, frequency of aircraft operations, airport layout, flight patterns or nighttime operations. Buyer should be aware that aviation noise levels can vary seasonally or change if airport usage changes.

PUBLIC RECORD: Based on officially adopted land use maps and/or digital data made publicly available by the governing ALUC or other designated government body. If the ALUC or other designated government body has not made publicly available a current officially adopted airport influence area map, then California law states that "a written disclosure of an airport within two (2) statute miles shall be deemed to satisfy any city or county requirements for the disclosure of airports in connection with transfers of real property."

REPORTING STANDARD: "IN" shall be reported along with the facility name(s) and the "Notice of Airport in Vicinity" if any portion of the Property is situated within either (a) an Airport Influence Area as designated on officially adopted maps or digital data or (b) a two (2) mile radius of a qualifying facility for which an official Airport Influence Area map or digital data has not been made publicly available by the ALUC or other designated governing body. "NOT IN" shall be reported if no portion of the Property is within either area.

**The Natural Hazard Disclosure Report
For SANTA CLARA County**

Property Address: 1180 N 5TH ST
SAN JOSE, SANTA CLARA COUNTY, CA 95112
("Property")

APN: 235-12-009
Report Date: 09/22/2025
Report Number: 3506289

AIRPORT NOISE DISCLOSURE

DISCUSSION: California Civil Code §1102.17 requires the seller(s) of residential real property who has/have actual knowledge that the property in the transaction is affected by airport use must give written notice of that knowledge, as soon as practicable, before transfer of title.

Under the Federal Aviation Administration's *Airport Noise Compatibility Planning Program Part 150*, certain 65 decibel (dB) Community Noise Equivalent Level (CNEL) contour maps have been produced for some airports. Not all airports have produced noise exposure maps. A property may be near or at some distance from an airport and not be within a delineated noise exposure area, but still experience aviation noise. Unless 65dB CNEL contour maps are published, helipads and military sites are not included in this section of the Report.

The *Airport Noise Compatibility Planning Program* is voluntary and not all airports have elected to participate. Furthermore, not all property in the vicinity of an airport is exposed to 65dB CNEL or greater average aviation noise levels. Conversely a property may be at some distance from an airport and still experience aviation noise. Buyer should be aware that aviation noise levels can vary seasonally or change if airport usage changes after a map is published or after the Report Date. JCP-LGS uses the most seasonally conservative noise exposures provided.

Federal funding may be available to help airports implement noise reduction programs. Such programs vary and may include purchasing properties, rezoning, and insulating homes for sound within 65dB areas delineated on CNEL maps. Airport owners have also cooperated by imposing airport use restrictions that include curfews, modifying flight paths, and aircraft limitations.

PUBLIC RECORD: Certain 65 decibel (dB) Community Noise Equivalent Level (CNEL) contour maps produced under the Federal Aviation Administration's *Airport Noise Compatibility Planning Program Part 150*.

REPORTING STANDARD: "IN" shall be reported if any portion of the Property is situated within a 65 decibel Community Noise Equivalent Level contour identified in the Public Record. "NOT IN" shall be reported if no portion of the Property is situated within a 65 decibel Community Noise Equivalent Level contour identified in the Public Record.

**The Natural Hazard Disclosure Report
For SANTA CLARA County**

Property Address: 1180 N 5TH ST
SAN JOSE, SANTA CLARA COUNTY, CA 95112
("Property")

APN: 235-12-009
Report Date: 09/22/2025
Report Number: 3506289

**SAN FRANCISCO BAY CONSERVATION AND DEVELOPMENT
COMMISSION DISCLOSURE**

DISCUSSION: As of July 1, 2005, Civil Code §1103.4 mandates disclosure to buyers of certain real estate if the boundary of the property is determined to be (1) within 100 feet of the San Francisco Bay shoreline as mapped in 1997 by the National Ocean Survey (NOS), an agency of the National Oceanographic and Atmospheric Administration (NOAA); or (2) within another mapped zone established by the Bay Conservation and Development Commission (BCDC). The BCDC has regulatory jurisdiction within 100 feet inland from the point of "mean higher high water" as mapped by the NOS, and within other zones the agency has defined along the San Francisco Bay margin (BCDC Memo entitled "Guidance on Determining Commission Jurisdiction Pursuant to Senate Bill 1568").

Notice is required to prevent unknowing violations of the law by new owners who were unaware that certain activities on the real property are subject to the BCDC's permit requirements. The BCDC notes that the Bay is a highly dynamic environment and the shoreline changes over time (see Discussion below). In addition, there is inherent uncertainty in the shoreline position as mapped by the NOS or any agency. The BCDC advises the buyer and other interested parties to contact its office if a more authoritative jurisdictional determination is desired. The BCDC office is located at 50 California Street, Suite 2600, San Francisco, California 94111, and can be reached at (415) 352-3600, or by email to info@bcdc.ca.gov

The BCDC has issued maps for some parts of its jurisdiction, including the San Francisco Bay Plan maps (California Code of Regulations, Title 14, Section 10121) and the Suisun Marsh Plan maps (Nejedly-Bagley-Z'berg Suisun Marsh Preservation Act of 1974). Official maps have not been issued for other parts of the BCDC jurisdiction (McAteer-Petris Act areas) because the Bay is a highly dynamic environment and the shoreline changes over time (in part because the sea level also changes over time). In those areas where official BCDC maps are not available or along the edges of the BCDC's mapped jurisdiction, to meet the disclosure requirements, this Report will indicate that the property "could be within" the BCDC's jurisdiction and that a location-specific jurisdictional determination should be made by consulting the BCDC. This determination of "could be within" the BCDC's jurisdiction was recommended by the BCDC in that certain Memo entitled "Guidance on Determining Commission Jurisdiction Pursuant to Senate Bill 1568" issued in February 2005 and posted on the BCDC website.

PUBLIC RECORDS: San Francisco Bay Plan maps (California Code of Regulations, Title 14, Section 10121) and the Suisun Marsh Plan maps (Nejedly-Bagley-Z'berg Suisun Marsh Preservation Act of 1974) made publicly available by BCDC and that certain Memo entitled "Guidance on Determining Commission Jurisdiction Pursuant to Senate Bill 1568" issued by BCDC in February 2005 and posted on the BCDC website ("BCDC Memo").

REPORTING STANDARD: "WITHIN" shall be reported if any portion of the Property is situated within an areas mapped by BCDC or is within the 100-foot shoreline band. "COULD BE WITHIN" shall be reported if any portion of the Property is situated within one-quarter (1/4) mile of either an area mapped by BCDC or the 100-foot shoreline band. "NOT WITHIN" shall be reported if no portion of the Property is situated within an area that would otherwise be reported as either "WITHIN" or "COULD BE WITHIN".

**The Natural Hazard Disclosure Report
For SANTA CLARA County**

Property Address: 1180 N 5TH ST
SAN JOSE, SANTA CLARA COUNTY, CA 95112
("Property")

APN: 235-12-009
Report Date: 09/22/2025
Report Number: 3506289

Part 4. General Advisories

METHAMPHETAMINE CONTAMINATED PROPERTY DISCLOSURE ADVISORY

DISCUSSION: According to the "Methamphetamine Contaminated Property Cleanup Act of 2005" a property owner must disclose in writing to a prospective buyer if local health officials have issued an order prohibiting the use or occupancy of a property contaminated by meth lab activity. The owner must also give a copy of the pending order to the buyer to acknowledge receipt in writing. Failure to comply with these requirements may subject an owner to, among other things, a civil penalty up to \$5,000. Aside from disclosure requirements, this new law also sets forth procedures for local authorities to deal with meth-contaminated properties, including the filing of a lien against a property until the owner cleans up the contamination or pays for the cleanup costs.

The Natural Hazard Disclosure Report For SANTA CLARA County

Property Address: 1180 N 5TH ST
SAN JOSE, SANTA CLARA COUNTY, CA 95112
("Property")

APN: 235-12-009
Report Date: 09/22/2025
Report Number: 3506289

MOLD ADVISORY

DISCUSSION: The Buyer is hereby advised that naturally occurring molds may exist both inside and outside of any home and may not be visible to casual inspection. Persons exposed to extensive mold levels can become sensitized and develop allergies to the mold or other health problems. Extensive mold growth can damage a structure and its contents. All prospective purchasers of residential and commercial property are advised to thoroughly inspect the Property for mold. Be sure to inspect the Property inside and out for sources of excess moisture, current water leaks and evidence of past water damage.

As part of a buyer's physical inspection of the condition of a property, the buyer should consider engaging an appropriate and qualified professional to inspect and test for the presence of harmful molds and to advise the buyer of any potential risk and options available. This advisory is not a disclosure of whether harmful mold conditions exist at a property or not. No testing or inspections of any kind have been performed by The Company. Any use of this form is acknowledgement and acceptance that The Company does not disclose, warrant or indemnify mold conditions at a property in any way and is not responsible in any way for mold conditions that may exist. Information is available from the California Department of Health Services Indoor Air Quality Section fact sheet entitled, "Mold in My Home: What Do I Do?" The fact sheet is available at https://www.cdph.ca.gov/Programs/CCDPHP/DEODC/EHLB/IAQ/CDPH%20Document%20Library/MMIMH_050619_ADA.pdf or by calling (510) 620-3620.

The Toxic Mold Protection Act of 2001 requires that information be developed regarding the potential issues surrounding naturally occurring molds within a home. Information was written by environmental authorities for inclusion in the *Residential Environmental Hazards: A Guide for Homeowners, Buyers, Landlords and Tenants* booklet developed by the California Environmental Protection Agency and the Department of Health Services. It is found in Chapter VII of that booklet, and includes references to sources for additional information.

For local assistance, contact your county or city Department of Health, Housing, or Environmental Health.

The Natural Hazard Disclosure Report For SANTA CLARA County

Property Address: 1180 N 5TH ST
SAN JOSE, SANTA CLARA COUNTY, CA 95112
("Property")

APN: 235-12-009
Report Date: 09/22/2025
Report Number: 3506289

RADON ADVISORY

DISCUSSION: For its Radon Advisory, JCP-LGS uses the updated assessment of radon exposure published in 1999 by the Lawrence Berkeley National Laboratory (LBNL) and Columbia University, under support from the U.S. Environmental Protection Agency (EPA), the National Science Foundation, and the US Department of Energy (published online at <http://www2.lbl.gov/Science-Articles/Archive/radon-risk-website.html>). Based on this recent assessment, JCP-LGS radon advisory is as follows:

All of California's 58 counties have a predicted median annual-average living-area concentration of radon below 2.0 pCi/L (picocuries per liter of indoor air) -- which is well below the EPA's guideline level of 4 pCi/L and equivalent to the lowest hazard zone (Zone 3) on the 1993 EPA Map of Radon Zones.

The "median concentration" means that half of the homes in a county are expected to be below this value and half to be above it. All houses contain some radon, and a few houses will contain much more than the median concentration. **The only way to accurately assess long-term exposure to radon in a specific house is through long-term testing (sampling the indoor air for a year or more). The EPA recommends that all homes be tested for radon.**

NOTE: JCP-LGS does not use the EPA's 1993 map for advisory purposes because that map shows "short-term" radon exposure averaged by county. It was based on "screening measurements" that were intentionally designed to sample the worst-case conditions for indoor air in US homes--using spot checks (sampling for just a few days), in the poorest air quality (with sealed doors and windows), at the worst time of the year (winter), in the worst part of the house (the basement, if one was available). These short-term, winter, basement measurements are both biased and variable compared to long-term radon concentrations (averaged over a year) in the living area of a house. Long-term concentrations are a more accurate way to judge the long-term health risk from radon. For the above reasons, the EPA expressly disclaims the use of its 1993 map for determining whether any house should be tested for radon, and authorizes no other use of its map for property-specific purposes. For additional information about EPA guidelines and radon testing, see "Chapter VII--Radon", in the California Department of Real Estate's *Residential Environmental Hazards: A Guide for Homeowners, Homebuyers, Landlords and Tenants*.

ENDANGERED SPECIES ACT ADVISORY

DISCUSSION: The Federal Endangered Species Act of 1973 ("ESA"), as amended, requires that plant and animal species identified and classified ("listed") by the Federal government as "threatened" or "endangered" be protected under U.S. law. Areas of habitat considered essential to the conservation of a listed species may be designated as "critical habitat" and may require special management considerations or protection. All threatened and endangered species -- even if critical habitat is not designated for them -- are equally afforded the full range of protections available under the ESA.

In California alone, over 300 species of plants and animals have been designated under the ESA as threatened or endangered, and over 80 species have critical habitats designated for them. Most California counties are host to a dozen or more protected species and, in many cases, 10 or more species have designated critical habitats within a county.

ADVISORY: An awareness of threatened and endangered species and/or critical habitats is not reasonably expected to be within the actual knowledge of a seller.

No federal or state law or regulation requires a seller or seller's agent to disclose threatened or endangered species or critical habitats, or to otherwise investigate their possible existence on real property. Therefore, Buyer is advised that, prior to purchasing a vacant land parcel or other real property, Buyer should consider investigating the existence of threatened or endangered species, or designated critical habitats, on or in the vicinity of the Property which could affect the use of the Property or the success of any proposed (re)development.

FOR MORE INFORMATION: Complete and current information about the threatened and endangered species in California that are Federally listed in each county -- including all critical habitats designated there -- is available on the website of the U.S. Fish & Wildlife Service, the Federal authority which has enforcement responsibility for the ESA.

U.S. Fish & Wildlife Service Endangered Species Database (TESS)

<https://www.fws.gov/endangered/>

The Natural Hazard Disclosure Report For SANTA CLARA County

Property Address: 1180 N 5TH ST
SAN JOSE, SANTA CLARA COUNTY, CA 95112
("Property")

APN: 235-12-009
Report Date: 09/22/2025
Report Number: 3506289

ABANDONED MINES ADVISORY

DISCUSSION: According to the California Department of Conservation, Division of Mine Reclamation, since the Gold Rush of 1849, tens of thousands of mines have been dug in California. Many were abandoned when they became unproductive or unprofitable. The result is that California's landscape contains many thousands of abandoned mines, which can pose health, safety, or environmental hazards on and around the mine property. Mines can present serious physical safety hazards, such as open shafts or adits (mine tunnel), and they may create the potential to contaminate surface water, groundwater, or air quality. Some abandoned mines are such massive problems as to earn a spot on the Federal Superfund environmental hazard list.

No California law requires the disclosure of abandoned mines in a real estate transaction, unless the existence of an abandoned mine is within the actual knowledge of the Seller and is deemed to be a fact material to the transaction.

The Division of Mine Reclamation (DMR) and the U.S. Geological Survey maintain a database of abandoned mines -- however, it is known to be incomplete and based on maps that are often decades out of date. Many mines are not mapped because they are on private land. The DMR warns that, *"Many old and abandoned mines are not recorded in electronic databases, and when they are, the information may not be detailed enough to accurately define, differentiate or locate the mine feature, such as a potentially hazardous vertical shaft or horizontal adit or mine waste."* (See reference below.)

Accordingly, this Report does not contain an abandoned mines disclosure from any government database or map or any other source, in order to protect the seller from liability for non-disclosure of unrecorded abandoned mines.

Parties concerned about the possible existence or impact of abandoned mines in the vicinity of the Property are advised to retain a State-licensed geotechnical consultant to study the site and issue a report. Other sources of information include, but are not limited to, the State Division of Mine Reclamation at (916) 323-9198 (website: <https://www.conservation.ca.gov/DMR>), and the Engineering, Planning or Building Departments in the subject City and County.

FOR MORE INFORMATION: For more information visit the State Division of Mine Reclamation's website at: <https://www.conservation.ca.gov/dmr/publications/Documents/Abandoned%20Mine%20Lands%20FAQs.pdf>

OIL & GAS WELL ADVISORY

California is currently ranked fourth in the nation among oil producing states. Surface oil production is concentrated mainly in the Los Angeles Basin and Kern County, and in districts elsewhere in the state. In recent decades, real estate development has rapidly encroached into areas where oil production has occurred. Because the state's oil production has been in decline since the 1980's, thousands of oil and gas wells have been shut down or abandoned, and many of those wells are in areas where residential neighborhoods now exist.

According to the California Department of Conservation ("DOC"), to date, about 230,000 oil and gas wells have been drilled in California and around 105,000 are still in use. The majority of remaining wells have been sealed ("capped") under the supervision of the DOC's Geologic Energy Management Division (CalGEM). A smaller number have been abandoned and have no known responsible operator -- these are called "orphan" wells. The state has a special fund that pays the cost of safely capping orphan wells, however, that program is limited in its scope and progress.

Buyer should be aware that, while the DOC database is the most comprehensive source available for California oil and gas well information, the DOC makes no warranties that the database is absolutely complete, or that reported well locations are known with absolute accuracy.

For More Information

For a search of the state's databases of oil and gas wells and sites of known environmental contamination on or near the Property, please obtain the JCP-LGS Residential Environmental Report. For general information, visit the California Department of Conservation, Geologic Energy Management Division (CalGEM) at <https://www.conservation.ca.gov/CalGEM/>.

**The Natural Hazard Disclosure Report
For SANTA CLARA County**

Property Address: 1180 N 5TH ST
SAN JOSE, SANTA CLARA COUNTY, CA 95112
("Property")

APN: 235-12-009
Report Date: 09/22/2025
Report Number: 3506289

ELECTROMAGNETIC FIELD ("EMF") ADVISORY

According to the National Cancer Institute ("NCI") a 1979 study pointed to a possible association between living near electric power lines and childhood leukemia. More recent studies have not found an association or have found one only for those children who lived in homes with very high levels of magnetic fields present in few residences. The NCI also notes that a majority of epidemiological studies have also shown no relationship between breast cancer in women and exposure to extremely low frequency EMFs ("ELF-EMF"s) in the home, although a few individual studies have suggested an association; only one reported results that were statistically significant. Sources of extremely low frequency ELF-EMF include power lines, electrical wiring, and electrical appliances such as shavers, hair dryers, and electric blankets. For more information please visit the NCI Electromagnetic Fields and Cancer portal at <https://www.cancer.gov/about-cancer/causes-prevention/risk/radiation/electromagnetic-fields-fact-sheet>

Weighing in on the same matter The World Health Organization ("WHO") states, "Based on a recent in-depth review of the scientific literature, the WHO concluded that current evidence does not confirm the existence of any health consequences from exposure to low level electromagnetic fields. However, some gaps in knowledge about biological effects exist and need further research." WHO also asserts, "Despite many studies, the evidence for any effect remains highly controversial. However, it is clear that if electromagnetic fields do have an effect on cancer, then any increase in risk will be extremely small. The results to date contain many inconsistencies, but no large increases in risk have been found for any cancer in children or adults." For more information please visit WHO's EMF Q&A website at <https://www.who.int/news-room/q-a-detail/electromagnetic-fields>

The National Institute of Environmental Health Science ("NIEHS") Electric & Magnetic Fields web page at <https://www.niehs.nih.gov/health/topics/agents/emf/index.cfm> states, "If you are concerned about EMFs emitted by a power line or substation in your area, you can contact your local power company to schedule an on-site reading. You can also measure EMFs yourself with the use of a gaussmeter, which is available for purchase online through a number of retailers."

For further information and additional reading please visit:

- United States Environmental Protection Agency ("U.S. EPA")
<https://www.epa.gov/radtown/electric-and-magnetic-fields-power-lines>
- The National Institute of Environmental Health Sciences ("NIEHS") & National Institutes of Health ("NIH")
https://www.niehs.nih.gov/health/materials/electric_and_magnetic_fields_associated_with_the_use_of_electric_power_questions_and_answers_english_508.pdf

**The Natural Hazard Disclosure Report
For SANTA CLARA County**

Property Address: 1180 N 5TH ST
SAN JOSE, SANTA CLARA COUNTY, CA 95112
("Property")

APN: 235-12-009
Report Date: 09/22/2025
Report Number: 3506289

TSUNAMI MAP ADVISORY

DISCUSSION: The California Emergency Management Agency (CalEMA), the University of Southern California Tsunami Research Center (USC), and the California Geological Survey (CGS) have prepared maps that depict areas of maximum tsunami inundation for all populated areas at risk to tsunamis in California (20 coastal counties). The maps were publicly released in December 2009 with the stated purpose that the maps are to assist cities and counties in identifying their tsunami hazard and developing their coastal evacuation routes and emergency response plans only.

These maps specifically contain the following disclaimer:

Map Disclaimer: This tsunami inundation map was prepared to assist cities and counties in identifying their tsunami hazard. It is intended for local jurisdictional, coastal evacuation planning uses only. This map, and the information presented herein, **is not a legal document and does not meet disclosure requirements for real estate transactions nor for any other regulatory purpose.** The California Emergency Management Agency (CalEMA), the University of Southern California (USC), and the California Geological Survey (CGS) make no representation or warranties regarding the accuracy of this inundation map nor the data from which the map was derived. Neither the State of California nor USC shall be liable under any circumstances for any direct, indirect, special, incidental or consequential damages with respect to any claim by any user or any third party on account of or arising from the use of this map.

A tsunami is a series of ocean waves or surges most commonly caused by an earthquake beneath the sea floor. These maps show the maximum tsunami inundation line for each area expected from tsunamis generated by undersea earthquakes and landslides in the Pacific Ocean. Because tsunamis are rare events in the historical record, the maps provide no information about the probability of any tsunami affecting any area within a specific period of time.

Although these maps may not be used as a legal basis for real estate disclosure or any other regulatory purpose, the CGS has, however, provided diagrams of the maps online which the public can view. To see a maximum tsunami inundation map for a specific coastal community, or for additional information about the construction and/or intended use of the tsunami inundation maps, visit the websites below:

State of California Emergency Management Agency, Earthquake and Tsunami Program:
<https://www.conservation.ca.gov/cgs/tsunami/maps>

University of Southern California -- Tsunami Research Center:
<https://tsunamiresearchcenter.com/category/tsunami-archive/>

State of California Geological Survey Tsunami Information:
<https://www.tsunami.gov/>

National Oceanic and Atmospheric Agency Center for Tsunami Research (MOST model):
<http://nctr.pmel.noaa.gov/time/background/models.html>

**The Natural Hazard Disclosure Report
For SANTA CLARA County**

Property Address: 1180 N 5TH ST
SAN JOSE, SANTA CLARA COUNTY, CA 95112
("Property")

APN: 235-12-009
Report Date: 09/22/2025
Report Number: 3506289

RESIDENTIAL FIREPLACE DISCLOSURE

Residential wood burning is the leading source of wintertime air pollution in the Bay Area and studies have confirmed there are significant health impacts from exposure to fine particulate matter found in wood smoke. The Bay Area Air Quality Management District ("BAAQMD") established the Wood Burning Devices (Wood Smoke Rule), Regulation 6, Rule 3 to reduce wintertime smoke pollution and protect public health. The Wood Smoke Rule requires anyone selling, renting or leasing a property in the Bay Area to disclose the potential health impacts from air pollution caused from burning wood. Fine particulate matter, also known as PM2.5, can travel deep into the respiratory system, bypass the lungs and enter the blood stream. Exposure may cause short term and long term health effects, including eye, nose and throat irritation, reduced lung function, asthma, heart attacks, chronic bronchitis, cancer and premature deaths. Exposure to fine particulates can worsen existing respiratory conditions. High PM2.5 levels are associated with increased respiratory and cardiovascular hospital admissions, emergency department visits, and even deaths. Children, the elderly and those with pre-existing respiratory or heart conditions are most at risk from negative health effects of PM2.5 exposure. The Buyer should consult with a licensed professional to inspect, properly maintain, and operate a wood burning stove or fireplace insert according to manufacturer's specifications to help reduce wood smoke pollution. The Air District encourages the use of cleaner and more efficient, non-wood burning heating options such as gas-fueled or electric fireplace inserts to help reduce emissions and exposure to fine particulates.

When the BAAQMD issues a Winter Spare the Air Alert during the winter season from November 1 through the end of February, it is illegal to burn wood, manufactured fire logs, pellets or any solid fuels in fireplaces, wood stoves or outdoor fire pits. To check when a Winter Spare the Air Alert is issued and it is illegal to burn wood, please call 1-877-4NO-BURN or visit www.baaqmd.gov or www.sparetheair.org.

END OF NATURAL HAZARD DISCLOSURE REPORT SECTION
See Terms and Conditions at end of this Report.

**California Property Tax Disclosure Report
For SANTA CLARA County**

Property Address: 1180 N 5TH ST
SAN JOSE, SANTA CLARA COUNTY, CA 95112
("Property")

APN: 235-12-009
Report Date: 09/22/2025
Report Number: 3506289

California Property Tax Disclosure Report

The parties for whom this Report was prepared are the owner or transferor ("Seller") of the Commercial Property ("Property") on the Report Date, the buyer or transferee ("Buyer") of the Commercial Property from Seller as of the Report Date, and their respective licensed real estate agents ("Agents"). Seller, Buyer and the Agents are sometimes referred to herein as "Party" or "Parties."

Part 1. Introduction and Summary

This Tax Report section discusses the results of an electronic search of specified government lists ("Databases") containing real property tax information concerning the Commercial Property. This tax information is based on the County's Fiscal Year 2024-2025 Secured Property Tax Roll and other sources identified in the Report. To understand the information provided, please read this entire Report.

Summary of Property Tax Determinations

| The Commercial Property: | IS | IS NOT | |
|--------------------------|----------|----------|---|
| A. | | X | NOT SUBJECT TO a Mello-Roos Community Facilities District. 28 |
| B. | | X | NOT SUBJECT TO a 1915 Bond Act District. 28 |
| C. | | X | NOT SUBJECT TO a Property Assessed Clean Energy (PACE) Contract. 28 |
| D. | X | | SUBJECT TO one or more other direct assessments. 29 |
| E. | | X | NOT SUBJECT TO the State Responsibility Area Fire Prevention Fee (SRA Fee is suspended until 2031 by Assembly Bill 398 of 2017). 33 |

Determined by First American Real Estate Disclosures Corporation

THIS IS A DATABASE REPORT ONLY: The tax information in this Report only provides data derived from the County Tax Assessor's and Treasure's Databases ("Databases") identified in this Report unless specified otherwise in the Report. While JCP-LGS has made good faith efforts to report from the Databases as accurately as possible, the quality, accuracy, and currency ("Database Date") of the information contained in these Databases can vary greatly. For more information regarding a specific Database, please read Part 2 of this Report. By use of this Report, Buyer agrees this is a Report product and not an insurance policy and is subject to the Terms and Conditions attached hereto and incorporated herein.

**California Property Tax Disclosure Report
For SANTA CLARA County**

Property Address: 1180 N 5TH ST
SAN JOSE, SANTA CLARA COUNTY, CA 95112
("Property")

APN: 235-12-009
Report Date: 09/22/2025
Report Number: 3506289

Part 2. NOTICE OF SPECIAL TAX/ASSESSMENT

Special assessments, also referred to as direct or fixed assessments, are charges that are not based on the value of the property. These charges are levied to provide funding for services or improvements that directly benefit the property. Mello-Roos Community Facility Districts and 1915 Bond Districts are also classified as special assessments. PACE contract agreements are typically created pursuant to the Mello-Roos Act or the 1915 Bond Act. Certain special assessments may be subject to accelerated foreclosure if allowed to go delinquent.

TO THE PROSPECTIVE PURCHASER OF THE COMMERCIAL PROPERTY AT THE ADDRESS REFERENCED ABOVE: THIS IS A NOTIFICATION TO BUYER PRIOR TO PURCHASING THE COMMERCIAL PROPERTY.

A. Mello-Roos Community Facilities Districts

This Commercial Property is NOT SUBJECT to Mello-Roos Community Facilities Districts.

Database: Secured Property Tax Roll **Database Date:** FY 2024-2025

B. 1915 Bond Act Assessment Districts

This Commercial Property is NOT SUBJECT to 1915 Bond Assessment Districts.

Database: Secured Property Tax Roll **Database Date:** FY 2024-2025

C. Notice of Property Assessed Clean Energy (PACE) Program

Property assessed clean energy (PACE) programs allow owners to finance energy and water efficiency and renewable energy projects, and qualifying seismic and wildfire safety improvements, on residential and commercial structures through a voluntary assessment on the property. PACE programs are offered by many city, county and regional agencies, with repayment periods from 5 to 20 years or more. **PACE liens are authorized pursuant to Section 53328 of the California Government Code, (the "Mello-Roos Community Facilities Act of 1982") or California Streets & Highways Code Section 8500 (the "1915 Act") and are disclosed pursuant to Section 1102.6b of the California Civil Code.**

WHAT THIS MEANS: If a property owner voluntarily enters into a PACE program, a contractual assessment lien is placed on the property. The lien is repaid through installments collected on the property owner's secured county property tax bill. In certain situations the program administrator may bill the property owner directly. If the property is sold and the contractual assessment is not repaid in full, the new owner may be responsible for future assessments contributing towards repayment of the PACE contract.

DISCLOSURES AT RESALE: A PACE lien runs with the land. This means that the responsibility to repay the PACE lien may fall to the new owner upon transfer of the property unless the lien is paid off before closing. This fact may be material to a buyer's decision to purchase or price offered for the property. In addition, the buyer's lender may require the lien to be paid in full before closing (for certain federally backed mortgages, for example). Therefore, the property seller and his or her real estate agent may have a duty to disclose the existence of a PACE lien on the sale property.

The Property IS NOT SUBJECT to a PACE lien documented in the county's Fiscal Year 2024-2025 Secured Property Tax Roll. Note: Buyer should read the preliminary title report and obtain and read all exceptions listed therein to investigate any PACE lien executed more recently. In the title report, lien exceptions are named as recorded with the county; therefore, a PACE lien may be listed under a name that is not obvious.

D. Accelerated Foreclosure Information

Certain assessment or bond issues may contain accelerated foreclosure liens which have priority over other real property taxes and are a legal right included as part of the security for the obligation. The issuers of such bonds are often contractually required to monitor and collect delinquent assessments quickly. Accordingly, these assessments are not subject to the five (5) year waiting period applicable to ad valorem real property taxes. If the real property is subject to such an assessment and the taxes are not paid promptly, the real property may be foreclosed upon and sold at public auction on an expedited basis. **Therefore, it is extremely important that the real property tax bill be paid on time to prevent the accelerated foreclosure.**

E. Approved Districts Which Have Been Formed and Authorized But Are Not Yet Levied

Certain Mello-Roos Communities Facilities Districts or 1915 Bond Act Assessment Districts may have been formed and authorized but have not yet to be levied. These Districts may not appear in this Report. However, the information regarding such districts may appear on your preliminary report issued by a title company. The district may levy a special tax on future property tax bills for the Property.

**California Property Tax Disclosure Report
For SANTA CLARA County**

Property Address: 1180 N 5TH ST
SAN JOSE, SANTA CLARA COUNTY, CA 95112
("Property")

APN: 235-12-009
Report Date: 09/22/2025
Report Number: 3506289

Part 3. Current Property Tax Bill Summary

A. Summary of 2024-2025 Property Tax Bill

The following is a summary of Database information obtained from the SANTA CLARA COUNTY Secured Property Tax Roll (Database) for Tax Year 2024-2025 ("Database Date"). This summary is provided for informational purposes only. The summary includes Ad Valorem taxes which are based on the property's Assessed Value as well as other Non- Ad Valorem Direct or Special Assessments. Upon transfer of ownership, the Assessed Value may be reset to the Current Market Value or Sale Price which may result in a substantial change in the Ad Valorem taxes assessed. Please see Parts 4 and 5 of this Report for more information regarding Ad Valorem taxes and Supplemental taxes.

| | |
|--------------------------------|--------------|
| Total Assessed Value: | \$704,428.00 |
| 1st Installment Due 11/01/2024 | \$4,813.40 |
| 2nd Installment Due 02/01/2025 | \$4,813.40 |
| Total Annual Tax Liability | \$9,626.80 |

General Ad Valorem Taxes

| AGENCY | DESCRIPTION | AMOUNT | CONTACT PHONE |
|-----------------------------------|---|-------------------|---------------|
| SANTA CLARA COUNTY | GENERAL AD VALOREM TAX & VOTER APPROVED BONDS | \$8,053.68 | 408-299-5540 |
| SANTA CLARA VALLEY WATER DISTRICT | SCVWD TAX RATE | \$28.88 | 408-299-5540 |
| TOTAL AD VALOREM TAXES | | \$8,082.56 | |

Direct and/or Special Assessments

| AGENCY | DESCRIPTION | AMOUNT | CONTACT PHONE |
|---|-----------------------------------|-------------------|----------------|
| SAN JOSE UNIFIED SCHOOL DISTRICT | SAN JOSE USD MEASURE Y PARCEL TAX | \$72.00 | 408-535-6444 |
| SAN JOSE SEWER SANITATION/STORM | SEWER SANI/STORM CHARGE | \$803.80 | (408) 535-3500 |
| CITY OF SAN JOSE LIBRARY | S.J. LIBRARY ASSMT. | \$106.88 | (800) 441-8280 |
| SANTA CLARA COUNTY VECTOR CNTRL DIST | SCCO VECTOR CONTROL | \$14.82 | (800) 273-5167 |
| SANTA CLARA COUNTY VECTOR CNTRL DIST | MOSQUITO ASSESSMENT NO. 2 | \$54.24 | (800) 273-5167 |
| SCVWD FLOOD ASSMT CENTRAL | FLOOD CONTROL | \$21.30 | (408) 630-2810 |
| SAN FRANCISCO BAY RESTORATION AUTHORITY | CLEAN AND HEALTHY BAY PARCEL TAX | \$12.00 | 888-508-8157 |
| OPEN SPACE DIST - SANTA CLARA COUNTY | SCCOSA ASMT DIST 1 | \$34.18 | (800) 273-5167 |
| OPEN SPACE AUTHORITY - SANTA CLARA VALLEY | SCVOSA MEASURE T | \$24.00 | (800) 273-5167 |
| SANTA CLARA VALLEY WATER DIST | SAFE, CLEAN WATER | \$401.02 | 408-630-2810 |
| TOTAL DIRECT ASSESSMENTS | | \$1,544.24 | |

**California Property Tax Disclosure Report
For SANTA CLARA County**

Property Address: 1180 N 5TH ST
SAN JOSE, SANTA CLARA COUNTY, CA 95112
("Property")

APN: 235-12-009
Report Date: 09/22/2025
Report Number: 3506289

Part 4. Estimating Property Taxes After the Sale

Instantly and securely calculate estimated property taxes and supplemental taxes on our website by clicking on the following link (or manually calculate them below):

<https://orderform.fanhd.com/Order/TaxCalcForm?token=jo6k2PQ6wx23FOj7xC4UTOJ1uaDJ0BFTK4gNQrCB46AatkRGNUjr8nZ%2bnMs6MnE%2fplyBRmqRrYuG%2fC7kSlp5tkWGPak4YP3Y8l0gcjBi8lY%3d>

A. Calculating Property Taxes After Sale (ESTIMATE ONLY)

PROPERTY TAX ESTIMATOR

The following calculation method is provided to assist Buyer in estimating the approximate amount of property tax charges that the Commercial Property may be subject to for the upcoming tax year based on the assessed valuation being equal to the sales price. The amount derived is only an estimate and is not a substitute for a tax bill from the County, nor does it anticipate new property tax charges, fees or other changes in the property tax rates for future tax years.

| | | | | |
|---|--|-----|----|-----------------|
| 1 | Estimated Sales Price..... | • 1 | \$ | _____ |
| 2 | Estimated Ad Valorem Tax Rate..... | • 2 | | <u>0.01147</u> |
| 3 | Multiply line 1 by line 2. This is your Estimated Ad Valorem Tax..... | • 3 | \$ | _____ |
| 4 | Direct Assessments including Mello Roos Special Taxes, 1915 Bond Act Assessments or PACE Assessments applicable..... | • 4 | \$ | <u>1,544.24</u> |
| 5 | Add lines 3 and 4. Total Estimated Annual Tax Amount After Sale..... | • 5 | \$ | _____ |

The information in this subparagraph A is an estimate only. The purpose of this "ESTIMATOR" is to assist Buyer in planning for property taxes which will be applicable after the Sale Date. This "ESTIMATOR" requires the Buyer's projection of the purchase price of the Commercial Property. Please note that potential exemptions and exclusions are not reflected in this estimate.

Additionally, undeveloped or recently developed properties may be subject to additional Direct Assessments not included in this estimate. JCP-LGS is not responsible or liable for any losses, liabilities or damages resulting from use of this Property Tax Estimator.

B. Exemptions & Exclusions to Ad Valorem Taxes

California law provides certain exemptions or exclusions from reassessments. In order to determine if Buyer may qualify for any exemptions or exclusions or to obtain a comprehensive list of available exemptions and exclusions, please contact the County Tax Assessors Office 408-299-5540 or visit the County website at <https://www.sccassessor.org/>. Additional information is also available on the website for the California Board of Equalization at www.boe.ca.gov

Reassessment Due to Decline in Value

Real estate markets are cyclical. In a less competitive market there are more sellers than buyers, and real estate prices can drop, sometimes precipitously. When a property is sold, in most cases its assessed value for tax purposes is set equal to the sale price. A drop in market value can mean the original assessment, and your property tax bill, is too high.

The County Tax Assessors Office is required to lower the assessment of any real property if it is higher than the current market value as of January 1 of each year. Each case is reviewed individually upon request by the property owner for the current year or the upcoming year. The annual deadline for filing an appeal – the "assessment appeal filing date" is November 30 in most California counties. For more information or to obtain a property tax reassessment request form, contact the Tax Assessors Office or visit the SANTA CLARA County website.

**California Property Tax Disclosure Report
For SANTA CLARA County**

Property Address: 1180 N 5TH ST
SAN JOSE, SANTA CLARA COUNTY, CA 95112
("Property")

APN: 235-12-009
Report Date: 09/22/2025
Report Number: 3506289

Part 5. Supplemental Property Tax Information

A. General Information Regarding Supplemental Taxes

California law mandates the county assessor to reappraise real property upon a change in ownership or completion of new construction. The assessor's office issues a supplemental assessment which reflects the difference between the prior assessed value and the new assessment. This value is prorated based on the number of months remaining in the fiscal tax year which ends June 30.

Notices of the supplemental assessment are mailed out to the property owners prior to the issuance of the supplemental tax bill or refund if the value is reduced. The taxes or refund based on the supplemental assessment are in addition to the regular annual tax bill.

The supplemental tax will be due from the current owner in addition to the regular tax assessment. Accordingly for the first year of ownership, Buyer should plan for this additional payment.

B. Supplemental Property Tax Disclosure

The following notice is mandated by California Civil Code Section 1102.6c:

NOTICE OF YOUR "SUPPLEMENTAL" PROPERTY TAX BILL

"California property tax law requires the Assessor to revalue real property at the time the ownership of the property changes. Because of this law, you may receive one or two supplemental tax bills, depending on when your loan closes.

The supplemental tax bills are not mailed to your lender. If you have arranged for your property tax payments to be paid through an impound account, the supplemental tax bills will not be paid by your lender. It is your responsibility to pay these supplemental bills directly to the Tax Collector.

If you have any question concerning this matter, please call your local Tax Assessor or Collector's Office."

SANTA CLARA County Assessor
Phone: 408-299-5540
Website: <https://www.sccassessor.org/>

**California Property Tax Disclosure Report
For SANTA CLARA County**

Property Address: 1180 N 5TH ST
SAN JOSE, SANTA CLARA COUNTY, CA 95112
("Property")

APN: 235-12-009
Report Date: 09/22/2025
Report Number: 3506289

C. Calculating Supplemental Taxes After Sale (ESTIMATE ONLY)

Instantly and securely calculate estimated property taxes and supplemental taxes on our website (or manually calculate them below):

<https://orderform.fanhd.com/Order/TaxCalcForm?token=jo6k2PQ6wx23FOj7xC4UTOJ1uaDJ0BFTK4gNQrCB46AatkRGNUjr8nZ%2bnMs6MnE%2fplyBRmqRrYuG%2fC7kSlp5tkWGPak4YP3Y8l0gcjBi8lY%3d>

SUPPLEMENTAL TAX ESTIMATOR

The following schedule is provided to estimate the potential amount of the supplemental taxes on a given property and does NOT include the amount of the regular annual ad valorem property tax. The following calculation provides an estimate of the supplemental property taxes that can be expected during the first year of ownership, and should be used for planning purposes only.

| | | | | |
|---|---|-----|----|-------------------|
| 1 | Estimated Sales Price..... | • 1 | \$ | _____ |
| 2 | Estimated Current Assessed Value..... | • 2 | \$ | <u>704,428.00</u> |
| 3 | Subtract line 2 from line 1. Estimated Supplemental Assessed Value..... | • 3 | \$ | _____ |
| 4 | Multiply line 3 by 0.01147000 (the Estimated Ad Valorem Tax Rate for the Commercial Property). Estimated Full-Year Supplemental Tax Obligation..... | • 4 | \$ | _____ |

If the Sale Date for the Commercial Property falls during the months of January through May, Buyer will receive TWO supplemental tax bills: (a) one for the current partial tax year; and (b) one for the next full tax year. The supplemental taxes can be estimated by completing lines 5 through 8 below:

| | | | |
|---|---|-----|----------|
| 5 | Enter the Month-of-Sale Factor from TABLE 1 below..... | • 5 | _____ |
| 6 | Multiply line 4 by line 5. Estimated Supplemental Tax Bill # 1..... | • 6 | \$ _____ |
| 7 | Enter the amount on line 4. Estimated Supplemental Tax Bill # 2..... | • 7 | \$ _____ |
| 8 | Add lines 6 and 7. Total estimated Supplemental Tax Bill..... | • 8 | \$ _____ |

If the Sale Date for the Commercial Property falls during the months of June through December, Buyer will receive ONE supplemental tax bill. The supplemental tax can be estimated by completing lines 9 and 10 below:

| | | | |
|----|---|------|----------|
| 9 | Enter the Month-of-Sale Factor from TABLE 2 below..... | • 9 | _____ |
| 10 | Multiply line 4 by line 9. Total estimated Supplemental Tax Bill..... | • 10 | \$ _____ |

TABLE 1. Month-of-Sale Factor

| | |
|------------|--------|
| Jan | 0.4167 |
| Feb | 0.3333 |
| Mar | 0.2500 |
| Apr | 0.1667 |
| May | 0.0833 |

TABLE 2. Month-of-Sale Factor

| | |
|-------------|--------|
| Jun | 1.0000 |
| Jul | 0.9167 |
| Aug | 0.8333 |
| Sept | 0.7500 |
| Oct | 0.6667 |
| Nov | 0.5833 |
| Dec | 0.5000 |

The information in this subparagraph C is an estimate only. The purpose of this "ESTIMATOR" is to assist Buyer in planning for the supplemental taxes. The estimated supplemental tax is not a substitute for the supplemental bill and may not be relied upon as such. This "ESTIMATOR" requires the Buyer's projection of the purchase price of the Commercial Property as well as month in which the transaction will be consummated. Please note that potential exemptions and exclusions are not reflected in these estimations. JCP-LGS is not responsible or liable for any losses, liabilities or damages resulting from use of this Supplemental Tax Estimator.

**California Property Tax Disclosure Report
For SANTA CLARA County**

Property Address: 1180 N 5TH ST
SAN JOSE, SANTA CLARA COUNTY, CA 95112
("Property")

APN: 235-12-009
Report Date: 09/22/2025
Report Number: 3506289

Part 6. State Responsibility Area Fire Prevention Fee

In 2011, the California Legislature and Governor enacted a "Fire Prevention Fee" on habitable structures in the State's wildland fire responsibility area ("SRA"). The yearly fee, levied on property owners, paid for various activities to prevent and suppress wildfires in the SRA, and was most recently at the rate of \$152.33 per habitable structure on the property.

Effective July 1, 2017, as authorized by Assembly Bill 398 and signed by the Governor, that fire prevention fee is suspended until 2031.

The fire prevention activities supported by the fee will continue, but instead will be funded through a different State program – one aimed at curbing industrial emissions of carbon dioxide (also known as California's "cap-and-trade" program). For more information, please refer to the text of the Assembly bill at the following link:

http://leginfo.ca.gov/faces/billNavClient.xhtml?bill_id=201720180AB398

Part 7. DOCUMENTARY TRANSFER TAX ADVISORY: Governmental Assessments Paid at the Close of Escrow

Documentary Transfer Tax Defined. Under California Revenue and Taxation Code Sections 11911-11929, counties and cities are authorized to impose a tax on the transfer of real property located within their jurisdiction. The tax is commonly known by various names, including the Documentary Transfer Tax, or Real Property Transfer Tax, or Real Estate Transfer Tax (hereinafter, the "Transfer Tax").

How Much? The "one-time" payment is made at the close of escrow and routinely documented on the HUD-1 Settlement Statement. The amount of the Transfer Tax is typically based on the value or sales price of the real estate that is transferred. The county rate is one dollar and ten cents (\$1.10) for each one thousand dollars (\$1,000) of value. The rate for non-charter ("general law") cities is one-half of the county rate and is credited against the county tax due. Charter cities may impose a Transfer Tax at a rate higher than the county rate.

For any city or county in California, the Transfer Tax rate ("Tax Rate Table") is available at no charge from many sources, most conveniently on the website of the **California Local Government Finance Almanac** (sponsored by the California League of Cities).

<http://www.californiacityfinance.com/PropTransfTaxRates.pdf>

To estimate the Transfer Taxes for the Property, multiply the Property's estimated sales price (in thousands of dollars) by the amount shown in the Tax Rate Table for the city and county in which the Property is located.

Who Pays? The law states that, "the Transfer Tax must be paid by the person who makes, signs or issues any document subject to the tax, or for whose use or benefit the document is made, signed or issued." In practice, this means that the payment of the Transfer Tax is customarily made by the Seller or the Buyer, or shared by both, depending on the jurisdiction in which the transferred Property is located.

**END OF TAX DISCLOSURE REPORT SECTION
See Terms and Conditions at end of this Report.**

**Environmental Screening Report
For SANTA CLARA County**

Property Address: 1180 N 5TH ST
SAN JOSE, SANTA CLARA COUNTY, CA 95112
("Property")

APN: 235-12-009
Report Date: 09/22/2025
Report Number: 3506289

Environmental Screening Report

Is Property Listed in a Disclosed Database?

YES The determination here indicates whether the exact property address as listed above was found in any of the databases searched for this Report. Please note that there may be errors or omissions in the addresses contained in the Local, State and Federal databases that prevent an exact match in this search. Refer to the lists beginning in the section titled "Sites Missing Key Location Information" for site addresses that may be similar to the subject property address or that do not include sufficient address information to precisely locate the site on a map

NO

Summary of Environmental Site Search

| DATABASE SEARCHED (See "Description of Databases Searched" below) | Are Any Contaminated Sites in Database? | 0 to 1/8 mile | 1/8 to 1/2 mile | 1/2 to 1 mile |
|--|--|----------------------|------------------------|----------------------|
| Federal National Priorities List or "Superfund" sites (NPL) | YES | 0 | 0 | 0 |
| Corrective Action Sites (RCRA COR) | YES | 0 | 1 | 1 |
| Federal Sites investigated for possible inclusion in the NPL (SEMS) | MAYBE | 0 | 0 | N/A |
| SEMS Sites That Have Been Archived (SEMS-Archived) | | 0 | 2 | N/A |
| Treatment, Storage & Disposal Sites for Hazardous Materials (RCRA TSD) | | 8 | 96 | N/A |
| Tribal UST And/Or Tribal LUST | MAYBE | 0 | 0 | N/A |
| State EnviroStor Cleanup Sites Database (ENVIROSTOR) | MAYBE | 2 | 12 | N/A |
| State List of Spills, Leaks, Investigation & Cleanup (SLIC) | YES | 2 | 4 | N/A |
| State List of Solid Waste Landfill Facilities (SWIS) | MAYBE | 0 | 0 | N/A |
| State List of Leaking Underground Storage Tanks (LUST) | YES | 6 | 54 | N/A |
| EnviroStor Site With Deed Restriction Or Other Controls (CONTROLS) | MAYBE | 0 | 2 | N/A |
| Potential Generator of hazardous materials Sites (RCRA GEN) | | 1 | N/A | N/A |
| Emergency Response Notification System (ERNS, National Response Center) | MAYBE | 0 | N/A | N/A |
| State List of Underground Storage Tanks (UST) | | 0 | N/A | N/A |
| State List of Historical Underground Storage Tanks (Hist-UST) | | 0 | N/A | N/A |
| State Hazardous Waste Information Summary (HWIS) | YES | 9 | N/A | N/A |
| State List of Aboveground Storage Tanks (AST) | | 0 | N/A | N/A |

N/A = Not Applicable Under Required AAI Search Standard.

MAYBE = Contamination is possible; for example, the database searched includes a mix of contaminated and

non-contaminated sites that are not distinguished, or landfill sites where contamination is common although not certainly identified, or sites currently being investigated for contamination by the responsible agency.

| | | | |
|---------------------------------|------------|------------|----------|
| AAI TOTALS | 28 | 171 | 1 |
| CONTAMINATED SITE TOTALS | 17 | 59 | 1 |
| TOTAL OF SITES FOUND | 200 | | |

**Environmental Screening Report
For SANTA CLARA County**

Property Address: 1180 N 5TH ST
SAN JOSE, SANTA CLARA COUNTY, CA 95112
("Property")

APN: 235-12-009
Report Date: 09/22/2025
Report Number: 3506289

Sites Found on the Databases Searched

UST sites are selected from the list maintained by the State Water Resources Control Board. Information regarding the contents of the tank, and any inspections or testing can be found on the web page <http://geotracker.waterboards.ca.gov/>. AST site information can be obtained from the responsible county or local government agency identified in the Unified Program directory available at <https://osfm.fire.ca.gov/what-we-do/pipeline-safety-and-cupa/certified-unified-program-agency>. Sites that have been identified as having a leak may also appear on one or more of the other lists reported above. Sites listed on LUST or RCRACOR may not appear on the UST or AST lists if the tank has been removed and the case has been closed. Sites listed on the SWIS list may contain hazardous materials. Information is available at <https://www2.calrecycle.ca.gov/SolidWaste/Site/Search>. NPL sites are listed by the U.S. EPA as contaminated sites that have received Federal funding to assist in cleanup. Information is available from the State at www.dtsc.ca.gov or from www.epa.gov and by calling (916) 323-3399. The SEMS (formerly CERCLIS) list includes sites the Federal EPA is investigating for possible inclusion on the NPL.

For information on the lists searched for this Report see the "Description of Databases Searched" Section that follows.

Open = Site listed as undergoing clean-up, investigation, or referral to another agency; or as non-active, abandoned or absorbed but not closed or completed.

Closed = Site listed as clean-up completed, release secured, no further remedial action planned, case closed, or delisted.

Active (or Inactive) = Site facility listed as actively (or not actively) engaged in a type of activity regulated under RCRA.

Deed = Site listed as completed or closed with a deed restriction.

N/A = Not Applicable - site listed as uncontaminated, or as using or storing hazardous substances.

N/P = Not Provided - site status not supplied on agency list used.

| Site Name | Address | Case No. | Status | Database |
|---------------------------------------|--|--------------|--------|------------------|
| BABBITT BEARING COMPANY INC | 1170 NO 5TH ST., SAN JOSE, CA 95112 | CAD029276813 | N/P | CA_HWIS |
| CUPERTINO ELECTRIC INC | 1132 N 7TH ST, SAN JOSE, CA 95112 | CAL000182215 | N/P | CA_HWIS |
| SENJU COMTEK CORP | 1171B N 4TH ST, SAN JOSE, CA 95112 | CAL000187765 | N/P | CA_HWIS |
| THEDY AUTO REPAIR | 1169 N 5th St, SAN JOSE, CA 95112 | CAL000256399 | N/P | CA_HWIS |
| O'REILLY AUTO PARTS STORE 2555 | 1160 N 4TH ST, SAN JOSE, CA 95112 | CAL000392794 | N/P | CA_HWIS |
| CALIBER COLLISION CENTER | 1138 N 5TH ST, SAN JOSE, CA 95112 | CAL000419857 | N/P | CA_HWIS |
| FERGUSON HVAC AIR COLD #1009 | 206 COMMERCIAL ST, SAN JOSE, CA 95122 | CAL000421976 | N/P | CA_HWIS |
| COAST ENGRAVING INC | 1097 NORTH FIFTH STREET, SAN JOSE, CA 95112 | CAL921694362 | N/P | CA_HWIS |
| ADVANCED SURFACE FINISHING | 1181 N FOURTH ST STE 50, SAN JOSE, CA 95112 | CAR000050625 | N/P | CA_HWIS |
| CERTIFIED GARMENT & LINEN SUPPLY | 519 HORNING ST, SAN JOSE, CA 95112 | CAD981672066 | Closed | FED_SEMS_ARCHIVE |
| PROTOMOLD MFG | 1390 OLD BAYSHORE HWY, SAN JOSE, CA 95112 | CAD982359101 | Closed | FED_SEMS_ARCHIVE |
| GARDEN VALLEY FERTILIZER COMPANY | 565 CHARLES STREET, SAN JOSE, CA 95112 | 43070026 | Open | CA_DTSC_DEED |
| MOYER CHEMICAL | 1300,1310, 1336 OLD BAYSHORE HWY, SAN JOSE, CA 95112 | 60001663 | Open | CA_DTSC_DEED |
| SAFETY-KLEEN SYSTEMS, INC | 1147 NORTH 10TH STREET, SAN JOSE, CA 95112-0000 | CAD980817159 | Active | FED_RCRA_COR |
| ULTRA-CHEM C L SCOTT ENTERPRISES INC | 460 REYNOLDS CIR, SAN JOSE, CA 95112 | CAT080013535 | Active | FED_RCRA_COR |
| SON MFG CO | 1099 N 5TH ST, SAN JOSE, CA 95112 | CAD981386410 | Active | FED_RCRA_GEN |
| SOUTH BAY GRADALL RENTALS | 948 N 8TH STREET, SAN JOSE, CA 95112 | CAT000611525 | Active | FED_RCRA_TSD |
| APPLIED REMEDIATION CO | 1450 KOLL CIRCLE STE 102A, SAN JOSE, CA 95112 | CAD982433476 | Active | FED_RCRA_TSD |
| GARDEN VALLEY FERTILIZER CO | 565 CHARLES ST, SAN JOSE, CA 95112 | CAP000103697 | Active | FED_RCRA_TSD |
| J N ABBOTT DISTRIBUTOR INC | 1090 N 10TH ST, SAN JOSE, CA 95112 | CAD983634908 | Active | FED_RCRA_TSD |
| LAIDLAW TRANSIT | 1145 N 13TH, SAN JOSE, CA 95112 | CAD981669625 | Active | FED_RCRA_TSD |
| FITZPATRICK BARRICADE & SAFETY SUPPLY | 1310 OLD BAYSHORE HWY, SAN JOSE, CA 95112 | CAD982337099 | Active | FED_RCRA_TSD |
| EXPRESS TRUCK PARTS, INC | 1371 OLD BAYSHORE HWY, SAN JOSE, CA 95112 | CAD092610484 | Active | FED_RCRA_TSD |
| 13TH ST AUTO BODY & TRUCK | 820 N 13TH ST, SAN JOSE, CA 95112 | CAD982004897 | Active | FED_RCRA_TSD |
| TOSCO NORTHWEST CO NO 11235 | 1271 N 1ST ST, SAN JOSE, CA 95112 | CA0001036698 | Active | FED_RCRA_TSD |
| AMERICAN METAL PLATING SERVICE | 1435 KOLL CIRCLE #104, SAN JOSE, CA 95112 | CAD982334054 | Active | FED_RCRA_TSD |
| Z CON SPECIALTY SERVICES INC | 1645 OLD BAYSHORE HWY, SAN JOSE, CA 95112 | CAR000049957 | Active | FED_RCRA_TSD |
| MOYER CHEM CO INC | 1310 BAYSHORE HWY, SAN JOSE, CA 95108 | CAD009125311 | Active | FED_RCRA_TSD |
| OLSON BROS BODY SHOP | 1325 OLD BAYSHORE HWY, SAN JOSE, CA 95112 | CAD981372675 | Active | FED_RCRA_TSD |
| AMERICAN METAL PLATING SERVICE | 1435 KOLL CIRCLE SUITE I04, SAN JOSE, CA 95112 | CAD981396211 | Active | FED_RCRA_TSD |

**Environmental Screening Report
For SANTA CLARA County**

Property Address: 1180 N 5TH ST
SAN JOSE, SANTA CLARA COUNTY, CA 95112
("Property")

APN: 235-12-009
Report Date: 09/22/2025
Report Number: 3506289

| Site Name | Address | Case No. | Status | Database |
|--|---|--------------|--------|--------------|
| FILOS COLLISION | 1190 N 13TH ST., SAN JOSE, CA 95112 | CAD009148784 | Active | FED_RCRA_TSD |
| CRISTINA WHSE CO INC | 1045 N 10TH ST, SAN JOSE, CA 95112 | CAD004771358 | Active | FED_RCRA_TSD |
| PAUL S AUTO BODY SHOP | 680 N 13TH STREET, SAN JOSE, CA 95112 | CAD982522708 | Active | FED_RCRA_TSD |
| DALES TRANSMISSION | 1604 OLD BAYSHORE RD, SAN JOSE, CA 95112 | CAD981668163 | Active | FED_RCRA_TSD |
| B AND F FRICTION | 1164 OLD BAYSHORE HWY, SAN JOSE, CA 95112 | CAD982343857 | Active | FED_RCRA_TSD |
| MOUNTZ INC | 1080 N 11TH ST, SAN JOSE, CA 95112-2927 | CAL000080988 | Active | FED_RCRA_TSD |
| GOODWILL OF SILICON VALLEY | 950 N 7TH ST, SAN JOSE, CA 95112 | CAD982471831 | Active | FED_RCRA_TSD |
| GREENTEAM MRF | 575 CHARLES ST, SAN JOSE, CA 95112 | CAL000130115 | Active | FED_RCRA_TSD |
| REYES COCA-COLA BOTTLING LLC | 1555 BAYSHORE HIGHWAY, SAN JOSE, CA 95112 | CAD982514879 | Active | FED_RCRA_TSD |
| CASCADE COMPUTER COATINGS INC | 1615 TERMINAL AVE, SAN JOSE, CA 95112 | CAD981370299 | Active | FED_RCRA_TSD |
| SON MFG CO | 1099 N 5TH ST, SAN JOSE, CA 95112 | CAD981386410 | Active | FED_RCRA_TSD |
| AIM SPRAY INC | 1068 N 10TH ST, SAN JOSE, CA 95112 | CAD051611119 | Active | FED_RCRA_TSD |
| SHELL SERVICE STATION | 1120 N FIRST, SAN JOSE, CA 95112 | CAR000103184 | Active | FED_RCRA_TSD |
| A I MARINE & CAR PARTS | 1133 N 10TH ST, SAN JOSE, CA 95112 | CAD983595752 | Active | FED_RCRA_TSD |
| CANNERY PARK V ASSOCIATES | 880 N 8TH ST, SAN JOSE, CA 95112 | CAD983631615 | Active | FED_RCRA_TSD |
| BOB LEWIS VW PEUGEOT | 1560 N 1ST STREET, SAN JOSE, CA 95112 | CAD029156148 | Active | FED_RCRA_TSD |
| ALL-CHEM | 1310 OLD BAYSHORE HWY, SAN JOSE, CA 95112 | CAD980814974 | Active | FED_RCRA_TSD |
| ALL AUTO | 1539 TERMINAL AVE, SAN JOSE, CA 95112 | CAD981650724 | Active | FED_RCRA_TSD |
| SAN JOSE PLATING WORKS INC | 1575 TERMINAL AVE, SAN JOSE, CA 95112 | CAD009164682 | Active | FED_RCRA_TSD |
| A & D PRECISION MACHINING INC | 1450 KOLL CIRCLE #101, SAN JOSE, CA 95112 | CAD981666597 | Active | FED_RCRA_TSD |
| GEAR SHOP THE | 1147 N TENTH ST, SAN JOSE, CA 95112 | CAD981580145 | Active | FED_RCRA_TSD |
| CANNERY PARK III ASSOCIATES | 615 N 9TH ST, SAN JOSE, CA 95112 | CAD983631607 | Active | FED_RCRA_TSD |
| MOHAWK PACKING CO | 1660 OLD BAYSHORE HWY, SAN JOSE, CA 95112 | CAD982438871 | Active | FED_RCRA_TSD |
| COINTROL | 398 COMMERCIAL ST, SAN JOSE, CA 95112 | CAR000115022 | Active | FED_RCRA_TSD |
| FLEETPRIDE #711 | 1164 OLD BAYSHORE HWY, SAN JOSE, CA 95112 | CAL000441866 | Active | FED_RCRA_TSD |
| SAFETY-KLEEN SYSTEMS, INC | 1147 NORTH 10TH STREET, SAN JOSE, CA 95112-0000 | CAD980817159 | Active | FED_RCRA_TSD |
| MIYAHARA AUTO REPAIR | 476 SANTA ANA AVE, SAN JOSE, CA 95112-2944 | CAL000161363 | Active | FED_RCRA_TSD |
| DAHL'S EQUIPMENT RENTAL'S, INC. | 1110 N 10TH ST, SAN JOSE, CA 95112-0000 | CAL000175168 | Active | FED_RCRA_TSD |
| ALPHA AUTO REPAIR | 481 MADERA AVE, SAN JOSE, CA 95112-0000 | CAL000188788 | Active | FED_RCRA_TSD |
| CIVIC PLAZA STATION | 1002 N 1ST ST, SAN JOSE, CA 95112-4922 | CAL000141008 | Active | FED_RCRA_TSD |
| SEASES AUTO SERVICE | 1444 N 4TH ST, SAN JOSE, CA 95112-4715 | CAL000041486 | Active | FED_RCRA_TSD |
| CIVIC CENTER 76 | 1271 NORTH 1ST STREET, SAN JOSE, CA 95112-0000 | CAL000105409 | Active | FED_RCRA_TSD |
| MARTIN AUTOMOTIVE REPAIR | 976 N 4TH ST, SAN JOSE, CA 95112-4939 | CAL000029400 | Active | FED_RCRA_TSD |
| COOK'S AUTOMOTIVE SERVICE INC | 1440 N 4TH ST, SAN JOSE, CA 95112-0000 | CAL000094380 | Active | FED_RCRA_TSD |
| AM AUTOMOTIVE | 1124 OLD BAYSHORE HIGHWAY STE #30, SAN JOSE, CA 95112 | CAL000281464 | Active | FED_RCRA_TSD |
| SUPERMODELLI LLC | 1050 N 5TH ST STE B, SAN JOSE, CA 95112-4400 | CAL000357121 | Active | FED_RCRA_TSD |
| BRUCE'S TIRE | 1315 N 10TH ST, SAN JOSE, CA 95112-0000 | CAL000098157 | Active | FED_RCRA_TSD |
| VICKER'S CONCRETE SAWING INC | 392 E GISH RD, SAN JOSE, CA 95112-0000 | CAL000232359 | Active | FED_RCRA_TSD |
| D & B TRENCHING | 935 N 8TH ST, SAN JOSE, CA 95112 | CAL000284860 | Active | FED_RCRA_TSD |
| E&D TRANSMISSION & MOTOR INC | 1205 N 5TH ST STE B, SAN JOSE, CA 95112-4443 | CAL000374401 | Active | FED_RCRA_TSD |
| IRBY CORP DBA CENTRAL EQUIPMENT SERVICE CO | 1135 N 7TH ST UNIT A, SAN JOSE, CA 95112-4428 | CAL000387852 | Active | FED_RCRA_TSD |
| C & O PAINTING INC | 1500 N 4TH ST, SAN JOSE, CA 95112 | CAL000300972 | Active | FED_RCRA_TSD |
| SAN JOSE CONCRETE PIPE CO | 1420 OLD BAYSHORE HWY, SAN JOSE, CA 95112-2813 | CAL000065957 | Active | FED_RCRA_TSD |
| NORTHWEST LANDSCAPE | 283 KINNEY DR, SAN JOSE, CA 95112-0000 | CAL000066104 | Active | FED_RCRA_TSD |
| TAVOLACCI MFG | 1590 KERLEY DR, SAN JOSE, CA 95112-0000 | CAL000014115 | Active | FED_RCRA_TSD |
| SAN JOSE CONCRETE TRANSFER CO | 1420 OLD BAYSHORE HIGHWAY, SAN JOSE, CA 95112-0000 | CAL000082230 | Active | FED_RCRA_TSD |
| AIR COOLED ENGINES INC | 1076 N 10TH ST, SAN JOSE, CA 95112-0000 | CAD982010795 | Active | FED_RCRA_TSD |
| D & D COMPRESSOR INC | 258 KINNEY DR, SAN JOSE, CA 95112-0000 | CAL000176847 | Active | FED_RCRA_TSD |
| PROSPERITY AUTOMOTIVE, INC. | 1036 N 11TH ST, SAN JOSE, CA 95112 | CAL000382270 | Active | FED_RCRA_TSD |
| MONSTER MECHANICAL INC | 1521 TERMINAL AVE, SAN JOSE, CA 95112-4316 | CAL000349873 | Active | FED_RCRA_TSD |
| MAIL HAUL INC | 1048 N 10TH ST, SAN JOSE, CA 95112-2922 | CAL000316086 | Active | FED_RCRA_TSD |
| HARMONIC DIESEL | 1336 OLD BAYSHORE HWY STE B, SAN JOSE, CA 95112-2811 | CAL000404176 | Active | FED_RCRA_TSD |

**Environmental Screening Report
For SANTA CLARA County**

Property Address: 1180 N 5TH ST
SAN JOSE, SANTA CLARA COUNTY, CA 95112
("Property")

APN: 235-12-009
Report Date: 09/22/2025
Report Number: 3506289

| Site Name | Address | Case No. | Status | Database |
|---|--|--------------|--------|-----------------------|
| SOUTH BAY AUTOWORKS | 505 SANTA ANA AVE STE 2, SAN JOSE, CA 95112-2945 | CAL000357131 | Active | FED_RCRA_TSD |
| SWEEPIT & MAINTENANCE INC | 336 E GISH RD, SAN JOSE, CA 95112 | CAL000405523 | Active | FED_RCRA_TSD |
| ADVANCED CYCLE SERVICE | 1135 OLD BAYSHORE HWY, SAN JOSE, CA 95112-2808 | CAL000356016 | Active | FED_RCRA_TSD |
| C & J CONTRACTING INC | 331 COMMERCIAL ST, SAN JOSE, CA 95112-4404 | CAL000328991 | Active | FED_RCRA_TSD |
| MORRIS & SONS TOWING | 390 E GISH RD, SAN JOSE, CA 95112 | CAL000396021 | Active | FED_RCRA_TSD |
| AM DRYWALL INC | 295 KINNEY DR, SAN JOSE, CA 95112-4433 | CAL000287548 | Active | FED_RCRA_TSD |
| J & J AIR CONDITIONING I | 1086 N 11TH ST, SAN JOSE, CA 95112 | CAL000311961 | Active | FED_RCRA_TSD |
| TOPSIDE MARINE LLC | 1071 N 10TH ST, SAN JOSE, CA 95112-2923 | CAL000349788 | Active | FED_RCRA_TSD |
| PACIFIC CREST LANDSCAPE & MAINTENANCE INC | 1450 N 4TH ST, SAN JOSE, CA 95112-4715 | CAL000356286 | Active | FED_RCRA_TSD |
| CALIBER COLLISION CENTER | 1138 N 5TH ST, SAN JOSE, CA 95112 | CAL000419857 | Active | FED_RCRA_TSD |
| PETER AUTO BODY & PAINT | 1310 N 10TH ST, SAN JOSE, CA 95112 | CAL000330539 | Active | FED_RCRA_TSD |
| PROPEL FUELS (202025) | 1002 N 1ST ST, SAN JOSE, CA 95112-4922 | CAL000363938 | Active | FED_RCRA_TSD |
| CUPERTINO ELECTRIC INC | 385 COMMERCIAL ST # 395, SAN JOSE, CA 95112-4404 | CAL000392625 | Active | FED_RCRA_TSD |
| DIAMOND SALES & SERVICE INC DBA DIAMOND MITSUBISHI FUSO | 1505 N 4TH ST, SAN JOSE, CA 95112 | CAL000370877 | Active | FED_RCRA_TSD |
| SERVICE KING COLLISION REPAIR-SERVICE KING PAINT AND BODY LLC | 1460 TERMINAL AVE, SAN JOSE, CA 95112 | CAL000401002 | Active | FED_RCRA_TSD |
| BARRITA CORP. | 1020 N. 4TH ST., SAN JOSE, CA 95112 | CAC002990595 | Active | FED_RCRA_TSD |
| P & D TRANSMISSION & REPAIR | 1548 OLD BAYSHORE HWY, SAN JOSE, CA 95112 | CAL000265233 | Active | FED_RCRA_TSD |
| CONDEX INC/AMERICAN DRILLING | 1300 OLD BAYSHORE HWY, SAN JOSE, CA 95112-2811 | CAL000301627 | Active | FED_RCRA_TSD |
| O'REILLY AUTO PARTS STORE 2555 | 1160 N 4TH ST, SAN JOSE, CA 95112-4946 | CAL000392794 | Active | FED_RCRA_TSD |
| TRISTAR MACHINING | 1450 KOLL CIR STE 111, SAN JOSE, CA 95112 | CAL000291360 | Active | FED_RCRA_TSD |
| ELITE AUTO SERVICE LLC | 505 SANTA ANA AVE, SAN JOSE, CA 95112-2945 | CAL000387497 | Active | FED_RCRA_TSD |
| FLAGSHIP FACILITY SERVICES INC | 1050 N 5TH ST, SAN JOSE, CA 95112 | CAL000436049 | Active | FED_RCRA_TSD |
| FMA LANDSCAPE SERVICES INC | 1556 OLD BAYSHORE HWY, SAN JOSE, CA 95112 | CAL000430875 | Active | FED_RCRA_TSD |
| SERVICE KING PAINT & BODY LLC | 1441 B TERMINAL AVE, SAN JOSE, CA 95112 | CAL000422716 | Active | FED_RCRA_TSD |
| STATEWIDE TRAFFIC SAFETY AND SIGNS INC | 1101 N 5TH ST, SAN JOSE, CA 95112 | CAL000428101 | Active | FED_RCRA_TSD |
| MCBAY INTERNATIONAL GROUP INC DBA MCBAY AUTO | 976 N 4TH ST, SAN JOSE, CA 95112 | CAL000437013 | Active | FED_RCRA_TSD |
| GARRETT TECHNOLOGIES INC | 1125 N SEVENTH ST, SAN JOSE, CA 95110 | CAL000434071 | Active | FED_RCRA_TSD |
| COAST ENGRAVING INC | 1097 NORTH FIFTH STREET, SAN JOSE, CA 95112-0000 | CAL921694362 | Active | FED_RCRA_TSD |
| GOLDEN COAST COLLISION | 1190 N 13TH ST STE 10, SAN JOSE, CA 95112 | CAL000443441 | Active | FED_RCRA_TSD |
| D&D COMPRESSOR INC | 347 COMMERCIAL ST, SAN JOSE, CA 95112 | CAC002998169 | Active | FED_RCRA_TSD |
| FLATLINE FLOORS | 999 N 10TH STREET #5, SAN JOSE, CA 95112 | CAL000440025 | Active | FED_RCRA_TSD |
| MICHAEL JS BODYSHOP | 1420 N 4TH ST, SAN JOSE, CA 95112 | CAL000387784 | Active | FED_RCRA_TSD |
| FLATLINE FLOORS | 999 N 10TH STREET #5, SAN JOSE, CA 95112 | CAC002983035 | Active | FED_RCRA_TSD |
| CALIBER COLLISION CENTERS | 1539 TERMINAL AVE, SAN JOSE, CA 95112 | CAL000399554 | Active | FED_RCRA_TSD |
| PERSONALIZED AUTO SERVICES INC DBA PERSONALIZED AUTO CARE | 1394 NORTH 4TH ST UNIT 1, SAN JOSE, CA 95112 | CAL000440796 | Active | FED_RCRA_TSD |
| CARDINAL HEALTH 414 LLC | 254 E GISH RD, SAN JOSE, CA 95112 | CAL000440316 | Active | FED_RCRA_TSD |
| OLD BAYSHORE SOUTH LLC | 1336 OLD BAY SHORE HWY, SAN JOSE, CA 95112 | CAC003015386 | Active | FED_RCRA_TSD |
| OLM RECYCLING SERVICES LLC | 1320 N 4TH ST, SAN JOSE, CA 95112 | CAL000423947 | Active | FED_RCRA_TSD |
| Premium Plating and Polishing | 1026 N. 10th Street, San Jose, CA 95112 | 60001646 | Open | CA_ENVIROSTOR_CLEANUP |
| Ultra-Chem/ALL-CHEM/Scott Enterprises | 1310 OLD BAYSHORE HWY, SAN JOSE, CA 95112 | 43280067 | Open | CA_ENVIROSTOR_CLEANUP |
| SAFETY-KLEEN | 1147 NORTH 10TH, SAN JOSE, CA 95112 | 43070008 | Open | CA_ENVIROSTOR_CLEANUP |
| Cascade Computer Coating | 1615 Terminal Avenue, San Jose, CA 95112 | 70000102 | Closed | CA_ENVIROSTOR_CLEANUP |
| San Jose Plating Works, Inc. | 1501 Terminal Avenue, San Jose, CA 95112 | 70000103 | Closed | CA_ENVIROSTOR_CLEANUP |
| CRISTINA WAREHOUSE CO INC | 1045 N 10TH ST, SAN JOSE, CA 951120000 | 80001529 | Closed | CA_ENVIROSTOR_CLEANUP |
| GARDEN VALLEY FERTILIZER COMPANY | 565 CHARLES STREET, SAN JOSE, CA 95112 | 43070026 | Open | CA_ENVIROSTOR_CLEANUP |
| Babbit Bearing Co. Inc. | 1170 North 5th Street, San Jose, CA 95112 | 70000101 | Closed | CA_ENVIROSTOR_CLEANUP |
| San Jose Plating Works II | 1575-1585 Terminal Avenue, San Jose, CA 95112 | 60000287 | Closed | CA_ENVIROSTOR_CLEANUP |

**Environmental Screening Report
For SANTA CLARA County**

Property Address: 1180 N 5TH ST
SAN JOSE, SANTA CLARA COUNTY, CA 95112
("Property")

APN: 235-12-009
Report Date: 09/22/2025
Report Number: 3506289

| Site Name | Address | Case No. | Status | Database |
|---------------------------------------|--|--------------|--------|-----------------------|
| Advance Circuit Services | 1181 N. 4th Street #B, San Jose, CA 95112 | 71003484 | Open | CA_ENVIROSTOR_CLEANUP |
| PROTO MOLD | 1390 OLD BAYSHORE HIGHWAY, SAN JOSE, CA 95112 | 43320041 | Closed | CA_DTSC_RESPONSE |
| ULTRA-CHEM/ALL-CHEM/SCOTT ENTERPRISES | 1310 OLD BAYSHORE BLVD, SAN JOSE, CA 951120000 | 80001847 | Open | CA_ENVIROSTOR_CLEANUP |
| Moyer chemical | 1300,1310, 1336 Old Bayshore Hwy, San Jose, CA 95112 | 60001663 | Open | CA_DTSC_RESPONSE |
| SAFETY-KLEEN SAN JOSE | 1147 NO TENTH ST, SAN JOSE, CA 951120000 | 80001749 | Open | CA_ENVIROSTOR_CLEANUP |
| Damart Inc. | 948 N 8th St, San Jose, CA 95112 | T0608500490 | Closed | CA_LUST |
| Oree Electrical Company | 1195 N 5th St, San Jose, CA 95112 | T0608501002 | Closed | CA_LUST |
| Roadway Express | 1436 Terminal Ave, San Jose, CA 95112 | T0608501951 | Closed | CA_LUST |
| San Jose Plating | 1575 Terminal Ave, San Jose, CA 95112 | T0608501183 | Closed | CA_LUST |
| ACOSTA SHEET METAL | 1067 N. 10TH STREET, SAN JOSE, CA 95112 | T0608500100 | Closed | CA_LUST |
| Cascade Computer Coating Inc. | 1615 Terminal Ave, San Jose, CA 95112 | T0608500314 | Closed | CA_LUST |
| D & D MANAGEMENT CONSULTANTS | 1033 11TH ST N, SAN JOSE, CA 95112 | T0608500487 | Closed | CA_LUST |
| Artificial Stone Works | 911 N 9th St, San Jose, CA 95112 | T0608501875 | Closed | CA_LUST |
| ACTION FORKLIFT | 1441 TERMINAL AVE., SAN JOSE, CA 95112 | T0608500101 | Open | CA_LUST |
| Penske Truck Leasing Co. Inc. | 1695 N 4th St, San Jose, CA 95112 | T0608501044 | Closed | CA_LUST |
| Mayflower Moving & Storage | 1605 Old Bayshore Hwy, San Jose, CA 95112 | T0608500881 | Closed | CA_LUST |
| SCC Office of Education | 1245 N 5th St, San Jose, CA 95110 | T0608501871 | Closed | CA_LUST |
| UNITED CENTRIFUGAL PUMPS | 1132 7TH ST N, SAN JOSE, CA 95112 | T0608501478 | Closed | CA_LUST |
| Muller Construction | 1277 Old Bayshore Hwy, San Jose, CA 95112 | T0608500967 | Closed | CA_LUST |
| Chevron #9-6668 | 1736 Old Bayshore Hwy, San Jose, CA 95112 | T0608500205 | Closed | CA_LUST |
| B. L. Cohen Landscape | 250 Commercial St, San Jose, CA 95112 | T0608500246 | Closed | CA_LUST |
| Tucci Property | 1090 N 10th St, San Jose, CA 95112 | T0608501459 | Closed | CA_LUST |
| WESTERN EXTERMINATOR | 1611 TERMINAL AVENUE, SAN JOSE, CA 95112 | T0608501584 | Closed | CA_LUST |
| CLARK PEST CONTROL | 1500 N. 4TH STREET, SAN JOSE, CA 95112 | T0608537770 | Closed | CA_LUST |
| Bob Lewis Volkswagon | 1560 N 1st St, San Jose, CA 95112 | T0608500249 | Closed | CA_LUST |
| DAHL'S EQUIPMENT | 1091 N. 10TH STREET, SAN JOSE, CA 95112 | T0608562782 | Open | CA_LUST |
| Pacific Car Rental | 1510 N 1st St, San Jose, CA 95112 | T0608594008 | Closed | CA_LUST |
| FORMER GARDEN STATE TRUCKING | 1505 N. FOURTH STREET, SAN JOSE, CA 95112 | T10000003504 | Closed | CA_SLIC |
| JN ABBOT DISTRIBUTORS | 1090 NORTH 10TH STREET, SAN JOSE, CA | T0608514975 | Closed | CA_LUST |
| SAN JOSE FIRE STATION #5 | 1380 N. 10TH STREET, SAN JOSE, CA 95112 | T0608500618 | Closed | CA_LUST |
| BAYSHORE AUTO TECH | 1394 N. FOURTH STREET, SAN JOSE, CA 95112 | T10000006141 | Closed | CA_LUST |
| BW/IP INTERNATIONAL | 1132 NORTH SEVENTH ST, SAN JOSE, CA 95112 | SL18222620 | Open | CA_SLIC |
| Marriot Airline Food Service | 385 Commercial St, San Jose, CA 95112 | T0608500532 | Closed | CA_LUST |
| Haines & Sons Painting | 980 N 11th St, San Jose, CA 95112 | T0608537549 | Closed | CA_LUST |
| San Jose Concrete | 1420 Old Bayshore Rd, San Jose, CA 95112 | T0608502413 | Closed | CA_LUST |
| CONSOLIDATED FREIGHTWAYS | 390 COMMERCIAL Street, SAN JOSE, CA 95112 | T0608544580 | Closed | CA_LUST |
| Koll Company | 1420 Koll Cir, San Jose, CA 95112 | T0608500811 | Closed | CA_LUST |
| All Brand Forklift | 1481 Terminal Ave, San Jose, CA 95112 | T0608500117 | Closed | CA_LUST |
| A.T. / MARINE/CAR PARTS | 1133 N. 10TH STREET, SAN JOSE, CA 95112 | T0608501349 | Closed | CA_LUST |
| Murata Enterprises | 1309 N 1st St, San Jose, CA 95112 | T0608500968 | Closed | CA_LUST |
| BEEM Enterprises | 1365 N 10th St, San Jose, CA 95112 | T0608501851 | Closed | CA_LUST |
| Rollie French Inc. | 1191 N 5th St, San Jose, CA 95112 | T0608501118 | Closed | CA_LUST |
| Goodwill Industries | 1080 N 7th St, San Jose, CA 95112 | T0608500688 | Closed | CA_LUST |
| SANTA CLARA CO.CIVIC CTRGARAGE | 90 W. YOUNGER STREET, SAN JOSE, CA 95110 | T0608501207 | Closed | CA_LUST |
| BP OIL #11235 | 1271 N. FIRST STREET, SAN JOSE, CA 95112 | T0608500919 | Closed | CA_LUST |
| HURWITZ/BORKIN | 1280 NORTH 10TH STREET, SAN JOSE, CA 95112 | SL0608581580 | Closed | CA_SLIC |
| Consolidated Freightways | 390 Commercial Street, San Jose, CA 95112 | T10000001895 | Open | CA_SLIC |
| Continental Can | 880 N 8th St, San Jose, CA 95112 | T0608500462 | Closed | CA_LUST |
| Christina Warehouse | 1045 N 10th St, San Jose, CA 95112 | T0608500471 | Closed | CA_LUST |
| S & W COMPANY | 1607 TERMINAL AVENUE, SAN JOSE, CA 95112 | T0608500354 | Closed | CA_LUST |
| Investment Financial | 1090 N 7th St, San Jose, CA 95113 | T0608501477 | Closed | CA_LUST |
| ARMORED TRANSPORT | 1305 4TH ST., SAN JOSE, CA 95110 | T0608500191 | Closed | CA_LUST |
| Howard Electric | 1336 Old Bayshore Hwy, San Jose, CA 95112 | T0608500736 | Closed | CA_LUST |

**Environmental Screening Report
For SANTA CLARA County**

Property Address: 1180 N 5TH ST
SAN JOSE, SANTA CLARA COUNTY, CA 95112
("Property")

APN: 235-12-009
Report Date: 09/22/2025
Report Number: 3506289

| Site Name | Address | Case No. | Status | Database |
|--------------------------------|---|--------------|--------|----------|
| 7-Up | 297 Commercial St, San Jose, CA 95112 | T0608500078 | Closed | CA_LUST |
| Superior Clutch and Brake | 1407 N 10th St, San Jose, CA 95112 | T0608533029 | Closed | CA_LUST |
| Coca Cola | 1555 Old Bayshore, San Jose, CA 95112 | T0608533135 | Closed | CA_LUST |
| Nakatsu Bros. Auto Shop | 952 N 10th St, San Jose, CA 95112 | T0608500970 | Closed | CA_LUST |
| CERTIFIED GARMENT LINEN SUPPLY | 519 HORNING, SAN JOSE, CA 95112 | T0608591624 | Closed | CA_SLIC |
| Accurate Metal | 1460 Terminal Ave, San Jose, CA 95112 | T0608500094 | Closed | CA_LUST |
| UNOCAL STATION #5954 | 1002 N. FIRST STREET, SAN JOSE, CA 95112 | T0608501670 | Closed | CA_LUST |
| Chevron #9-2462 | 1100 N 1st St, San Jose, CA 95112 | T0608500330 | Closed | CA_LUST |
| COMMERCIAL FUELING CORPORATION | 1170 N. 4TH Street, SAN JOSE, CA 95112 | T0608500446 | Open | CA_LUST |
| Coca Cola | 1555 Old Bayshore Hwy, San Jose, CA 95112 | T0608500440 | Closed | CA_LUST |
| TCI | 1610 N 4th St, San Jose, CA 95112 | T0608502396 | Closed | CA_LUST |
| RW James Company | 1432 Old Bayshore Hwy, San Jose, CA 95112 | T0608501147 | Closed | CA_LUST |
| Alamo | 1280 N 4th St, San Jose, CA 95112 | T0608500111 | Closed | CA_LUST |
| L'Hommedieu Property | 1223-1225 N 5th Street, San Jose, CA 95112 | T10000008043 | Open | CA_SLIC |
| Mohawk Packing | 1660 Old Bayshore, San Jose, CA 95106 | T0608500783 | Closed | CA_LUST |
| Garden State Internat'l Trucks | 1505 N 4th St, San Jose, CA 95112 | T0608500665 | Closed | CA_LUST |
| Super-7 | 1410 N 1st St, San Jose, CA 95112 | T0608501341 | Closed | CA_LUST |
| SHELL - 1120 N FIRST | 1120 NORTH FIRST STREET, SAN JOSE, CA 95112 | T0608501247 | Closed | CA_LUST |

Sites Missing Key Location Information

Open = Site listed as undergoing clean-up, investigation, or referral to another agency; or as non-active, abandoned or absorbed but not closed or completed.

Closed = Site listed as clean-up completed, release secured, no further remedial action planned, case closed, or delisted.

Active (or Inactive) = Site facility listed as actively (or not actively) engaged in a type of activity regulated under RCRA.

Deed = Site listed as completed or closed with a deed restriction.

N/A = Not Applicable - site listed as uncontaminated, or as using or storing hazardous substances.

N/P = Not Provided - site status not supplied on agency list used.

Many environmental sites in the databases searched have incomplete address information and cannot be precisely located. They are, therefore, considered "unlocatable" with the geocoding methods used in this Report, and could potentially be anywhere in the Property city, county, or state. The table below includes unlocatable sites whose address contains a zip code that matches the Property zip code or matches a neighboring zip code whose boundary is within the radius distance searched. The sites listed are not necessarily within one mile of the Property, and they are not included on the site map in this Report. The databases searched include a large number of unlocatable addresses, and the list below is limited to a maximum of 30 sites per database searched. If you wish to view a **full list** of ALL unlocatable sites in California, please download the full list from our website at the following address:

https://orderform.disclosures.com/Content/Files/Enviro/Current_List_of_Unlocatable_Sites_in_California.xlsx

| Site Name | Address | Case No. | Status | Database |
|------------------------------|---|----------|--------|-------------|
| ARCO AM/PM MINI MARKET #5370 | 1860 EAST CAMPBELL AVENUE, CAMPBELL, CA 95008 | N/P | N/P | CA_HIST_UST |
| CAMPBELL FIRE STATION | 123 SOUTH UNION AVENUE, CAMPBELL, CA 95008 | N/P | N/P | CA_HIST_UST |
| CHEVRON #98122 | 3405 SOUTH WINCHESTER BOULEVARD, CAMPBELL, CA 95008 | N/P | N/P | CA_HIST_UST |
| CHUNG'S ARCO #6147 | 2015 SOUTH WINCHESTER BOULEVARD, CAMPBELL, CA 95008 | N/P | N/P | CA_HIST_UST |
| CITY OF CAMPBELL | 290 SOUTH DILLON AVENUE, CAMPBELL, CA 95008 | N/P | N/P | CA_HIST_UST |
| ROTTEN ROBBIE #27 | 2140 SOUTH WINCHESTER BOULEVARD, CAMPBELL, CA 95008 | N/P | N/P | CA_HIST_UST |
| RV CLOUD COMPANY | 3000 SOUTH WINCHESTER BOULEVARD, CAMPBELL, CA 95008 | N/P | N/P | CA_HIST_UST |
| SUNNYOAK SHELL | 2855 SOUTH WINCHESTER BOULEVARD, CAMPBELL, CA 95008 | N/P | N/P | CA_HIST_UST |
| TOSCO FACILITY #5088 | 3035 SOUTH WINCHESTER BOULEVARD, CAMPBELL, CA 95008 | N/P | N/P | CA_HIST_UST |
| BP SERVICE STATION #11234 | 21855 HOMESTEAD ROAD, CUPERTINO, CA 95014 | N/P | N/P | CA_HIST_UST |
| WEST VALLEY FIRE STATION | 19800 COX AVENUE, CUPERTINO, CA 95014 | N/P | N/P | CA_HIST_UST |

**Environmental Screening Report
For SANTA CLARA County**

Property Address: 1180 N 5TH ST
SAN JOSE, SANTA CLARA COUNTY, CA 95112
("Property")

APN: 235-12-009
Report Date: 09/22/2025
Report Number: 3506289

| Site Name | Address | Case No. | Status | Database |
|---|--|--------------|--------|-------------|
| QUITO FIRE STATION | 18870 SARATOGA-LOS GATOS ROAD, LOS GATOS, CA 95030 | N/P | N/P | CA_HIST_UST |
| AIRDROME ORCHARDS, INC | 610 GISH ROAD, SAN JOSE, CA 95112 | N/P | N/P | CA_HIST_UST |
| BEACON FOOD & GAS | 795 13TH STREET, SAN JOSE, CA 95112 | N/P | N/P | CA_HIST_UST |
| CIVIC CENTER BP #11235 | 1271 1ST STREET, SAN JOSE, CA 95112 | N/P | N/P | CA_HIST_UST |
| CIVIC CENTER SHELL STATION | 1120 1ST STREET, SAN JOSE, CA 95112 | N/P | N/P | CA_HIST_UST |
| CIVIC CENTER UNOCAL PLAZA | 1002 1ST STREET, SAN JOSE, CA 95112 | N/P | N/P | CA_HIST_UST |
| COCA COLA BOTTLING COMPANY | 2930 BAYSHORE HIGHWAY, SAN JOSE, CA 95112 | N/P | N/P | CA_HIST_UST |
| COLUMBIA SAN JOSE HEALTH | 675 SANTA CLARA STREET, SAN JOSE, CA 95112 | N/P | N/P | CA_HIST_UST |
| GARDEN STATE INTL TRUCKS | 1505 4TH STREET, SAN JOSE, CA 95112 | N/P | N/P | CA_HIST_UST |
| GAS STOP & MINIMART | 899 13TH ST., SAN JOSE, CA 95112 | N/P | N/P | CA_HIST_UST |
| GREAT AMERICA TOWING | 560 GISH, SAN JOSE, CA 95112 | N/P | N/P | CA_HIST_UST |
| J.N. ABBOTT DISTRIBUTOR, INC. | 1090 10TH STREET, SAN JOSE, CA 95112 | N/P | N/P | CA_HIST_UST |
| MAIN SERVICE YARD | 696 6TH STREET, SAN JOSE, CA 95112 | N/P | N/P | CA_HIST_UST |
| PACIFIC BELL | 190 5TH STREET, SAN JOSE, CA 95112 | N/P | N/P | CA_HIST_UST |
| PETE'S STOP GAS AUTO SERV | 447 WILLIAM STREET, SAN JOSE, CA 95112 | N/P | N/P | CA_HIST_UST |
| RENT A CAR | 697 4TH ST, SAN JOSE, CA 95112 | N/P | N/P | CA_HIST_UST |
| ROLLINS LEASING CORPORATION | 1691 BAYSHORE HIGHWAY, SAN JOSE, CA 95112 | N/P | N/P | CA_HIST_UST |
| WESTERN STATES OIL CO | 1790 10TH STREET, SAN JOSE, CA 95112 | N/P | N/P | CA_HIST_UST |
| SAN JOSE STATE UNIVERSITY CENTRAL PLANT | 1 WASHINGTON SQUARE, SAN JOSE, CA 95112 | N/P | N/P | CA_HIST_UST |
| MILPITAS GAS TERMINAL | 66 RANCH RD., MILPITAS, CA 95035 | N/P | N/p | CA_AST |
| CALPINE GILROY COGENERATION | 1400 PACHECO HWY., GILROY, CA 95020 | N/P | N/p | CA_AST |
| WAL-MART DIVISION 1 STORE #2002 | 7150 CAMINO ARROYO, GILROY, CA 95020 | N/P | N/p | CA_AST |
| Z-BEST COMPOSTING FACILITY | 980 STATE HWY 25, GILROY, CA 95020 | N/P | N/p | CA_AST |
| SANDRIDGE FARMS | UTICA AVE @ HWY 5, KINGS COUNTY, CA | N/P | N/p | CA_AST |
| RINCONADA WATER TREATMENT PLT. | 400 MORE AVE., LOS GATOS, CA 95030 | N/P | N/p | CA_AST |
| KICU-TV TRANSMITTER SITE | 9530 WELLER RD., MILPITAS, CA 95035 | N/P | N/p | CA_AST |
| NAVY EXCHANGE GAS STATION | WESCOAT RD., MOFFETT FEDERAL AIRFIELD, CA 94035-1000 | N/P | N/p | CA_AST |
| NASA AMES RESEARCH CENTER | , MOFFETT FIELD, CA 94035 | N/P | N/p | CA_AST |
| MONTEREY MUSHROOMS | 642 HALE AVE., MORGAN HILL, CA 95038 | N/P | N/p | CA_AST |
| JIFFY LUBE #1196 | 500 W. EL CAMINO REAL, MOUNTAIN VIEW, CA 94040 | N/P | N/p | CA_AST |
| HITACHI GLOBAL STORAGE TECHNOLOGIES, INC. | 5600 COTTLE RD., SAN JOSE, CA 95193 | N/P | N/p | CA_AST |
| TUSCANNY HILLS | 2020 NEWMAN, SAN JOSE, CA | N/P | N/p | CA_AST |
| SAN JOSE | 55 MARKET STREET, SAN JOSE, CA 95113 | N/P | N/p | CA_AST |
| SPRINT | 801 NEWHALL ST., SAN JOSE, CA | N/P | N/p | CA_AST |
| CHEMICAL SYSTEMS DIVISION 600 | METCALF RD., SAN JOSE, CA 95161 | N/P | N/p | CA_AST |
| KIRBY CANYON RECYCLING & DISP. | 910 COYOTE CREEK GOLF DR, SAN JOSE, CA 95038 | N/P | N/p | CA_AST |
| SAN MARTIN TRANSFER STATION | 14070 LIAGAS AVE., SAN MARTIN, CA 95046 | N/P | N/p | CA_AST |
| WALSH CAMPUS | 288 N. WESTERN PARKWAY, SANTA CLARA, CA 95052 | N/P | N/p | CA_AST |
| SANTA CLARA POINT OF PRESENCE | 3045 RAYMOND CT, SANTA CLARA, CA 95054 | N/P | N/p | CA_AST |
| FACILITIES BUILDING | 500 EL CAMINO REAL BLDG 604, SANTA CLARA, CA 95053 | N/P | N/p | CA_AST |
| SAVVIS COMMUNICATIONS, SC-6/7 DATA CENTER | 2045/2055 LAFAYETTE STREET, SANTA CLARA, CA 95050 | N/P | N/p | CA_AST |
| ONIZUKA AIR STATION | 1080 LOCKHEED MARTIN WAY, SUNNYVALE, CA 94089-1231 | N/P | N/p | CA_AST |
| JIFFY LUBE #295 | 999 WEST EL CAMINO REAL, SUNNYVALE, CA 94087 | N/P | N/p | CA_AST |
| NAVY BRAC PMO-W (MOFFETT) | NAS, MOFFETT FIELD, CA 94035 | CA0170023238 | N/P | CA_HWIS |
| UNITED STATES POSTAL SERVICE | 1750 LUNDY AVE, SAN JOSE, CA 95101 | CA1180090424 | N/P | CA_HWIS |
| NASA-AMES RESEARCH CENTER | ENVIRONMENTAL HEALTH & SAFETY, MOFFETT FIELD, CA 94035 | CA1800005034 | N/P | CA_HWIS |
| B P MANAGEMENT | 739 E. EL CAMINO REAL, SUNNYVALE, CA 94087 | CAC002880612 | N/P | CA_HWIS |
| BROOKSIDE OAKS APARTMENTS | 1651 BELLAVILLE WAY, SUNNYVALE, CA 94087 | CAC002885645 | N/P | CA_HWIS |

**Environmental Screening Report
For SANTA CLARA County**

Property Address: 1180 N 5TH ST
SAN JOSE, SANTA CLARA COUNTY, CA 95112
("Property")

APN: 235-12-009
Report Date: 09/22/2025
Report Number: 3506289

| Site Name | Address | Case No. | Status | Database |
|---|--|--------------|--------|----------|
| SUMMERHILL- LAWRENCE STATION LLC | 3475, 3479, 3489, 343505 KIFER ROAD, SANTA CLARA, CA 95051 | CAC002887629 | N/P | CA_HWIS |
| POLYCOM | 6001 AMERICA CENTER DR, SAN JOSE, CA 95002 | CAC002889854 | N/P | CA_HWIS |
| KJ-PARK,LLC | 2555 PARK BLVD., PALO ALTO, CA 94306 | CAC002890007 | N/P | CA_HWIS |
| UNION PACIFIC RAILROAD (UPRR) | LAT/LONG_USED, SAN JOSE, CA 95112 | CAC002897937 | N/P | CA_HWIS |
| CALIFORNIA WATER SERVICE COMPANY | LAT/LONG_USED, SALINAS, CA 95112 | CAC002898577 | N/P | CA_HWIS |
| PENSKE | 1271 N 1ST ST., SAN JOSE, CA 95112 | CAC002904909 | N/P | CA_HWIS |
| SUN GARDEN CENTER LLC | 1566 MONTEREY ROAD, SAN JOSE, CA 95112 | CAC002905809 | N/P | CA_HWIS |
| MENLO LAND & CAPITAL VIII, LLC | 2331 SOUTH 7TH ST., SAN JOSE, CA 95112 | CAC002912670 | N/P | CA_HWIS |
| SANTA CLARA COUNTY-FAF | 151 MISSION AVE, SAN JOSE, CA 95112 | CAC002922541 | N/P | CA_HWIS |
| A & E ANODIZING INC | 652 A CHARLES ST, SAN JOSE, CA 95112 | CAD982498651 | N/P | CA_HWIS |
| REYES COCA-COLA BOTTLING LLC | 1555 BAYSHORE HIGHWAY, SAN JOSE, CA 95112 | CAD982514879 | N/P | CA_HWIS |
| CIVIC CENTER 76 | 1271 NORTH 1ST STREET, SAN JOSE, CA 95112 | CAL000105409 | N/P | CA_HWIS |
| FREEMAN FINISHING INC | 1775 SOUTH FIRST ST, SAN JOSE, CA 95112 | CAL000123529 | N/P | CA_HWIS |
| AUTOZONE #3354 | 1204 N CAPITAL EXPRESS, SAN JOSE, CA 95112 | CAL000269001 | N/P | CA_HWIS |
| US HEALTHWORKS/SAN JOSE | 1893 MONTEREY HWY STE 200, SAN JOSE, CA 95112 | CAL000374157 | N/P | CA_HWIS |
| POWER DESIGN MANUFACTURING | 121 E BROKAW RD, SAN JOSE, CA 95112 | CAL000378112 | N/P | CA_HWIS |
| SMART & FINAL #436 | 2152 MONTEREY RD, SAN DIEGO, CA 95112 | CAL000378268 | N/P | CA_HWIS |
| SUNSTATE EQUIPMENT CO LLC | 2233 S 7TH ST, SAN JOSE, CA 95112 | CAL000381612 | N/P | CA_HWIS |
| CLIMAX LABORATORIES INC | 1939 MONTEREY HWY STE 10, SAN JOSE, CA 95112 | CAL000387180 | N/P | CA_HWIS |
| JESSE TRANSMISSION | 1775 MONTEREY HWY STE 60B, SAN JOSE, CA 95112 | CAL000397181 | N/P | CA_HWIS |
| MANUFAB | 1775 MONTEREY RD #66-B, SAN JOSE, CA 95112 | CAL000423082 | N/P | CA_HWIS |
| NAVARRA AUTO & TRUCK DISMANTLERS | 1837 MONTEREY RD, SAN JOSE, CA 95112 | CAL000425379 | N/P | CA_HWIS |
| UNION PACIFIC RAILROAD | 37.357996 -121.894346, SAN JOSE, CA 95112 | CAP000272088 | N/P | CA_HWIS |
| CALIFORNIA WATER SERVICE CO CH STA 1 T2 | E 3RD ST AT SW CORNER OF E 1ST, CHICO, CA 95112 | CAR000182600 | N/P | CA_HWIS |
| SENJU COMTEK CORP | 1171 B NORTH 4TH ST, SAN JOSE, CA 95112 | CAR000276238 | N/P | CA_HWIS |
| | 1515 NORMAN AVE, SANTA CLARA, CA 0 | 1247583 | Open | FED_ERNS |
| | 3287 MIRAGE WAY, SAN JOSE, CA 95135 | 1264627 | Open | FED_ERNS |
| | 14198 LEIGH AVE, SAN JOSE, CA 0 | 1237652 | N/P | FED_ERNS |
| | MP: 46.59, SAN JOSE, CA 0 | 1238452 | N/P | FED_ERNS |
| MAIN LINE | MP: 46.59, SAN JOSE, CA 0 | 1238535 | N/P | FED_ERNS |
| MAIN LINE | MP: 46.3, SAN JOSE, CA 0 | 1238709 | N/P | FED_ERNS |
| | MILE POST: 73, MORGAN HILL, CA 0 | 1238924 | N/P | FED_ERNS |
| | HACIENDA AVE, SAN JOSE, CA 0 | 1239285 | N/P | FED_ERNS |
| MAIN LINE | MP 56.1, SAN JOSE, CA 0 | 1243452 | N/P | FED_ERNS |
| | MILEPOST 46.6, SAN JOSE, CA 0 | 1245528 | N/P | FED_ERNS |
| | MP: 54, SAN JOSE, CA 0 | 1245735 | N/P | FED_ERNS |
| UP MAIN LINE | MP: 54, SOUTH SAN JOSE, CA 0 | 1245747 | N/P | FED_ERNS |
| | 840 LENFEST ROAD, SAN JOSE, CA 0 | 1248371 | Open | FED_ERNS |
| | SOUTH WEST EXPRESSWAY AND STOKES STREET, SAN JOSE, CA 0 | 1251540 | N/P | FED_ERNS |
| | CASTRO ST, MOUNTAINVIEW, CA 0 | 1252870 | N/P | FED_ERNS |
| | SANTA TERESA BLVD, BAYLISS, CA 0 | 1255305 | Closed | FED_ERNS |
| | CHARLESTON RD, PALO ALTO, CA 0 | 1255432 | N/P | FED_ERNS |
| | SAN PEDRO AVE, MORGAN HILL, CA 0 | 1256819 | N/P | FED_ERNS |
| HWY 17 & ALMA BRIDGE ROAD | , LOS GATOS, CA 0 | 1256944 | N/P | FED_ERNS |
| | AUZERAIS CROSSING, SAN JOSE, CA 0 | 1258088 | N/P | FED_ERNS |
| | TRIMBLE RD, SAN JOSE, CA 0 | 1258328 | Closed | FED_ERNS |
| MILEPOST: 53.6 | , SAN JOSE, CA 0 | 1259234 | N/P | FED_ERNS |
| | MP 54.27, SOUTH SAN JOSE, CA 0 | 1259950 | N/P | FED_ERNS |
| MP 36.25 | , MOUNTAIN VIEW, CA 0 | 1259953 | N/P | FED_ERNS |
| BASCOM STREET GRADE CROSSING | , SAN JOSE, CA 0 | 1261219 | N/P | FED_ERNS |
| HWY 101 | CHURCH AVE OVERCROSSING, SAN MARTIN, CA 0 | 1263682 | Open | FED_ERNS |

**Environmental Screening Report
For SANTA CLARA County**

Property Address: 1180 N 5TH ST
SAN JOSE, SANTA CLARA COUNTY, CA 95112
("Property")

APN: 235-12-009
Report Date: 09/22/2025
Report Number: 3506289

| Site Name | Address | Case No. | Status | Database |
|--|---|--------------|--------|-----------------------|
| US 101 SOUTH BOUND NORTH OF EXIT 340 | , GILROY, CA 0 | 1263696 | N/P | FED_ERNS |
| CHURCHILL AVE | MP: 30.88, PALO ALTO, CA 0 | 1264072 | N/P | FED_ERNS |
| | MP :42.95, SANTA CLARA, CA 0 | 1264125 | N/P | FED_ERNS |
| | MARY AVE, MOUNTAIN VIEW, CA 0 | 1265280 | N/P | FED_ERNS |
| BUTTERICK DEMOLITION | 11TH AND HORNING, SAN JOSE, CA 95112 | CA0000064105 | Closed | FED_SEMS_ARCHIVE |
| MOFFETT FIELD ANG | 129 ARR/CC, SUNNYVALE, CA 94086 | CA0170023238 | Closed | FED_SEMS_ARCHIVE |
| 129TH CAV AIR NATL GUARD | 129TH HRMS MOFFETT FIELD, SUNNYVALE, CA 94086 | CA0572890218 | Closed | FED_SEMS_ARCHIVE |
| FAIRCHILD | 4001 MIRANDA AVE, PALO ALTO, CA 94304 | CAD009124256 | Closed | FED_SEMS_ARCHIVE |
| LOCKHEED MISSILES & SPACE COMPANY INC. | 111 LOCKHEED WAY, SUNNYVALE, CA 94088 | CAD009125535 | Open | FED_SEMS_ARCHIVE |
| MEMOREX | SAN TOMAS AT CENTRAL EXPY, SANTA CLARA, CA 95052 | CAD009142415 | Closed | FED_SEMS_ARCHIVE |
| STANFORD UNIV-613 A1 | NEAR CORNER, CAMPUS DR/PANAMA, STANFORD, CA 94305 | CAD009214214 | Open | FED_SEMS_ARCHIVE |
| TELEDYNE MEC | 3165 PORTER AVE, PALO ALTO, CA 94304 | CAD009696097 | Closed | FED_SEMS_ARCHIVE |
| FORD MOTOR CO | 1100 S MAIN ST, MILPITAS, CA 95035 | CAD028679462 | Closed | FED_SEMS_ARCHIVE |
| BECKMAN INSTRUMENTS | 1117 CALIFORNIA AVE, PALO ALTO, CA 94304 | CAD028872711 | Closed | FED_SEMS_ARCHIVE |
| STANFORD CLEANERS | 2875 EL CAMINO, PALO ALTO, CA 94306 | CAD028879765 | Closed | FED_SEMS_ARCHIVE |
| SAN JOSE GRAPHICS | 696 TRIMBLE RD, SAN JOSE, CA 95131 | CAD044869469 | Closed | FED_SEMS_ARCHIVE |
| STAUFFER CHEMICAL CO. | 1931 SO. 1ST STREET, SAN JOSE, CA 95112 | CAD063566442 | Closed | FED_SEMS_ARCHIVE |
| GREAT WESTERN CHEMICAL CO | 945 AMES BLVD, MILPITAS, CA 95035 | CAD095991253 | Open | FED_SEMS_ARCHIVE |
| MOUNTAIN VIEW LDFL | SHORELINE REG PK STIERLIN RD, MOUNTAIN VIEW, CA 94040 | CAD980498711 | Closed | FED_SEMS_ARCHIVE |
| NINE PAR DUMP | LOS ESTEROS RD, ALVISO, CA 95002 | CAD980498752 | Closed | FED_SEMS_ARCHIVE |
| STAUFFER CHEM CO RAISCH QUARRY | S OF 1ST ST, SAN JOSE, CA 95112 | CAD980498877 | Closed | FED_SEMS_ARCHIVE |
| SINGLETON RD MUNI DSPL GRDS | 885 SINGLETON RD, SAN JOSE, CA 95112 | CAD980498950 | Closed | FED_SEMS_ARCHIVE |
| SUNNYVALE LDFL | CARIBBEAN DR, SUNNYVALE, CA 94086 | CAD980498992 | Closed | FED_SEMS_ARCHIVE |
| OPEN FIELD | BETWEEN HWY 237 & HWY 101, SANTA CLARA, CA 95050 | CAD980637292 | Closed | FED_SEMS_ARCHIVE |
| INTERNATIONAL DSPL CORP NEWBY IS LDFL | FT OF DIXON LANDING RD W END, MILPITAS, CA 95035 | CAD980637318 | Closed | FED_SEMS_ARCHIVE |
| OWENS CORNING FIBERGLAS CORP | LOS ESTERRAS, SAN JOSE, CA 95050 | CAD980637334 | Closed | FED_SEMS_ARCHIVE |
| PACIFIC AIRMOTIVE | SAN JOSE ARPT, SAN JOSE, CA 95110 | CAD980637367 | Closed | FED_SEMS_ARCHIVE |
| PACHECO PASS LDFL | 0.7 MI NE OF BLOOMFIELD RD, GILROY, CA 95020 | CAD980637722 | Closed | FED_SEMS_ARCHIVE |
| PACIFIC RAILWAY SIGNALS COLUMBIA POWDER | DAVES AVE, LOS GATOS, CA 95030 | CAD980736128 | Closed | FED_SEMS_ARCHIVE |
| US CELLULOSE | 520 PARROT ST, SAN JOSE, CA 95112 | CAD981379332 | Closed | FED_SEMS_ARCHIVE |
| Curtner Quarry | 2000 Scott Creek Rd, Milpitas, CA 95035 | FA0202264 | N/P | CA_GEO_UST |
| SCVTA-North Bus Division | 1235 L'AVENIDA AV, Mountain View, CA 94043 | 712 | N/P | CA_GEO_UST |
| CITY OF SAN JOSE- ALVISO PUMP STATION | 3519 GOLD ST, SAN JOSE, CA 95002 | FA0700488 | N/P | CA_GEO_UST |
| HIGHWAY 101 AND MOFFETT BLVD | HIGHWAY 101/85/MOFFETT BLVD, MOUNTAIN VIEW, CA 94043 | CAN000906131 | Open | FED_SEMS_ACTIVE |
| SOUTHERN PACIFIC RAILROAD | MOUNTAIN VIEW RAIL STATION, MOUNTAIN VIEW, CA 94035 | 43400002 | Open | CA_ENVIROSTOR_CLEANUP |
| SUMMERHILL CHERRY ORCHARD PROJECT | CRAWFORD & SARATOGA, SUNNYVALE, CA 94087 | 43070025 | Open | CA_ENVIROSTOR_CLEANUP |
| MARSHLAND DEVELOPMENTS, INC | GOLD STREET, NEAR SAN TOMAS AQUINO CREEK, ALVISO, CA 95002 | 43490003 | Open | CA_ENVIROSTOR_CLEANUP |
| MARIANI FRUIT PACKING PLANT ORCHARD | CORNER OF DEANZA BOULEVARD & HIGHWAY 280, CUPERTINO, CA 95014 | 43200018 | Open | CA_ENVIROSTOR_CLEANUP |
| MOUNTAIN VIEW LANDFILL GAS RECOVERY FACT | BETW CHARLESTON SLOUGH & STEVENS CREEK, MOUNTAIN VIEW, CA 94042 | 43950002 | Open | CA_ENVIROSTOR_CLEANUP |
| OPEN FIELD / SUNNYVALE LANDFILL | BETWEEN HIGHWAY 237 AND HIGHWAY 101, SUNNYVALE, CA 94086 | 43490058 | Open | CA_ENVIROSTOR_CLEANUP |
| Varian Medical Systems | 911, 913, 3075, 3030, & 3140 Hansen Way, Palo Alto, CA 94304 | 71003483 | Open | CA_ENVIROSTOR_CLEANUP |

**Environmental Screening Report
For SANTA CLARA County**

Property Address: 1180 N 5TH ST
SAN JOSE, SANTA CLARA COUNTY, CA 95112
("Property")

APN: 235-12-009
Report Date: 09/22/2025
Report Number: 3506289

Description of Databases Searched

The JCP-LGS Commercial Environmental Screening Report is based on an electronic search of certain federal, tribal and state level environmental-hazard record systems, or databases. These databases are searched for hazard sites within certain radius distances around the subject property. The databases searched, and the radius distances searched from the subject property, comply with the U.S. Environmental Protection Agency (EPA) "All Appropriate Inquiry" (AAI) standard for government records search (40 CFR Part 312.26) under the U.S. Small Business Liability Relief and Revitalization Act ("the Brownfields Law").

The government databases searched for this Report are identified below, along with the abbreviation used in this Report, and a brief explanation about the nature of the hazard sites included in those databases.

DISCLAIMER: An EPA-compliant government records search is only one part of the "All Appropriate Inquiry" standard defined under the Brownfields Law. Compliance with all parts of the Brownfields Law is required for an "innocent landowner defense" against the future discovery of contamination on the property. This Report, by itself, does NOT provide that liability protection. Please see the Terms and Conditions Section for additional information on the preparation and limitations of this Report.

Federal National Priorities List, or "Superfund" sites (SEMS NPL):

This is a list compiled by the Federal Environmental Protection Agency (EPA) of contaminated sites with the highest priority of cleanup. The federal EPA is required to force clean up of these sites under the authority of a law called the Comprehensive Environmental Response, Compensation, and Liability Act (CERCLA), which is commonly called "Superfund". The status of National Priority List ("NPL") and non-NPL sites governed by the statute is now contained in the U.S. EPA Superfund Enterprise Management System ("SEMS") which replaced the Comprehensive Environmental Response, Compensation, and Liability Information System ("CERCLIS")

Source Agency: U.S. Environmental Protection Agency.

Search Distance Used: 1.0 mile

Database last checked by JCP-LGS: 27 Mar 2025

WANT MORE INFORMATION? Contact the Environmental Information Center for US EPA Region 9 at (866) 372-9378 or via e-mail at r9.info@epa.gov.

Corrective Action Sites, sites with Known Contamination (RCRA COR):

This subset of the RCRA database (also known as the RCRA CORRACTS List), maintained by US EPA, identifies sites "subject to corrective action" at which contamination has been discovered and where some level of corrective clean-up activity has been or may be undertaken. For example, a site may have been on the RCRA TSD or a RCRA GEN site list (see above), and was placed on the CORRACTS list once contamination was discovered and remediation was underway.

Source Agency: U.S. Environmental Protection Agency.

Search Distance Used: 1.0 mile

Database last checked by JCP-LGS: 22 May 2025

WANT MORE INFORMATION? Contact the Environmental Information Center for US EPA Region 9 at (866) 372-9378 or via e-mail at r9.info@epa.gov.

Federal Sites Investigated for Possible Inclusion in the NPL (SEMS):

The Superfund Program has deployed the Superfund Enterprise Management System (SEMS), which integrates multiple legacy systems into a comprehensive tracking and reporting tool. Replacing The Comprehensive Environmental Response, Compensation, and Liability Act Information System (CERCLIS), SEMS provides updated data on the inventory of active and archived hazardous waste sites evaluated by the Superfund program. It contains sites that are either proposed to be or are on the National Priorities List (NPL) as well as sites that are in the screening and assessment phase for possible inclusion on the NPL. After investigation is complete, the sites on this list will either be closed because no contamination was found, added to the NPL to be cleaned up, or sent to a local state overseeing agency for clean-up.

Source Agency: U.S. Environmental Protection Agency.

Search Distance Used: 0.5 mile

Database last checked by JCP-LGS: 27 Mar 2025

WANT MORE INFORMATION? Contact the Environmental Information Center for US EPA Region 9 at (866) 372-9378 or via e-mail at r9.info@epa.gov.

SEMS Sites That Have Been Archived (SEMS-Archived):

Most sites in this database have been assigned the status "NFRAP" (which means "No Further Response Action Planned"). These sites, once listed in the active SEMS database, which has replaced CERCLIS, have been removed from that database into an archive list because they have been assessed by the EPA and determined not to require further remedial action under the Superfund Program.

**Environmental Screening Report
For SANTA CLARA County**

Property Address: 1180 N 5TH ST
SAN JOSE, SANTA CLARA COUNTY, CA 95112
("Property")

APN: 235-12-009
Report Date: 09/22/2025
Report Number: 3506289

Source Agency: U.S. Environmental Protection Agency.

Search Distance Used: 0.5 mile

Database last checked by JCP-LGS: 28 Mar 2024

WANT MORE INFORMATION? Contact the Environmental Information Center for US EPA Region 9 at (866) 372-9378 or via e-mail at r9.info@epa.gov.

Treatment, Storage and Disposal Sites for Hazardous Materials (RCRA TSD):

TSD stands for Treatment, Storage and Disposal. This list of facilities is maintained by the Federal EPA, and includes sites that are licensed to treat, store, or dispose of hazardous substances. They are not necessarily contaminated.

Source Agency: U.S. Environmental Protection Agency.

Search Distance Used: 0.5 mile

Database last checked by JCP-LGS: 22 May 2025

WANT MORE INFORMATION? Contact the Environmental Information Center for US EPA Region 9 at (866) 372-9378 or via e-mail at r9.info@epa.gov.

Tribal UST And/Or Tribal LUST:

Federally recognized Native American tribes are sovereign entities subject to federal laws. Underground storage tanks (including leaking tanks, UST/LUST) located on tribal lands generally are not subject to state laws. As a result, unless a state acts as a tribe's agent pursuant to a formal agreement with a tribe, EPA and the tribe are responsible for implementing and enforcing the UST program on tribal lands. There are approximately 6,000 UST/LUST's on Native American lands in the U.S. The EPA works with tribal entities to identify and assess hazards to public health and the environment on tribal lands from UST's and LUST's, to bring all tanks on tribal lands into compliance so as to prevent future leaks and to cleanup existing leaks. Other tribal databases are not included in this search. The EPA notes that tribal government records need only be searched for in those instances where the subject property is located on or near tribal-owned lands. While tribal hazardous waste sites are included in the California Department of Toxic Substances Control (DTSC) "Envirostor" database, only some are listed and they are not identified in order to maintain the privacy of the tribe(s) and their lands, according to DTSC. See Envirostor database (described below) for more information, or visit: <https://www.envirostor.dtsc.ca.gov/public/>

Source Agency: U.S. Environmental Protection Agency.

Search Distance Used: 0.5 mile

Database last checked by JCP-LGS: 01 Jun 2018

WANT MORE INFORMATION? Contact the Environmental Information Center for US EPA Region 9 at (866) 372-9378 or via e-mail at r9.info@epa.gov.

State EnviroStor Database (ENVIROSTOR, formerly SMBRPD):

The EnviroStor database, maintained by the California Department of Toxic Substances Control (DTSC), replaces the former Site Mitigation and Brownfields Reuse Program (SMBRP) database (CalSites). EnviroStor identifies sites that have known contamination or sites for which there may be reasons to investigate further as well as hazardous waste treatment, storage, disposal or transfer facilities (TSDTF). The EnviroStor data disclosed in this Report includes those sites identified in the EnviroStor Cleanup Sites database as well as those listed in the EnviroStor Permitted and Corrective Action Facilities database download. Among the site types included in EnviroStor database are State Response Sites, generally high-priority and high potential risk confirmed release sites where DTSC is involved in remediation; Voluntary Cleanup Sites with either confirmed or unconfirmed releases where DTSC has been asked to oversee evaluation, investigation, and/or cleanup activities; and Evaluation sites with suspected but unconfirmed contamination. DTSC cautions that the EnviroStor database does not include ALL contaminated sites, permitted transportable treatment units, hazardous waste generators/transporters, or former methamphetamine (meth) labs. This database also does not include information on sites where DTSC has made a "No Action Required" determination, as these sites had assessments that revealed no evidence of recognized environmental conditions in connection with the property.

Source Agency: California Department of Toxic Substances Control.

Search Distance Used: 0.5 mile

Database last checked by JCP-LGS: 10 Jul 2025

WANT MORE INFORMATION? Contact the CA Environmental Protection Agency, Department of Toxic Substances Control, (916)323-3400.

State List of Spills, Leaks, Investigation & Cleanup (SLIC):

The Spills, Leaks, Investigations & Cleanup (SLIC) Program, administered by the California Water Resources Control Board, is designed to protect and restore water quality from spills, leaks, and similar discharges. Sites identified by the SLIC program are now listed in the GeoTracker database as "Cleanup Program Sites". The program oversees soil and water investigations, corrective actions, and human health risk assessments at sites with current or historic unauthorized discharges, which have adversely affected or threaten to adversely affect waters of the state. The program covers all types of pollutants (such as solvents, petroleum fuels, heavy metals, pesticides, etc) and all environments (including surface water, groundwater, sediment, and soil). The outcome of the SLIC program process may range from a No Further Action (NFA) letter indicating cleanup is complete with no land-use restrictions, to the design and implementation of a remedial system. Sites in the SLIC program are generally small to medium-sized industrial sites with non-fuel contamination. Many of these sites are regulated under Site Cleanup Requirements, which are issued by the Regional Board. Site Cleanup Requirements generally mandate a time schedule for specific tasks that

**Environmental Screening Report
For SANTA CLARA County**

Property Address: 1180 N 5TH ST
SAN JOSE, SANTA CLARA COUNTY, CA 95112
("Property")

APN: 235-12-009
Report Date: 09/22/2025
Report Number: 3506289

must be performed by the responsible party(ies) to investigate and cleanup the site. Statutory authority for the program is derived from the California Water Code, Division 7, Section 13304. Guidelines for site investigation and remediation are promulgated in State Board Resolution No. 92-49 entitled Policies and Procedures.

Source Agency: California Water Resources Control Board.

Search Distance Used: 0.5 mile

Database last checked by JCP-LGS: 05 Jun 2025

WANT MORE INFORMATION? Contact the CA State Water Resources Control Board, Underground Storage Tank Program, (916)341-5808.

Solid Waste Landfill Facilities (SWIS):

The Solid Waste Information System is maintained by California's Integrated Waste Management Board. This system tracks known landfills. Sites on this list are often reported as "unlocatable" because the site address information on the state list is frequently insufficient for precise location (landfills are typically distant from population centers, in undeveloped or rural areas where there are no street names or address numbers).

Source Agency: California Integrated Waste Management Board.

Search Distance Used: 0.5 mile

Database last checked by JCP-LGS: 20 Jun 2025

WANT MORE INFORMATION? Contact the CA State Integrated Waste Management Board, (916)341-6320.

State List of Leaking Underground Storage Tanks (LUST):

California's Water Resources Control Board, under its Underground Storage Tank Program, maintains a list of all underground storage tanks which have been reported as having released contaminants. Formerly identified as a standalone database called the Leaking Underground Storage Tank Information System (LUSTIS), these sites are now identified as "LUST Cleanup Sites" in the GeoTracker database.

Source Agency: California Water Resources Control Board.

Search Distance Used: 0.5 mile

Database last checked by JCP-LGS: 05 Jun 2025

WANT MORE INFORMATION? Contact the CA State Water Resources Control Board, Underground Storage Tank Program, (916)341-5808.

EnviroStor Site With Deed Restriction Or Other Controls (CONTROLS)

California law requires that the Department of Toxic Substances Control (DTSC) notify the planning and building departments of all local governments of any recorded land use restriction ("Deed Restriction"). The DTSC maintains a database called "EnviroStor" that lists all deed restrictions, including street addresses or the equivalent description of location. According to DTSC, this database may not include all deed restrictions and other land use controls that exist at the current time.

Source Agency: California Department of Toxic Substances Control.

Search Distance Used: 0.5 mile

Database last checked by JCP-LGS: 23 Jan 2025

WANT MORE INFORMATION? Contact the CA Environmental Protection Agency, Department of Toxic Substances Control, (916)323-3400.

Sites of Potential Generators of Hazardous Materials (RCRA GEN):

Small scale and large scale generators (GEN) are included in this list, as required under the Resource Conservation and Recovery Act (RCRA). This list is maintained by the Federal EPA of facilities that generate hazardous substances. Depending on the quantity, they will be listed as small or large. Sites on this list are not necessarily contaminated, but they are tracked because they deal with hazardous substances on the site. RCRA is a federal law that governs how hazardous substances are produced, transported, stored, and disposed of.

Source Agency: U.S. Environmental Protection Agency.

Search Distance Used: 0.125 mile

Database last checked by JCP-LGS: 22 May 2025

WANT MORE INFORMATION? Contact the Environmental Information Center for US EPA Region 9 at (866) 372-9378 or via e-mail at r9.info@epa.gov.

Emergency Response Notification System (ERNS, National Response Center):

The National Response Center (NRC) is the sole federal point of contact for reporting environmental hazard spills. The NRC operates 24 hours a day, 7 days a week, 365 days a year. The National Response System (NRS) is the government's mechanism for emergency response to discharges of oil and the release of chemicals into the navigable waters or environment of the United States and its territories. Initially, this system focused on oil spills and selected hazardous polluting substances discharged into the environment. It has since been expanded by other legislation to include hazardous substances and wastes released to all types of media. The ERNS database includes information about location, type, and severity of spills reported to the NRC.

Source Agency: U.S. Coast Guard.

Search Distance Used: 0.125 mile

Database last checked by JCP-LGS:

**Environmental Screening Report
For SANTA CLARA County**

Property Address: 1180 N 5TH ST
SAN JOSE, SANTA CLARA COUNTY, CA 95112
("Property")

APN: 235-12-009
Report Date: 09/22/2025
Report Number: 3506289

WANT MORE INFORMATION? Contact the National Response Center, (800) 424-8802.

State List of Underground Storage Tanks (UST):

Part of the larger GeoTracker database, this list identifies permitted tanks storing hazardous substances which are substantially or totally beneath the surface of the ground. The list is maintained by California's Water Resources Control Board. When a tank on this list is discovered to be leaking, it may also appear on the LUST or RCRA COR list (see above). Sites on the LUST or RCRA COR lists may not appear on the UST list if the tank has been removed and the case has been closed.

Source Agency: California Water Resources Control Board.

Search Distance Used: 0.125 mile

Database last checked by JCP-LGS: 23 Jan 2025

WANT MORE INFORMATION? Contact the CA State Water Resources Control Board, Underground Storage Tank Program, (916)341-5808

State List of Historical Underground Storage Tanks (Hist-UST):

The California State Water Resources Control Board keeps the Hazardous Substances Storage Container Information on file. This is a database of historical underground storage tanks that was kept until the late 1980's, but has been discontinued and is no longer updated.

Source Agency: California Water Resources Control Board.

Search Distance Used: 0.125 mile

Database last checked by JCP-LGS: 01 Jun 2018

WANT MORE INFORMATION? Contact the CA State Water Resources Control Board, Underground Storage Tank Program, (916)341-5808

State Hazardous Waste Information Summary (HWIS):

The Hazardous Waste Information Summary (also called the Hazardous Waste Summary Report, and formerly the Tanner Report), is a database that summarizes the chemical data contained in manifests submitted to the California Department of Toxic Substances Control (DTSC) by hazardous waste generators and facilities around the state. The volume of manifests submitted to the DTSC is typically 900,000 - 1,000,000 annually, representing approximately 450,000 - 500,000 shipments.

Source Agency: California Department of Toxic Substances Control.

Search Distance Used: 0.125 mile

Database last checked by JCP-LGS: 28 Feb 2020

WANT MORE INFORMATION? Contact the CA Environmental Protection Agency, Department of Toxic Substances Control, (916)323-3400.

Sites Reported but Not Required for AAI Compliance

As a courtesy to JCP-LGS clients, the Commercial Environmental Screening Report also includes storage tank sites listed by state agencies that are not required by the AAI standard to be included in a government records search. These sites are listed in the following database:

State List of Aboveground Storage Tanks (AST):

This historic list tracks aboveground petroleum storage tanks of 10,000 gallons or more, with exceptions for certain uses (e.g., agricultural). It was maintained by the state's Water Resources Control Board. When an aboveground tank is discovered to be leaking, it may also appear on the RCRA COR list (see above). Sites on the RCRA COR list may not appear on the AST list if the tank has been removed and the case has been closed. NOTE: Effective January 1, 2008 the Certified Unified Program Agencies (CUPAs) at the local level are vested with the responsibility and authority to implement the Aboveground Petroleum Storage Act (APSA) which regulates ASTs.

Source Agency: California Water Resources Control Board.

Search Distance Used: 0.125 mile

Database last checked by JCP-LGS: 01 Jun 2018

WANT MORE INFORMATION? Contact the local responsible agency from the online directory at

<https://osfm.fire.ca.gov/what-we-do/pipeline-safety-and-cupa/certified-unified-program-agency/aboveground-petroleum-storage-act>.

**END OF ENVIRONMENTAL SCREENING REPORT SECTION
See Terms and Conditions at end of this Report.**

Property Address: 1180 N 5TH ST
SAN JOSE, SANTA CLARA COUNTY, CA 95112
("Property")

APN: 235-12-009
Report Date: 09/22/2025
Report Number: 3506289

TERMS and CONDITIONS

ACCEPTANCE OR USE OF THIS REPORT CONSTITUTES APPROVAL AND ACCEPTANCE OF THE TERMS, CONDITIONS, AND LIMITATIONS STATED HEREIN.

The Report ("Report") is subject to each of the following Terms and Conditions. Each Recipient (defined below) of the Report agrees that the Report is subject to the following Terms and Conditions, and each Recipient agrees to be bound by such. Use of this Report by any Recipient constitutes acceptance of the Terms and Conditions to the Report. The Terms and Conditions below are incorporated by this reference into the Report. **This Report is not an insurance policy.**

This Report is made for the real property specifically described in the Report (the "Property") and solely for the transaction for which it was originally purchased ("Transaction"). The Property shall not include any property beyond the boundaries of the real property described in the Report. The Property shall not include any structures (whether located on the Property, or not), easements, or any right, title, interest, estate, or easement in any abutting streets, roads, alleys, lanes, ways, or waterways.

IMPORTANT NOTICE: Transferor(s) and transferee(s) shall read the complete Report in its entirety before the close of escrow. A "Signature Page" or "Summary Pages" document may be included in the electronic delivery of this Report. Those documents do not replace the complete Report or remove the need to read the complete Report, and do not remove the requirement to disclose. The Signature Page and Summary Pages documents are subject to the Terms and Conditions of the complete Report.

- A. **No Third Party Reliance on This Report.** Only the transferor(s) and transferee(s), and their agents/brokers, if any, involved in the Transaction (collectively, the "Recipients") may use and rely on this Report and only after they have paid in full for the Report. While disclosures made on the Natural Hazard Disclosure Statement in the Report may indicate certain risks to the Property, the disclosures are only "...between the transferor, the transferor's agents, and the transferee, and shall not be used by any other party, including, but not limited to, insurance companies, lenders, or governmental agencies, for any purpose." Cal. Civil Code section 1103.2, subdivision (g).
- B. **Seller and Seller's Agent's Responsibility of Full Disclosure.** Recipients are obligated to make disclosures, and always disclose material facts, that are within their actual knowledge.
- C. **Scope of Report.** This Report is limited to determining whether the Property is in those specified natural hazard zones and property tax districts, and in proximity to those specified environmental sites (depending on the report product ordered), as defined in the Report. The Report is not a geologic report or a land survey and no site inspection has been made in producing the Report. JCP-LGS makes no determination, expresses no opinion or view, and assumes no responsibility in this Report concerning the right, entitlement, or ability to develop or improve the Property. JCP-LGS has no information concerning whether the Property can be developed or improved. No determination is made and no opinion is expressed, or intended, by this Report concerning structures or soils on or outside of the Property, including, without limitation, habitability of structures or the Property, suitability of the Property for construction or improvement, potential for soil settlement, drainage, soil subsidence, or other soil or site conditions. The Recipient(s) is advised to consult the local Planning Department to determine whether factors beyond the scope of this Report may limit the transferee(s) ability to use or improve the Property.

The Report is not a title report, and no determination is made and no opinion is expressed, or intended, by this Report as to title to the Property or liens against the Property, recorded or otherwise, or whether the Property is comprised of legal lots in conformance with the California Subdivision Map Act or local ordinances. The Report is not a property inspection report, and no determination is made and no opinion is expressed, or intended, by this Report concerning architectural, structural, mechanical, engineering, or legal matters, or the marketability or value of the Property. JCP-LGS has not conducted any testing or physical or visual examination or inspection of the Property, nor is this Report a substitute for any such testing, physical or visual examination, or inspection.

- D. **Tax and Environmental Disclosures (if included in Report).** No determination is made and no opinion is expressed, or intended, by the Report concerning the existence of property tax liabilities, or the existence of hazardous or toxic materials or substances, or any other defects, on, under, or in proximity to the Property, unless specifically described in the Report. JCP-LGS's total liability for any error or omission in its disclosures relating to taxes and/or environmental matters shall be limited to actual proven damages not to exceed the price paid for this Report.
- E. **JCP-LGS Database Updates.** Each database used in this Report is updated by the responsible agency at various intervals. Updates for a database are determined by the responsible agency and may be made at any time and without notice. JCP-LGS maintains an update schedule and makes reasonable efforts to use updated information. For these reasons, JCP-LGS reports information as of the date when the database was last updated by JCP-LGS. That date is specified as the "Database Date" for each database. The Tax Report discloses Mello Roos Community Facilities Districts, 1915 Bond Act Assessments and PACE assessments documented in the county's Fiscal Year 2024-2025 annual secured property tax roll. The Report may disclose PACE contracts where PACE taxes were first assessed or liens were recorded after the Fiscal Year 2024-2025 secured property tax roll, where recordation data is available to JCP-LGS. To discover a PACE lien on the Property executed more recently, the buyer should read the preliminary title report and obtain and read all exceptions listed therein. Note that, in the title report, lien exceptions are named as recorded with the county; therefore, a PACE lien may be listed under a name that is not obvious.
- F. **Statutory and Additional Disclosures, Advisories, and Local Addenda (if included in Report).** No determination is made and no opinion is expressed, or intended, by this Report concerning the need to purchase earthquake or flood insurance for the Property. In preparing the Report, JCP-LGS accurately reported on information contained in Government Records. JCP-LGS reviewed and relied upon those Government Records specifically identified and described in the Report. JCP-LGS has not reviewed or relied upon any Government Records that are not specifically identified in the Report. JCP-LGS also has not reviewed any plat maps, survey maps, surveyor maps, assessor maps, assessor parcel maps, developer maps, or engineering maps, whether or not such maps have been recorded. No determination is made and no opinion is expressed, or intended, by the Report concerning any matters identified in Government Records that were not reviewed by JCP-LGS. Local Addenda, where applicable, are included "AS IS" as an accommodation to the local real estate board that provided the content; JCP-LGS assumes no responsibility for the accuracy of any information included in the Local Addenda.
- G. **FEMA Flood Determination Certificate (if accompanying the Report).** No determination is made and no opinion is expressed, or intended, by the Report concerning the requirement for or cost of flood insurance on the Property. Recipient(s) understands that a lender may require flood insurance to secure its loan collateral independent of whether FEMA may require flood insurance under the National Flood Insurance Program on a federally backed mortgage. The FEMA Flood Determination Certificate ("Flood Certificate"), which may accompany the Report, is produced by a third-party expert certified by FEMA to provide Flood Certificates. JCP-LGS assumes no liability for errors in that third-party flood determination.
- H. **Changes to Government Record after Report Date.** This Report is issued as of the Report Date identified in the Report. JCP-LGS shall have no obligation to advise any Recipient of any information learned or obtained after the Report Date even if such information would modify or otherwise affect the Report.

Property Address: 1180 N 5TH ST
SAN JOSE, SANTA CLARA COUNTY, CA 95112
("Property")

APN: 235-12-009
Report Date: 09/22/2025
Report Number: 3506289

Subsequent to JCP-LGS acquisition of Government Records, changes may be made to said Government Records and JCP-LGS is not responsible for advising the Recipients of any changes. JCP-LGS will update this Report upon request and at no charge during the transaction process for which this Report was issued, but not to exceed one year from the date of the Report. Likewise, JCP-LGS is not liable for any impact on the Property that any change to the Government Records may have.

- I. **Government Record Sources.** JCP-LGS relies upon the Government Records specifically identified in the Report without conducting an independent investigation of their accuracy. JCP-LGS assumes no responsibility for the accuracy of the Government Records identified in the Report. JCP-LGS makes no warranty or representation of any kind, express or implied, with respect to the Report. JCP-LGS expressly disclaims and excludes any and all other express and implied warranties, including, without limitation, warranties of merchantability or fitness for a particular purpose. The JCP-LGS Report is "AS IS".
- J. **Limitation of JCP-LGS's Liability**
- JCP-LGS is not responsible for:
 - Any inaccuracies or incompleteness of the information in the Public Records.
 - Inaccurate address information provided for the Property.
 - Any other information not contained in the Public Records as of the Report Date.
 - Any information which would be disclosed by a physical inspection of the Property.
 - Any information known by one of the Parties.
 - The health or risk to humans or animals that may be associated with any of the disclosed hazards.
 - The costs of investigating or remediating any of the disclosed hazards.
 - JCP-LGS's total liability and responsibility to all Recipients collectively for any and all liabilities, causes of action, claim or claims, including but not limited to claims for breach of contract or negligence, shall be limited to the price paid for the Report. JCP-LGS expressly disclaims any liability for Recipients indirect, incidental and/or consequential damages, including without limitation lost profits even if such damages are foreseeable. In the event of any error, omission or inaccuracy in the JCP-LGS Report for which JCP-LGS is liable, JCP-LGS shall have no duty to defend or pay any attorneys' fees, costs or expenses incurred by the Recipients, or any of them. The Recipients, and each of them, expressly waive the benefits of California Civil Code Section 2778. JCP-LGS has not conducted an independent investigation of the accuracy of the information provided by the Recipient. JCP-LGS assumes no responsibility for the accuracy of information provided by the Recipient. JCP-LGS shall be subrogated to all rights of any claiming party against anyone including, but not limited to, another party who had actual knowledge of a matter and failed to disclose it to the Recipients in writing prior to the close of escrow.
- K. **Reporting of Risk Elements for Condominium Projects, Planned Unit Developments, and Other Properties with Common or Undivided Interests ("Common Interests")** Unless otherwise noted, this report is based solely on the real Property referenced by the Property's Assessor's Parcel Number ("APN"). An APN whose boundary does not include all Common Interests associated with the parcel will generate a report which does not identify the natural hazards relating to the Common Interests that extend beyond the APN parcel boundary. Accordingly, it is imperative that you consult with the property's homeowners association(s) to determine those risks.
- L. **Governing Law.** The Report shall be governed by, and construed in accordance with, the laws of the State of California.
- M. **Small Claims or Arbitration.** This provision constitutes an agreement to arbitrate disputes on an individual basis. Any party may bring an individual action in small claims court instead of pursuing arbitration, so long as the action remains in that court. All disputes and claims arising out of or relating to the Website, Customer Service, or any Report, must be resolved by binding arbitration. This agreement to arbitrate includes, but is not limited to, all disputes and claims between Company, transferor(s) and transferee(s) and claims that arose prior to purchase of the Report. This agreement to arbitrate applies to transferor(s) and transferee(s) successors in interest, assigns, heirs, spouses, and children. As noted above, a party may elect to bring an individual action in small claims court instead of arbitration, so long as the dispute falls within the jurisdictional requirements of small claims court.
- Any arbitration must take place on an individual basis. Company, transferor(s) and transferee(s) agree that they are waiving any right to a jury trial and to bring or participate in a class, representative, or private attorney general action, and further agree that the arbitrator lacks the power to grant relief affecting anyone other than the individual claimant. If a court decides that any of the provisions of this paragraph are invalid or unenforceable as to a particular claim or request for a particular remedy (such as a request for public injunctive relief), then that claim or request for that remedy must be brought in court and all other claims and requests for remedies must be arbitrated in accordance with this agreement
- The arbitration is governed by the Consumer Arbitration Rules (the "AAA Rules") of the American Arbitration Association ("AAA"), as modified by this Agreement, and will be administered by the AAA. Company will pay all AAA filing, administration and arbitrator fees for any arbitration it initiates and for any arbitration initiated by another party for which the value of the claims is \$75,000 or less, unless an arbitrator determines that the claims have been brought in bad faith or for an improper purpose, in which case the payment of AAA fees will be governed by the AAA Rules #A COPY OF THESE RULES IS AVAILABLE FROM THE AAA'S WEB SITE AT WWW.ADR.ORG OR ON REQUEST FROM THE COMPANY. THE ARBITRATION AWARD MAY INCLUDE ATTORNEY'S FEES IF ALLOWED BY FEDERAL, STATE, OR OTHER APPLICABLE LAW AND MAY BE ENTERED AS A JUDGMENT IN ANY COURT OF PROPER JURISDICTION.
- The arbitration will take place in the same county in which the property covered by the Report is located. The Federal Arbitration Act will govern the interpretation, applicability and enforcement of this arbitration agreement. This arbitration agreement will survive the termination of the Report.
- N. **Severability.** If any provision of the Terms and Conditions to this Report is determined to be invalid or unenforceable for any reason, then such provision shall be treated as severed from the remainder of the Terms and Conditions, and shall not affect the validity and enforceability of all of the other provisions of the Terms and Conditions.
- O. **Other Agreements.** This Report constitutes the entire, integrated agreement between JCP-LGS and Recipients, and supersedes and replaces all prior statements, representations, negotiations, and agreements.

END OF REPORT