



242-244 Broadmoor Dr

Raymore, Missouri

Property Features

- 1,800-3,600 SF Available
- Second generation medical suites
- Signage opportunity and dedicated front entrances
- Ample parking surrounding building on three sides
- Next door to Raymore City Hall and Police Department
- Sale Price: \$1,300,000
- Lease Rate: \$14/SF NNN

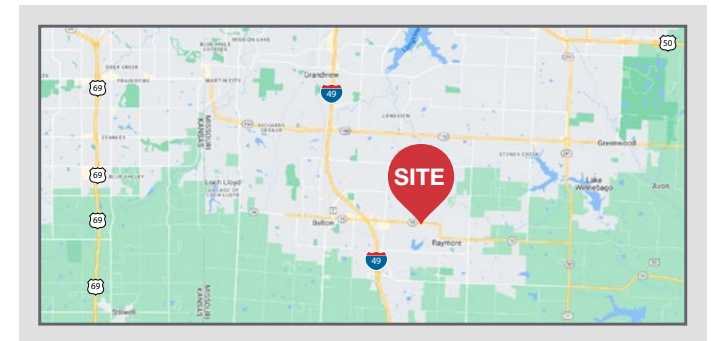

For more information:

Mike Sonnenberg, CCIM

+1 913 956 5812 • mike@nai-heartland.com

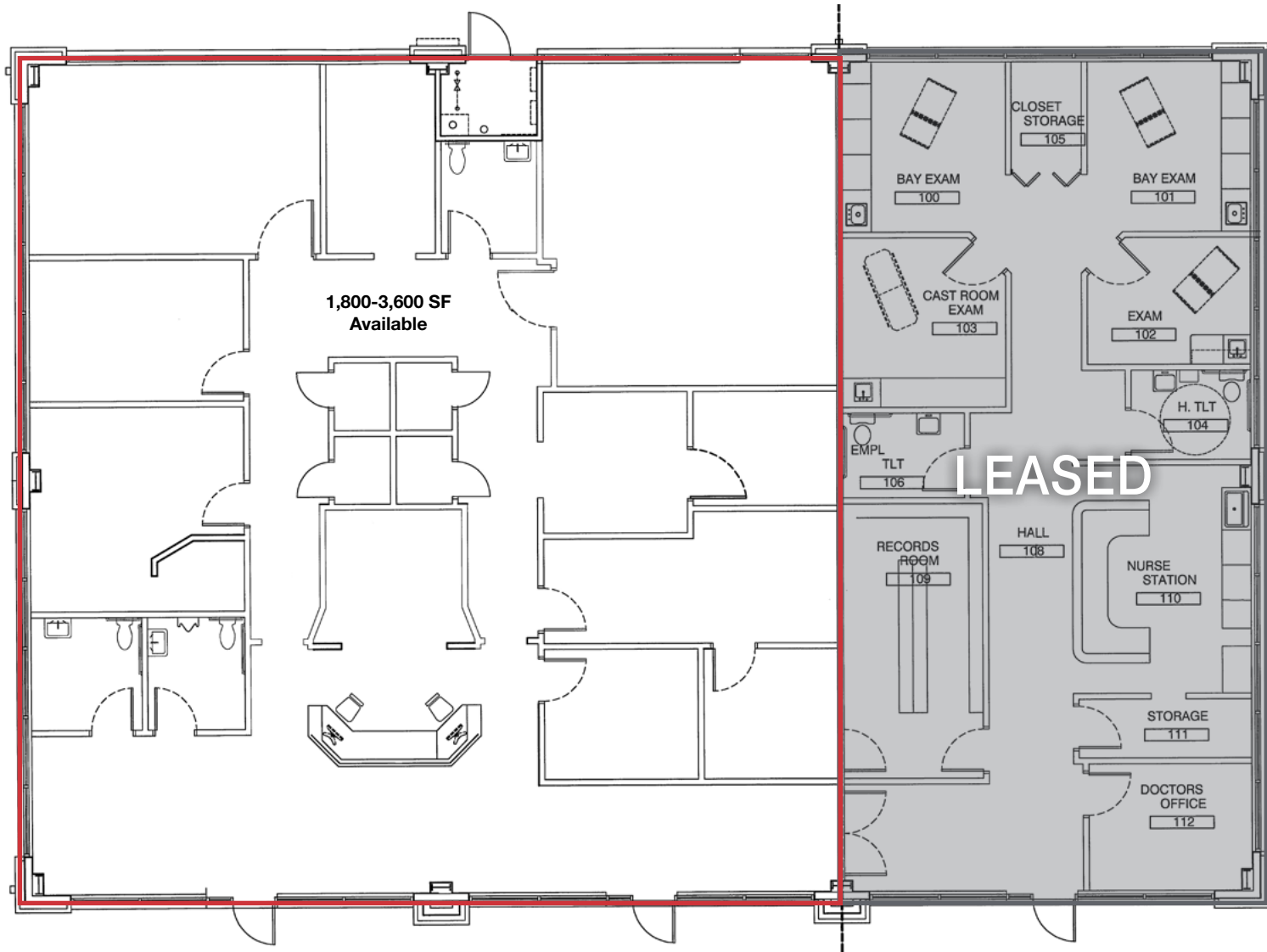



NO WARRANTY OR REPRESENTATION, EXPRESS OR IMPLIED, IS MADE AS TO THE ACCURACY OF THE INFORMATION CONTAINED HEREIN, AND THE SAME IS SUBMITTED SUBJECT TO ERRORS, OMISSIONS, CHANGE OF PRICE, RENTAL OR OTHER CONDITIONS, PRIOR SALE, LEASE OR FINANCING, OR WITHDRAWAL WITHOUT NOTICE, AND OF ANY SPECIAL LISTING CONDITIONS IMPOSED BY OUR PRINCIPALS NO WARRANTIES OR REPRESENTATIONS ARE MADE AS TO THE CONDITION OF THE PROPERTY OR ANY HAZARDS CONTAINED THEREIN ARE ANY TO BE IMPLIED.

4400 College Boulevard, Suite 170
Overland Park, Kansas 66211
+1 913 956 1000

nai-heartland.com

CITY	2023 EST. POPULATION	2022 EST. POPULATION	# CHANGE	% CHANGE
Gardner, KS	25,378	24,196	1,182	4.89%
Raymore, MO	25,306	24,171	1,135	4.70%
Gladstone, MO	27,329	26,898	431	1.60%
Blue Springs, MO	60,539	59,611	928	1.56%
Olathe, KS	147,461	145,577	1,884	1.29%
Leawood, KS	33,980	33,713	267	0.79%
Lee's Summit, MO	104,184	103,409	775	0.75%
Belton, MO	25,534	25,404	130	0.51%
Shawnee, KS	69,417	69,180	237	0.34%
Kansas City, MO	510,704	509,129	1,575	0.31%
Liberty, MO	30,794	30,769	25	0.08%
Leavenworth, KS	37,034	37,071	-37	-0.10%
Lenexa, KS	58,536	58,607	-71	-0.12%
Independence, MO	120,922	121,079	-157	-0.13%
Kansas City, KS	152,933	153,238	-305	-0.20%
Prairie Village, KS	22,900	22,946	-46	-0.20%
Overland Park, KS	197,089	197,705	-616	-0.31%
Grandview, MO	25,436	25,601	-165	-0.64%
Raytown, MO	29,097	29,301	-204	-0.70%

AMONG THE 19 CITIES IN THE KANSAS CITY METRO WITH A POPULATION OF AT LEAST 20,000, RAYMORE WAS THE SECOND FASTEST GROWING BY PERCENTAGE CHANGE IN 2023.



25,306
POPULATION



9,034
HOUSEHOLDS



59,203
DAYTIME POPULATION



\$96,536
MEDIAN HOUSEHOLD INCOME



20 MILES
SOUTH OF DOWNTOWN
KANSAS CITY



\$278,100
MEDIAN HOME VALUE

Source: Census Bureau, Vintage 2023 Population Estimates (release date: May 2024)

NO WARRANTY OR REPRESENTATION, EXPRESS OR IMPLIED, IS MADE AS TO THE ACCURACY OF THE INFORMATION CONTAINED HEREIN, AND THE SAME IS SUBMITTED SUBJECT TO ERRORS, OMISSIONS, CHANGE OF PRICE, RENTAL OR OTHER CONDITIONS, PRIOR SALE, LEASE OR FINANCING, OR WITHDRAWAL WITHOUT NOTICE, AND OF ANY SPECIAL LISTING CONDITIONS IMPOSED BY OUR PRINCIPALS NO WARRANTIES OR REPRESENTATIONS ARE MADE AS TO THE CONDITION OF THE PROPERTY OR ANY HAZARDS CONTAINED THEREIN ARE ANY TO BE IMPLIED.

4400 College Boulevard, Suite 170
Overland Park, Kansas 66211
+1 913 956 1000

nai-heartland.com