



2,500 SF Available

For Lease

Aaron Flynn

+1 208 807 3332

aaron.flynn@colliers.com

Michael McNeight

+1 208 472 2865

michael.mcneight@colliers.com

755 West Front Street, Suite 300

Boise, Idaho 83702

+1 208 345 9000

colliers.com/idaho

1322 Lauren Lane
Caldwell, Idaho 83605

Highlights:

- Functional floor plan and high end office finishes
- Ideally located within Sky Ranch Business Park
- 18' clear height in warehouse

This document has been prepared by Colliers for advertising and general information only. Colliers makes no guarantees, representations or warranties of any kind, expressed or implied, regarding the information including, but not limited to, warranties of content, accuracy and reliability. Any interested party should undertake their own inquiries as to the accuracy of the information. Colliers excludes unequivocally all inferred or implied terms, conditions and warranties arising out of this document and excludes all liability for loss and damages arising there from. This publication is the copyrighted property of Colliers and /or its licensor(s). © 2025. All rights reserved. This communication is not intended to cause or induce breach of an existing listing agreement. Colliers Treasure Valley, LLC.

For Lease

Property Information

Property Type	Industrial
Total Building Size	2,500 SF
Zoning	Light Industrial
Ceiling Height	18'
Grade Level Drive-In Doors	16' x 14'
Lease Rate	Contact Agent
NNN Est.	\$0.27 PSF



Site Plan

Business Park Entrance

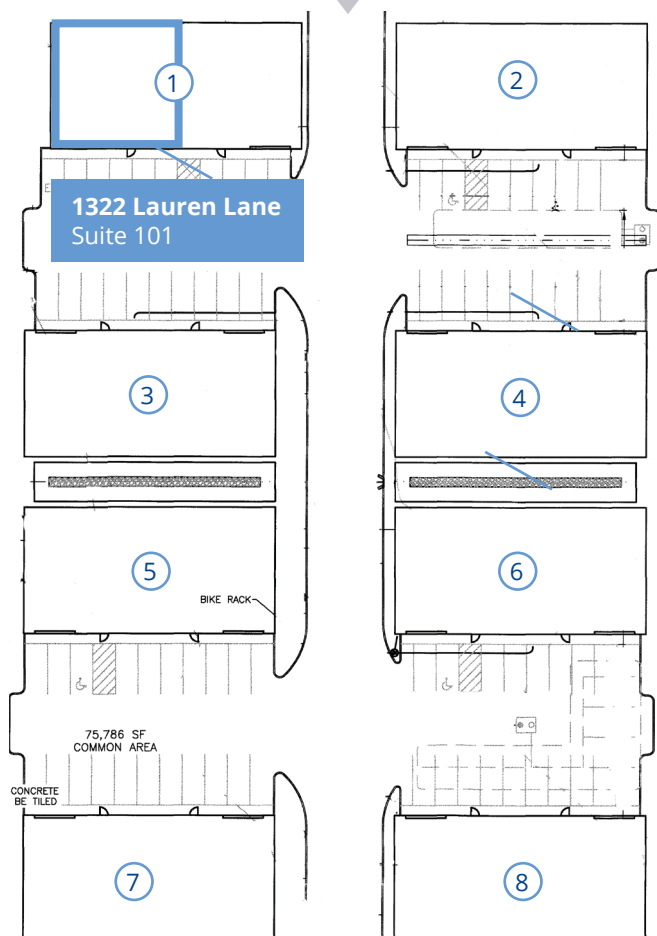

Space Available

Building	Suite	Size	Rate
1	101	2,500 SF	Contact Agent

Floor Plan

Suite 101 | 2,500 SF

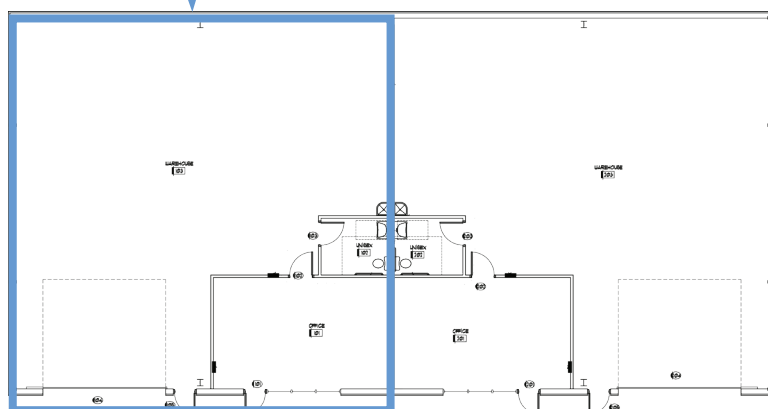

Location



Google Map



Street View

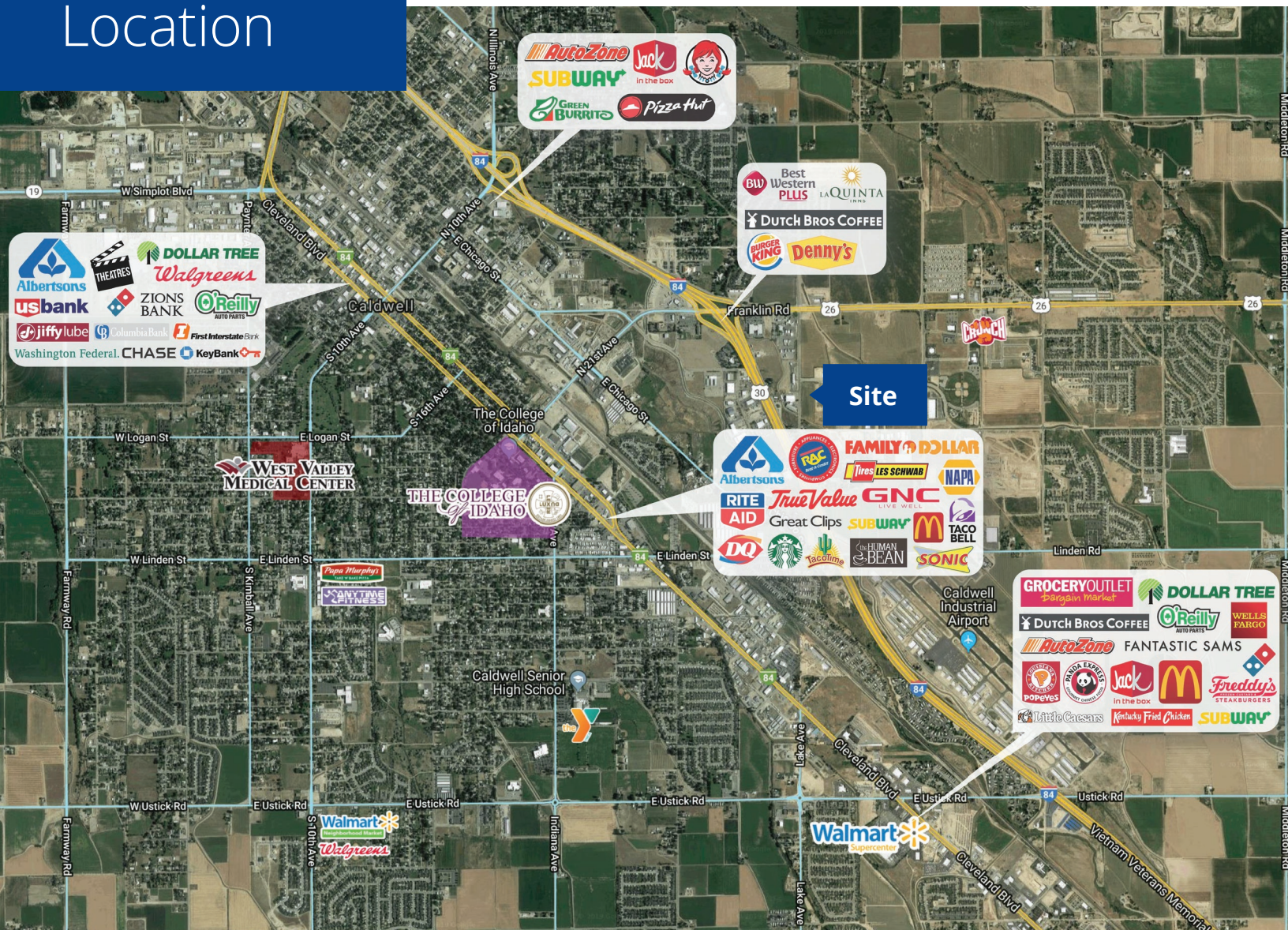

Colliers

755 West Front Street, Suite 300
Boise, Idaho 83702
+1 208 345 9000
colliers.com/idaho