

Flex Building Available for Sale

savills

FOR SALE

16812 Red Hill Avenue, Irvine, CA 92606





SPACE PROFILE

12,050 RSF

Total SF Available

±4,000 RSF

Lab Space SF Available

±4,000 RSF

Warehouse Space

Withheld

Sale Price

Immediate

Availability

22'

Clearance Height

KEY HIGHLIGHTS

- ±12,050 SF two-story flex building
- ±4,000 SF warehouse
- ±4,000 SF lab space
- Highly visible on Red Hill Avenue
- Year Built: 1977
- Total Drive-ins: 2 tot./9'w x 14'h
- Parking Ratio: 2.74/1,000 SF
- Total Surface Parking Stalls: 33
- Land Acres: 0.69 AC (30,056 SF)

1ST FLOOR - FLOOR PLAN



Tony DeFrancis

Corporate Managing Director

+1 949 706 6589

tdefrancis@savills.us

The information contained in this communication has been obtained from a variety of sources believed to be reliable but has not been verified. NO WARRANTY OR REPRESENTATION, EXPRESS OR IMPLIED, IS MADE AS TO THE CONDITION OF THE PROPERTY OR ACCURACY OR COMPLETENESS OF THE INFORMATION CONTAINED HEREIN AND SAME IS SUBMITTED SUBJECT TO ERRORS, OMISSIONS, CHANGE OF PRICE, RENTAL OR OTHER CONDITIONS, WITHDRAWAL WITHOUT NOTICE AND TO ANY SPECIFIC CONDITIONS IMPOSED BY THE PROPERTY OWNER OR LESSOR.

2ND FLOOR - FLOOR PLAN

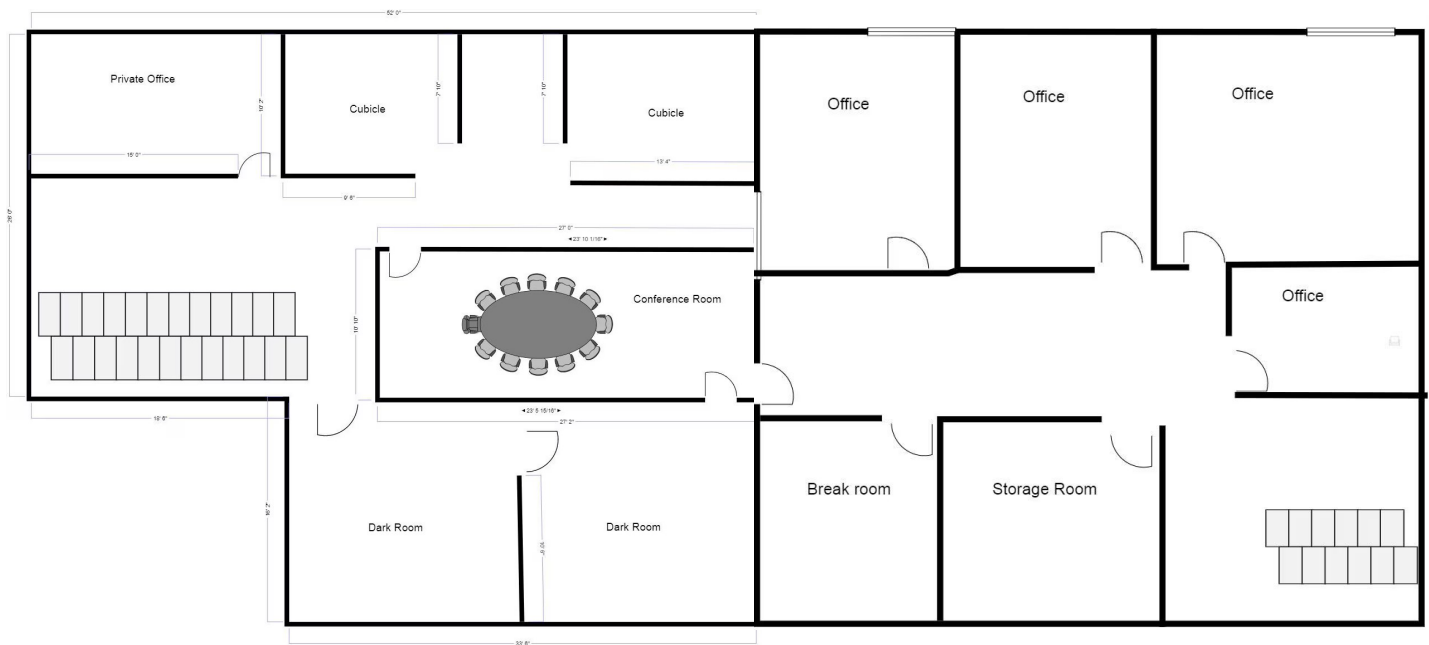

Tony DeFrancis

Corporate Managing Director

+1 949 706 6589

tdefrancis@savills.us

The information contained in this communication has been obtained from a variety of sources believed to be reliable but has not been verified. NO WARRANTY OR REPRESENTATION, EXPRESS OR IMPLIED, IS MADE AS TO THE CONDITION OF THE PROPERTY OR ACCURACY OR COMPLETENESS OF THE INFORMATION CONTAINED HEREIN AND SAME IS SUBMITTED SUBJECT TO ERRORS, OMISSIONS, CHANGE OF PRICE, RENTAL OR OTHER CONDITIONS, WITHDRAWAL WITHOUT NOTICE AND TO ANY SPECIFIC CONDITIONS IMPOSED BY THE PROPERTY OWNER OR LESSOR.











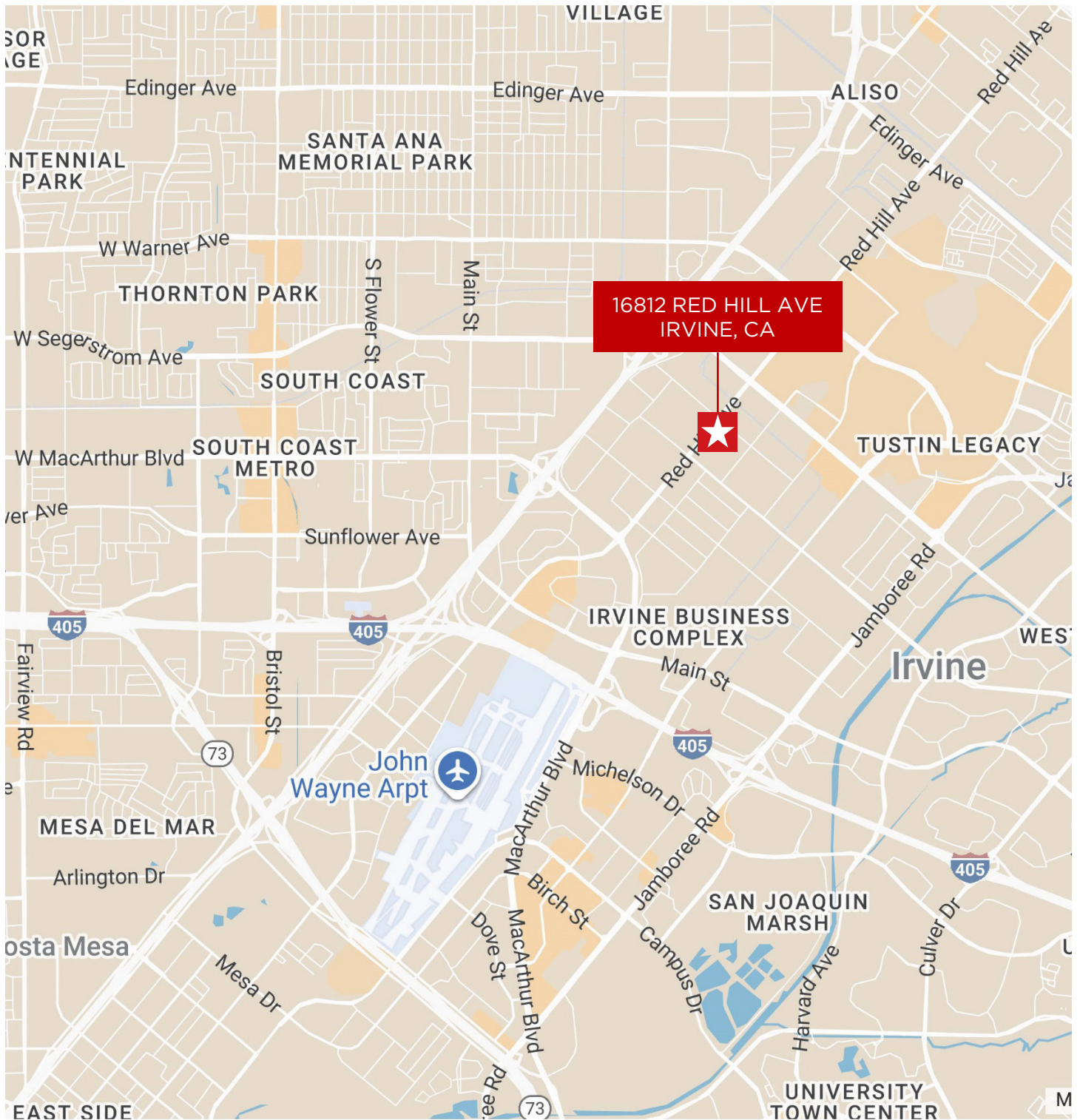

Tony DeFrancis

Corporate Managing Director

+1 949 706 6589

tdefrancis@savills.us



The information contained in this communication has been obtained from a variety of sources believed to be reliable but has not been verified. NO WARRANTY OR REPRESENTATION, EXPRESS OR IMPLIED, IS MADE AS TO THE CONDITION OF THE PROPERTY OR ACCURACY OR COMPLETENESS OF THE INFORMATION CONTAINED HEREIN AND SAME IS SUBMITTED SUBJECT TO ERRORS, OMISSIONS, CHANGE OF PRICE, RENTAL OR OTHER CONDITIONS, WITHDRAWAL WITHOUT NOTICE AND TO ANY SPECIFIC CONDITIONS IMPOSED BY THE PROPERTY OWNER OR LESSOR.

Tony DeFrancis

Corporate Managing Director

+1 949 706 6589

tdefrancis@savills.us

The information contained in this communication has been obtained from a variety of sources believed to be reliable but has not been verified. NO WARRANTY OR REPRESENTATION, EXPRESS OR IMPLIED, IS MADE AS TO THE CONDITION OF THE PROPERTY OR ACCURACY OR COMPLETENESS OF THE INFORMATION CONTAINED HEREIN AND SAME IS SUBMITTED SUBJECT TO ERRORS, OMISSIONS, CHANGE OF PRICE, RENTAL OR OTHER CONDITIONS, WITHDRAWAL WITHOUT NOTICE AND TO ANY SPECIFIC CONDITIONS IMPOSED BY THE PROPERTY OWNER OR LESSOR.