

FOR SALE
RETAIL PROPERTY



2929 Plummer Cove Rd., Suite 2
Jacksonville, FL 32223

IFLY GROUND LEASE

10579 BRIGHTMAN BLVD
JACKSONVILLE, FL 32246

AMANDA KINKADE
904.635.6376
amanda@kinkadecommercial.com

FOR SALE

TABLE OF CONTENTS



2929 Plummer Cove Rd., Suite 2
Jacksonville, FL 32223

iFly Ground Lease - 10579 Brightman Blvd Jacksonville, FL 32246

PROPERTY INFORMATION	3
LOCATION INFORMATION	8
FINANCIAL ANALYSIS	13
DEMOGRAPHICS	15

CONFIDENTIALITY & DISCLAIMER

All materials and information received or derived from Kinkade Commercial Real Estate its directors, officers, agents, advisors, affiliates and/or any third party sources are provided without representation or warranty as to completeness, veracity, or accuracy, condition of the property, compliance or lack of compliance with applicable governmental requirements, developability or suitability, financial performance of the property, projected financial performance of the property for any party's intended use or any and all other matters.

Neither Kinkade Commercial Real Estate its directors, officers, agents, advisors, or affiliates makes any representation or warranty, express or implied, as to accuracy or completeness of the any materials or information provided, derived, or received. Materials and information from any source, whether written or verbal, that may be furnished for review are not a substitute for a party's active conduct of its own due diligence to determine these and other matters of significance to such party. Kinkade Commercial Real Estate will not investigate or verify any such matters or conduct due diligence for a party unless otherwise agreed in writing.

EACH PARTY SHALL CONDUCT ITS OWN INDEPENDENT INVESTIGATION AND DUE DILIGENCE.

Any party contemplating or under contract or in escrow for a transaction is urged to verify all information and to conduct their own inspections and investigations including through appropriate third party independent professionals selected by such party. All financial data should be verified by the party including by obtaining and reading applicable documents and reports and consulting appropriate independent professionals. Kinkade Commercial Real Estate makes no warranties and/or representations regarding the veracity, completeness, or relevance of any financial data or assumptions. Kinkade Commercial Real Estate does not serve as a financial advisor to any party regarding any proposed transaction. All data and assumptions regarding financial performance, including that used for financial modeling purposes, may differ from actual data or performance. Any estimates of market rents and/or projected rents that may be provided to a party do not necessarily mean that rents can be established at or increased to that level. Parties must evaluate any applicable contractual and governmental limitations as well as market conditions, vacancy factors and other issues in order to determine rents from or for the property.

Legal questions should be discussed by the party with an attorney. Tax questions should be discussed by the party with a certified public accountant or tax attorney. Title questions should be discussed by the party with a title officer or attorney. Questions regarding the condition of the property and whether the property complies with applicable governmental requirements should be discussed by the party with appropriate engineers, architects, contractors, other consultants and governmental agencies. All properties and services are marketed by Kinkade Commercial Real Estate in compliance with all applicable fair housing and equal opportunity laws.

PRESENTED BY:

AMANDA KINKADE

904.635.6376

amanda@kinkadecommercial.com

FOR SALE

RETAIL PROPERTY



2929 Plummer Cove Rd., Suite 2
Jacksonville, FL 32223

J. Turner Butler

ST JOHNS
TOWN CENTER
A SIMON MALL

10579 Brightman Blvd.
1.14 acres, 7,513[±] sq. ft.
PUD Zoning



PROPERTY INFORMATION



Traffic Count: 113,000 AADT

FOR SALE

EXECUTIVE SUMMARY

iFly Ground Lease - 10579 Brightman Blvd., Jacksonville, FL 32246



OFFERING SUMMARY

Sale Price:	\$4,495,000
Building Size:	7,513 SF
Lot Size:	1.14 Acres
Price / SF:	\$90.52
Cap Rate:	5%
NOI:	\$222,200
Zoning:	PUD

PROPERTY OVERVIEW

For Sale is a 50 year absolute NNN ground lease available in the heart of Jacksonville's Southside shopping and dining district. iFLY occupies on the main subject property with a building size of 7,513 +/-SF which sits on 1.05 +/- acres. There is an adjacent .09+/- acres parcel that is also on a 50 year NNN Lease which is utilized for parking by the Holiday Inn Express owner. Both leases increase 10% every five years(5) years. RE#'s 1677280160 and 1677280155.

This is an absolute triple-net ground lease with zero Landlord responsibilities.

PROPERTY HIGHLIGHTS

- Longterm NNN Lease
- 5% Cap Rate
- Jacksonville's Town Center
- Excellent exposure along I-295
- Traffic counts 113,000 AADT

PRESENTED BY:

AMANDA KINKADE

904.635.6376

amanda@kinkadecommercial.com

FOR SALE

PROPERTY DESCRIPTION

iFly Ground Lease - 10579 Brightman Blvd., Jacksonville, FL 32246



PROPERTY DESCRIPTION

For Sale is a 50 year absolute NNN ground lease available in the heart of Jacksonville's Southside shopping and dining district. iFLY occupies on the main subject property with a building size of 7,513 +/-SF which sits on 1.05 +/- acres. There is an adjacent .09+/- acres parcel that is also on a 50 year NNN Lease which is utilized for parking by the Holiday Inn Express owner. Both leases increase every five years(5) years.

RE#'s 1677280160 and 1677280155.

This is an absolute triple-net ground lease with zero Landlord responsibilities.

LOCATION DESCRIPTION

Located in Town Center Jacksonville, FL within heart of outdoor shopping and dining. Less than 15 miles from Jacksonville's Beaches, and about 14 miles from Jacksonville's Downtown, and 25 miles from JAX (Jacksonville International Airport).

PRESENTED BY:

AMANDA KINKADE

904.635.6376

amanda@kinkadecommercial.com

FOR SALE

COMPLETE HIGHLIGHTS

iFly Ground Lease - 10579 Brightman Blvd., Jacksonville, FL 32246



PROPERTY HIGHLIGHTS

- Longterm NNN Lease
- 5% Cap Rate
- Jacksonville's Town Center
- Excellent exposure along I-295
- Traffic counts 113,000 AADT



PRESENTED BY:

AMANDA KINKADE

904.635.6376

amanda@kinkadecommercial.com

FOR SALE

ADDITIONAL PHOTOS

iFly Ground Lease - 10579 Brightman Blvd., Jacksonville, FL 32246



PRESENTED BY:

AMANDA KINKADE

904.635.6376

amanda@kinkadecommercial.com

FOR SALE
RETAIL PROPERTY



2929 Plummer Cove Rd., Suite 2
Jacksonville, FL 32223



10579 Brightman Blvd.
1.14 acres, 7,513^{+/-} sq. ft.
PUD Zoning

LOCATION INFORMATION



Count: 113,000 AADT

FOR SALE REGIONAL MAP

iFly Ground Lease • 10579 Brightman Blvd., Jacksonville, FL 32246

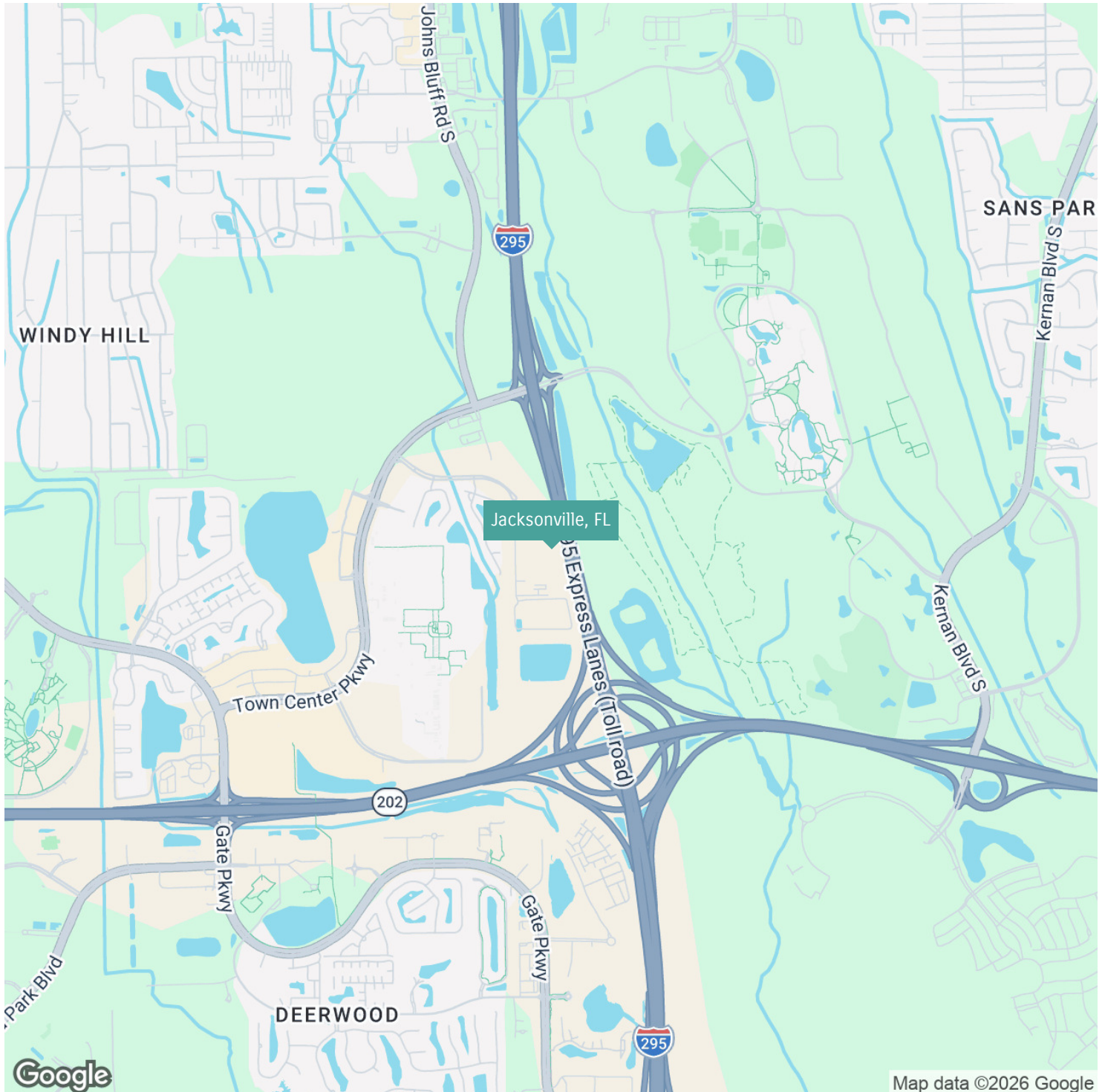

PRESENTED BY:

AMANDA KINKADE

904.635.6376

amanda@kinkadecommercial.com

FOR SALE LOCATION MAP

iFly Ground Lease • 10579 Brightman Blvd., Jacksonville, FL 32246



PRESENTED BY:

AMANDA KINKADE

904.635.6376

amanda@kinkadecommercial.com

FOR SALE AERIAL MAP

iFly Ground Lease - 10579 Brightman Blvd., Jacksonville, FL 32246

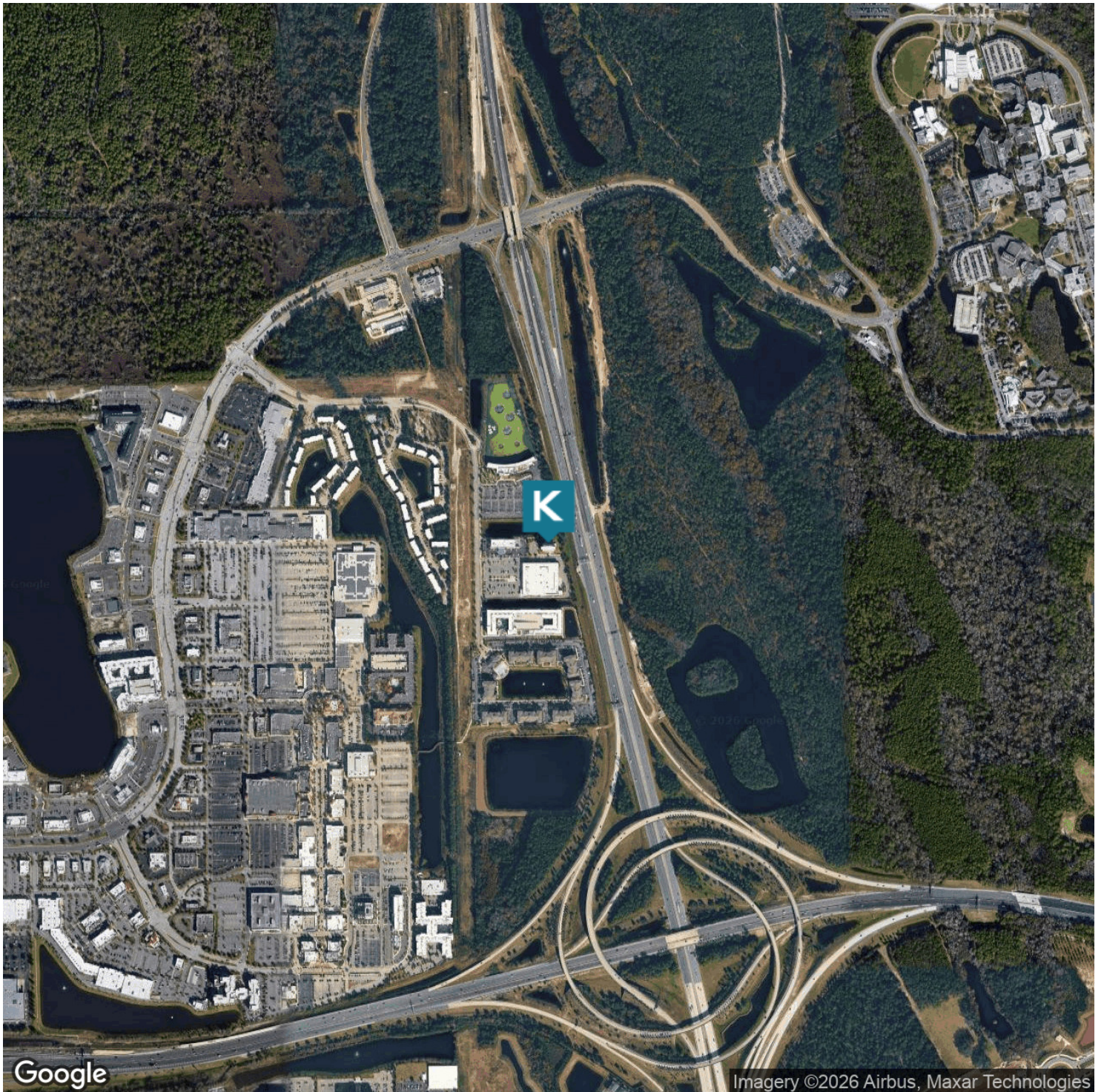

PRESENTED BY:

AMANDA KINKADE

904.635.6376

amanda@kinkadecommercial.com

FOR SALE SITE PLANS

iFly Ground Lease • 10579 Brightman Blvd., Jacksonville, FL 32246

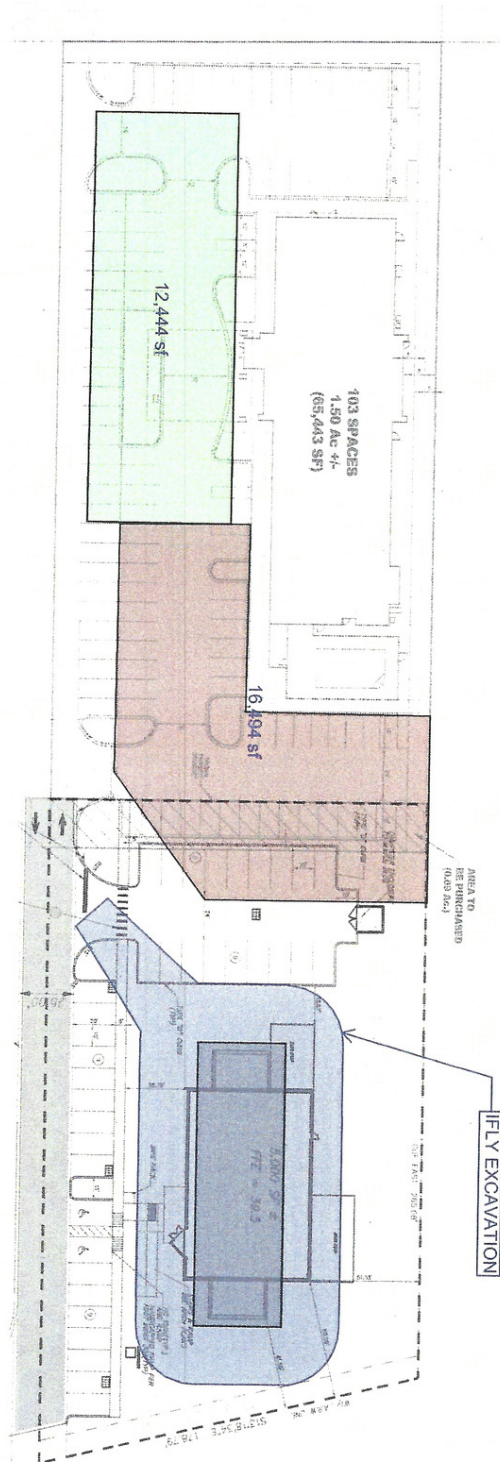

PRESENTED BY:

AMANDA KINKADE

904.635.6376

amanda@kinkadecommercial.com

FOR SALE

RETAIL PROPERTY



2929 Plummer Cove Rd., Suite 2
Jacksonville, FL 32223

ST JOHNS
TOWN CENTER
A SIMON MALL

10579 Brightman Blvd.
1.14 acres, 7,513^{+/-} sq. ft.
PUD Zoning

FINANCIAL ANALYSIS

INTERSTATE

295

Count: 113,000 AADT

FOR SALE

FINANCIAL SUMMARY



2929 Plummer Cove Rd., Suite 2
Jacksonville, FL 32223

iFly Ground Lease - 10579 Brightman Blvd., Jacksonville, FL 32246

INVESTMENT OVERVIEW	IFLY GROUND LEASE
Price	\$4,495,000
Price per SF	\$91
Price per Unit	\$4,495,000
CAP Rate	5%
Cash-on-Cash Return (yr 1)	5%
Total Return (yr 1)	\$222,200

OPERATING DATA	IFLY GROUND LEASE
Net Operating Income	\$222,200
Pre-Tax Cash Flow	\$222,200

FINANCING DATA	IFLY GROUND LEASE
Down Payment	\$4,495,000

PRESENTED BY:

AMANDA KINKADE

904.635.6376

amanda@kinkadecommercial.com

CONFIDENTIAL OFFERING MEMORANDUM

FOR SALE

RETAIL PROPERTY



2929 Plummer Cove Rd., Suite 2
Jacksonville, FL 32223

ST JOHNS
TOWN CENTER
A SIMON MALL

10579 Brightman Blvd.
1.14 acres, 7,513^{+/-} sq. ft.
PUD Zoning

DEMOGRAPHICS



Count: 113,000 AADT

FOR SALE

DEMOGRAPHICS MAP & REPORT

iFly Ground Lease • 10579 Brightman Blvd., Jacksonville, FL 32246

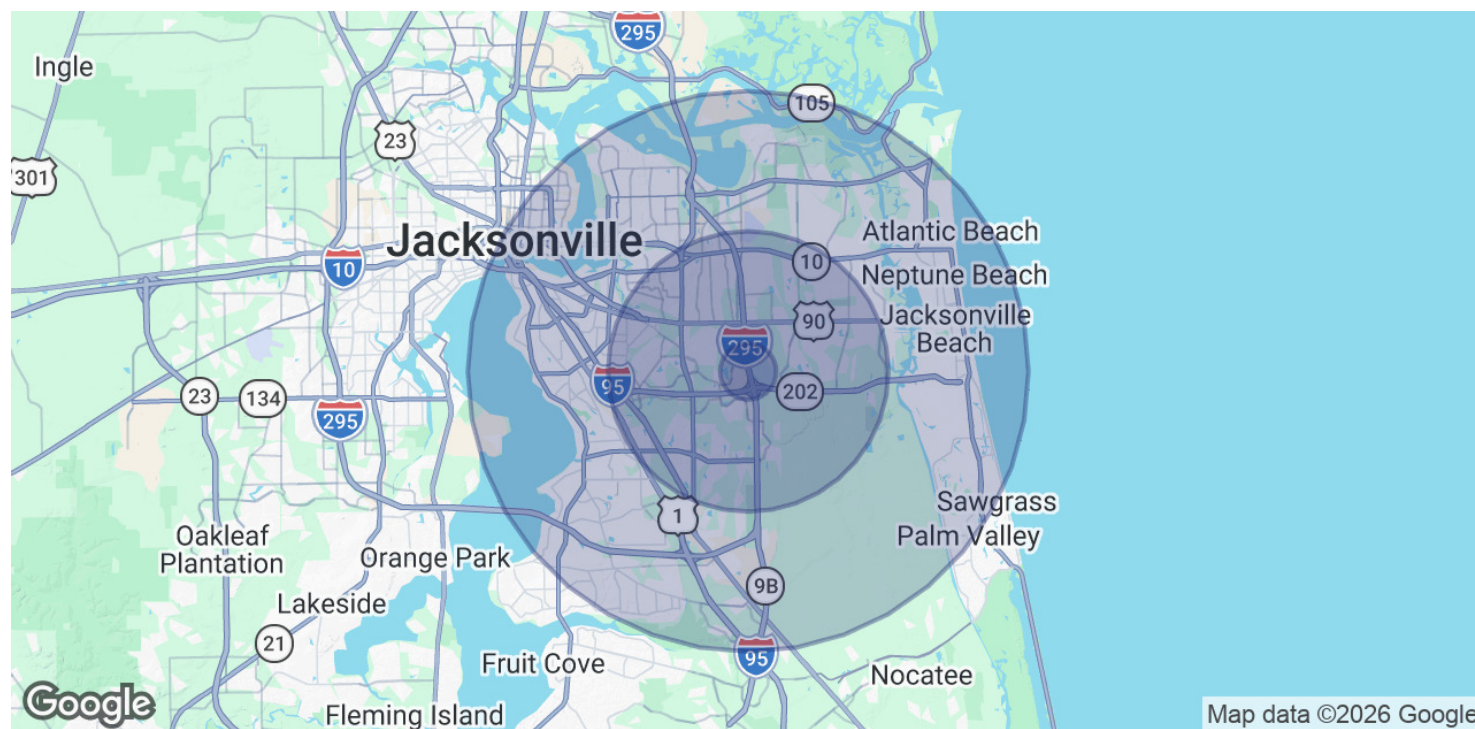

POPULATION	1 MILE	5 MILES	10 MILES
Total Population	5,535	169,892	541,570
Average Age	27.8	35.7	38.3
Average Age (Male)	26.9	35.2	37.3
Average Age (Female)	29.9	36.2	39.4
HOUSEHOLDS & INCOME	1 MILE	5 MILES	10 MILES
Total Households	2,548	76,203	241,429
# of Persons per HH	2.2	2.2	2.2
Average HH Income	\$72,579	\$76,685	\$81,073
Average House Value	\$178,069	\$199,005	\$246,856

2020 American Community Survey (ACS)

PRESENTED BY:

AMANDA KINKADE

904.635.6376

amanda@kinkadecommercial.com