

AVAILABLE FOR LEASE
599 EDGEWOOD AVENUE
WOOD DALE, ILLINOIS

MAKE-READY WORK UNDERWAY



LISTING SPECIFICATIONS:

BUILDING SIZE:	21,728 SF
AVAILABLE SPACE:	2,741 SF
OFFICE:	1,461 SF
WAREHOUSE:	1,280 SF
CLEAR HEIGHT:	14'
LOADING:	1 drive-in door
PARKING:	6 spaces
OCCUPANCY:	Immediate
LEASE RATE:	Subject to Offer
COMMENTS:	<ul style="list-style-type: none">› Prime location within O'Hare submarket› Flexible layout› Easy access to I-390› Institutionally owned & managed

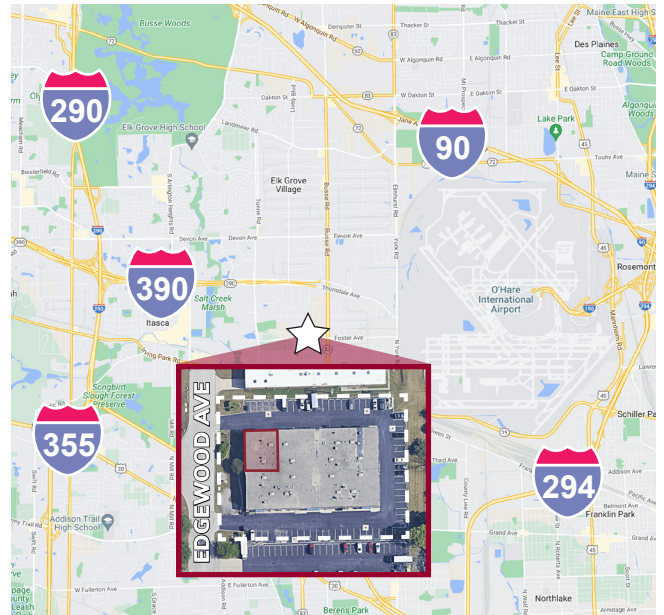

John M. Joyce
Senior Associate
jjoyce@lee-associates.com
D 773.355.3021



All information furnished regarding property for sale, rental or financing is from sources deemed reliable, but no warranty or representation is made to the accuracy thereof and same is submitted to errors, omissions, change of price, rental or other conditions prior to sale, lease or financing or withdrawal without notice. No liability of any kind is to be imposed on the broker herein.

AVAILABLE FOR LEASE
599 EDGEWOOD AVENUE
WOOD DALE, ILLINOIS

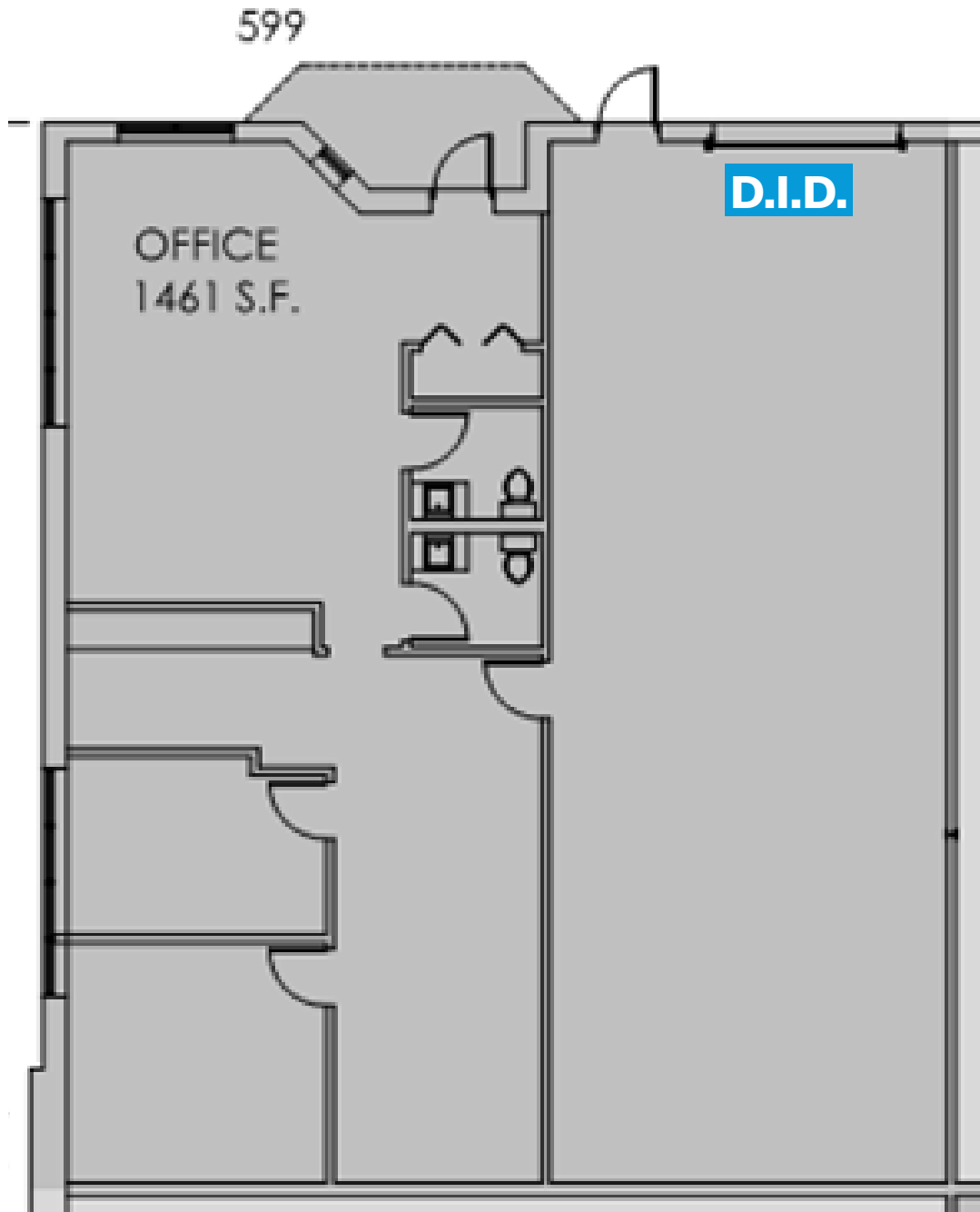

John M. Joyce
Senior Associate
jjoyce@lee-associates.com
D 773.355.3021

DRA
ADVISORS

All information furnished regarding property for sale, rental or financing is from sources deemed reliable, but no warranty or representation is made to the accuracy thereof and same is submitted to errors, omissions, change of price, rental or other conditions prior to sale, lease or financing or withdrawal without notice. No liability of any kind is to be imposed on the broker herein.