



Site Location:  
3100 NW 131st St  
Opa-Locka, FL 33054



# OUTDOOR STORAGE AVAILABLE FOR LEASE

**+/- 1.51 ACRES**  
I-2 Industrial Zoning

**Pat McBride, Esq.**  
pmcbride@comreal.com  
305-619-2937

**Chris Spear, SIOR, CCIM**  
cspear@comreal.com  
(305) 807-7662

Owned & Managed By



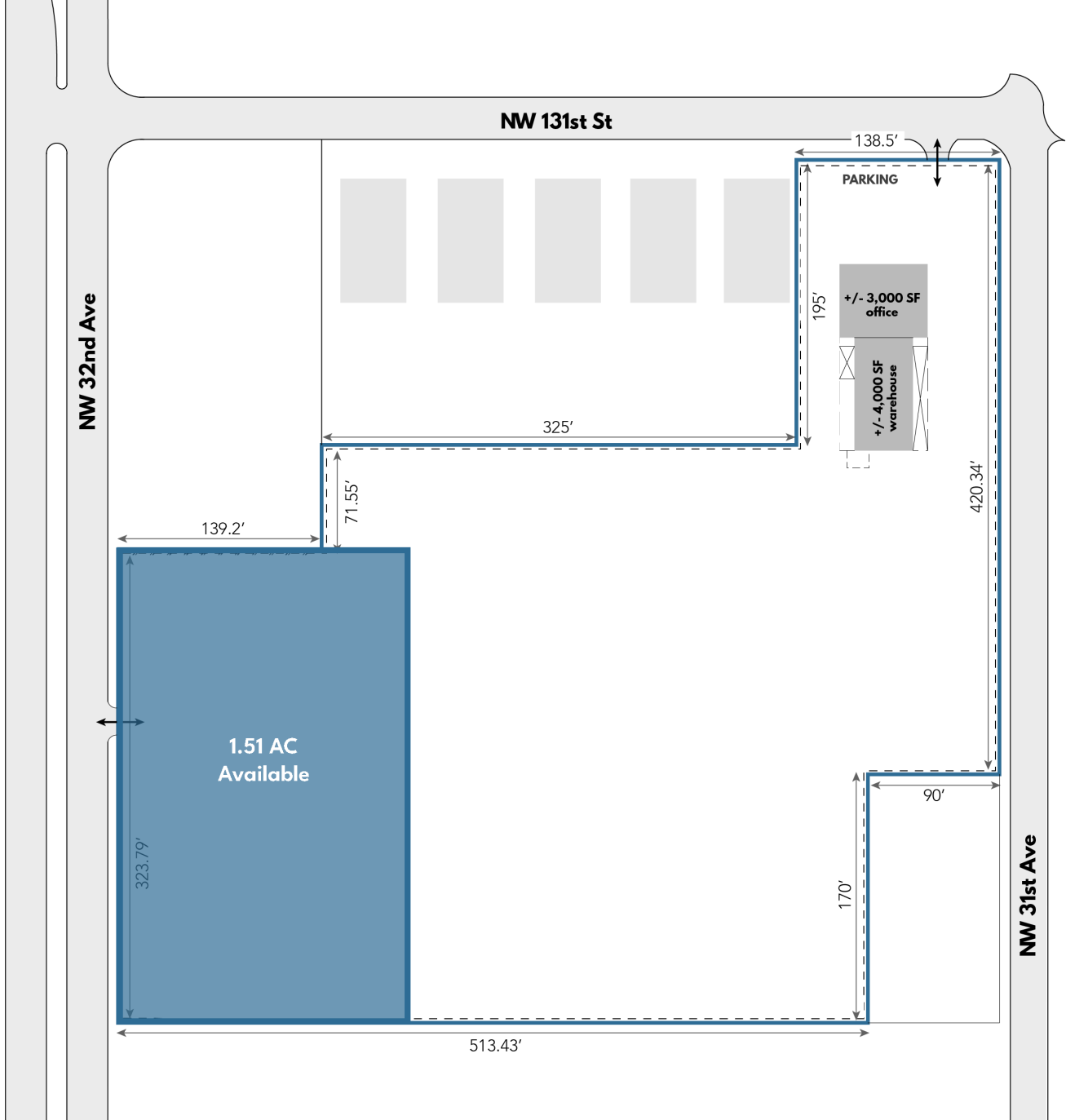

# PROPERTY OVERVIEW

- **1.51 Acres - Fenced, and Lit**
- **Ideal Uses:** Truck/Trailer Parking, Container Storage, Outdoor Storage
- **Zoning:** I-2 Industrial
- This location not only provides excellent access to major expressways but also positions the future tenant to be neighbors with: Amazon, Carnival, Winn-Dixie, Caterpillar, United Rentals, Copart, Gordon Food Services and others.
- **Lease Rate:** Inquire

**National Highway Freight Network**

- PHFS (Primary Highway Freight System)
- Non-PHFS Interstates
- Connectors
- Connector Pending FHWA Approval
- Other Roads

BROWARD COUNTY

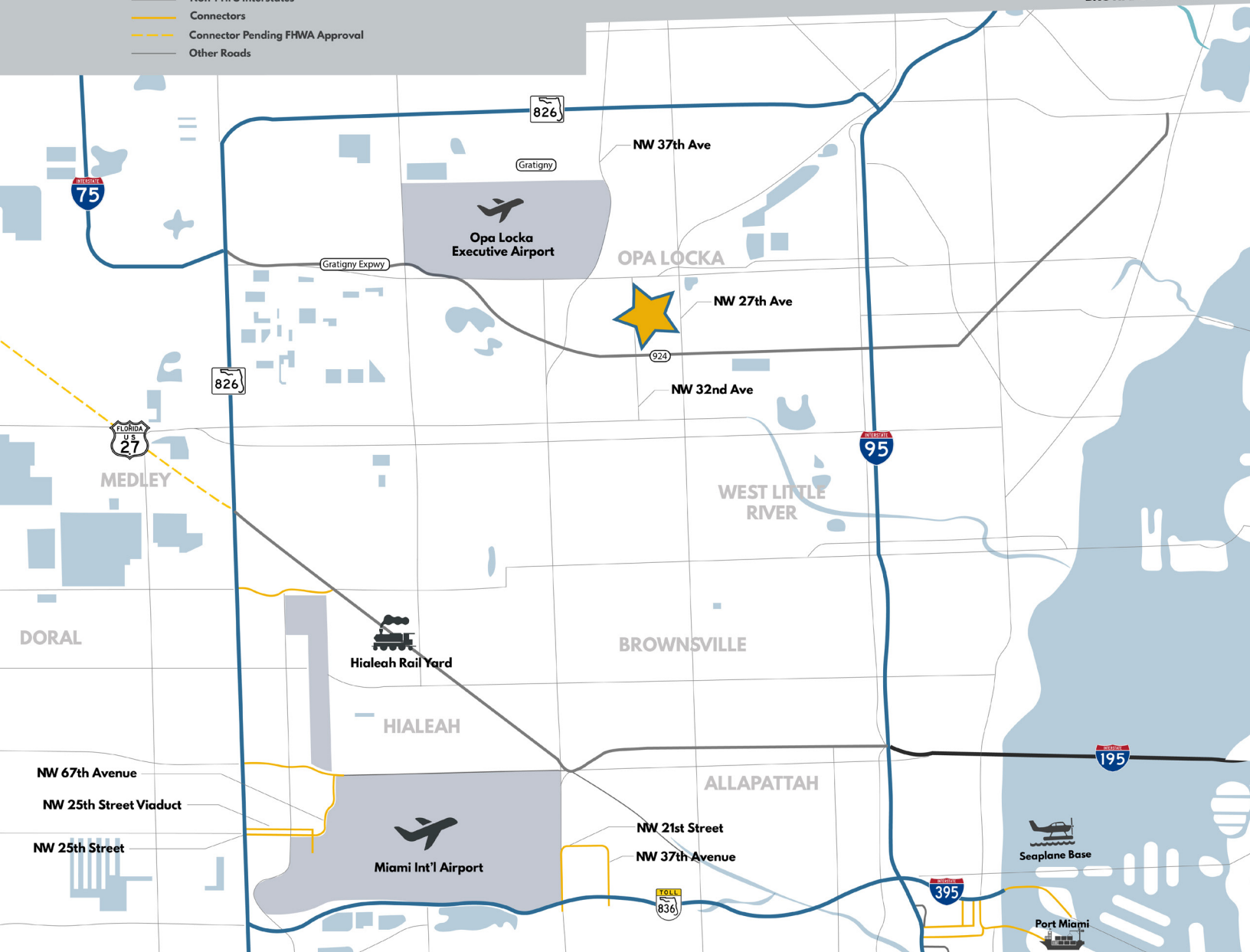

# PROPERTY LOCATION

## DISTANCE TO:

NW 119th St (Gratigny)	0.8 mi
Palmetto Expwy	2.0 mi
I-95	3.0 mi
Miami Int'l Airport	9.5 mi
Port Miami	12.2 mi
Port Everglades	20.4 mi



Owned and Managed by:



Broker:  
**Chris Spear**  
cspear@comreal.com  
(305) 807-7662

Broker:  
**Pat McBride**  
pmcbride@comreal.com  
(305) 619-2937

**ComReal Miami - Doral, LLC**

3470 NW 82nd Ave, Suite 605

Doral, FL 33122