



## AVAILABLE NEW CONSTRUCTION – 156,177 SF

1501 Mittel Blvd., Wood Dale, IL

### Contact us:

**Matthew Stauber, SIOR**

Vice Chair

847 698 8236

matthew.stauber@colliers.com

**Thomas Rodeno**

Vice Chair

847 698 8231

tom.rodno@colliers.com

**Patrick Turner**

Executive Vice President

847 698 8277

patrick.turner@colliers.com

**Caroline Atout**

Transaction Manager

847 698 8297

caroline.atout@colliers.com

Colliers

6250 N. River Rd. | Suite 11-100

Rosemont, IL 60018

www.colliers.com/chicago

### Property Highlights

- Available Size: 156,177 SF (divisible)
- Site Size: 8.2 acres
- Office Size: To suit, spec office available
- Ceiling Height: 36' clear
- Loading: 16 exterior docks (expandable to 30), 2 drive-in doors
- Car Parking: 155 spaces
- Sprinkler System: ESFR
- Sale Price: Subject to Offer
- Lease Rate: Subject to Offer
- Available Q2 2027
- Excellent location, near York Road and Route 83
- Easy access to I-90, I-290, I-355
- Minutes from O'Hare International Airport
- Low DuPage County taxes

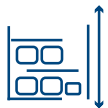
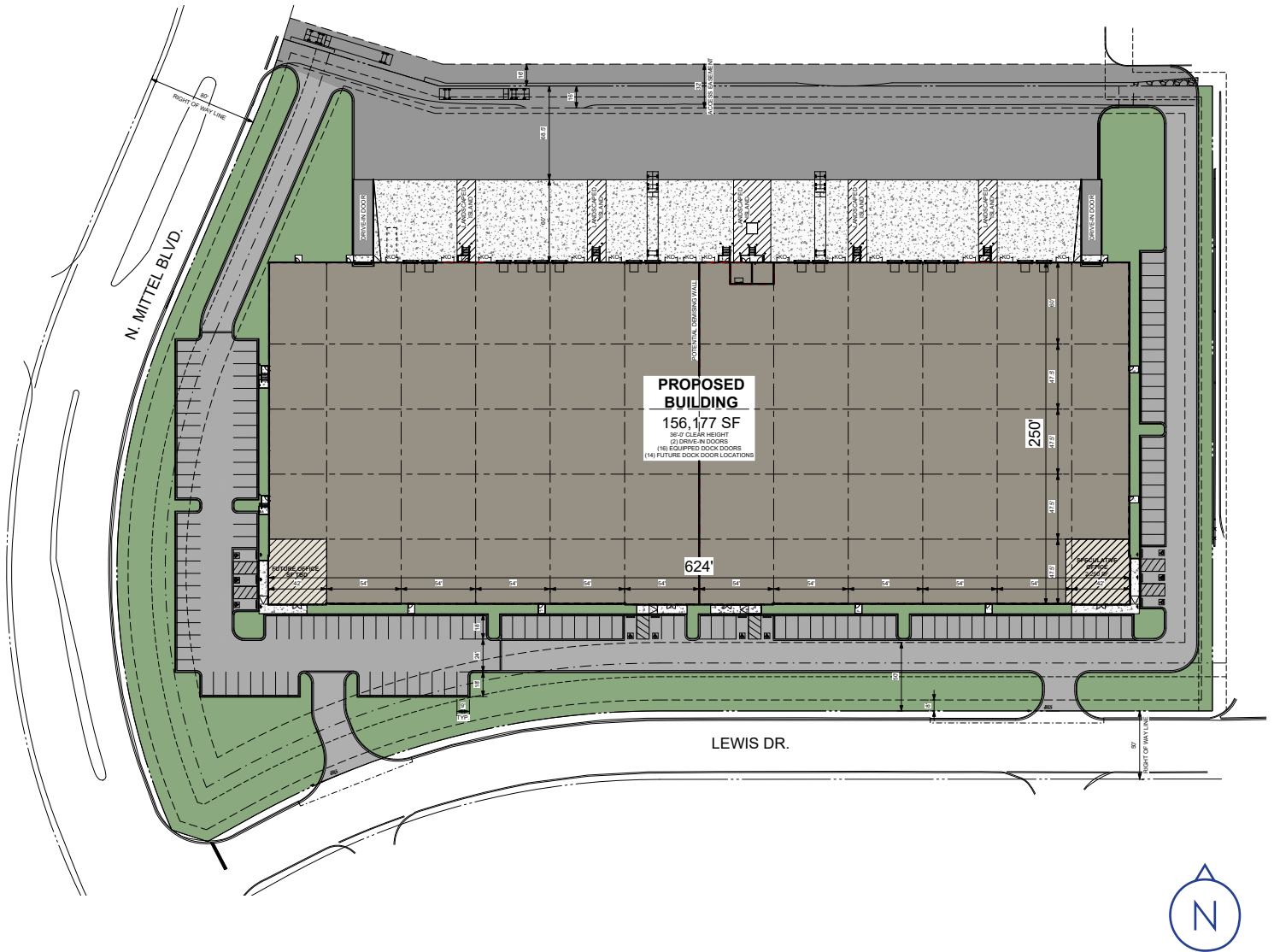

**36' CLEAR HEIGHT**



**155 CAR PARKING**



**OFFICE TO SUIT**



**16 EXTERIOR DOCKS**  
(expandable to 30)  
**2 DRIVE-IN DOORS**

**Matthew Stauber, SIOR**  
Vice Chair  
+1 847 698 8236  
matthew.stauber@colliers.com

**Thomas Rodeno**  
Vice Chair  
+1 847 698 8231  
tom.rodeno@colliers.com

**Patrick Turner**  
Executive Vice President  
+1 847 698 8277  
patrick.turner@colliers.com

**Caroline Atout**  
Transaction Manager  
+1 847 698 8297  
caroline.atout@colliers.com

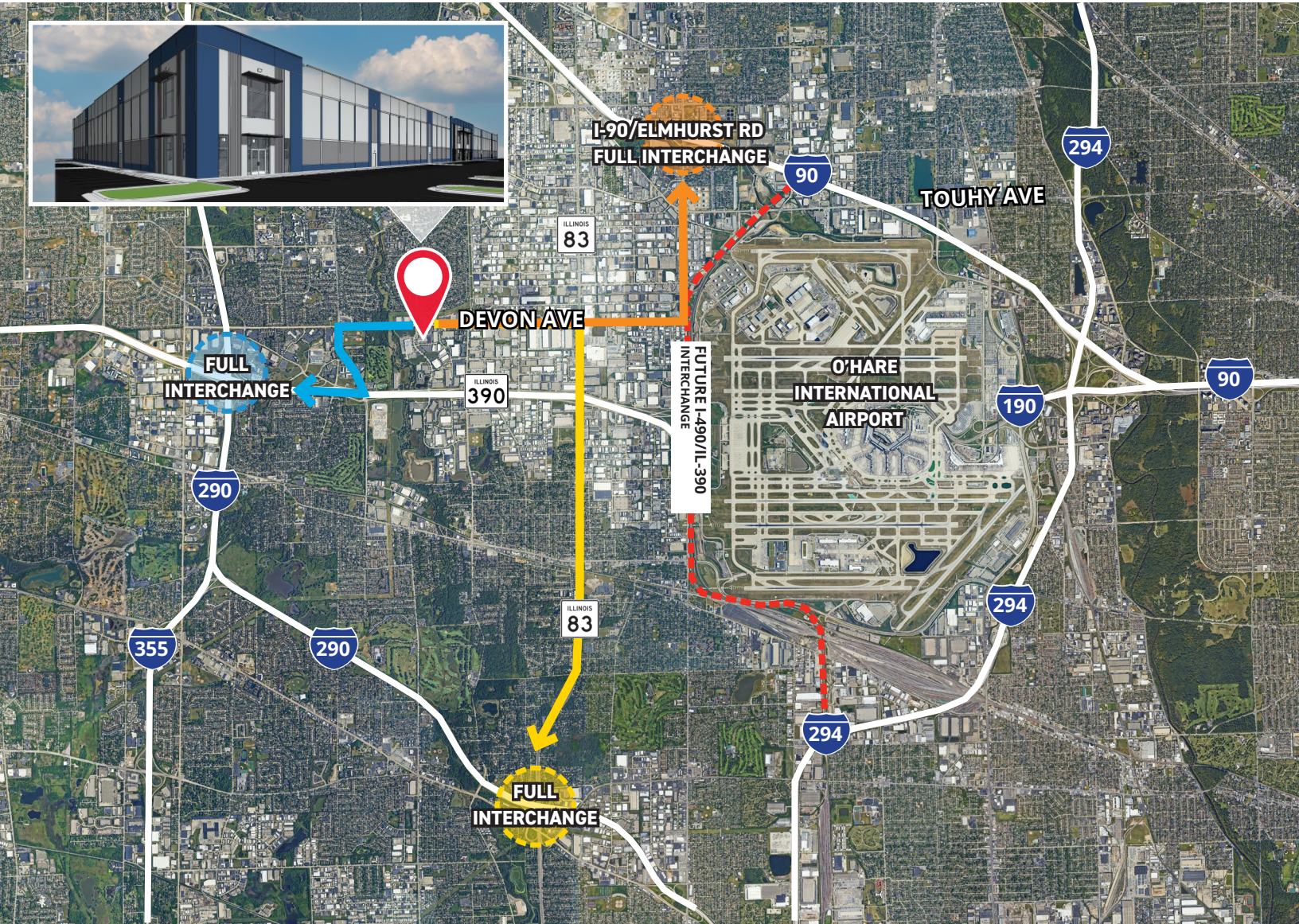

**Matthew Stauber, SIOR**  
Vice Chair  
+1 847 698 8236  
matthew.stauber@colliers.com

**Thomas Rodeno**  
Vice Chair  
+1 847 698 8231  
tom.rodeno@colliers.com

**Patrick Turner**  
Executive Vice President  
+1 847 698 8277  
patrick.turner@colliers.com

**Caroline Atout**  
Transaction Manager  
+1 847 698 8297  
caroline.atout@colliers.com