

6%

Co-operating
Broker Fee*

RenCorpRealty^{AD}



Centrally
Located

Renovated

Bar/Restaurant

TURN KEY BAR/RESTAURANT NOW LEASING

RENTAL RATES

\$17.25/RSF (\$3,300/mo)

Modified Gross*

*Tenant Pays Electricity

SPACE AVAILABLE

2,297 RSF

THE HISTORIC HOLLEY MASON

157 S Howard St, Suite 100, Spokane WA 99201

NEIGHBORHOOD

The Holley-Mason Building is an important Spokane landmark that is beautifully executed with Renaissance-inspired brick and terra cotta details.

AMENITIES

- ✓ One of a Kind Outdoor Patio & Bar with Fireplace
- ✓ FF&E Available
- ✓ Parking Validation System in Place
- ✓ Basement Cold & Dry Storage Available

Information is deemed reliable but not guaranteed. Broker not responsible for changes errors or commissions. All square footages are for conveniences only. All information should be verified prior to leasing or purchasing property.

*6% Co-operating Broker Fee is offered for a limited time and is based on marketed rates.

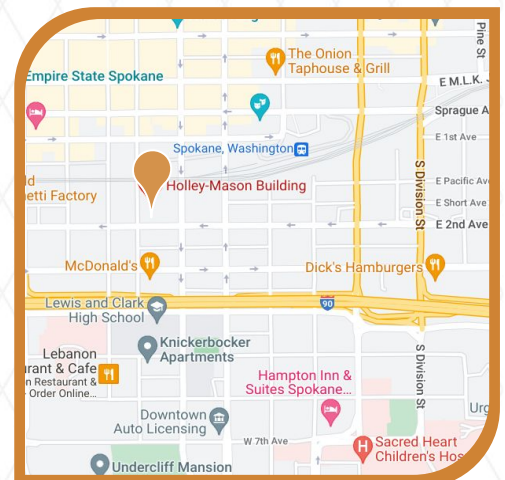

KYHRA STRAMPE
509-309-8444

JUSTIN FOLKINS
509-991-8387

CHRIS BATTEN
509-217-5508

info@rencorprealty.com
509-315-2998

FLOOR PLAN

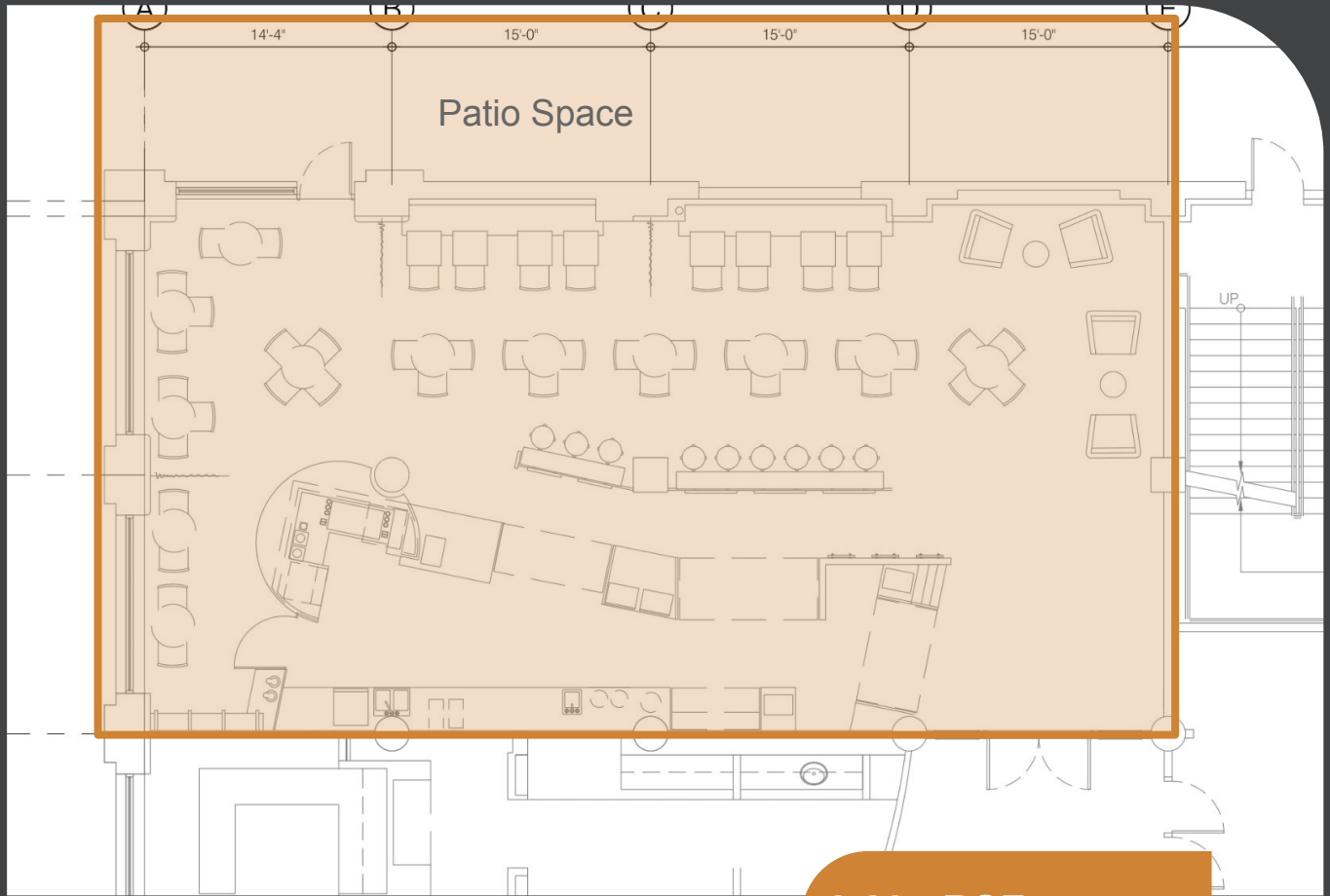

2,297 RSF
\$17.25/SF (\$3,300/mo)
Modified Gross
Heated Patio & Bar
FF&E Available
Parking Validation

Information is deemed reliable but not guaranteed. Broker not responsible for changes errors or commissions. All square footages are for conveniences only. All information should be verified prior to leasing or purchasing property.

ADDITIONAL PHOTOS



Information is deemed reliable but not guaranteed. Broker not responsible for changes errors or commissions. All square footages are for conveniences only. All information should be verified prior to leasing or purchasing property.