



## OFFICE SUITE AVAILABLE

**Suite 350**  
**4,540 SF**  
**\$16.00psf MG** (includes CAM & RE Taxes)  
**Utilities Separate**

*This fully furnished office space is available for sublease through February 2028.*

*Beautiful office on the third floor provides plenty of natural sun light. The building recently went through a remodel of it's common areas.*

### Space Highlights:

- Recently renovated
- Fully furnished office
- ADA compliant building with elevators
- Reception area
- Conference room
- Kitchen area
- Located off I-88 and Winfield Road
- Easy access to I-355 and I-294





## OFFICE SUITE AVAILABLE

**Suite 350**  
**4,540 SF**  
**\$16.00psf MG** (includes CAM & RE Taxes)  
**Utilities Separate**

*This fully furnished office space is available for sublease through February 2028.*

*Beautiful office on the third floor provides plenty of natural sun light. The building recently went through a remodel of it's common areas.*

### Space Highlights:

- Recently renovated
- Fully furnished office
- ADA compliant building with elevators
- Reception area
- Conference room
- Kitchen area
- Located off I-88 and Winfield Road
- Easy access to I-355 and I-294

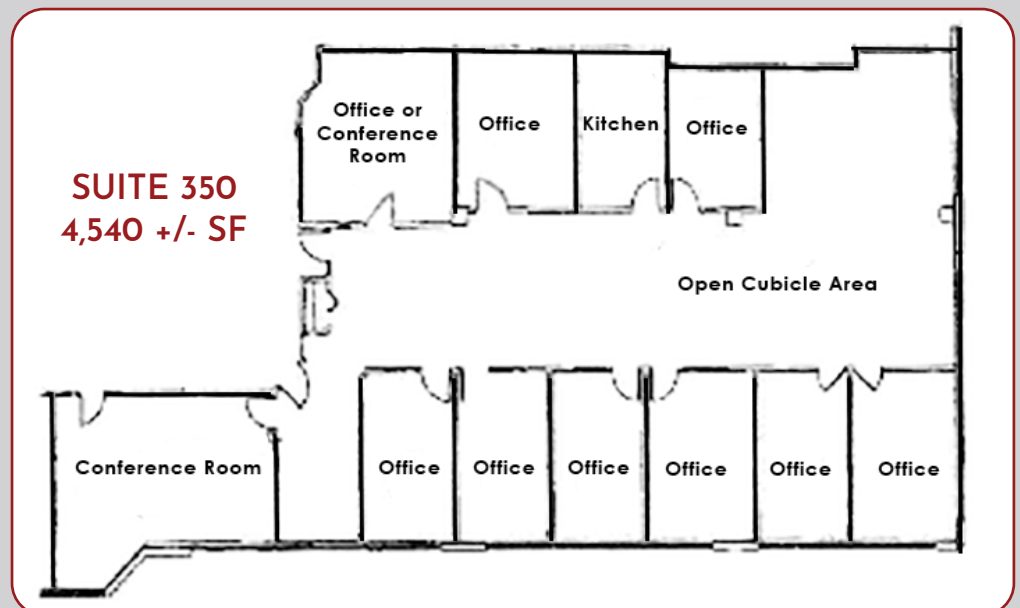

All information furnished regarding property for sale, rental or financing is from sources deemed reliable, but no warranty or representation is made to accuracy thereof and same is submitted to errors, omissions, change of price, rental or other conditions prior to sale, lease or financing or withdrawal without notice. No liability of any kind is to be imposed on the broker herein.



**Brad Schreiner**  
Managing Broker  
bschreiner@beicre.com  
630.457.1248

140 FIRST STREET, SUITE B  
BATAVIA, IL  
630.761.6589  
BEICRE.COM