

# AVAILABLE

## 25,850 SQUARE FEET

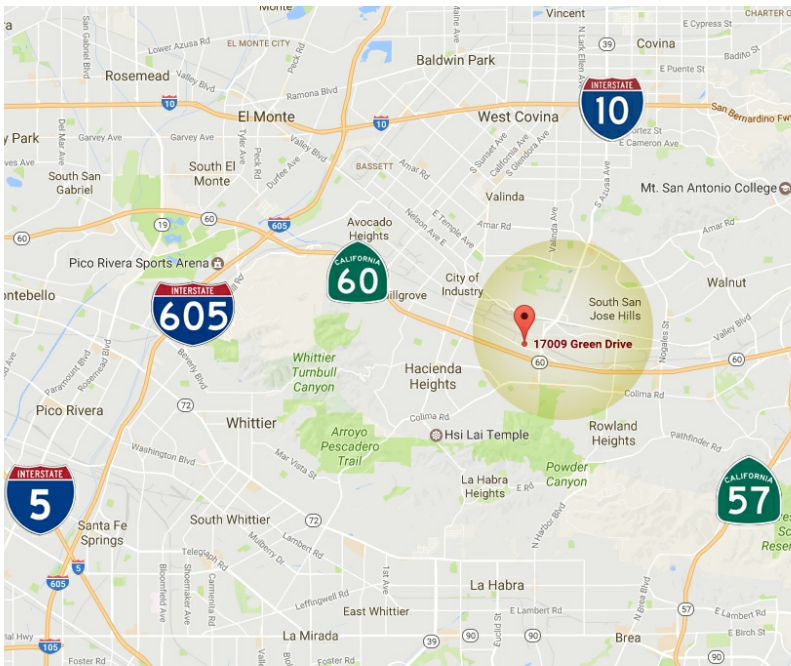

→ **17009 GREEN DRIVE, UNIT A, CITY OF INDUSTRY, CA 91745** ←



- Prime City of Industry Location
- Easy Access to FWY 60 via Azusa Avenue
- Excellent Logistics and Distribution Space
- 5 True Dock High Positions with Edge Levelers
- Deep Fenced Yard with Great Truck Turning Radius
- 22' - 24' Clearance
- Approximately 1,500 Square Feet of Office Space

 **Shan Lee / Principal**  
(M) 626-823-1580  
slee@kanderpacific.com  
CA BRE#00999585

 **Andy H. Ho / Principal**  
(M) 626-862-4488  
aho@kanderpacific.com  
CA BRE#01402736

18725 E. Gale Ave., Ste. 205  
City of Industry, CA 91748 91748

Office: 626-839-6689 | Corp. LIC#02014105  
info@kanderpacific.com | www.kanderpacific.com

# DISTRIBUTION SPACE

25,850 SQUARE FEET AVAILABLE

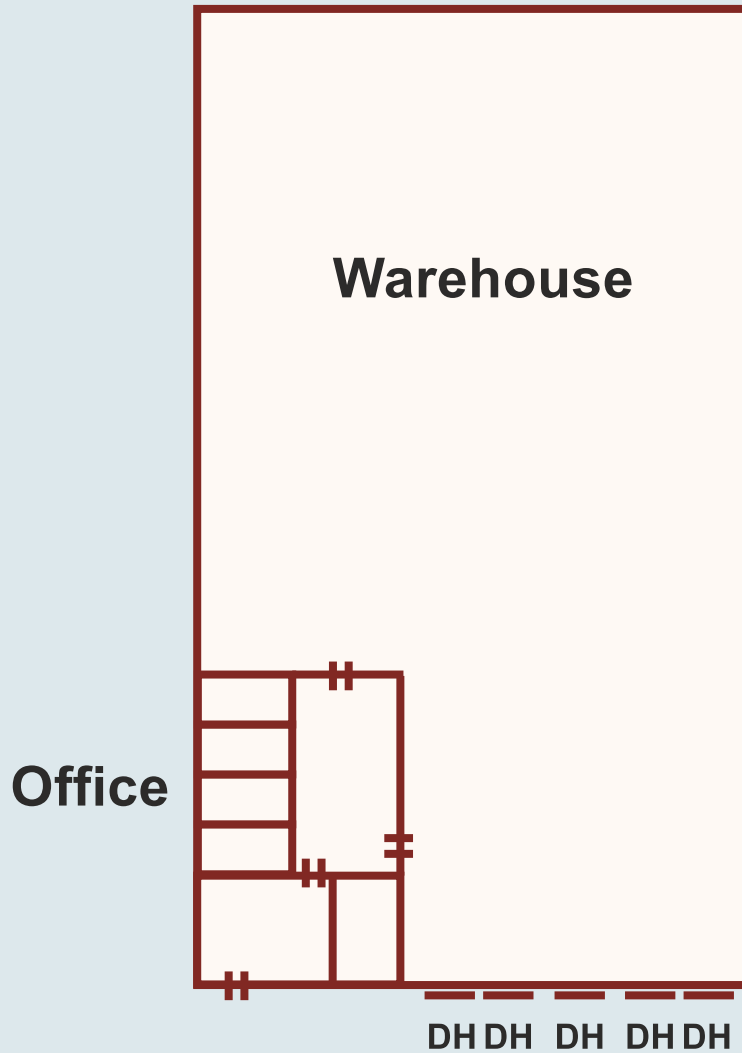

25,850 SF

 **Shan Lee / Principal**  
(M) 626-823-1580  
slee@kanderpacific.com  
CA BRE#00999585

 **Andy H. Ho / Principal**  
(M) 626-862-4488  
aho@kanderpacific.com  
CA BRE#01402736

18725 E. Gale Ave., Ste. 205  
City of Industry, CA 91748 91748

Office: 626-839-6689 | Corp. LIC#02014105  
info@kanderpacific.com | www.kanderpacific.com