

PROPERTY FOR LEASE

2700 Auburn Ct
Auburn Hills, MI 48326



PROPERTY SUMMARY



Property Highlights

- 22,760 Square Feet For Lease
- 4,500 Square Feet of Office
- 10-Ton Crane
- Exterior Truckwell
- Extremely Clean Facility

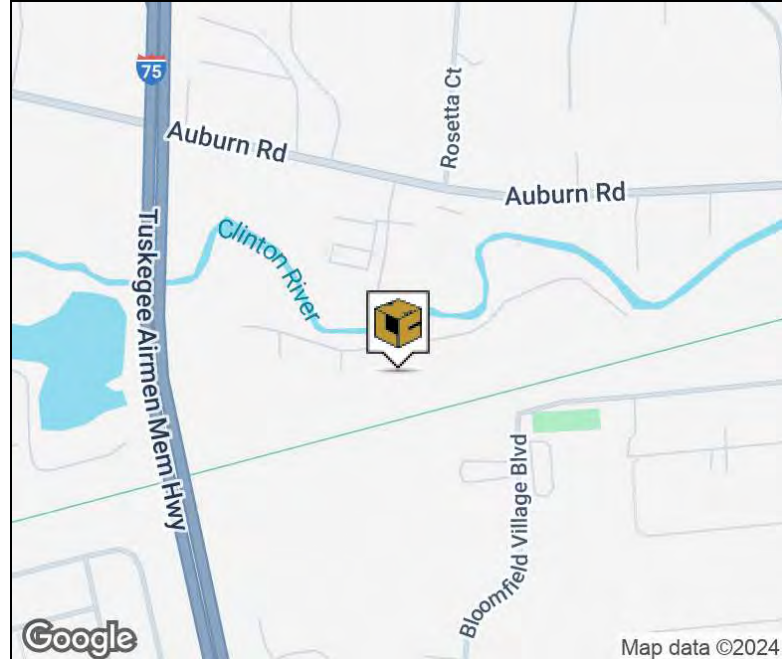

FOR MORE INFORMATION:

Jason Capitani, SIOR, CCIM
Managing Partner
248.637.7684
jcapitani@LMCap.com

Garry Rogers
Senior Vice President
248.637.3527
grogers@LMCap.com



CONNECT WITH US

248.637.9700 | www.LMCap.com

Information contained herein was obtained from sources deemed to be reliable but is not guaranteed. Subjects to prior sales, changes of price or withdrawal.

PROPERTY FOR LEASE

2700 Auburn Ct
Auburn Hills, MI 48326

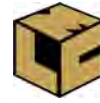

L. MASON CAPITANI
CORFAC INTERNATIONAL

LOCATION MAP

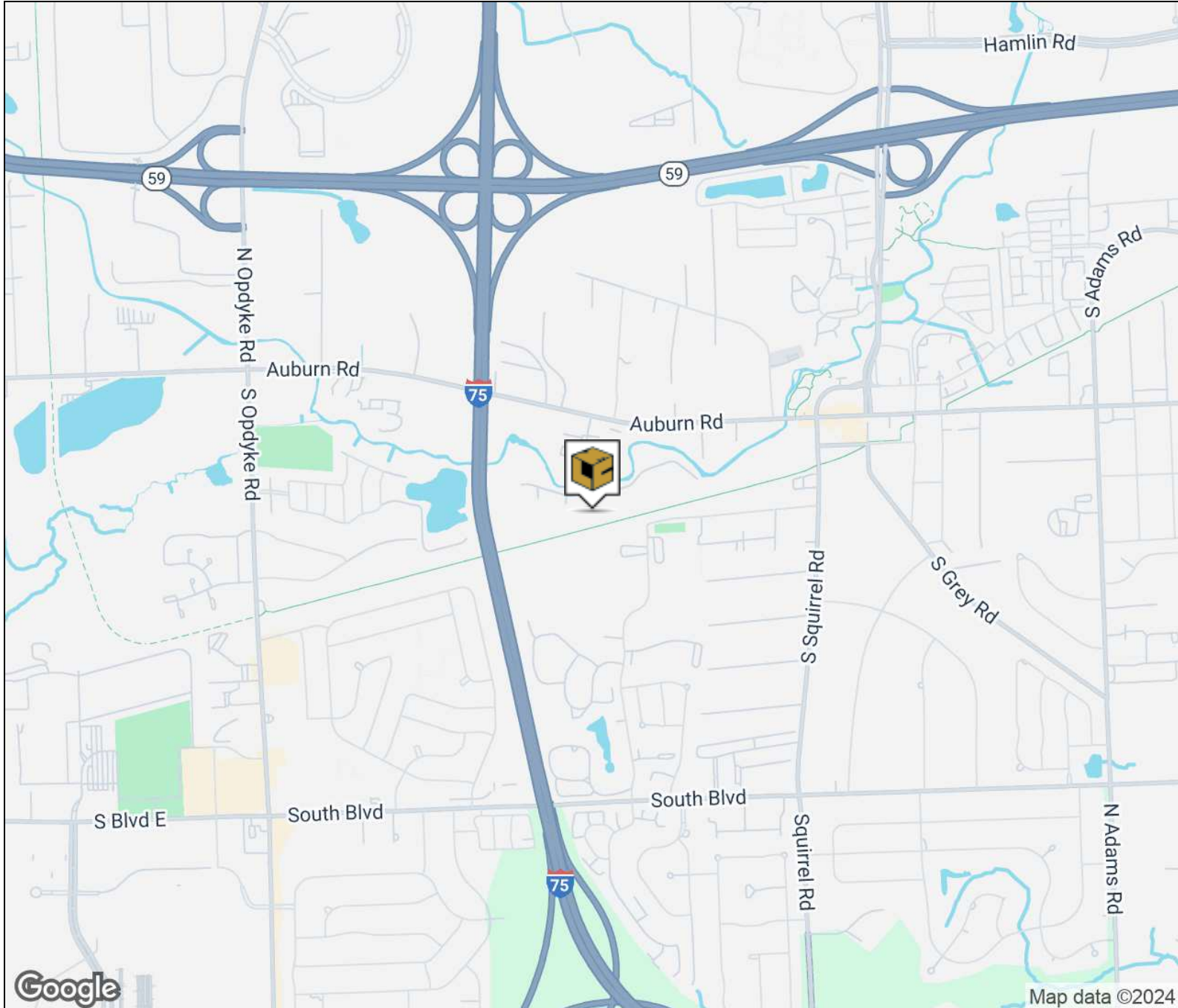

FOR MORE INFORMATION:

Jason Capitani, SIOR, CCIM
Managing Partner
248.637.7684
jcapitani@LMCap.com

Garry Rogers
Senior Vice President
248.637.3527
grogers@LMCap.com



CONNECT WITH US

248.637.9700 | www.LMCap.com

Information contained herein was obtained from sources deemed to be reliable but is not guaranteed. Subjects to prior sales, changes of price or withdrawal.

PROPERTY FOR LEASE

2700 Auburn Ct
Auburn Hills, MI 48326



INDUSTRIAL PROPERTY DETAILS

Lease Rate:	\$9.50 SF/yr NNN
Lease/Month:	\$18,018.33

Location Information

Street Address	2700 Auburn Ct
City, State, Zip	Auburn Hills, MI 48326
County	Oakland
Side of Street	South
Nearest Highway	M-59

Property Information

Property Type	Flex/Hi-Tech
Zoning	I2
Property Subtype	Manufacturing
Lot Size	2.63 Acres
APN #	14-35-228-014
Lot Frontage	218 ft
Lot Depth	523 ft
Site Description	Located south off Auburn Rd between Opdyke and Squirrel.

Building Information

Building Size	22,760 SF
Available SF	22,760 SF
Factory SF	18,260 SF
Office Space	4,500 SF
Year Built	1985
Year Last Renovated	2022
Tenancy	Single
Number of Grade Level Doors	1
Fire Suppression	100%
Bay Size	40
Ceiling Height	24 ft
Minimum Ceiling Height	21 ft
Cranes	10-Ton, (2) 3-Ton Monorail, 2-Ton Monorail
Clearance Under Hook	18'
Mezzanine	Yes
Truckwell	1
Power Description	480V, 1,200 Amps
Rail Access	N/A
Number of Parking Spaces	37
Heating	HVAC
A/C	Office Area
Restrooms	4
Lighting	LED

FOR MORE INFORMATION:

Jason Capitani, SIOR, CCIM
Managing Partner
248.637.7684
jcapitani@LMCap.com

Garry Rogers
Senior Vice President
248.637.3527
grogers@LMCap.com



CONNECT WITH US

248.637.9700 | www.LMCap.com

Information contained herein was obtained from sources deemed to be reliable but is not guaranteed. Subjects to prior sales, changes of price or withdrawal.

PROPERTY FOR LEASE

2700 Auburn Ct
Auburn Hills, MI 48326



L. MASON CAPITANI
CORFAC INTERNATIONAL

FLOOR PLAN

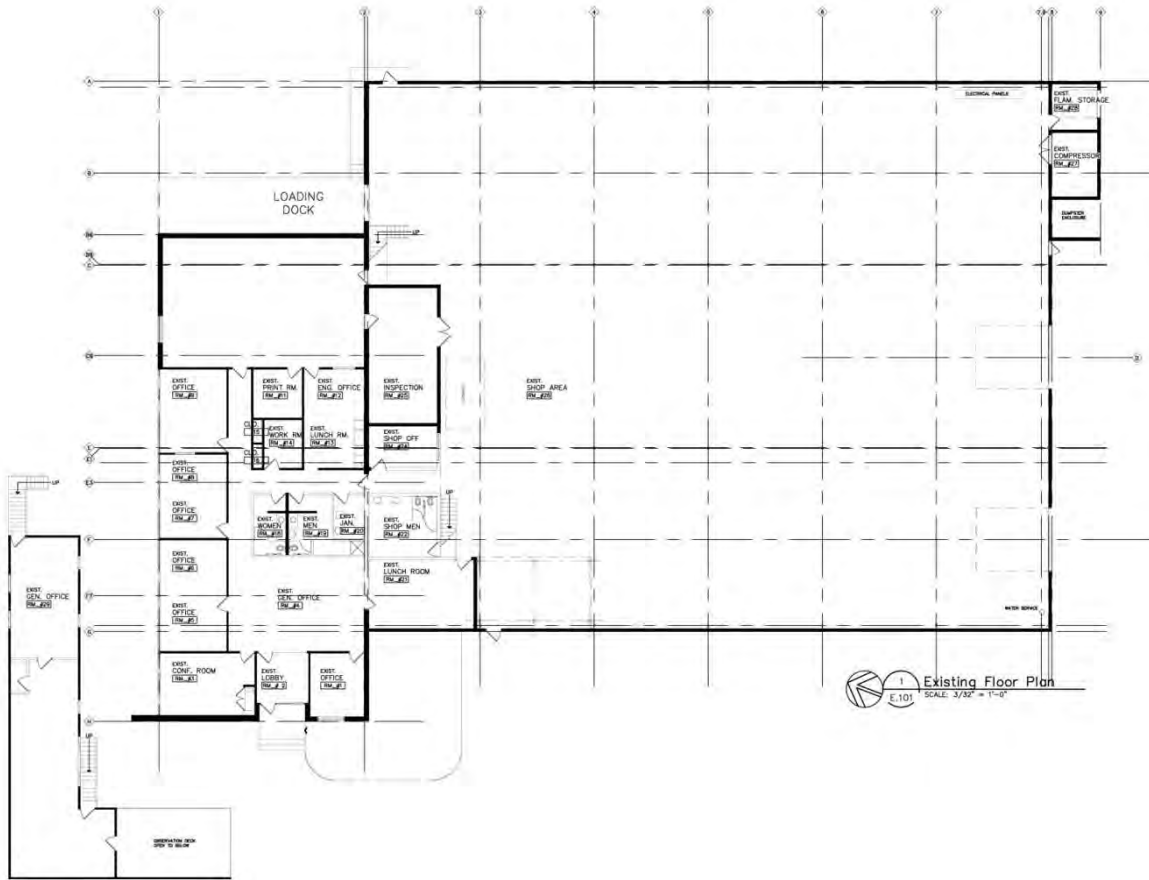

Existing Mezz. Floor Plan
E.101 SCALE: 3/32" = 1'-0"

Existing Floor Plan
E.101 SCALE: 3/32" = 1'-0"



AUGER KLEIN ALLER
ARCHITECTS INC.

303 E THIRD ST FREET, SUITE 100
ROCHESTER, MI 48307
248.814.9100
WWW.AKAARCHITECTS.NET

Copyright © 2019
All rights reserved.
These drawings and specifications are
copyrighted by Auger Klein Aller Architects
Inc. (AKA Architects) and shall remain the
property of AKA Architects. No portion of
this project may be used without the
written consent of AKA Architects. Any
reproduction or use of these drawings
without the written consent of AKA
Architects is strictly prohibited and will
remain property of AKA Architects.

PROJECT
Elite Detection
K9 Auburn Hills

2700 Auburn Ct.
Auburn Hills, MI

DATE ISSUED 06.04.2019
ISSUED FOR SPA

03.12.2020 SPA

DRAWN: AH
CHECKED: DM
APPROVED: AKA

SHEET
Existing Floor
Plans

SCALE OR STORY

FILE NUMBER
1922

SHEET NUMBER
E.101

FOR MORE INFORMATION:

Jason Capitani, SIOR, CCIM
Managing Partner
248.637.7684
jcapitani@LMCap.com

Garry Rogers
Senior Vice President
248.637.3527
grogers@LMCap.com



CONNECT WITH US

248.637.9700 | www.LMCap.com

Information contained herein was obtained from sources deemed to be reliable but is not guaranteed. Subjects to prior sales, changes of price or withdrawal.

PROPERTY FOR LEASE

2700 Auburn Ct
Auburn Hills, MI 48326



ADDITIONAL PHOTOS



FOR MORE INFORMATION:

Jason Capitani, SIOR, CCIM
Managing Partner
248.637.7684
jcapitani@LMCap.com

Garry Rogers
Senior Vice President
248.637.3527
grogers@LMCap.com



CONNECT WITH US

248.637.9700 | www.LMCap.com

Information contained herein was obtained from sources deemed to be reliable but is not guaranteed. Subjects to prior sales, changes of price or withdrawal.

PROPERTY FOR LEASE

2700 Auburn Ct
Auburn Hills, MI 48326



ADDITIONAL PHOTOS



FOR MORE INFORMATION:

Jason Capitani, SIOR, CCIM
Managing Partner
248.637.7684
jcapitani@LMCap.com

Garry Rogers
Senior Vice President
248.637.3527
grogers@LMCap.com



CONNECT WITH US

248.637.9700 | www.LMCap.com

Information contained herein was obtained from sources deemed to be reliable but is not guaranteed. Subjects to prior sales, changes of price or withdrawal.