

# For Sublease

**Existing GMP and Lab Opportunity**

1405 Research Blvd  
Rockville, MD

## Highlights

- 47,180 SF Total: (1st, 2nd, and 3rd floors) of manufacturing, lab, storage, and office\*
- Available: Immediately
- Term: Through December 1, 2032
- Asking rent: Negotiable

\*Equipment list and utility information available upon request

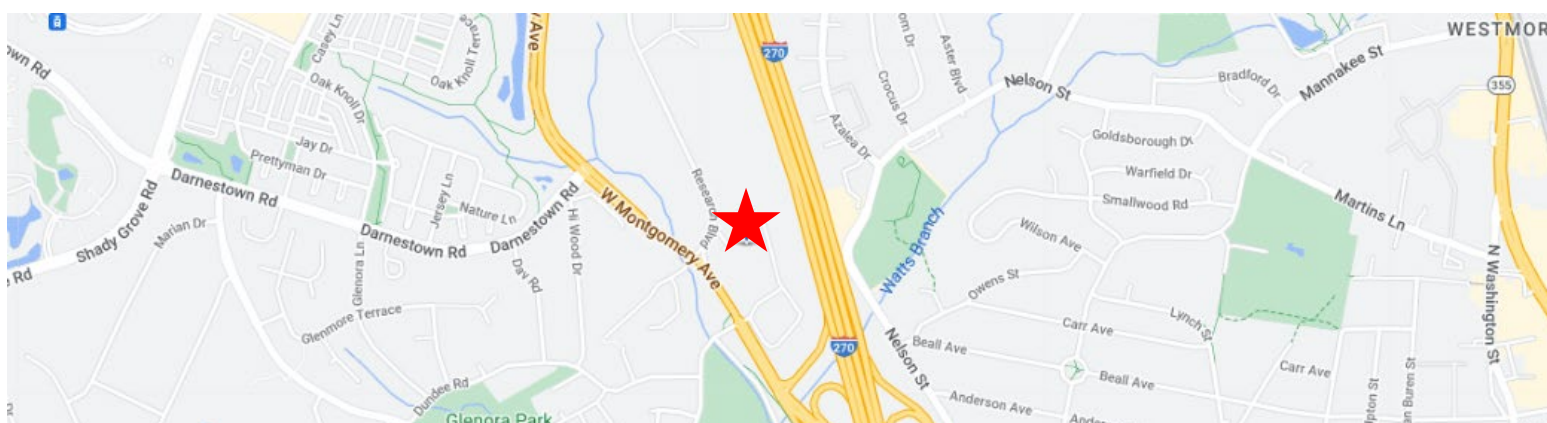

**Alden Stabb**

**+1 301 287 3241**

**[alden.stabb@jll.com](mailto:alden.stabb@jll.com)**



**[jll.com](http://jll.com)**

# First Floor

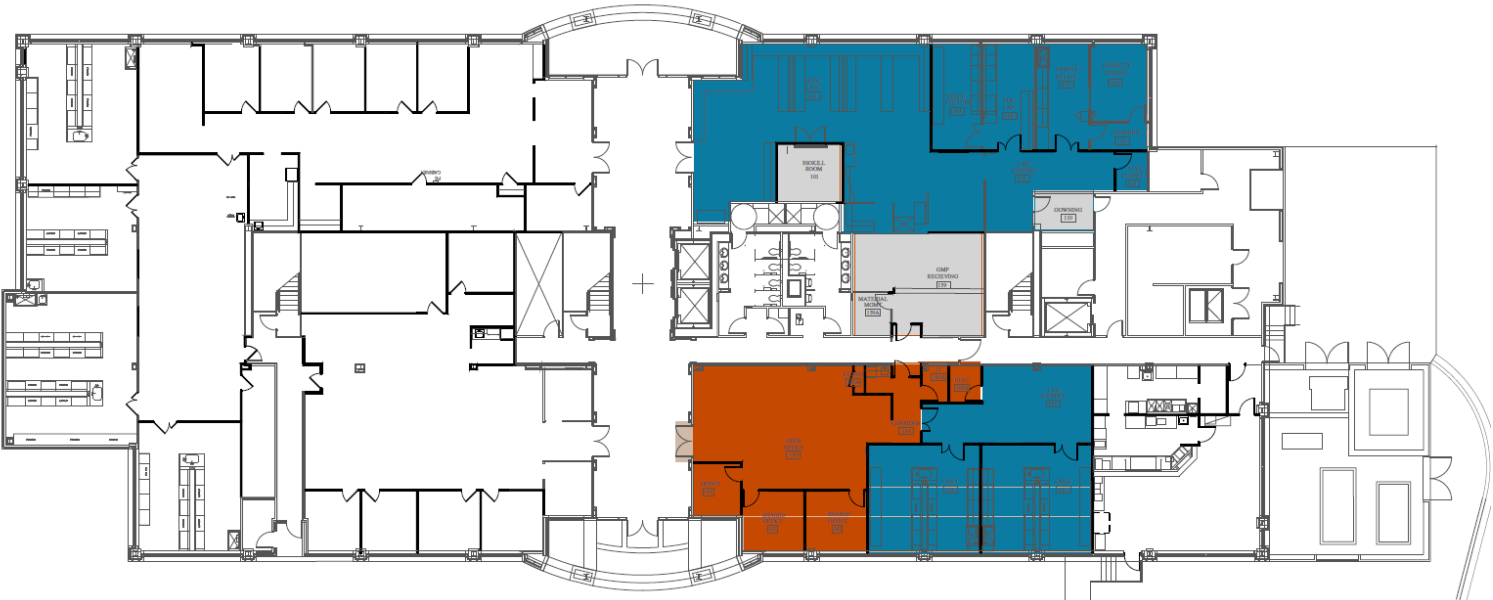
## Floor Plan



### LEGEND:

	R&D Wet Lab
	GMP Support + Shipping and Receiving
	Administrative Space





First Floor  
7,610 RSF

# Second Floor

## Floor Plan

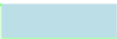

### LEGEND:

	NC
	Grade CNC
	Grade D
	Grade C
	Grade B
	LAF - grade A air supply

Second Floor

13,848 RSF

# Third Floor

## Floor Plan

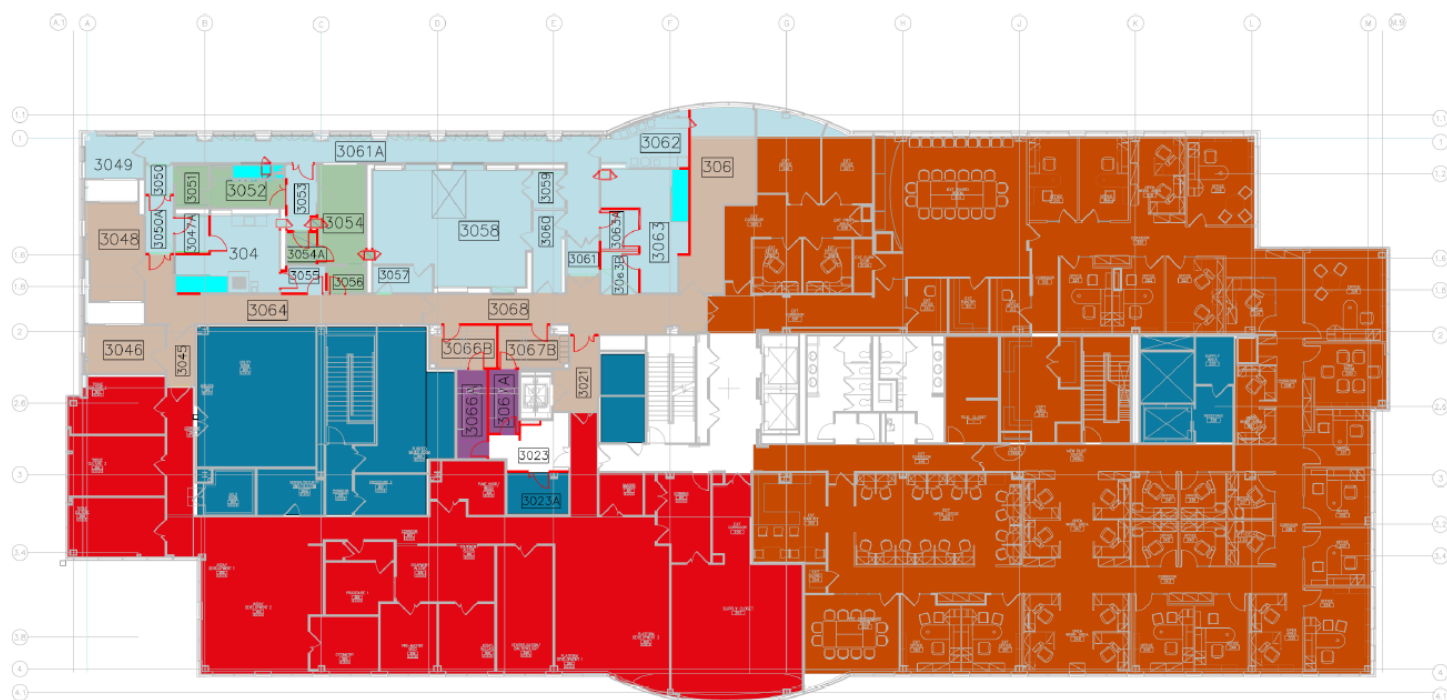

Third Floor  
25,722 RSF

LEGEND:	
	NC
	Grade CNC
	Grade D
	Grade C
	Grade B
	Containment system - grade A
	Administrative Space
	Production Development
	Logistic/Technical